

Model Code

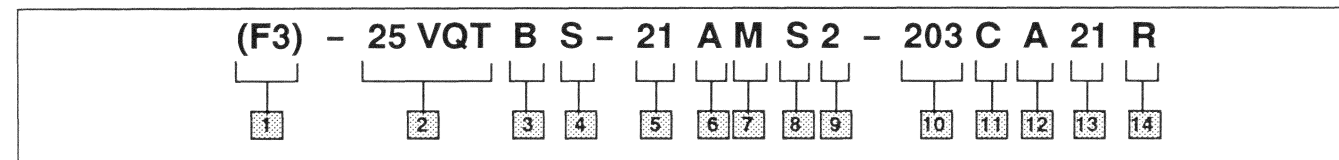

1 Viton seals
Omit - Standard seals

2 Intravane pump series-Thru drive
25VQT - Standard bearing
26VQT - Heavy duty bearing

3 Thru-drive connection mounting adapter

Code	SAE Designation	
	J744C	J744Oct83
A	A	82-2
B	B	101-2
BP	Special mounting with spacer for Vickers PVE19/21	

4 Front mounting flange

Model series	SAE Designation	
	J744C	J744Oct83
2*VQT	B	101-2

5 Geometric displacement
Code - SAE rating (USgpm) at 1200 rpm, 6.9 bar (100 psi)

Frame Size	Code	cm ³ /r	in ³ /r
2*VQT	12	40	2.47
	14	45	2.78
	17	55	3.39
	21	67	4.13

6 Port connections
A - SAE 4-bolt flange

7 Metric threads on port connection
(Omit for inch threads.)

8 Double shaft seal
S - Double shaft seal
Blank - Single shaft seal

9 Thru-drive coupling
2 - SAE splined coupling included with pump

10 Shaft
202 - Straight key
203 - Straight key
297 - Splined

11 Outlet positions
(Viewed from adapter end of pump)
A - Opposite inlet
B - 90° CCW from inlet
C - In line with inlet
D - 90° CW from inlet

12 Adapter mounting orientation
(Viewed from adapter end of pump)

Code	A adapter	B adapter
A	Rotated 45° CW with respect to pump mtg. flg.	In line with pump mtg. flg.
B	Rotated 45° CCW with respect to pump mtg. flg.	Rotated 90° with respect to pump mtg. flg.

13 Design
-20 design single shaft seal
-21 design double shaft seal

14 Rotation
(Viewed from shaft end of pump)
L - Left hand (counterclockwise)
R - Right hand (clockwise)

NOTE
To reverse cartridge kit rotation, remove the two screws and reverse the location of the inlet support plate and outlet support plate. Re-install the two screws hand tight. Use pump cover to align all sections of the cartridge. Carefully remove the cover and tighten the screws.

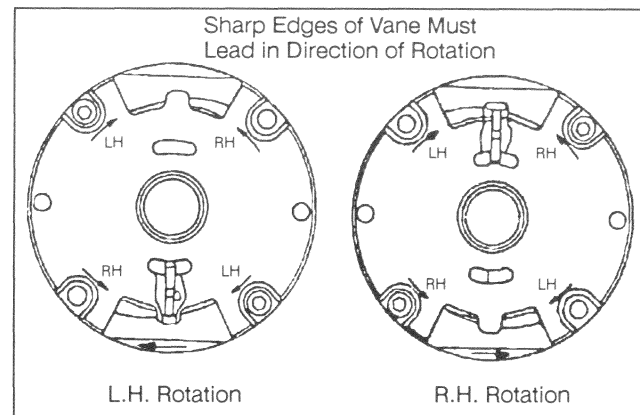

NOTE
When ordering spare cartridge parts, it is recommended they be obtained in cartridge kits. Kits are assembled and tested by Vickers for either right or left hand rotation. If left hand rotation is required, it should be specified on parts order by adding suffix "L" to cartridge kit number.

Service Data



Thru-Drive Vane Type Pump

(F3)-25VQT*(M)-**A(M)2-**-*-20/21-*

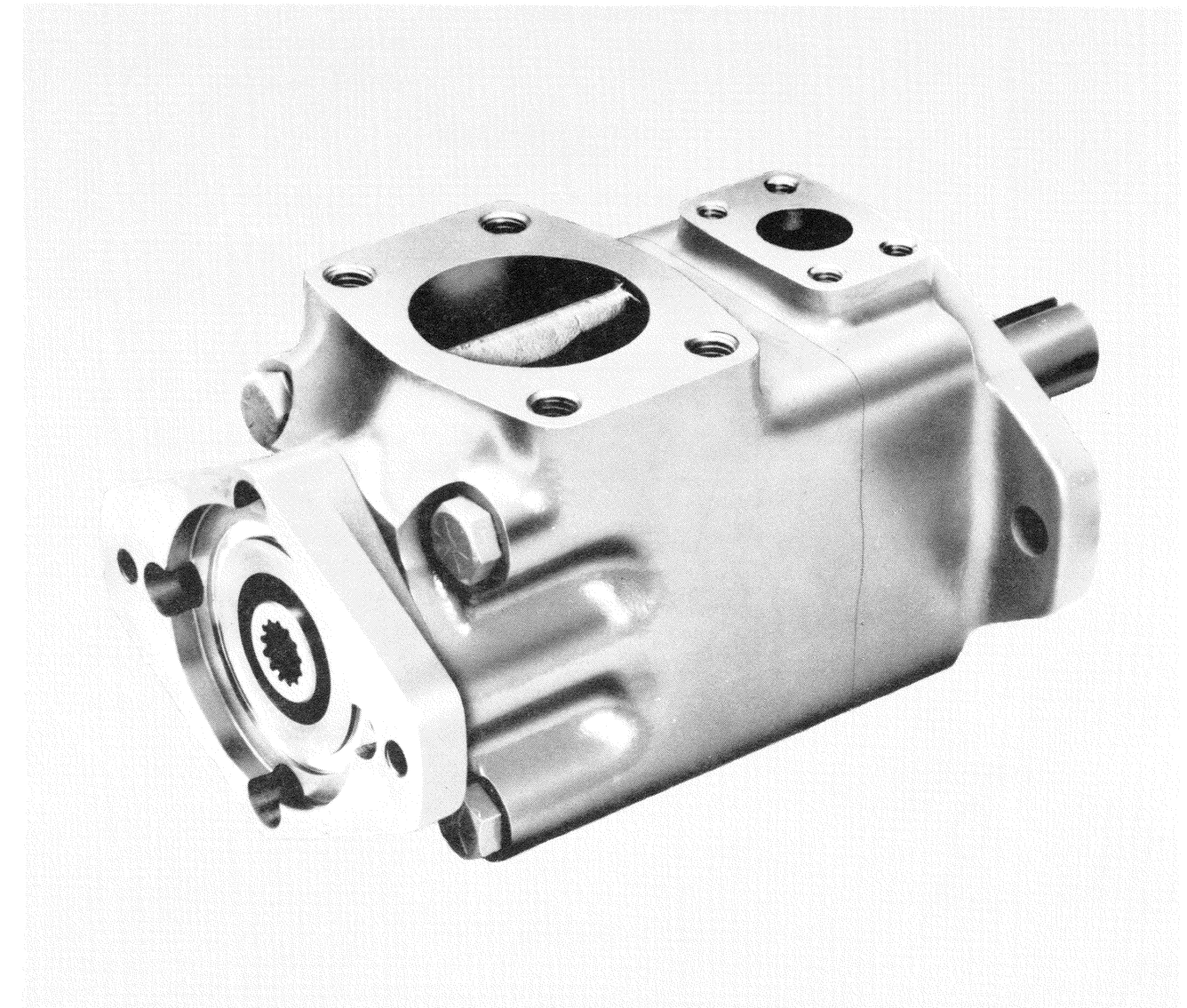

Vickers Incorporated
A TRINOVA Company
5445 Corporate Drive
P. O. Box 302
Troy, Michigan 48007-0302
U.S.A.

MODEL	ADAPTER PLATE	ADAPTER KIT	SPACER KIT	RETAINING RING	COUPLING	COUPLING KIT
VQTA	584936	941296		223172	426770	02-136810
VQTB	584922	941297		89447 (1)	584924	02-136811
VQTBP			02-136817	89447 (2)	452865	02-136812

NOTE
FOR BP MODELS AN ADAPTER KIT
AND SPACER KIT IS REQUIRED.

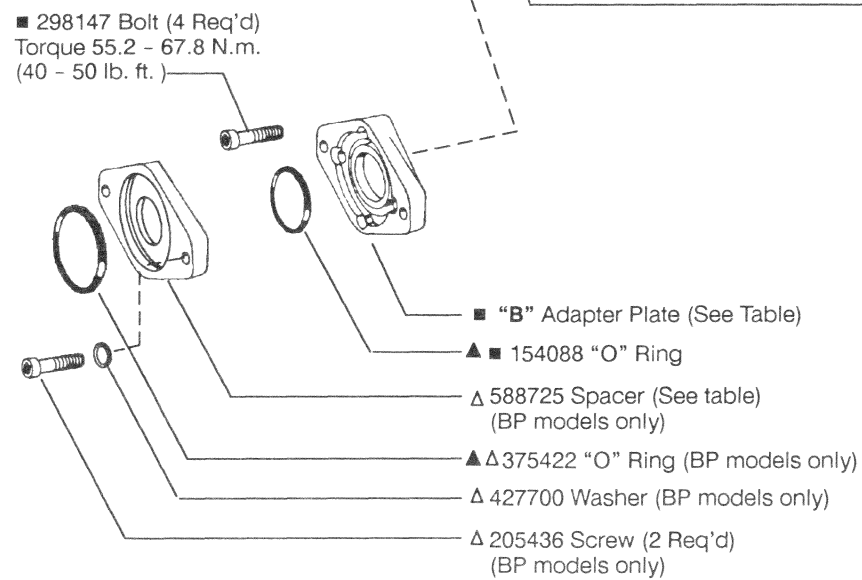
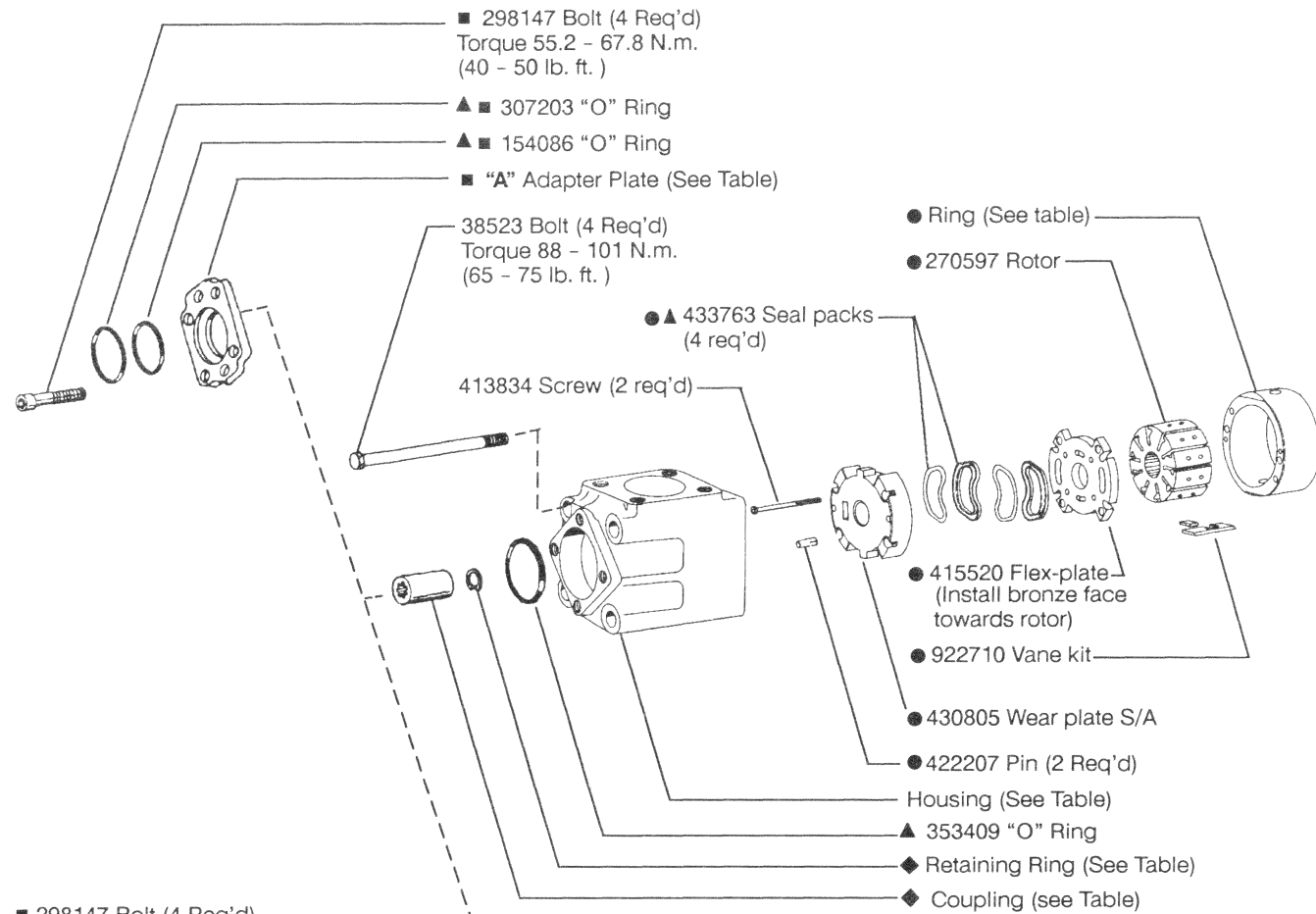

MODEL	SEAL KIT	F3 SEAL KIT
25VQTA-20	920239	920240
25VQTA-21	02-136865	02-136866
25VQTB-20	02-136782	02-136783
25VQTB-21	02-136867	02-136868
25VQTBP-20	02-136933	02-136934
25VQTBP-21	02-136939	02-136940

- ▲ Included in seal kit (See Table)
F3 equivalent seal kit (See Table)
- Included in cartridge kit (See Table)
- ◆ Included in coupling kit (See Table)
- Included in adapter kit (See Table)
- ▲ Included in spacer kit (BP models only)
Parts prefixed with symbols available
only in kits

MODEL	SHAFT	KEY
25VQTAS-202	876124	3418
25VQTB(P)S-202	876125	
25VQTAS-203	876126	
25VQTB(P)S-203	876127	
25VQTAS-297	876121	
25VQTB(P)S-297	876117	

MODEL	HOUSING	BODY S/A
25VQT*S**A	251263	02-136915
25VQT*S**AM	478505	02-136916

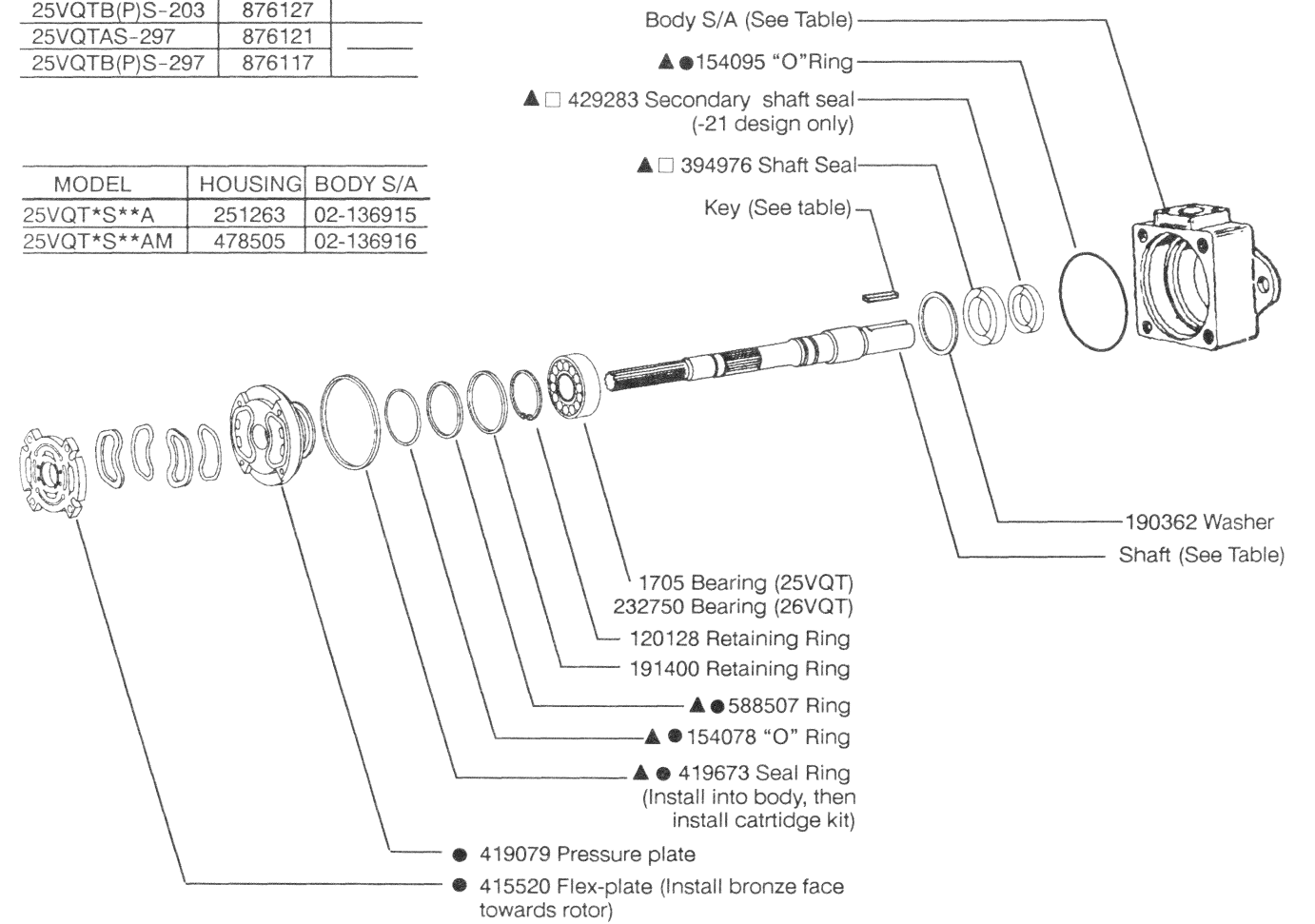

MODEL	RING	● CART KIT	F3 CART KIT
25VQT12	326984	416439	421570
25VQT14	326985	416440	421571
25VQT17	326986	416441	421572
25VQT21	326988	416442	421574

□ Assemble seal with spring loaded
sealing member towards bearing. Seals
to be completely wetted with oil prior
to assembly.

NOTE:
For satisfactory service life of these
components in industrial applications,
use full flow filtration to provide fluid
which meets ISO cleanliness code
16/13 or cleaner. OFP, OFR, and OFRS
series filters are recommended.

