

MODEL CODE BREAKDOWN

TA1919 V1010 * * -2 * * - ** * * * * -21

1 2 3 4 5 6 7 8 9 10 11 12 13 14 15

- 1 Double transmission pump
Each rated @ 19 USgpm @ 1800 rpm
- 2 Auxiliary vane pump
- 3 Vane pump cover
- P - Priority
Omitted - STD.
- 4 **Rotation**
(Viewed from shaft end)
R - Right hand (CW)
L - Left hand (CCW)
- 5 **Input shaft**
2 - SAE B-B Spline
- 6 **Control pintle**
(Location viewed from shaft end w/drain port up.)
Code Pump #1 Pump #2
A RH side RH side
B LH side RH side
C RH side LH side
D LH side LH side
- 7 **Main relief valve**
R - Relief valve
O - No relief valve
- 8 **Shaft end vane pump ring**
(Capacity at 1200 rpm)
04 - 4 USgpm 06 - 6 USgpm
05 - 5 USgpm 07 - 7 USgpm
- 9 **Cover end vane pump ring**
(Capacity at 1200 rpm)
01 - 1 USgpm *05 - 5 USgpm
02 - 2 USgpm 06 - 6 USgpm
03 - 3 USgpm 07 - 7 USgpm
*04 - 4 USgpm
* "P" cover
- 10 **Vane pump outlet port #1**
(Position viewed from cover end)
A - In line with case drain
C - 180° Opposite case drain
- 11 **Vane pump inlet port**
(Viewed from cover end)
A - Opposite outlet 1
B - 90° CCW from outlet 1
C - In line with outlet 1
D - 90° CW from outlet 1
- 12 **Vane pump inlet port #2**
(Viewed from cover end)
A - Opposite inlet
B - 90° CCW from inlet
C - In line with inlet
D - 90° CW from inlet
- 13 **Flow rate thru orifice "P"**
(Located in the cover)
1, 2, 3, 4, 5, 6, or 7 USgpm
- 14 **Cover end vane pump relief valve setting**
("P" cover only)
A - 250 psi F - 1500 psi
B - 500 psi G - 1750 psi
C - 750 psi H - 2000 psi
D - 1000 psi J - 2250 psi
E - 1250 psi K - 2500 psi
- 15 **Design**

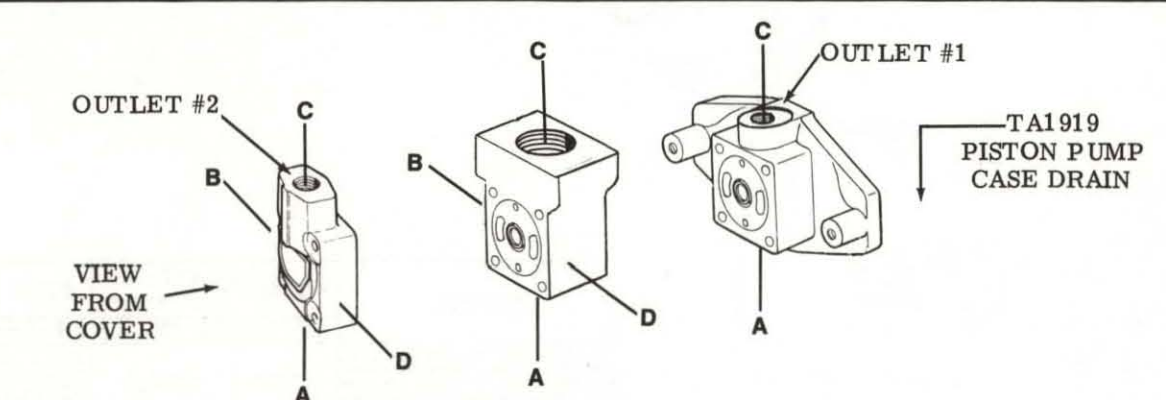

For satisfactory service life of these components, use full flow filtration to provide fluid which meets ISO cleanliness code 16/13 or cleaner. Selections from pressure, return, and in-line filter series are recommended.

Revised 11-1-89 M-2848-S

Service Parts Information

Double
Transmission
Pump
Package

TA1919V1010(P)-21

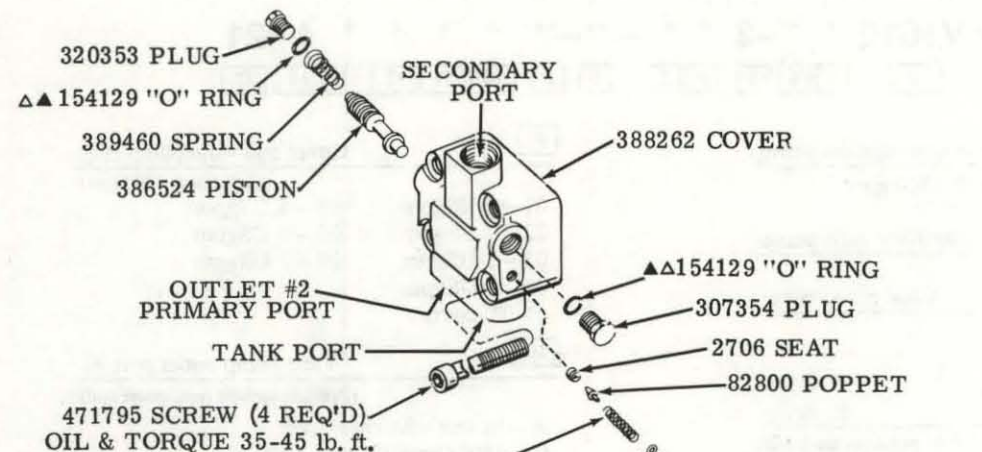

SEE MODEL CODE	PRESSURE SETTING (P. S. I.)	SPRING
A	250	252886
B	500	2280
C	750	
D	1000	2282
E	1250	
F	1500	
G	1750	
H	2000	2281
J	2250	
K	2500	

NOTE
USE PRIMARY PORT
FOR COVER POSITION

ROTOR	VANE KIT (12 VANES)	RING	CART. KIT	PIN (2 REQ'D)	MODEL
INCLUDED IN CART KIT					
580224	923500	317677 317678	941099 941100	2456	TDV1010-04-**-**-10 TDV1010-05-**-**-10
580215	923501	355641 331813	941101 941102	16662	TDV1010-06-**-**-10 TDV1010-07-**-**-10

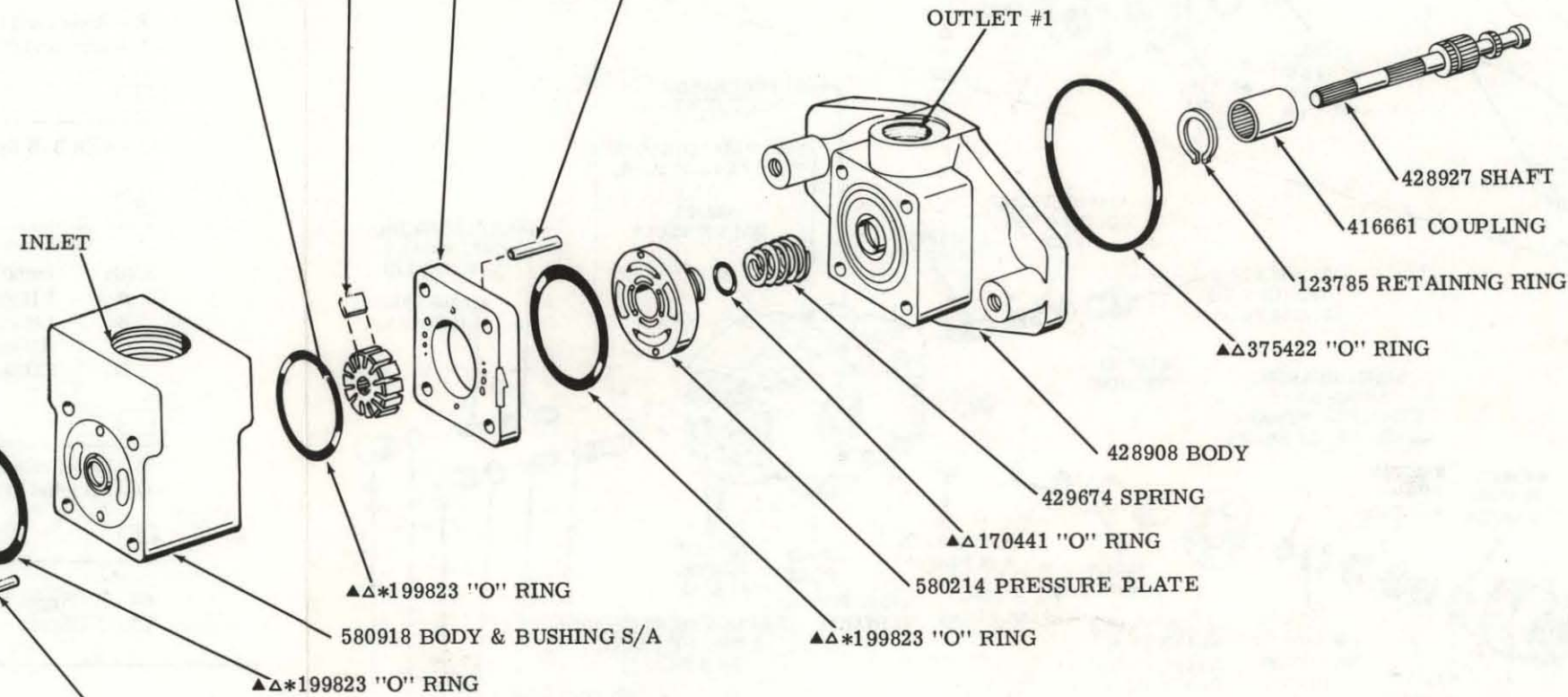

THREAD SHAFT INTO INTERMEDIATE SHAFT UNTIL BOTTOMED THEN BACKOFF 1/4 TURN (APPROX. .020 GAP). INSTALL COUPLING & 123785 RETAINING RING TO HOLD COUPLING IN PLACE.

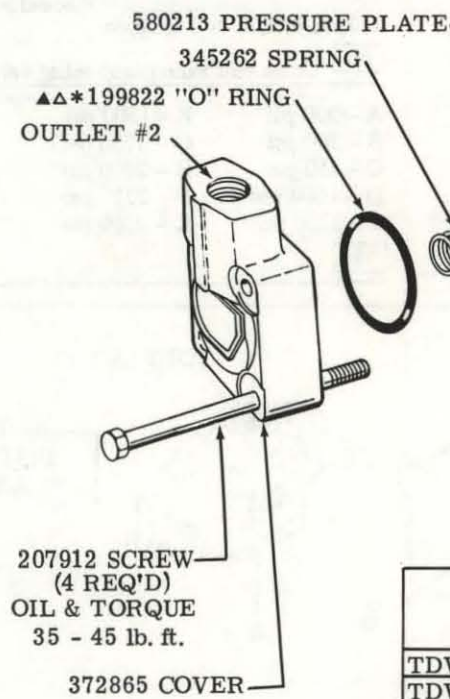

MODEL	ROTOR	VANE KIT (12 VANES)	RING	CART. KIT	PIN (2 REQ'D)
TDV1010-**-01-**-10			317674	923471	
TDV1010-**-02-**-10	317681	923499	317675	923470	231042
TDV1010-**-03-**-10			317676	923496	
TDV1010-**-04-**-10			317677	923469	
TDV1010-**-05-**-10	351247	923500	317678	923468	2456
TDV1010-**-06-**-10			355641	923497	
TDV1010-**-07-**-10	357286	923501	331813	923498	16662

△ INCLUDED IN 920220 SEAL KIT

* ALSO INCLUDED IN CARTRIDGE KIT

