

**WARNING: USE THIS DRAWING FOR PARTS INFORMATION ONLY.  
SEE OVERHAUL MANUAL M-2835-S FOR MAINTENANCE INFORMATION**

- INCLUDED IN 923938 SHIM KIT
- ▲ INCLUDED IN 920171 SEAL KIT
- \* SEE OVERHAUL MANUAL FOR BEARING PRELOAD ADJUSTMENT.
- INCLUDED IN 923936 ROTATING GROUP KIT (FOR ONE PUMP ONLY) (ORDER 2 KITS FOR BOTH PUMPS)

427172 SCREW (4 REQ'D) TORQUE TO 170-190 lb. in.

- 402650 SHOE PLATE
- 402580 SPHERICAL WASHER
- 410050 PIN RETAINER
- 248810 PIN (3 REQ'D)
- 426836 CYLINDER BLOCK
- 404932 SPRING WASHER
- 424526 SPRING (COLOR CODED GREEN)
- 99907 RETAINING RING

- 423368 SPRING WASHER
- 942401 BEARING SPACER KIT (CHAMFER TOWARD SHOULDER OF SHAFT)
- 424492 WAFER PLATE R. H. (424481 WAFER PLATE L. H. ROTATION)
- 473914 BEARING S/A

- 427172 SCREW (4 REQ'D) TORQUE TO 170-190 lb. in.
- 427171 SCREW (6 REQ'D) TORQUE TO 23-26 lb. ft.
- 417381 BEARING S/A
- 416637 COVER
- SHIM KIT (SEE OTHER PINTLE)
- 410053 PINTLE BEARING SPACER
- 471965 SHAFT SEAL
- 85560 RETAINING RING
- 410053 PINTLE BEARING SPACER

- 423417 INTERMEDIATE SHAFT
- 416636 YOKE (L. H. POSITION)
- 419627 BEARING S/A
- 423617 GASKET
- 199740 SCREW (2 REQ'D) TORQUE TO 54-60 lb. ft.
- 427700 WASHER (2 REQ'D)
- 416638 PINTLE COVER
- 410053 PINTLE BEARING SPACER
- 417381 BEARING S/A
- 174140 "O" RING
- 923938 SHIM KIT (INCLUDES SHIMS FOR BOTH SIDES OF UNIT)
- 427172 SCREW (4 REQ'D) TORQUE TO 170-190 lb. in.
- 7075 PLUG (3 REQ'D) TORQUE TO 15-17 lb. ft.
- 422303 VALVE BLOCK
- 416645 POPPET
- 424525 SPRING COLOR CODED RED
- 154131 "O" RING (TORQUE TO 128-148 lb. ft.)
- 416599 PLUG (TORQUE TO 128-148 lb. ft.)
- 424481 WAFER PLATE R. H. (424492 WAFER PLATE L. H. ROTATION)
- 942401 BEARING SPACER KIT (CHAMFER TOWARD SHOULDER OF SHAFT)
- 99907 RETAINING RING
- 404932 SPRING WASHER
- 426836 CYLINDER BLOCK
- 248810 PIN (3 REQ'D)
- 410050 PIN RETAINER
- 402580 SPHERICAL WASHER
- 402650 SHOE PLATE
- 923939 PISTON SHOE S/A KIT (INCLUDES 9 PISTON & SHOE S/A)
- 423417 INTERMEDIATE SHAFT
- 416636 YOKE (R. H. POSITION)
- 423617 GASKET
- 419627 BEARING S/A
- 422309 HOUSING (#1)
- 923938 SHIM KIT (INCLUDES SHIMS FOR BOTH SIDES OF UNIT)
- 427172 SCREW (4 REQ'D) TORQUE TO 170-190 lb. in.
- 416637 COVER
- 174140 "O" RING
- 410053 PINTLE BEARING SPACER

MODEL	SHAFT	KEY	TYPE
TA1919V20**-2	423416		SPLINED
TA1919V20**-12	426443	235252	KEYED
TA1919V20**-13	435296	398082	KEYED

MODEL	REPLENISHING CHECK AND RELIEF VALVE KIT (4 REQ'D)	REPLENISHING CHECK (4 REQ'D)
TA1919V20**-**R	942429 - 5000 PSI	NONE
TA1919V20**-001 SUFFIX	942430 - 3500 PSI	416645
TA1919V20**-**0	NONE	NONE
TA1919V20**-014 SUFFIX	942428 - 3000 PSI	NONE
TA1919V20**-016 SUFFIX	942427 - 4000 PSI	NONE

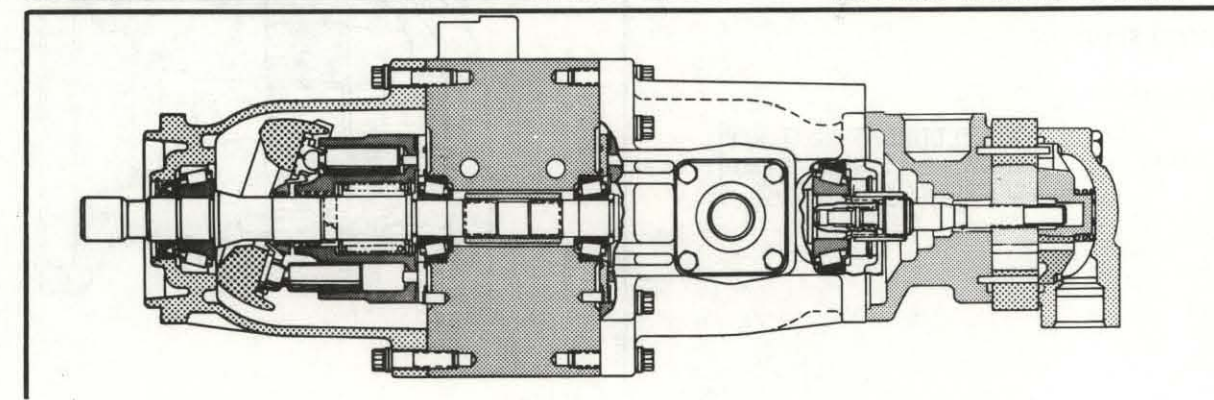

SEE DOUBLE TRANSMISSION VANE PUMP EXPLODED VIEW SHOWN ON BACK PAGE.

### MODEL CODE BREAKDOWN

TA1919 V20 \* \*-2 \* \* - \* \* \* \* \*

- 1 2 3 4 5 6 7 8 9 10 11 12 13

1 Double transmission pump  
Each rated @ 19 USgpm @ 1800 rpm

2 Auxiliary vane pump

3 Vane pump cover  
F - Flow control  
P - Priority flow  
Omitted - STD cover

4 Rotation  
(Viewed from shaft end)  
R - Right hand (CW)  
L - Left hand (CCW)

5 Input shaft  
2 - SAE B-B Spline  
12 - Straight keyed  
13 - Straight keyed

6 Control pintle  
(Location viewed from shaft end w/drain port up.)

Code	Pump #1	Pump #2
A	RH side	RH side
B	LH side	RH side
C	RH side	LH side
D	LH side	LH side

7 Main relief valve  
R - Relief valve  
O - No relief valve

8 Vane pump ring capacity  
(@ 1200 rpm)

- 07 - 7 USgpm
- 08 - 8 USgpm
- 09 - 9 USgpm
- 10 - 10 USgpm
- 11 - 11 USgpm
- 12 - 12 USgpm
- 13 - 13 USgpm

9 Vane pump outlet port  
(Position viewed from cover end)  
A - In line with case drain  
C - 180° Opposite case drain

10 Vane pump inlet port  
(Viewed from cover end)  
A - Opposite inlet  
B - 90° CCW from inlet  
C - In line with inlet  
D - 90° CW from inlet

11 Flow rate  
Orifice in "F" cover:  
2, 4, 6, 8, 10 USgpm  
Orifice in "P" cover:  
1, 2, 2.5, 3, 4, 5, 6, 7, 8 USgpm

12 Vane pump relief valve setting  
( "F" & "P" cover )

Code	Pressure	Code	Pressure
A	250 psi	G	1750 psi
B	500 psi	H	2000 psi
C	750 psi	J	2250 psi
D	1000 psi	K	2500 psi
E	1250 psi	O	No relief valve
F	1500 psi		

13 Design

For satisfactory service life of these components, use full flow filtration to provide fluid which meets ISO cleanliness code 16/13 or cleaner. Selections from pressure, return, and in-line filter series are recommended.

**PRIORITY VALVE COVER**

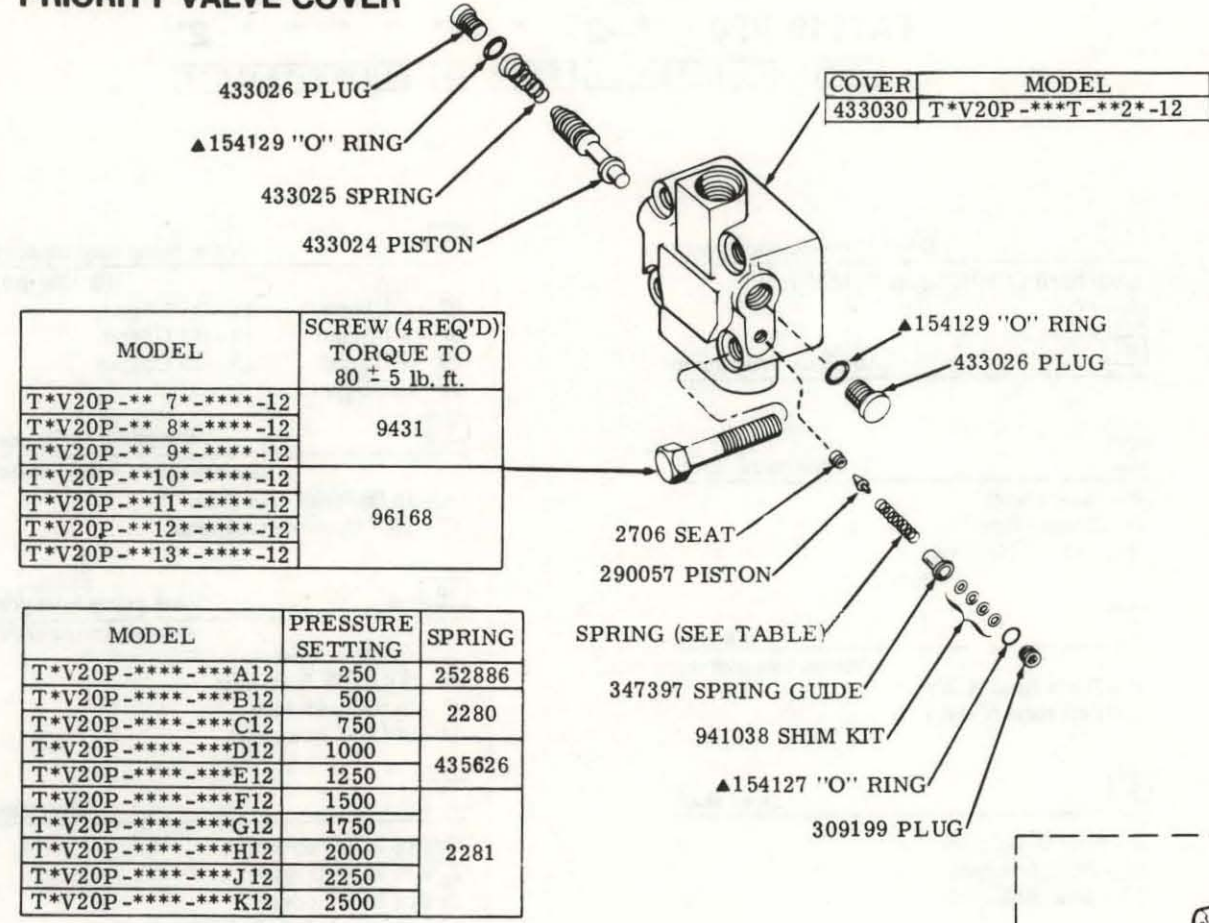

**FLOW CONTROL COVER**

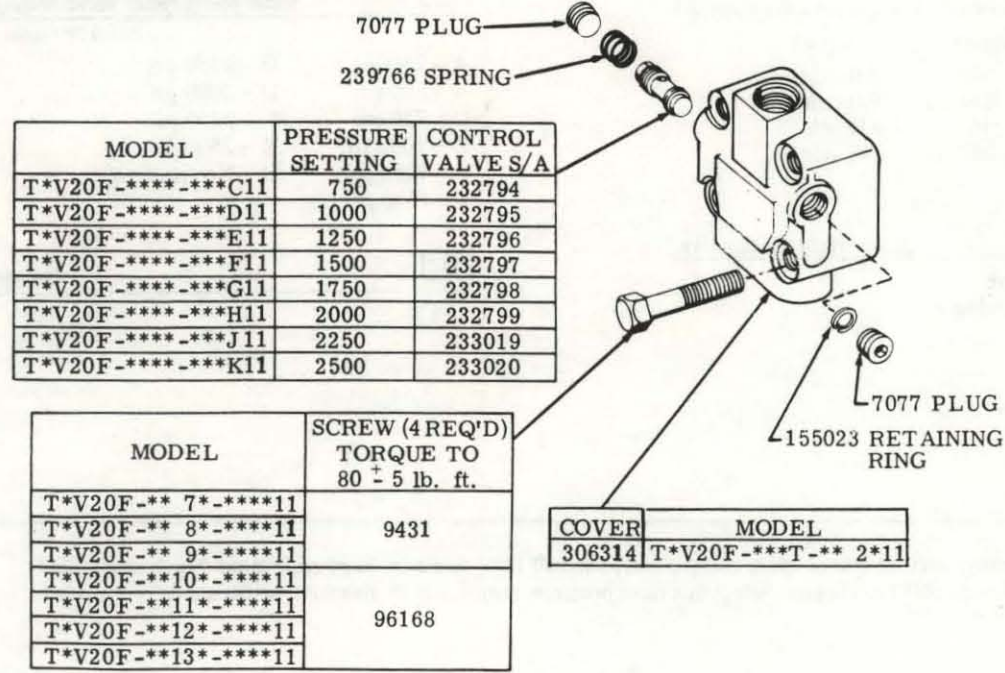

RING	ROTOR	VANE KIT (12 VANES)	"O" RING (2 REQ'D)	CART KIT	PIN (2 REQ'D)	SCREW (4 REQ'D) TORQUE TO 80 ± 5 lb. ft.	MODEL
SERVICED IN CARTRIDGE KIT							
328152				923481			T*V20*-** 7*-****11/12
331791	358330	923493	154090	923483	2478	131486	T*V20*-** 8*-****11/12
331789				923484			T*V20*-** 9*-****11/12
374309	358332	923478		923620	16662		T*V20*-**10*-****11/12
328156				923482			T*V20*-**11*-****11/12
331806	358334	923479		923486		1319	T*V20*-**12*-****11/12
331807				923487	9603		T*V20*-**13*-****11/12

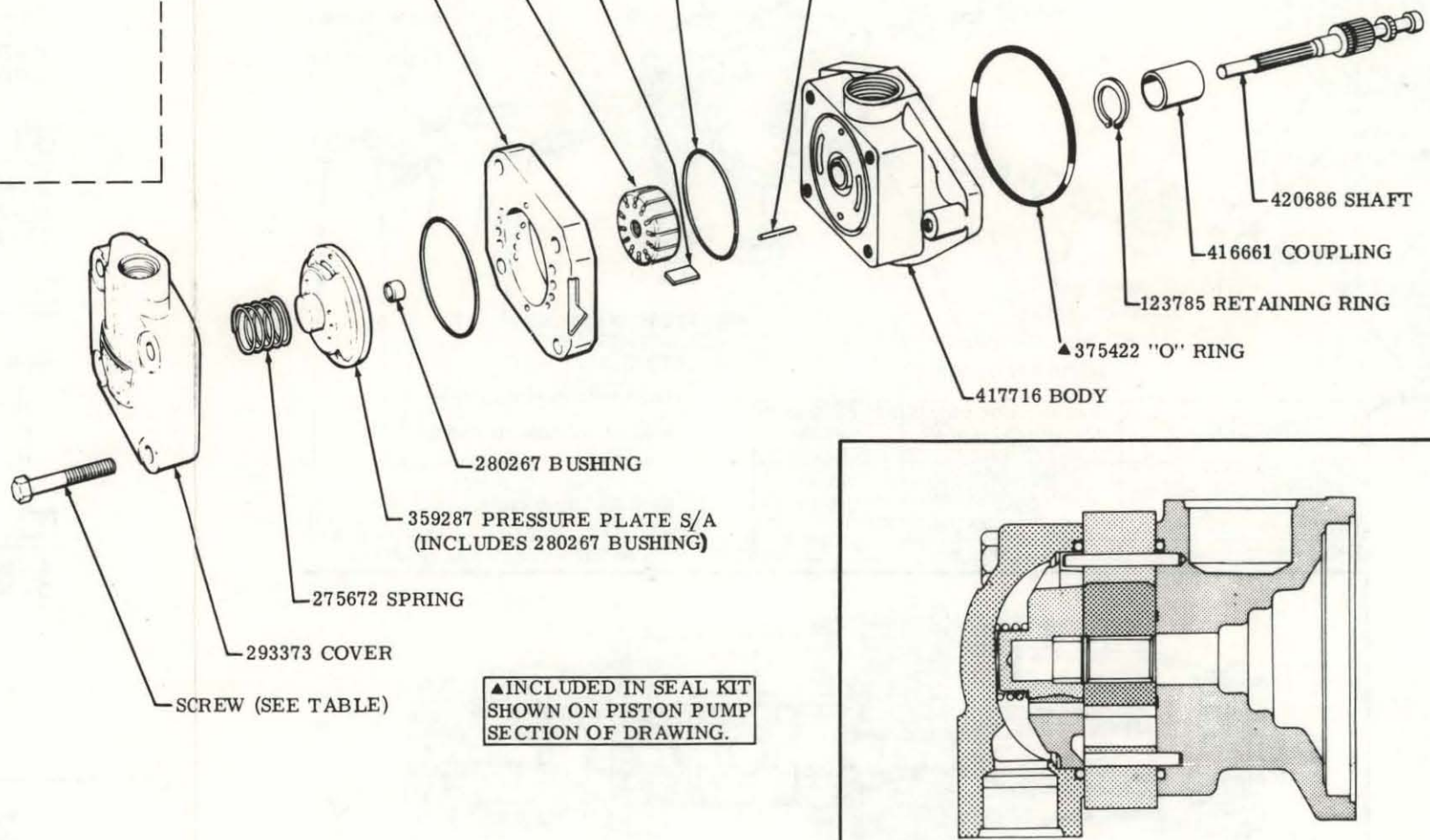

# Service Parts Information

Double  
Transmission  
Pump  
Package

TA1919V20\*-21/-22

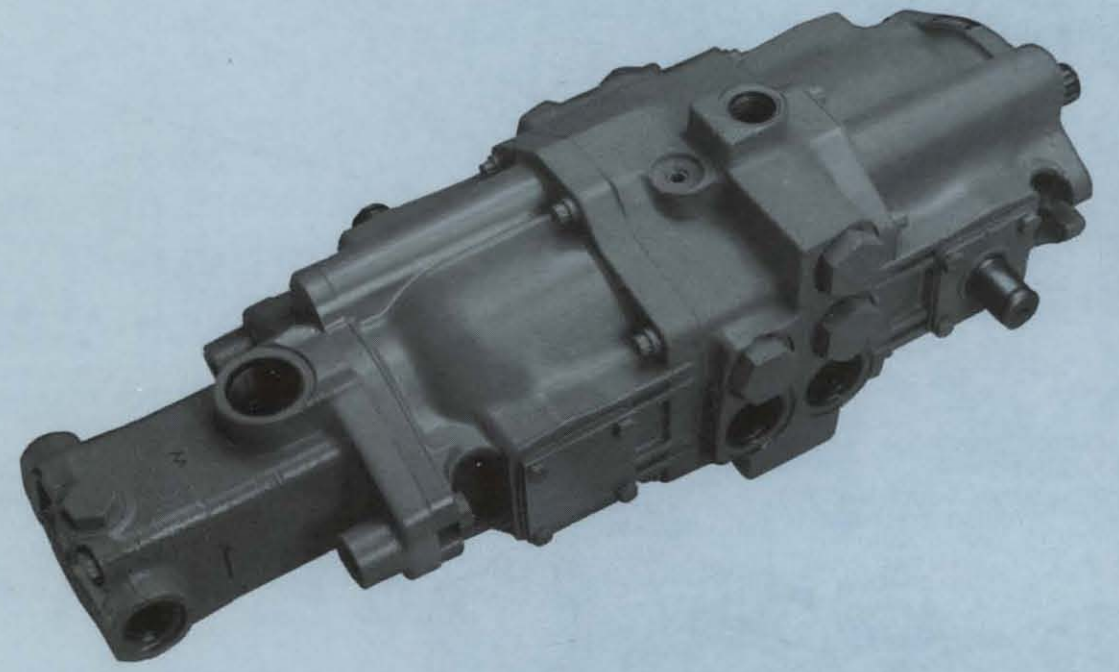

Vickers, Incorporated

P.O. Box 302  
Troy, Michigan 48007-0302

Revised 11-1-89

M-2847-S