

Dual Displacement, Pilot Operated, Piston Motor

MVE-19-* -30-M**/P*-10-(030)

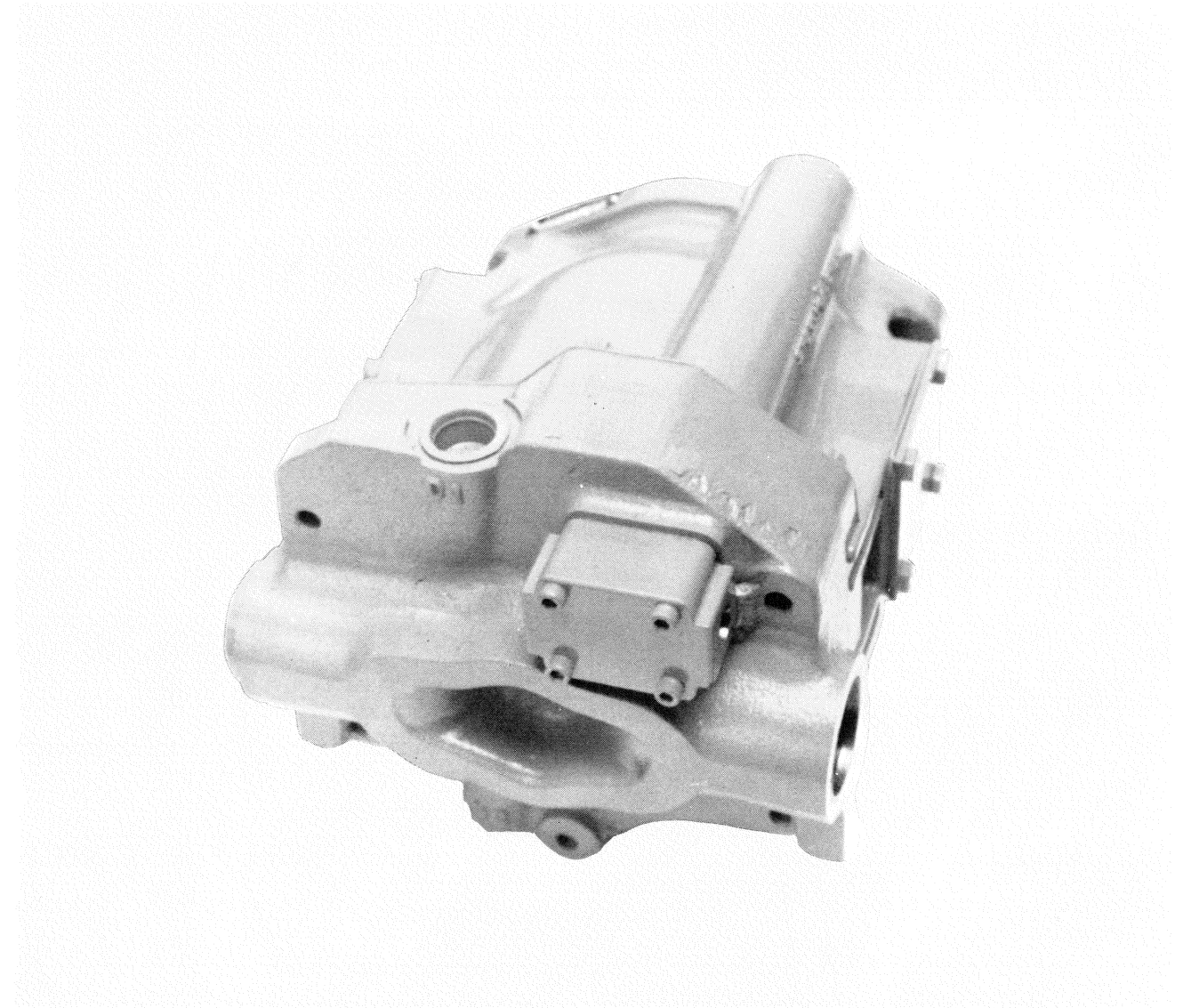
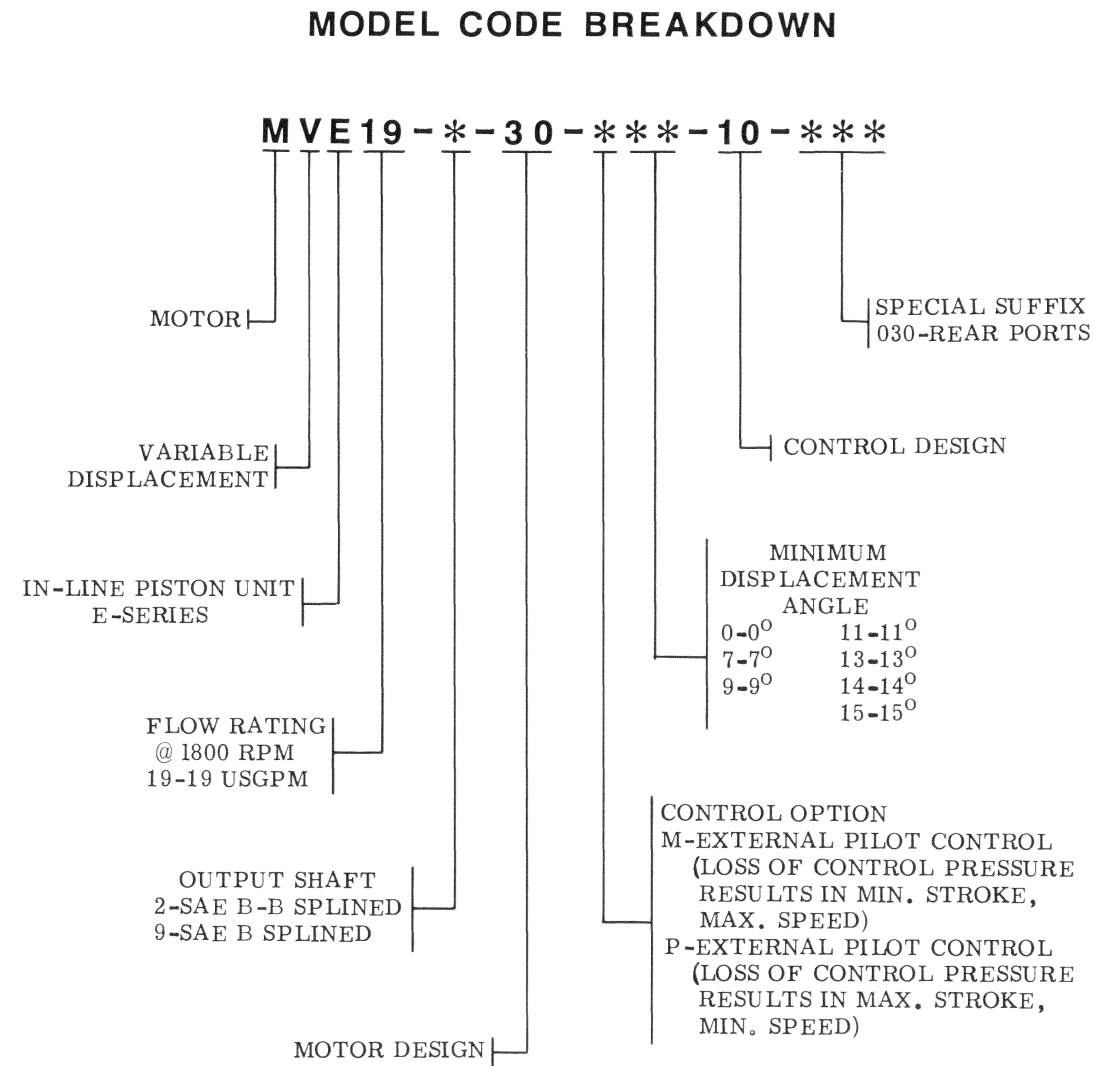

For satisfactory service life of these components in industrial applications, use full flow filtration to provide fluid which meets ISO cleanliness code 19/15 or cleaner. Selections from Vickers OFP, OFR, and OFRS series are recommended.

Litho in U. S. A.

Vickers Incorporated
 5445 Corporate Drive
 P. O. Box 302
 Troy, Michigan 48007-0302
 U.S.A.

Revised 12-01-87

M-2822-S

- ▲ INCLUDED IN SEAL KIT 920248
- ◇ INCLUDED IN PINTLE SHIM KIT 923938
- ⊖ INCLUDED IN BEARING SPACER KIT 942401
- INCLUDED IN ROTATING GROUP (M**-10) 938092
- INCLUDED IN ROTATING GROUP (P*-10) 923941

MODEL	SPACER
MVE19-*-30-M0-10	OMIT
MVE19-*-30-M7-10	629521
MVE19-*-30-M9-10	629522
MVE19-*-30-M11-10	629523
MVE19-*-30-M13-10	629527
MVE19-*-30-M14-10	595487
MVE19-*-30-M15-10	629524
MVE19-*-30-P7-10	OMIT
MVE19-*-30-P9-10	OMIT

MODEL	PORT	VALVE BLOCK
MVE19-*-30**-10	SIDE	594346
MVE19-*-30**-10-030	REAR	680780

MODEL	YOKE STOP	YOKE SPRING	SPRING SEAT	YOKE	PISTON	PIN	SPRING
MVE19-*-30-M*-10	OMIT	594347	594355	594341	594354	393841	594799
MVE19-*-30-P7-10	581054	581075	581053	409997	404958	248810	418271
MVE19-*-30-P9-10			500572				

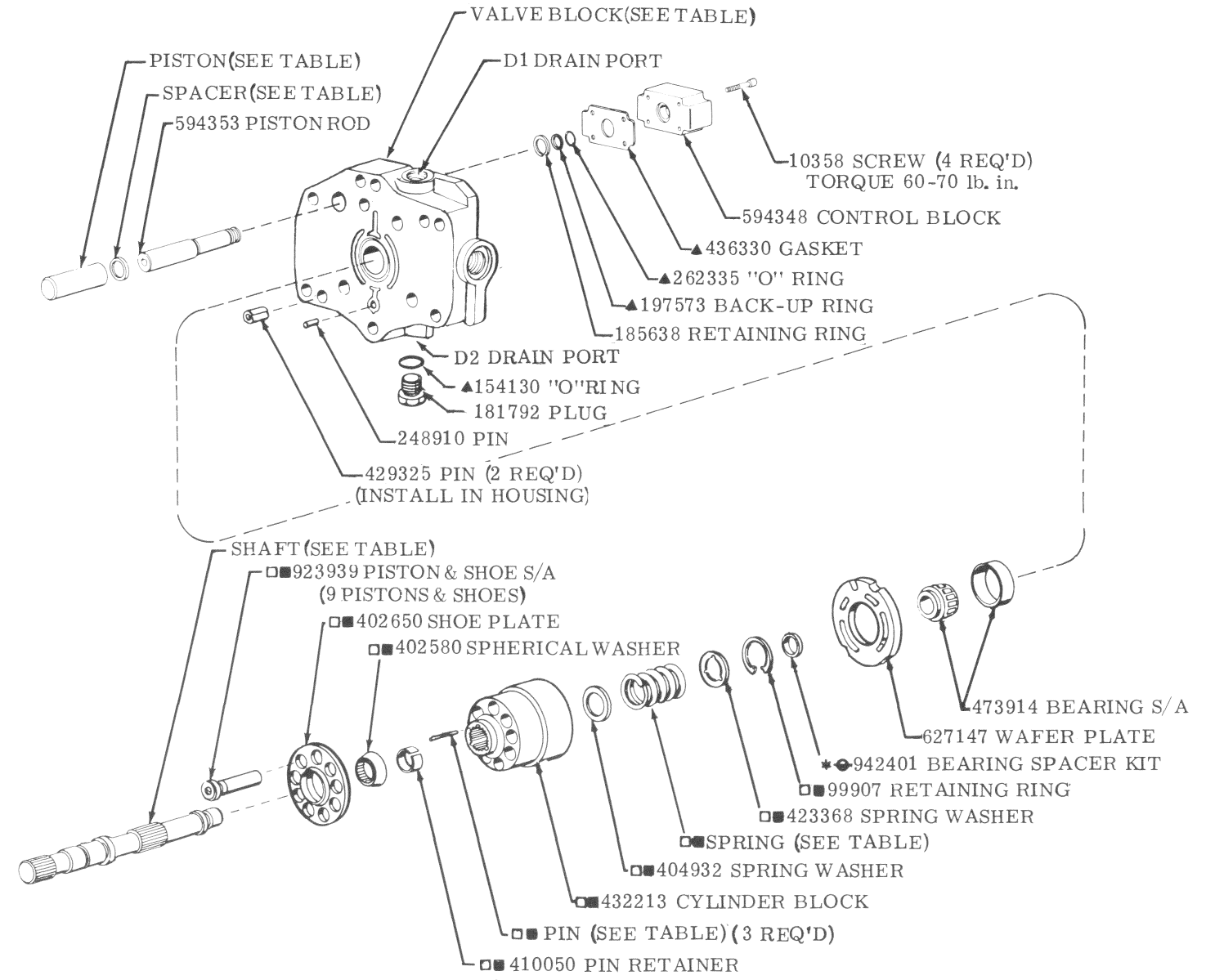
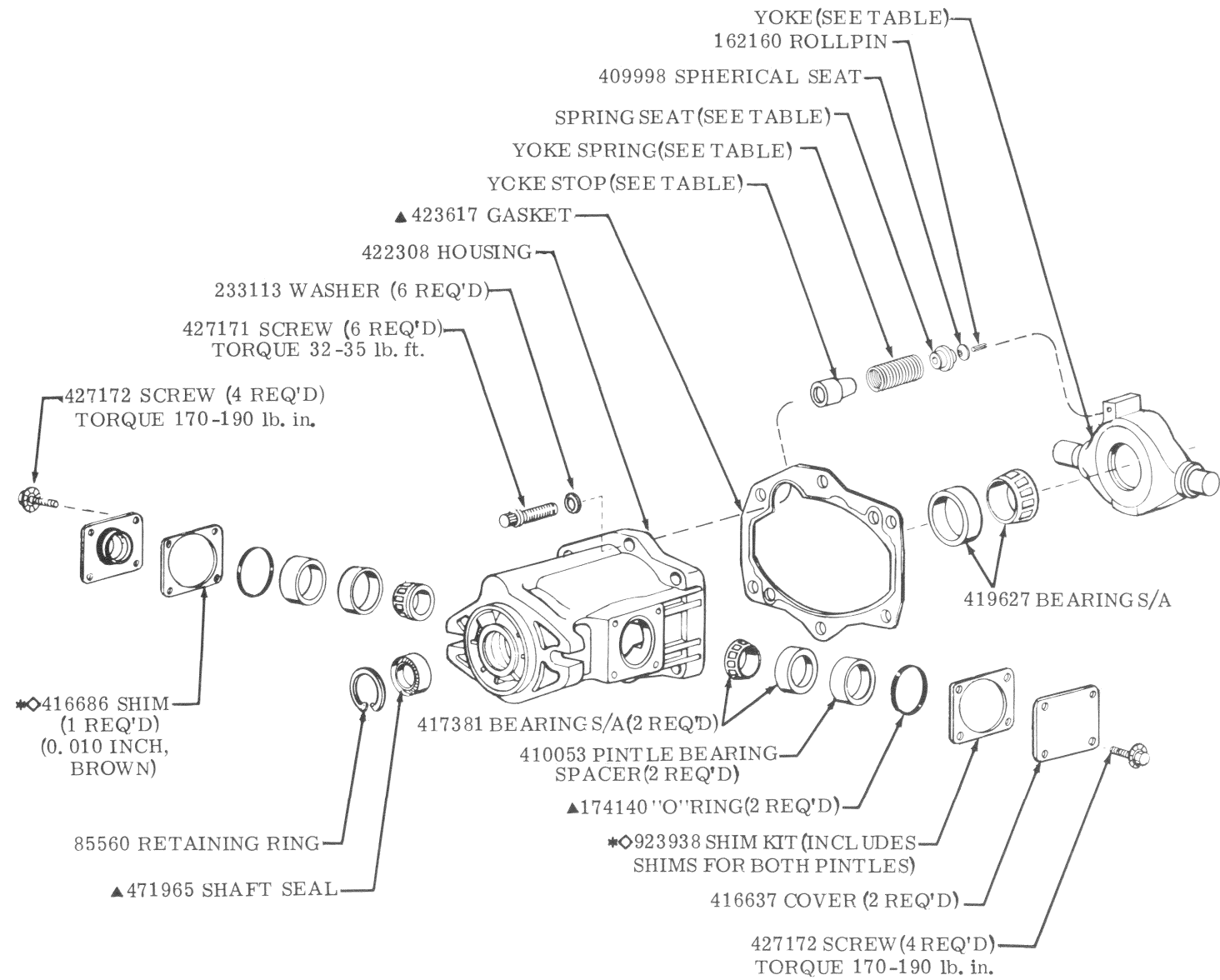

MODEL	SHAFT	SAE SHAFT TYPE
MVE19-2	423415	B-B SPLINED
MVE19-9	424544	B SPLINED

*NOTE
REFER TO OVERHAUL MANUAL
M-2844-S FOR SHAFT END PLAY
AND PINTLE BEARING PRELOAD
SHIMMING PROCEDURE.

