

10 SAE rated capacity (V10 cover end cartridge)

USgpm	○ Rotor	○ Vane Kit (12 vanes)	○ Ring	Pin (V10S)	Pin (V10F/V10P)	Bolt (V10S)	Bolt (V10F)	Bolt (V10P)	○ Cartridge Kit
1			317674						923471
2	317681	923499	317675	2456	2456	11156	295344	295344	923470
3			317676						923496
4			317677						923469
5	351247	923500	317678	16662	16662	1278	432511	432511	923468
6			355641						923497
7	357286	923501	331813	179341	179341	432509	295346	295346	923498

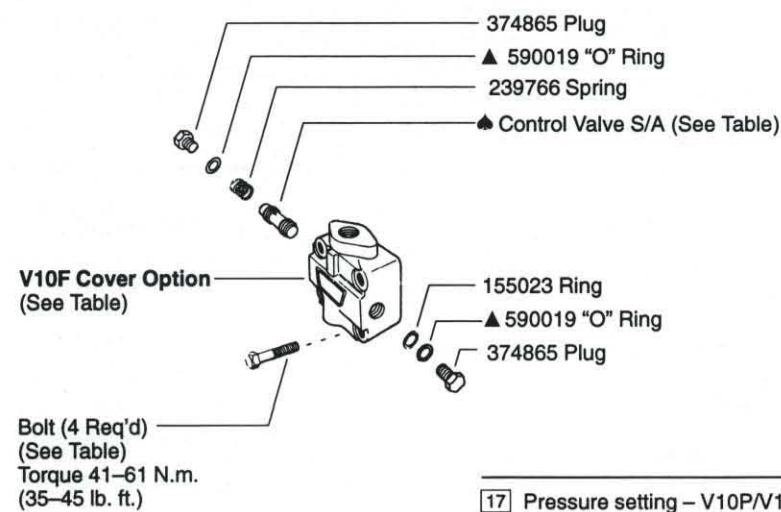
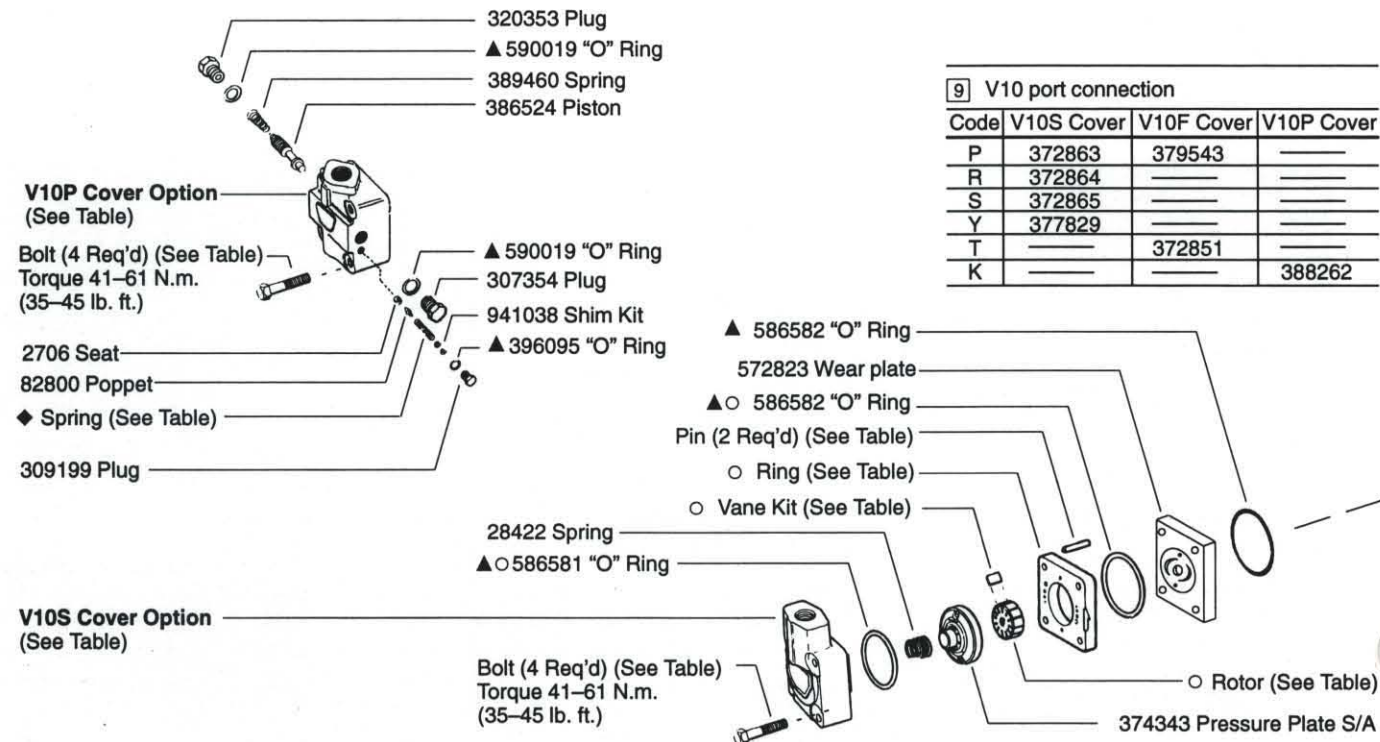

17 Pressure setting - V10P/V10F (Omit for V10S)

Code	Pressure setting V10P/V10F	◆ V10P Spring	▲ V10F control valve S/A
A	250 psi	252886	229613
B	500 psi	2280	233018
C	750 psi		232794
D	1000 psi	2282	232795
E	1250 psi		232796
F	1500 psi		232797
G	1750 psi	2281	232798
H	2000 psi		232799
J	2250 psi		233019
K	2500 psi		233020

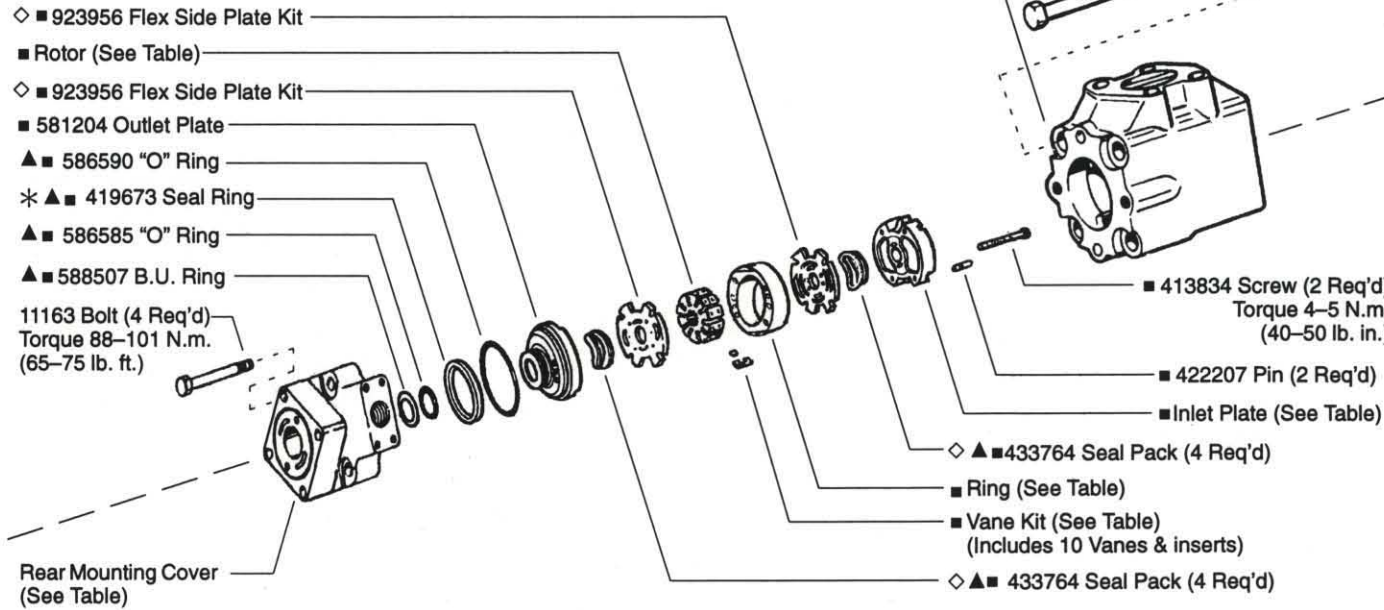

8 SAE rated capacity (\*\*25 VQ center cartridge)

USgpm	Ring	Inlet Plate	Rotor	Vane Kit	F3 Cart. Kit
12	326984				581851
14	326985				581852
17	326986	419080	270597	922710	581853
19	326987				581854
21	326988				581855

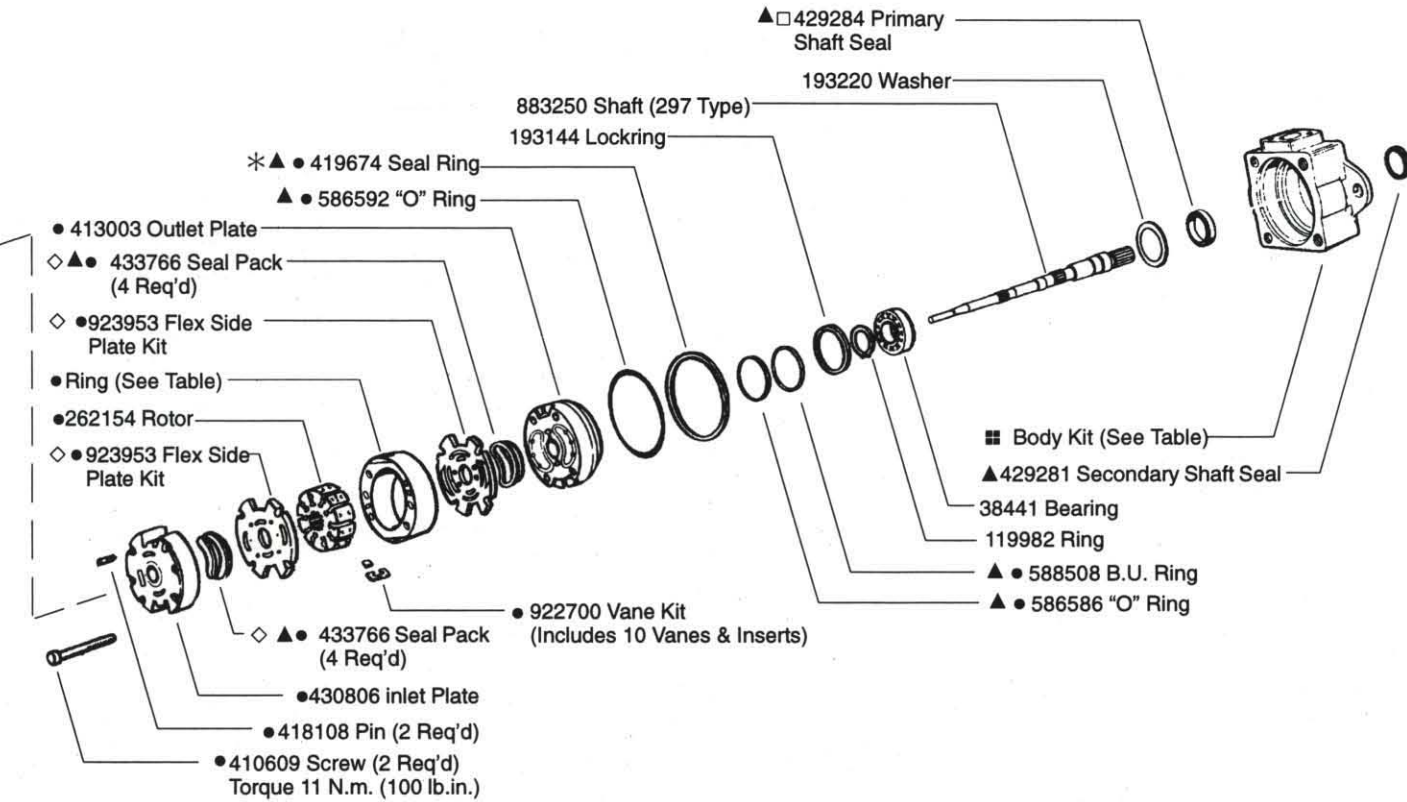

6 SAE rated capacity (35\*\*VQ shaft end cartridge)

USgpm	Ring	F3 Cart. Kit
21	394961	421582
25	319396	421583
30	319397	421584
35	319398	421585
38	319399	421586

7 Port connections

Connection Type	Body Kit	Inlet Cover	Rear Mounting Cover
A - 4 Bolt Flange (Inch)	02-136919	230189	581863
AM - 4 Bolt Flange (Metric)	02-136920	995239	995240

NOTE: Body kit includes body, ball, and plug. (Ball and plug not shown)

- Included in 35\*\* VQ shaft end cartridge kit.
- Included in \*\*25 VQ center cartridge kit.
- Included in V10 cover end cartridge kit.
- ▲ Included in seal kit 920170. (Kit contains F3 components & both shaft seals.)
- ◇ Included in flex side plate kit; bronze face of plate must be installed toward the rotor. Kit also contains four seal packs.
- Assemble seal with spring loaded sealing member towards bearing. Seals to be completely wetted with oil prior to assembly.
- \* Install 419674 & 419673 sealing ring into body, then install cartridge kit.



# Model Code

**(F3) - 3525VQ S V10 \* - \* \* \* \* - \* \* \* \* \* - 20 \***

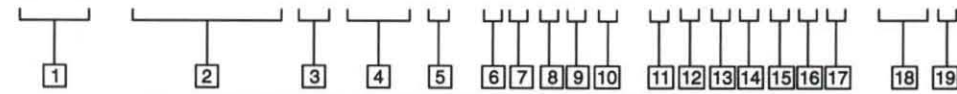

<b>1 Special seals</b> F3 - Viton "O" Rings and shaft seals	<b>9 V10 port connections</b> V10S standard covers and outlet # 3 <b>Code</b> S - .750-16 Str. thd. P - 1/2" - NPT thd. Y - .875-14 Str. thd. R - 1.062-12 Str. thd.	<b>14 Port orientation (Outlet #2)</b> (Viewed from cover end of pump; refer to table on next page)
<b>2 Pump series designation</b> 35**VQ - Shaft end pump **25VQ - Center pump	<b>V10F flow/relief control cover</b> <b>Code</b> Outlet # 3 Tank port T - .750-16 Str. thd. .750-16 Str. thd. P - .750-16 Str. thd. 1/2" - NPT thd.	<b>15 Port orientation (Outlet #3 or primary outlet)</b> (Viewed from cover end of pump; refer to table on next page)
<b>3 Body mounting flange</b> S - SAE mounting per J-744 101-2	<b>V10P priority control covers</b> Primary port Secondary port Tank port <b>Code</b> Str. thd. Str. thd. Str. thd. K - .5625-18 .750-16 .5625-18	<b>16 Controlled flow rate, V10F &amp; V10P (Omit for standard cover)</b> <b>Code</b> <b>Code</b> 3 - 3 USgpm 6 - 6 USgpm 4 - 4 USgpm 7 - 7 USgpm 5 - 5 USgpm 8 - 8 USgpm
<b>4 Pump series designation</b> V10 cover end pump	<b>V10P relief valve pressure setting, V10F &amp; V10P (Omit for standard cover)</b> <b>Code</b> <b>Code</b> A - 250 psi F - 1500 psi B - 500 psi G - 1750 psi C - 750 psi H - 2000 psi D - 1000 psi J - 2250 psi E - 1250 psi K - 2500 psi	<b>17 Relief valve pressure setting, V10F &amp; V10P (Omit for standard cover)</b> <b>Code</b> <b>Code</b> A - 250 psi F - 1500 psi B - 500 psi G - 1750 psi C - 750 psi H - 2000 psi D - 1000 psi J - 2250 psi E - 1250 psi K - 2500 psi
<b>5 V10 pump cover options</b> S - Standard cover F - Flow control and relief cover P - Priority valve and relief cover	<b>10 SAE rated capacity (V10 cover end cartridge)</b> <b>Code</b> <b>Code</b> 1 - 1 USgpm 5 - 5 USgpm 2 - 2 USgpm 6 - 6 USgpm 3 - 3 USgpm 7 - 7 USgpm 4 - 4 USgpm	<b>18 Design</b> (Subject to change)
<b>6 SAE rated capacity (VQ shaft - end cartridge)</b> <b>Code</b> <b>Code</b> 21 - 21 USgpm 35 - 35 USgpm 25 - 25 USgpm 38 - 38 USgpm 30 - 30 USgpm	<b>11 Shaft seal</b> Blank - Single seal S - Double seal	<b>19 Rotation (Viewed from shaft end of pump)</b> L - Left hand for counterclockwise R - Right hand for clockwise
<b>7 VQ port connections (inlet &amp; outlet #1 &amp; #2)</b> A - 4 bolt flange (inch threads) AM - 4 bolt flange (metric threads)	<b>12 Shaft type</b> 297 - All series	
<b>8 Rated capacity (VQ center cartridge)</b> <b>Code</b> <b>Code</b> 12 - 12 USgpm 19 - 19 USgpm 14 - 14 USgpm 21 - 21 USgpm 17 - 17 USgpm	<b>13 Port orientation (Outlet #1)</b> (Viewed from cover end of pump; refer to table on next page)	

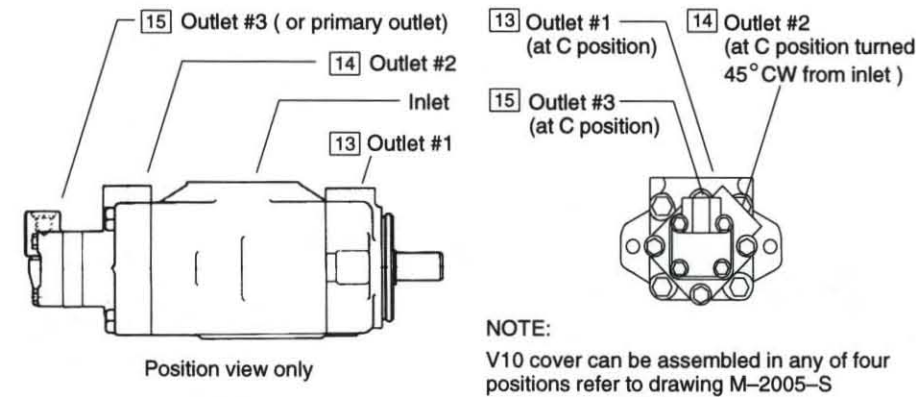

NOTE:  
V10 cover can be assembled in any of four positions refer to drawing M-2005-S

Port orientation code (Viewed from cover end of pump)			
Outlet	13 #1	14 #2	15 #3
Opposite inlet	A	A	A
135° CCW from inlet		A	
90° CCW from inlet	B		B
45° CCW from inlet		B	
Inline with inlet	C		C
45° CW from inlet		C	
90° CW from inlet	D		D
135° CW from inlet		D	

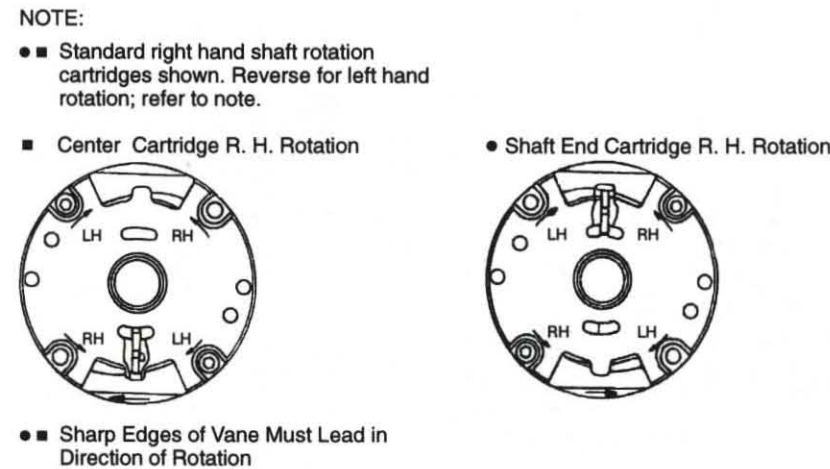

NOTE:  
 • To reverse cartridge kit rotation, remove the two screws and reverse the location of the inlet support plate and the outlet support plate. Reinstall the two screws hand tight. Use pump cover to align all sections of the cartridge. Carefully remove the cover and tighten the screws.  
 • When ordering spare cartridge parts, it is recommended they be obtained in cartridge kits. Kits are assembled and tested for either right or left hand rotation. If left hand rotation is required, it should be specified on parts order by adding suffix "L" to cartridge kit number.

# Service Data



## Vane Type Triple Pump

(F3)-3525VQSV10\*-\*\*\*\*\*-\*\*\*\*\*-20\*

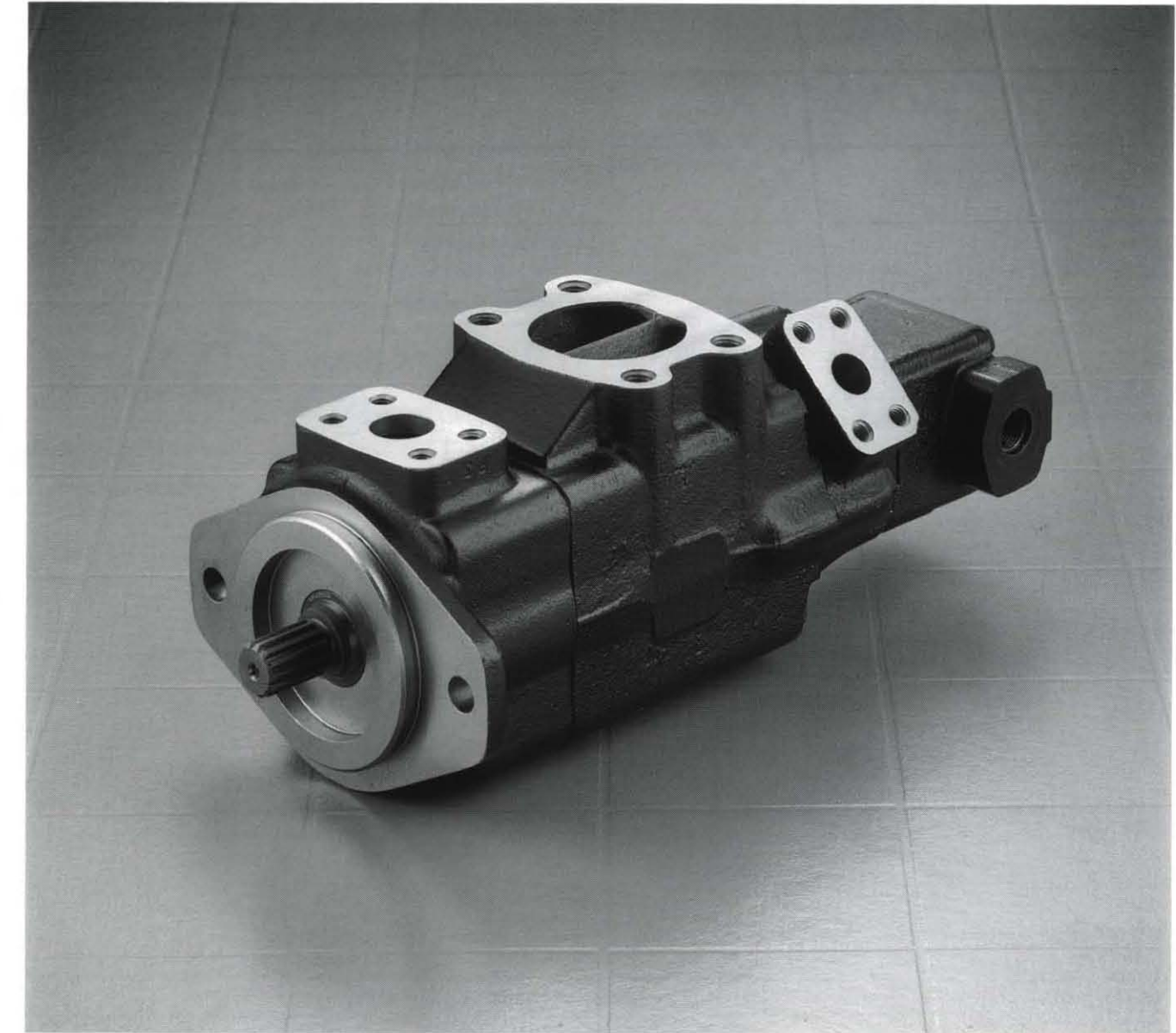

Vickers Incorporated  
5445 Corporate Drive  
P. O. Box 302  
Troy, Michigan 48007-0302  
U.S.A.