

10 SAE rated capacity (V10 cover end cartridge)									
USgpm	○ Rotor	○ Vane Kit (12 vanes)	○ Ring	Pin (V10S)	Pin (V10F/V10P)	Bolt (V10S)	Bolt (V10F)	Bolt (V10P)	○ Cartridge Kit
1			317674						923471
2	317681	923499	317675	2456	2456	11156	295344	295344	923470
3			317676						923496
4			317677						923469
5	351247	923500	317678	16662	16662	1278	432511	432511	923468
6			355641						923497
7	357286	923501	331813	179341	179341	432509	295346	295346	923498

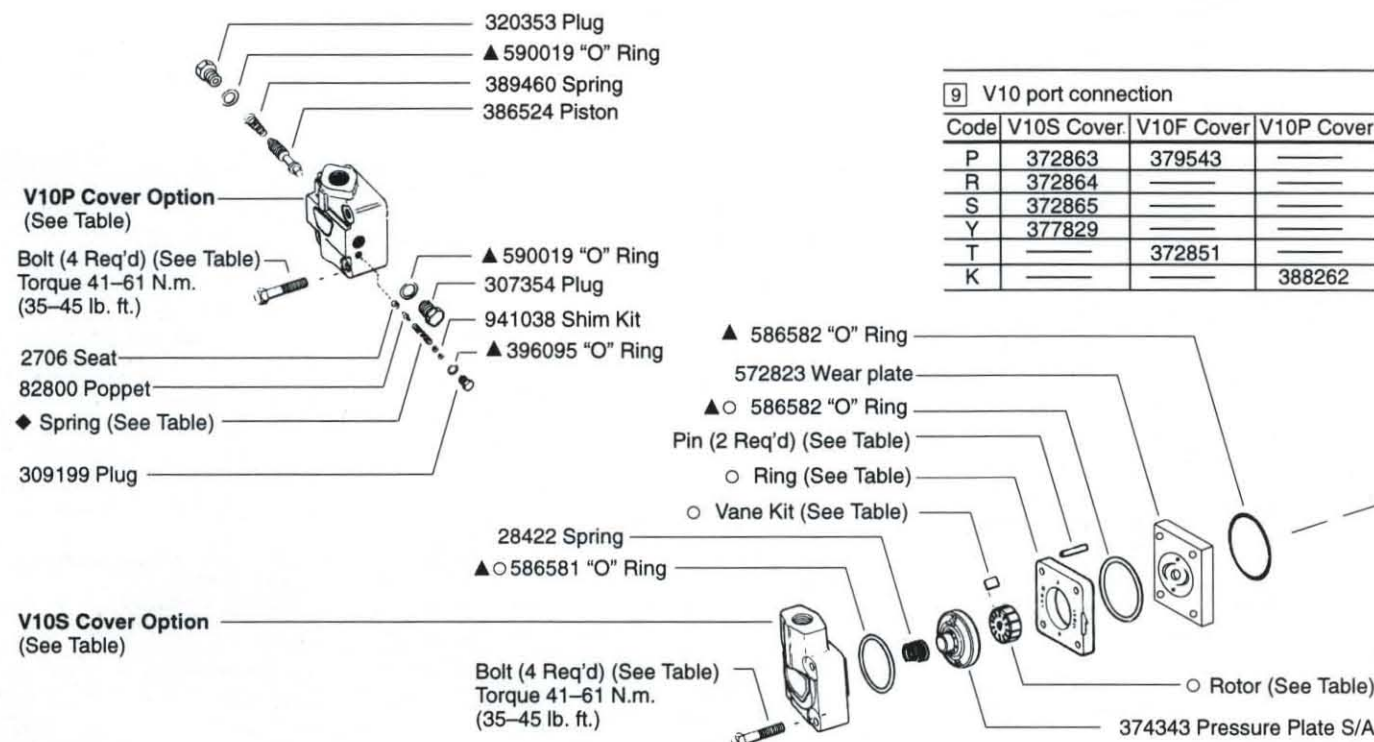

9 V10 port connection			
Code	V10S Cover	V10F Cover	V10P Cover
P	372863	379543	
R	372864		
S	372865		
Y	377829		
T		372851	
K			388262

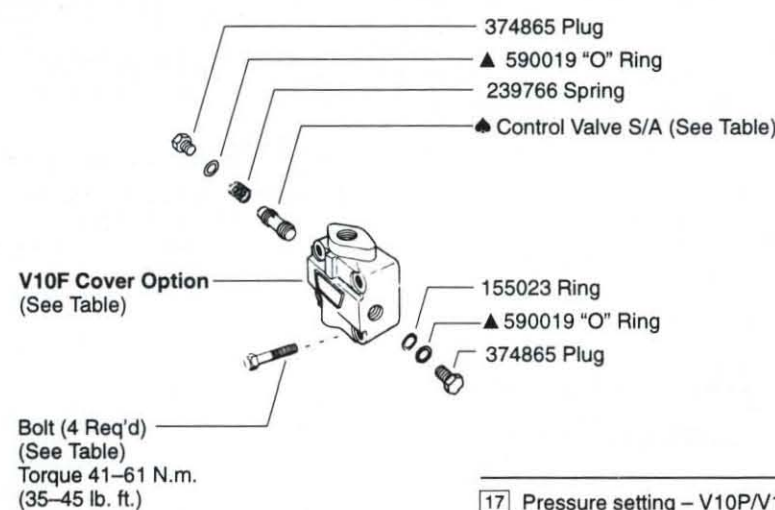

17 Pressure setting - V10P/V10F (Omit for V10S)			
Code	Pressure setting V10P/V10F	◆ V10P Spring	▲ V10F control valve S/A
A	250 psi	252886	229613
B	500 psi	2280	233018
C	750 psi		232794
D	1000 psi	2282	232795
E	1250 psi		232796
F	1500 psi		232797
G	1750 psi	2281	232798
H	2000 psi		232799
J	2250 psi		233019
K	2500 psi		233020

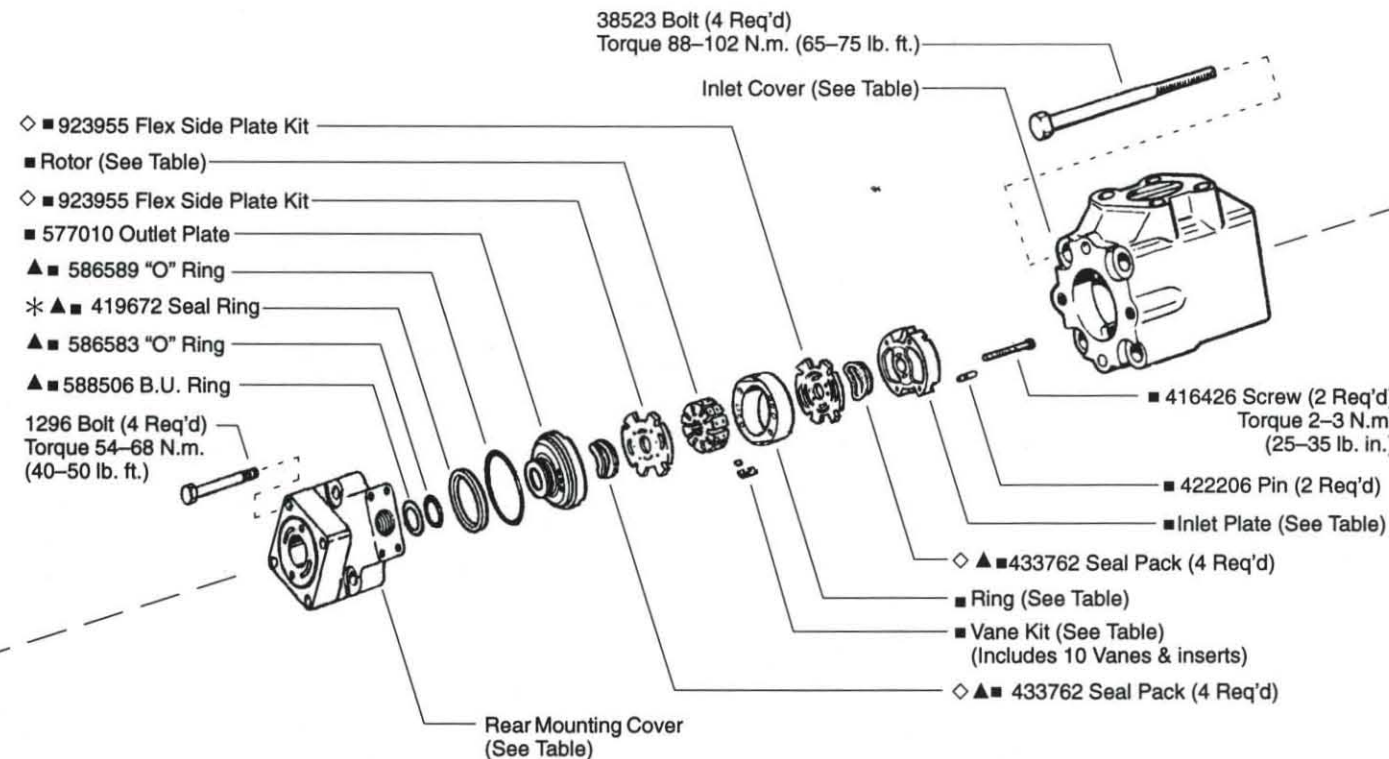

8 SAE rated capacity (**20 VQ center cartridge)					
USgpm	Ring	Inlet Plate	Rotor	Vane Kit	F3 Cart. Kit
5	333624				574918
8	333625	419502	402690	922741	574920
9	374799				574921
11	333626				574922
12	353901	419501	403539	922745	574923
14	353902				574924

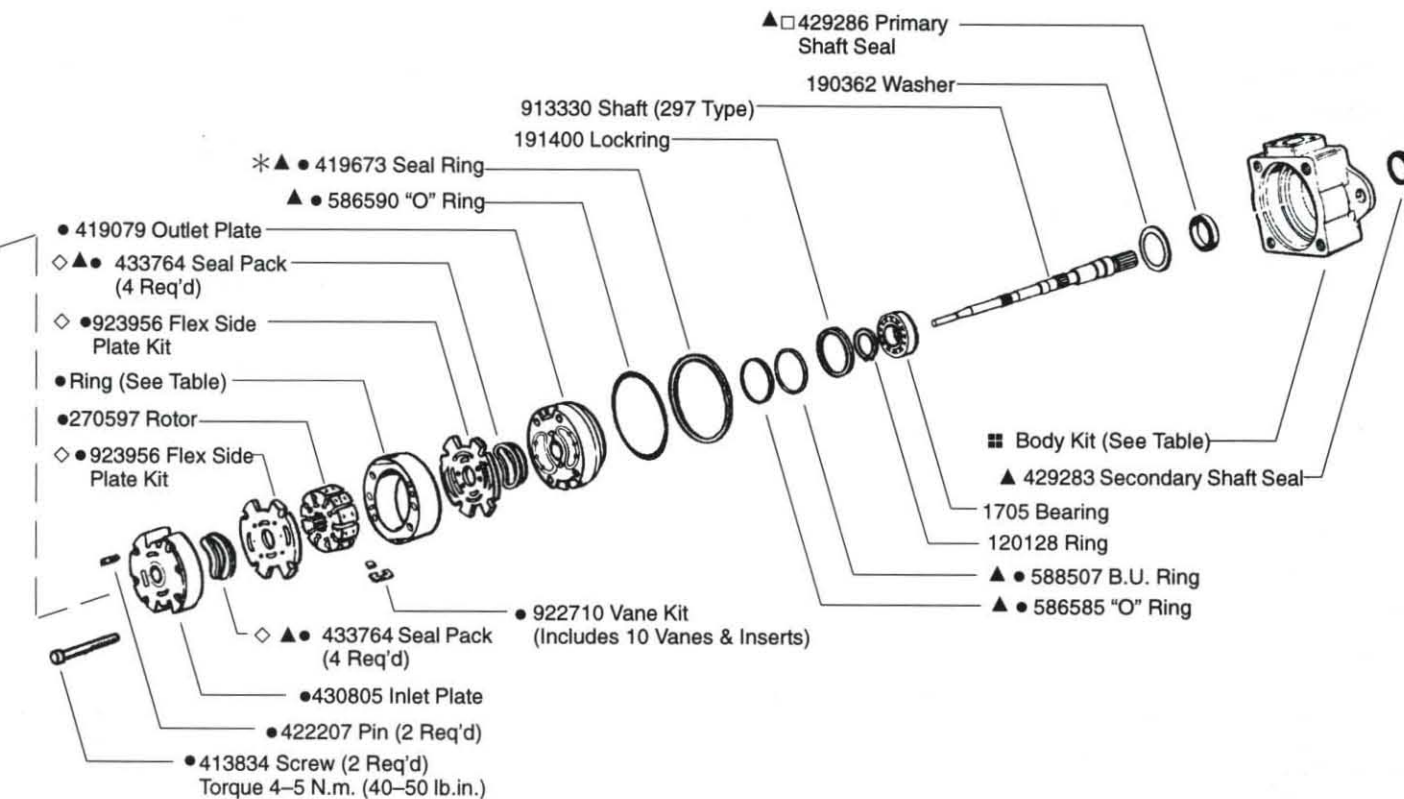

6 SAE rated capacity (25**VQ shaft end cartridge)		
USgpm	Ring	F3 Cart. Kit
10	326989	02-125589
12	326984	421570
14	326985	421571
16	424084	578174
17	326986	421572
19	326987	421573
21	326988	421574

- Included in 25** VQ shaft end cartridge kit.
- Included in **20 VQ center cartridge kit.
- Included in V10 cover end cartridge kit.
- ▲ Included in seal kit 920166. (Kit contains F3 components & both shaft seals.)
- ◇ Included in flex side plate kit; bronze face of plate must be installed toward the rotor. Kit also contains four seal packs.
- Assemble seal with spring loaded sealing member towards bearing. Seals to be completely wetted with oil prior to assembly.
- * Install 419673 & 419672 sealing ring into body, then install cartridge kit.

7 Port connections			
Connection Type	Body Kit	Inlet Cover	Rear Mounting Cover
A - 4 Bolt Flange (Inch)	02-136915	251263	572822
AM - 4 Bolt Flange (Metric)	02-136916	478505	860778

NOTE: Body kit includes body, ball, and plug. (Ball and plug not shown)

