

Model Code

(F3) - V 2010 * - * (*) F * S * S - 1 ** - 12 (L)

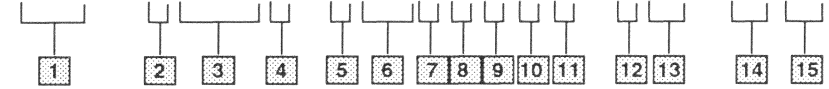

1 Special seals

2 Vane pump

3 Series designation

4 Cover type

F - Flow control cover
P - Priority valve cover
Omit - Standard cover

5 Mounting

1 - Flange, 2 bolt SAE B size
2 - Foot bracket
6 - Flange, 2 bolt SAE A size

6 Foot bracket

(Mounting position with respect to inlet port when viewed from shaft end. No code required for inlet port at 12 o'clock)

3 - Inlet port at 3 o'clock
6 - Inlet port at 6 o'clock
9 - Inlet port at 9 o'clock
Omitted for flange mounting

7 Inlet port

F - 4 bolt flange, 1.500 dia.

8 Ring capacity (Shaft end)

(Rated capacity (USgpm) at 1200 rpm, 6.9 bar (100 psi))

7 - 7 gpm 11 - 11 gpm
8 - 8 gpm 12 - 12 gpm
9 - 9 gpm 13 - 13 gpm

9 No. 1 outlet port (Shaft end)

S - 1.062 - 12 UN-2B thread

10 Ring capacity (Cover end)

(Rated capacity (USgpm) at 1200 rpm, 6.9 bar (100 psi))

1 - 1 gpm 4 - 4 gpm 7 - 7 gpm
2 - 2 gpm 5 - 5 gpm
3 - 3 gpm 6 - 6 gpm

11 No. 2 outlet port (Cover end)

Code	Std. cover	Flow control cover	
		Pressure	Tank
P	1/2 NPT Thd.	3/4-16 St.Thd.	1/2 NPT Thd.
R	1.062-12 St.Thd.	_____	_____
S	3/4-16 St.Thd.	_____	_____
T	_____	3/4-16 St.Thd.	3/4-16 St.Thd.

12 Shaft type

1 - Straight thread
3 - Threaded
11 - Splined

13 Outlet port orientation

(Viewed from cover end of pump)

With no. 1 outlet opposite inlet

AA - No. 2 outlet 135° CCW from inlet
AB - No. 2 outlet 45° CCW from inlet
AC - No. 2 outlet 45° CW from inlet
AD - No. 2 outlet 135° CW from inlet

With no. 1 outlet 90° CCW from inlet

BA - No. 2 outlet 135° CCW from inlet
BB - No. 2 outlet 45° CCW from inlet
BC - No. 2 outlet 45° CW from inlet
BD - No. 2 outlet 135° CW from inlet

With no. 1 outlet inline with inlet

CA - No. 2 outlet 135° CCW from inlet
CB - No. 2 outlet 45° CCW from inlet
CC - No. 2 outlet 45° CW from inlet
CD - No. 2 outlet 135° CW from inlet

With no. 1 outlet 90° CW from inlet

DA - No. 2 outlet 135° CCW from inlet
DB - No. 2 outlet 45° CCW from inlet
DC - No. 2 outlet 45° CW from inlet
DD - No. 2 outlet 135° CW from inlet

14 Design

15 Rotation

(Viewed from shaft end of pump)

L - Left hand (counterclockwise)
Omit - Right hand (clockwise)

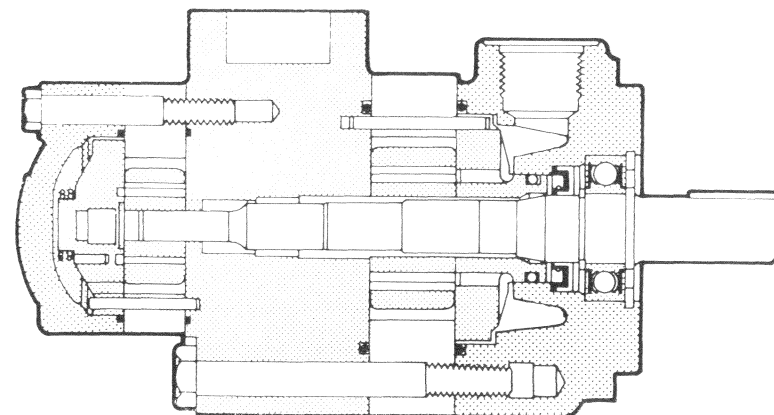

Typical sectional view

Service Data



Double Vane Type Pump

(F3)-V2010*-*(*)F*S*S-1**-12(L)

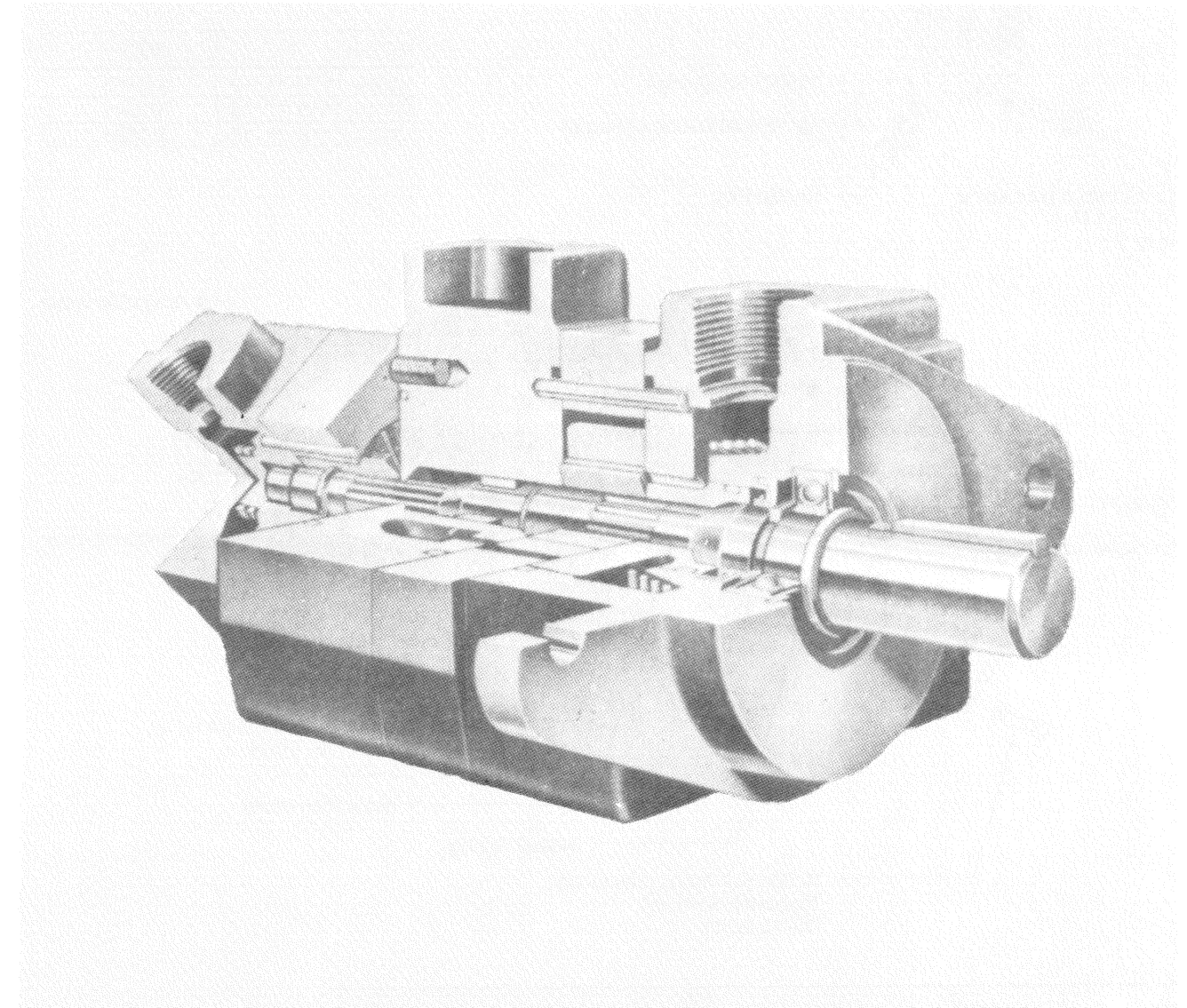

Vickers Incorporated
A TRINOVA Company
5445 Corporate Drive
P. O. Box 302
Troy, Michigan 48007-0302
U.S.A.

MODEL	◇ COVER
V2010F-*****T-**2	372851
V2010F-*****P-**2	379543

MODEL	CONTROL VALVE SUB-ASSEMBLY	PRESSURE SETTING
V2010F-*****-***-A	229613	250 psi
V2010F-*****-***-B	233018	500 psi
V2010F-*****-***-C	232794	750 psi
V2010F-*****-***-D	232795	1000 psi
V2010F-*****-***-E	232796	1250 psi
V2010F-*****-***-F	232797	1500 psi
V2010F-*****-***-G	232798	1750 psi
V2010F-*****-***-H	232799	2000 psi
V2010F-*****-***-J	233019	2250 psi
V2010F-*****-***-K	233020	2500 psi

MODEL	□ SCREW
V2010F-****1	432509
V2010F-****2	
V2010F-****3	
V2010F-****4	295344
V2010F-****5	432511
V2010F-****6	
V2010F-****7	

MODEL	SHAFT	KEY	NUT	TYPE
V2010-*****-1**-12	351249	9955		Straight
V2010-*****-3**-12	321214	1617	18755	Threaded
V2010-*****-11**-12	321215			Splined

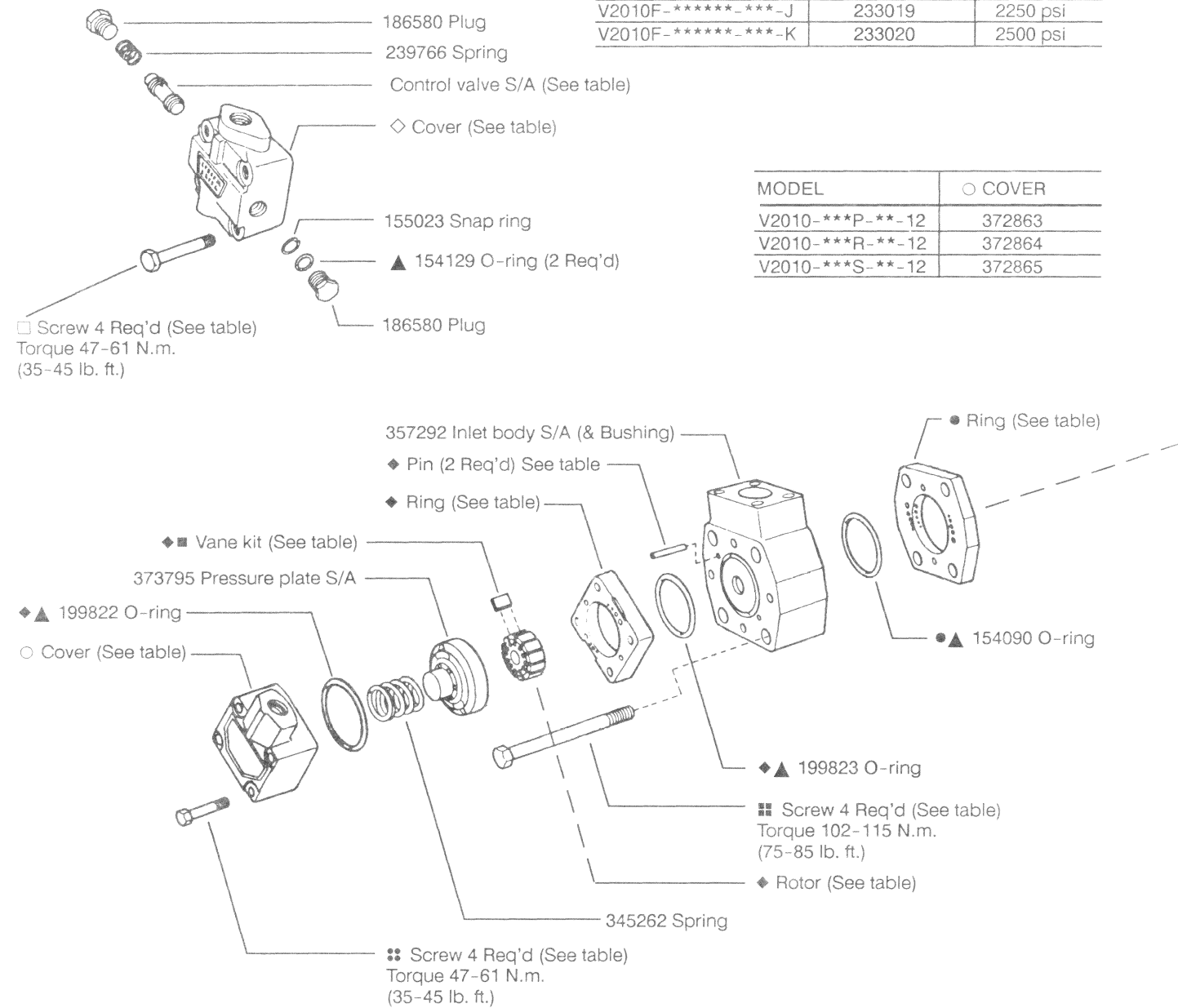

MODEL	◆ SCREW	◆ ROTOR	◆ VANE KIT	◆ PIN	◆ RING	◆ CART. KIT
V2010-****1	1277	317681	923499	231042	317674	923471
V2010-****2					317675	923470
V2010-****3					317676	923496
V2010-****4	108561	351247	923500	2456	317677	923469
V2010-****5	1278	357286	923501	351963	317678	923468
V2010-****6					355641	923497
V2010-****7					331813	923498

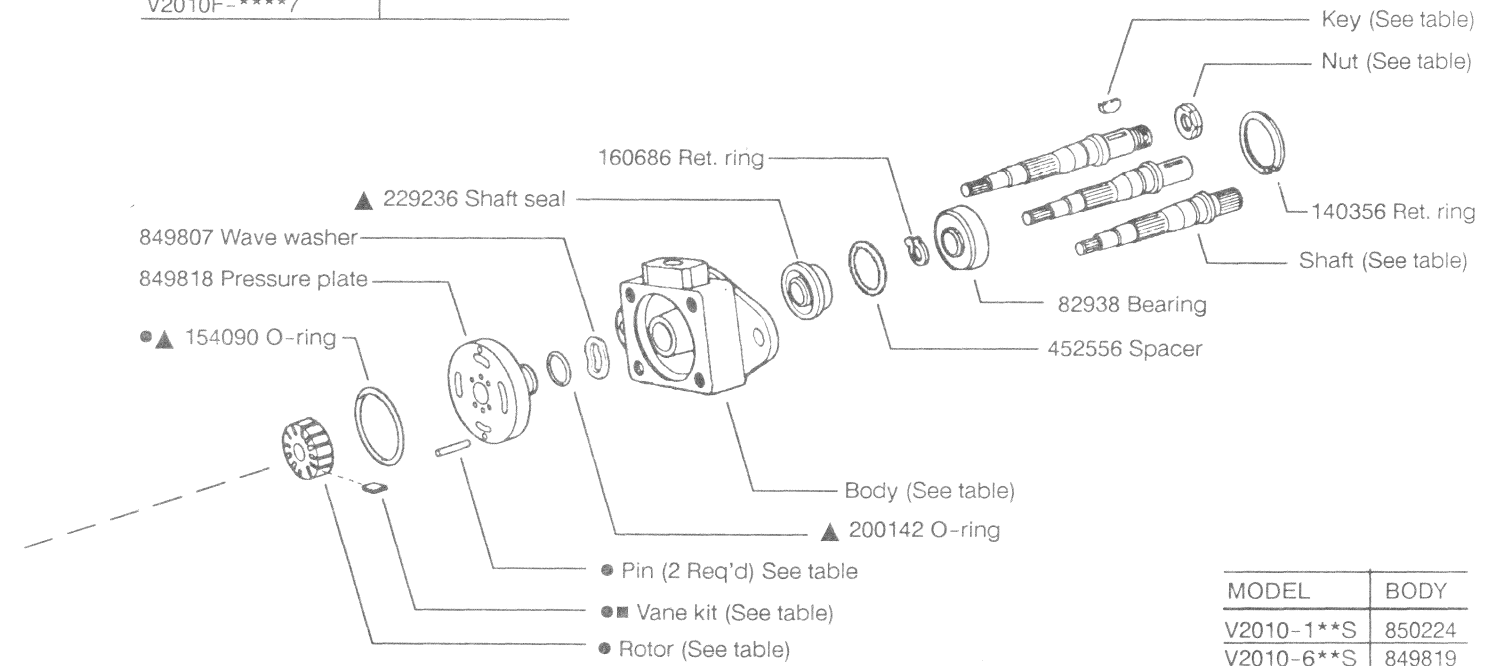

MODEL	BODY
V2010-1**S	850224
V2010-6**S	849819

MODEL	◆ SCREW	● ROTOR	◆ VANE KIT	● PIN	● RING	● CART. KIT
V2010-**5**	9431	388286	923485	2456	388284	02-141745
V2010-**6**					328150	02-141746
V2010-**7**					328152	923494
V2010-**8**	96168	358335	923493	16662	331791	923495
V2010-**9**					331789	923462
V2010-**11**	295384	358336	923478	179341	328156	923475
V2010-**12**					331806	923476
V2010-**13**					331807	923477

- ▲ Included in seal kit 923577
F3 equivalent seal kit 919770
- Shaft end cartridge kit (See table)
- ◆ Cover end cartridge kit (See table)
- ◆ Vane kit (includes 12 vanes) See table

NOTE:
For satisfactory service life of these components in industrial applications, use full flow filtration to provide fluid which meets ISO cleanliness code 16/13 or cleaner. OFP, OFR, and OFRS series filters are recommended.