

MODEL CODE BREAKDOWN

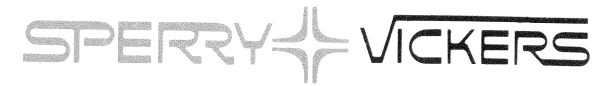

(F3)-V2010 *-*(*)F*S*S-1-10(L)**

SEALS
F3 - VITON
OMITTED - BUNA N

VANE PUMP

SERIES

F - FLOW CONTROL COVER
P - PRIORITY VALVE COVER

MOUNTING
1 - FLANGE
2 - FOOT
BRACKET

FOOT BRACKET
MOUNTING POSITION WITH
RESPECT TO INLET PORT
WHEN VIEWED FROM SHAFT
END. NO CODE REQUIRED
FOR INLET PORT AT 12
O'CLOCK.
3 - INLET PORT AT 3 O'CLOCK
6 - INLET PORT AT 6 O'CLOCK
9 - INLET PORT AT 9 O'CLOCK
OMITTED FOR FLANGE
MOUNTING

INLET PORT
F - 4 BOLT FLANGE
1.500 DIA.

RING CAPACITY - SHAFT END
(USGPM AT 1200 RPM & 100 PSI)
7 - 7 9 - 9 12 - 12
8 - 8 11 - 11 13 - 13

NO. 1 OUTLET PORT (SHAFT END)
S - 1.062 - 12 UN-2B THREAD

SHAFT ROTATION
L - LEFT HAND
(OMITTED FOR
RIGHT HAND)

DESIGN

OUTLET POSITIONS VIEWED FROM COVER END		
#1 OUTLET	#2 OUTLET	
OPPOSITE INLET	AA	135° CCW FROM INLET
	AB	45° CCW FROM INLET
	AC	45° CW FROM INLET
	AD	135° CW FROM INLET
90° CCW FROM INLET	BA	135° CCW FROM INLET
	BB	45° CCW FROM INLET
	BC	45° CW FROM INLET
	BD	135° CW FROM INLET
INLINE WITH INLET	CA	135° CCW FROM INLET
	CB	45° CCW FROM INLET
	CC	45° CW FROM INLET
	CD	135° CW FROM INLET
90° CW FROM INLET	DA	135° CCW FROM INLET
	DB	45° CCW FROM INLET
	DC	45° CW FROM INLET
	DD	135° CW FROM INLET

SHAFT TYPE
1 - STRAIGHT THD.
3 - THREADED
11 - SPLINED

NO. 2 OUTLET PORT (COVER END)

CODE	STD COVER	FLOW CONTROL COVER	
		PRESSURE	TANK
P	1/2 IN. NPT THD	3/4-16 ST. THD.	1/2 IN NPT THD
R	1.062-12 ST. THD	—	—
S	3/4-16 ST. THD	—	—
T	—	3/4-16 ST. THD.	3/4-16 ST THD

RING CAPACITY - COVER END
(USGPM AT 1200 RPM & 100 PSI)
1 - 1 3 - 3 5 - 5
2 - 2 4 - 4 6 - 6
7 - 7

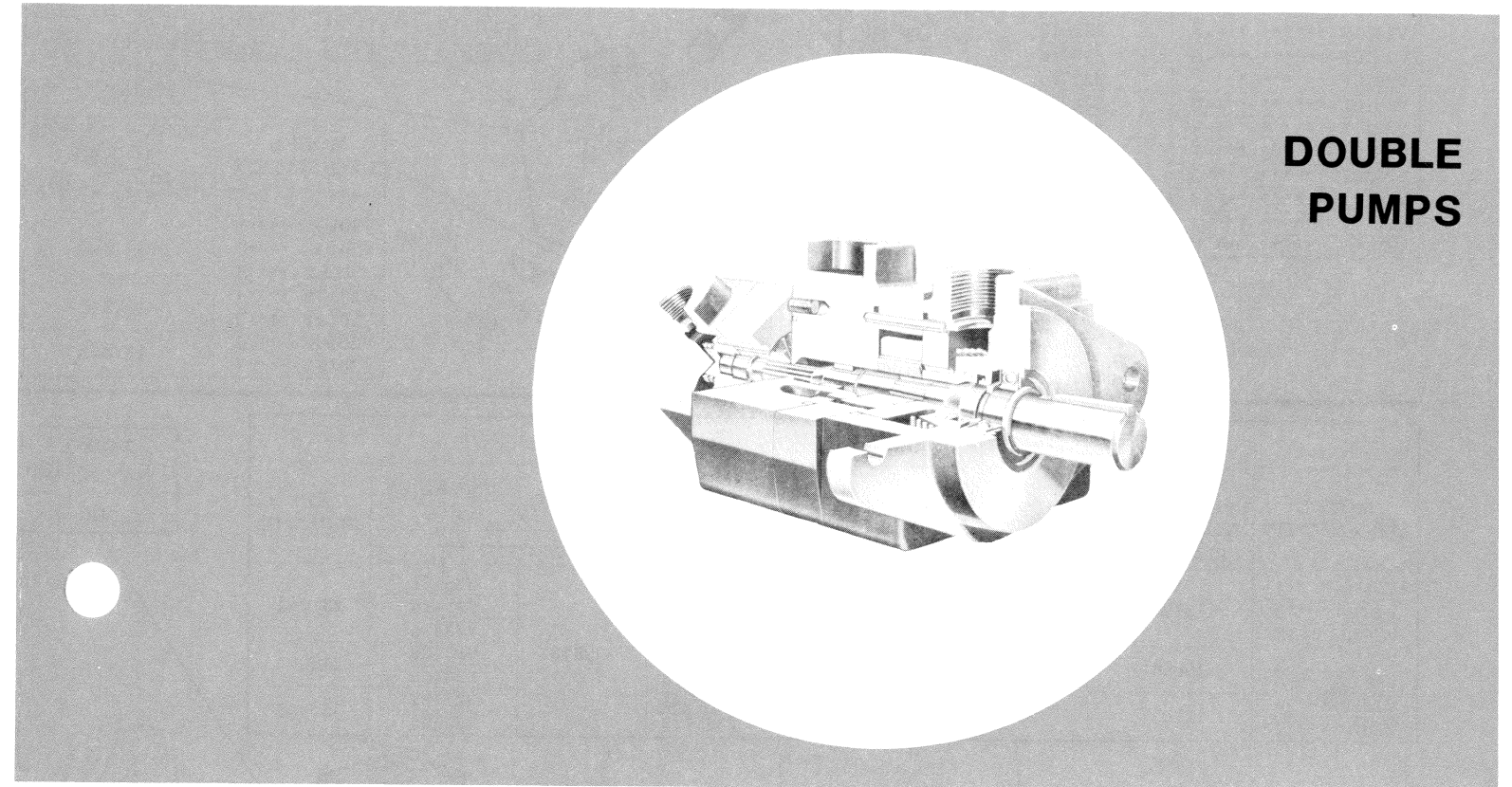

SERVICE PARTS INFORMATION

V2010 AND V2010F SERIES - 10 DESIGN

To insure sustained efficiency and maximum trouble-free life of this precision equipment, initial and continuous filtration of the fluid medium to 25 microns absolute or less is essential. (For information pertaining to Sperry Vickers economical 3 or 10 micron filters, see installation drawing 522140.)

Litho in U. S. A.

SPERRY VICKERS
TROY, MI. 48084

Revised 1-1-80

M-2253-S

V2010F-*****-****-20
FLOW CONTROL COVER

MODEL DESIGNATION	CONTROL VALVE SUB-ASSEMBLY	PRESSURE SETTING
V2010F-*****-****-A	229613	250 PSI
V2010F-*****-****-B	233018	500 PSI
V2010F-*****-****-C	232794	750 PSI
V2010F-*****-****-D	232795	1000 PSI
V2010F-*****-****-E	232796	1250 PSI
V2010F-*****-****-F	232797	1500 PSI
V2010F-*****-****-G	232798	1750 PSI
V2010F-*****-****-H	232799	2000 PSI
V2010F-*****-****-J	233019	2250 PSI
V2010F-*****-****-K	233020	2500 PSI

MODEL DESIGNATION	COVER
V2010F-*****T-**2	372851
V2010F-*****T-**3	372852
V2010F-*****T-**4	372853
V2010F-*****T-**5	372854
V2010F-*****T-**6	372855
V2010F-*****T-**7	372856

MODEL DESIGNATION	GPM	COVER
V2010F-*****P-**2	379543	
V2010F-*****P-**3	379545	
V2010F-*****P-**4	376605	
V2010F-*****P-**5	379547	
V2010F-*****P-**6	379549	
V2010F-*****P-**7	379551	

MODEL DESIGNATION	SCREW (4 REQ'D) TORQUE 40 ± 5 lb. ft.
V2010F-****1	1278-B
V2010F-****2	
V2010F-****3	
V2010F-****4	1278-C
V2010F-****5	
V2010F-****6	
V2010F-****7	1278-A

MODEL DESIGNATION	TYPE	RET. RING	BEARING	SHAFT	KEY	NUT	RET. RING
V2010-*****-1**10	STRAIGHT			351249	9955		
V2010-*****-3**10	THREADED	160686	82938	321214	1617	18755	140356
V2010-*****-11**10	SPLINED			321215			

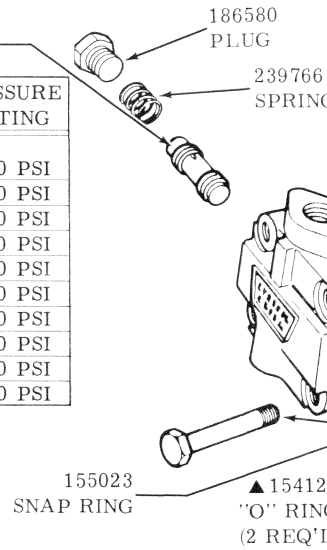

MODEL DESIGNATION	SCREW (4 REQ'D) TORQUE TO 40 ± 5 lb. ft.	COVER END - ROTATING GROUP						PIN (2 REQ'D)
		▲"O" RING	ROTOR	VANE KIT (12 VANES)	RING	▲"O" RING	CARTRIDGE KIT	
V2010-****1	1277	199822	317681	923499	317674	199823	923471	231042
V2010-****2				317675	923470			
V2010-****3				317676	923496			
V2010-****4	108561		351247	923500	317677	923469	2456	
V2010-****5			317678	923468				
V2010-****6	1278		357286	923501	355641	923497	351963	
V2010-****7					331813	923498		

MODEL DESIGNATION	BODY S. A. AND BUSHING
V2010-*F	357292

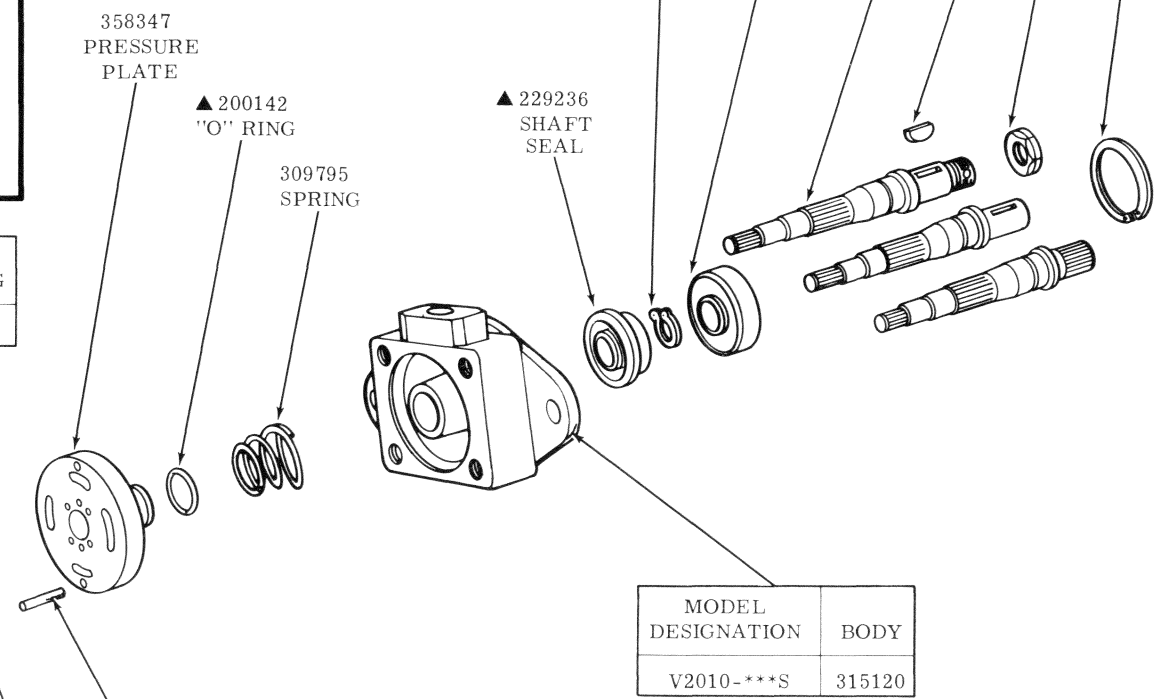

MODEL DESIGNATION	BODY
V2010-***S	315120

WARNING: USE THIS DRAWING FOR PARTS INFORMATION ONLY.

SCREW (4 REQ'D) TORQUE TO 80 ± 5 lb. ft.	RING	ROTOR	VANE KIT (12 VANES)	"O" RING (2 REQ'D)	CARTRIDGE KIT	PIN (2 REQ'D)	MODEL DESIGNATION
96168	328152	358335	923493	▲154090	923494	16662	V2010-**7**
	331791				923495		V2010-**8**
	331789				923462		V2010-**9**
9430	328156	358337	923478	▲154090	923475	179341	V2010-**11**
	331806				923476		V2010-**12**
	331807				923477		V2010-**13**

COVER	MODEL
372863	V2010-***P-**-10
372864	V2010-***R-**-10
372865	V2010-***S-**-10

▲INCLUDED IN 923577 SEAL KIT
F3 EQUIVALENT SEAL KIT 919770

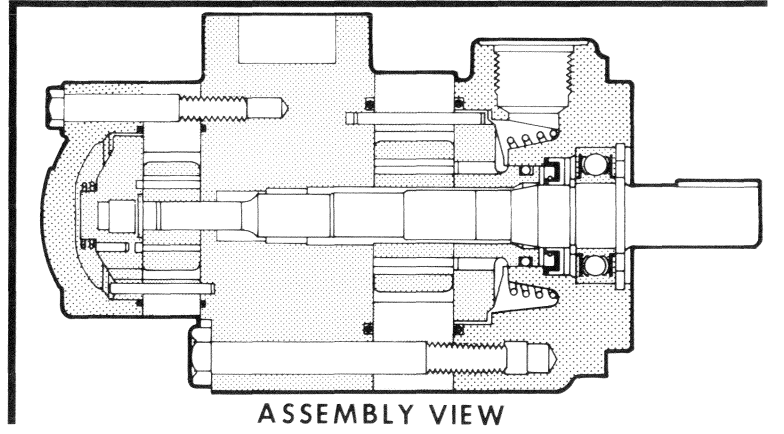

ASSEMBLY VIEW