

### MODEL CODE BREAKDOWN

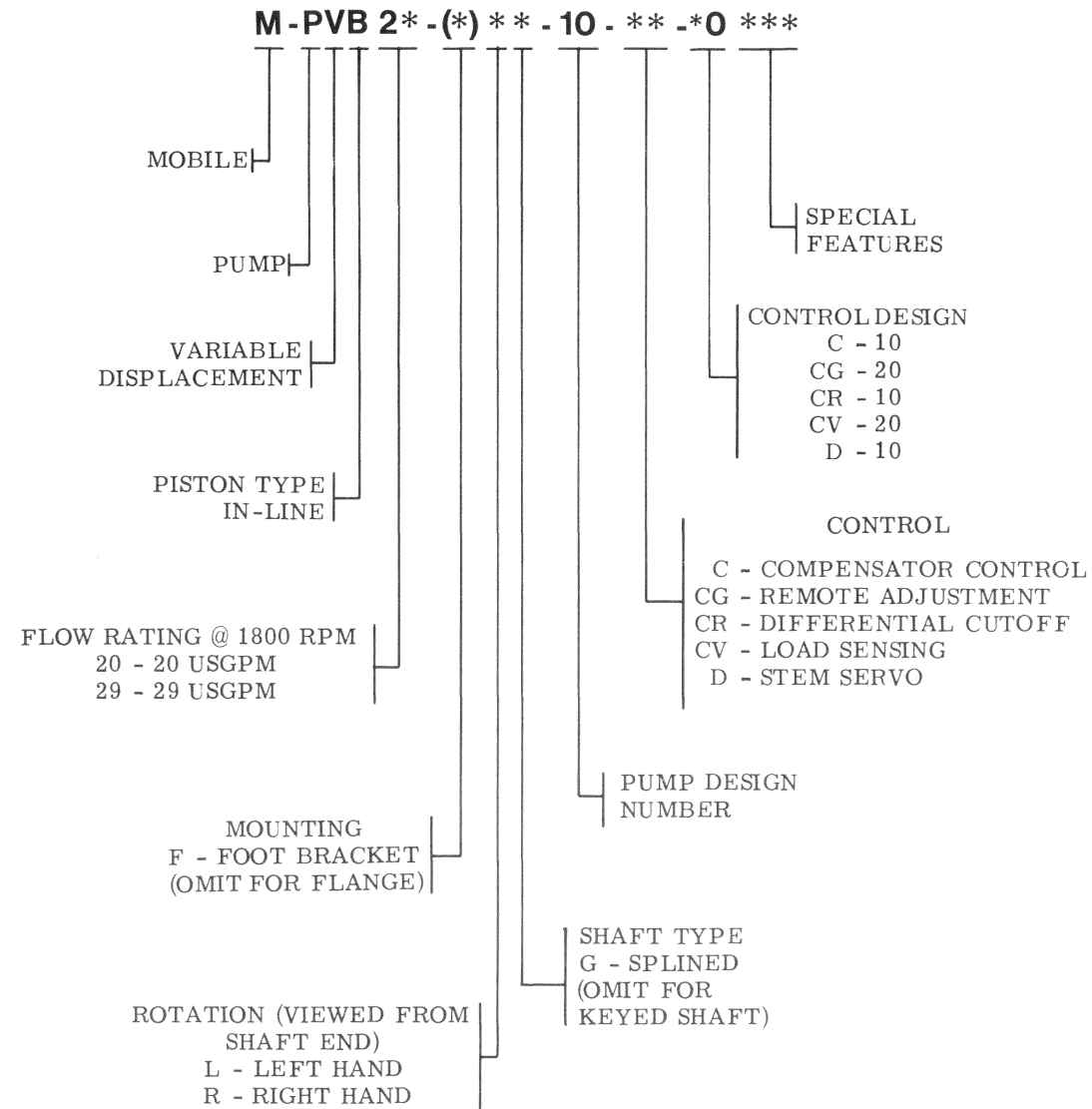

## Variable Inline Piston Pump

M-PVB20 -10 Design  
M-PVB29 -10 Design

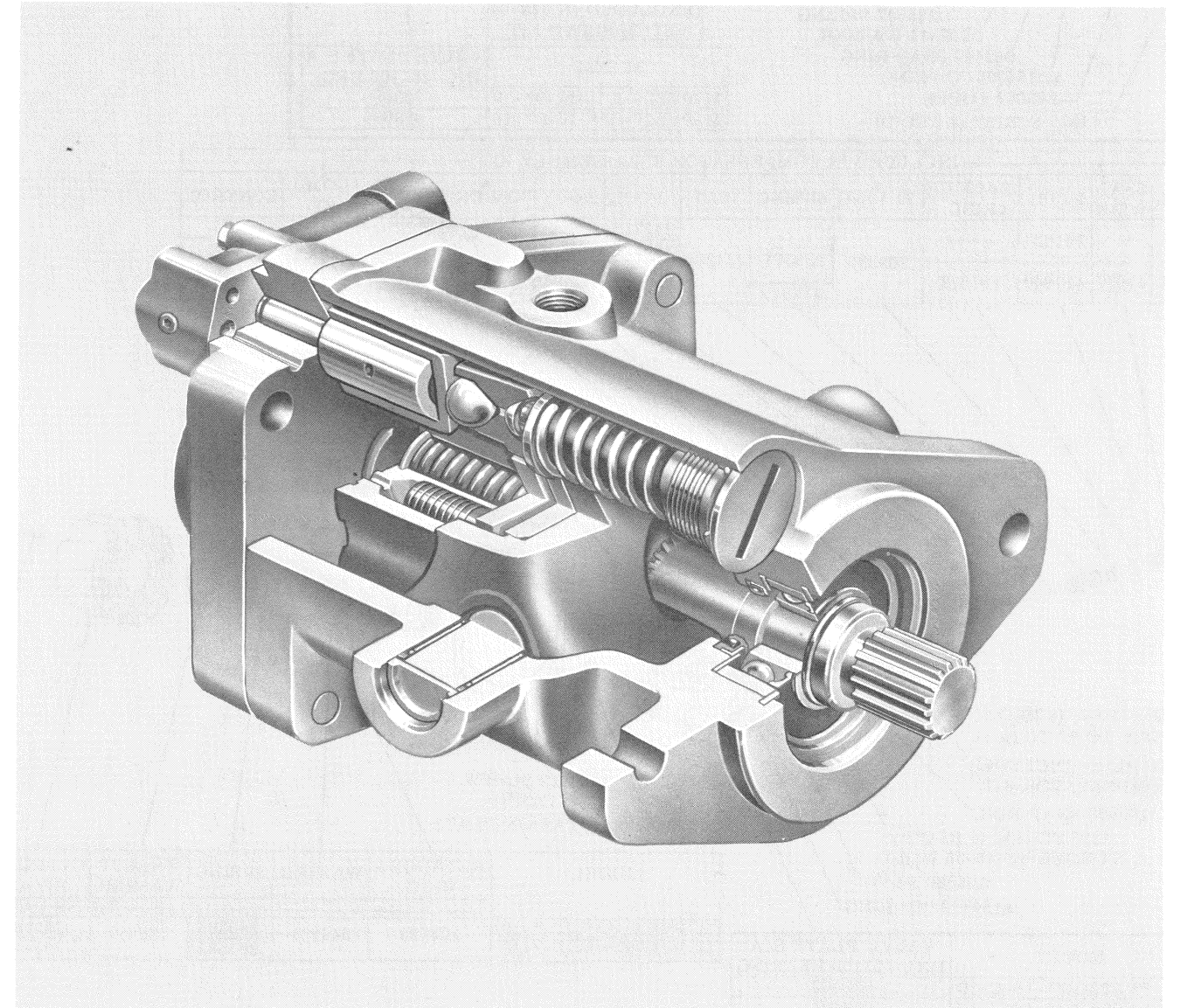

For satisfactory service life of these components, use full flow filtration to provide fluid which meets ISO cleanliness code 16/13 or cleaner. Selections from Vickers OFP, OFR, and OFRS series are recommended.

Litho in U. S. A.

Vickers Incorporated  
A TRINOVA Company  
5445 Corporate Drive  
P. O. Box 302  
Troy, Michigan 48007-0302  
U.S.A.

**WARNING: USE THIS DRAWING FOR PARTS INFORMATION ONLY. SEE OVERHAUL MANUAL M-2200-S FOR MAINTENANCE INFORMATION**

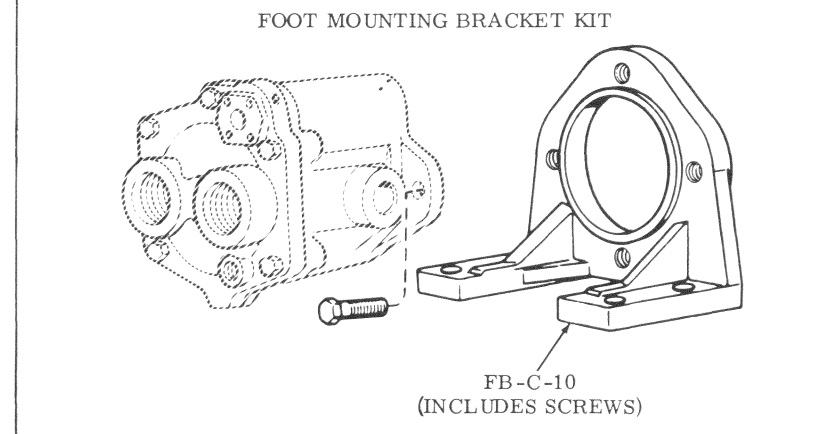
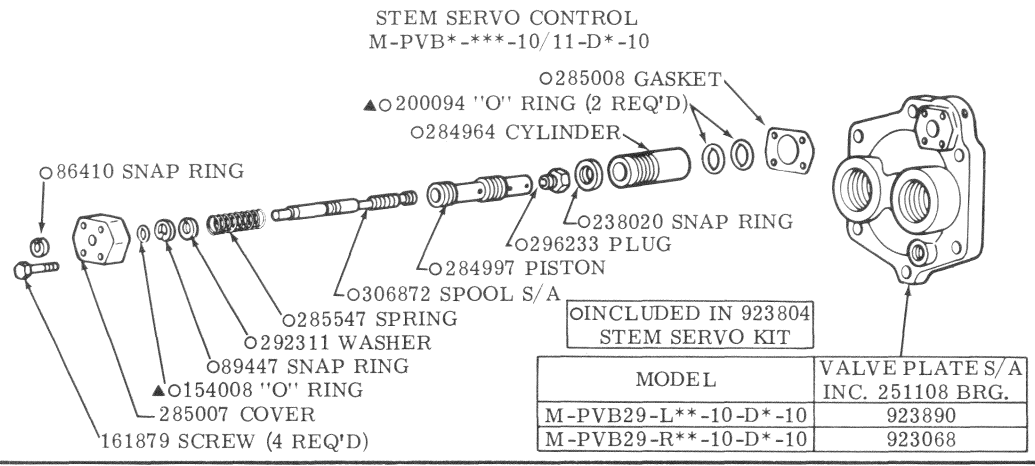

INCLUDED IN COMPENSATOR SUBASSEMBLY KIT

SEAL	SEAL WIRE	PLUG	BACK UP ▲RING	"O" RING	SPRING	SEAT	SPOOL	BODY	"O" RING	GASKET	COMP. KIT	CONTROL
		241621		262335	239371	234204	241717 285624 296234 278711	241568 412890	154005	244956	941700 923990 942480 942441	C CR CG CV
17079	17077	412940	197573		417649							

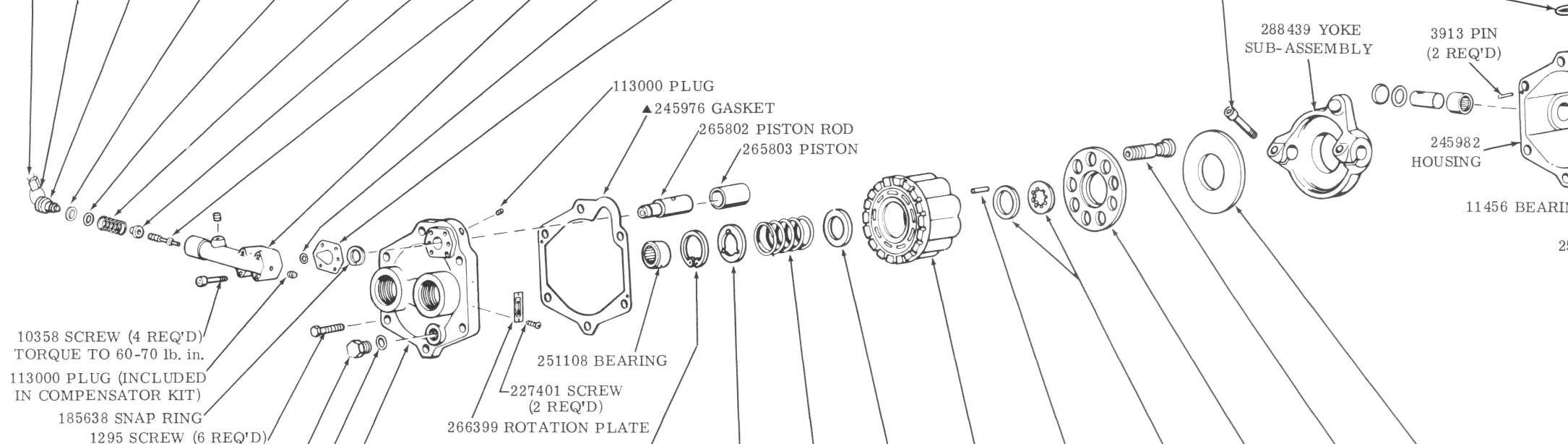

SEAT	SPRING	PLUG	MODEL
245975	436335	245973	M-PVB2*-***-11-C/CG-*0
306370	306434	306369	M-PVB2*-***-11-CR-10
245975	436335	245973	M-PVB2*-***-11-CV/D-*0

MODEL	SHAFT	KEY
M-PVB*-***-10-*10	245979	246353
M-PVB*-***G-10-*10	282880	

MODEL	RETAINING RING	WASHER	SPRING	THRUST WASHER	CYLINDER BLOCK	PIN (3 REQ'D)	SPHERICAL WASHERS/A	SHOE PLATE	PISTON KIT (9 PISTONS)	SWASH PLATE	ROTATING GROUP KIT
M-PVB20-***-10-*10	194025	244931	246386	238780	250688	248835	938392	248609	941883	239335	938280
M-PVB29-***-10-*10			263582		259458				941888		938290

THESE PARTS INCLUDED IN ROTATING GROUP KIT

MODEL	VALVE PLATE S/A INC. 251108 BEARING
M-PVB20-R**-10-C-10	938400
M-PVB20-L**-10-C-10	938401
M-PVB29-R**-10-C-10	938404
M-PVB29-L**-10-C-10	938405

