

Maximum Adjustable Stop - S

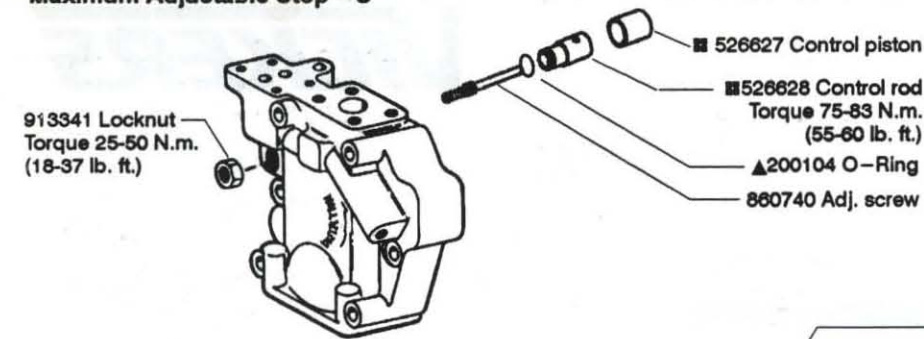

Torque Limiter - CT

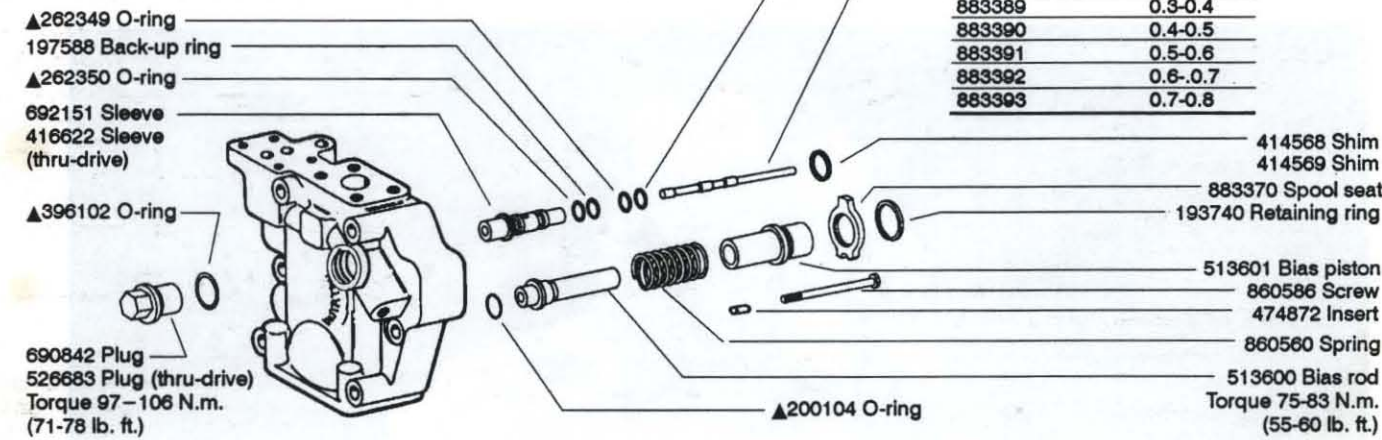

Load Sensing - C/CM/CMV

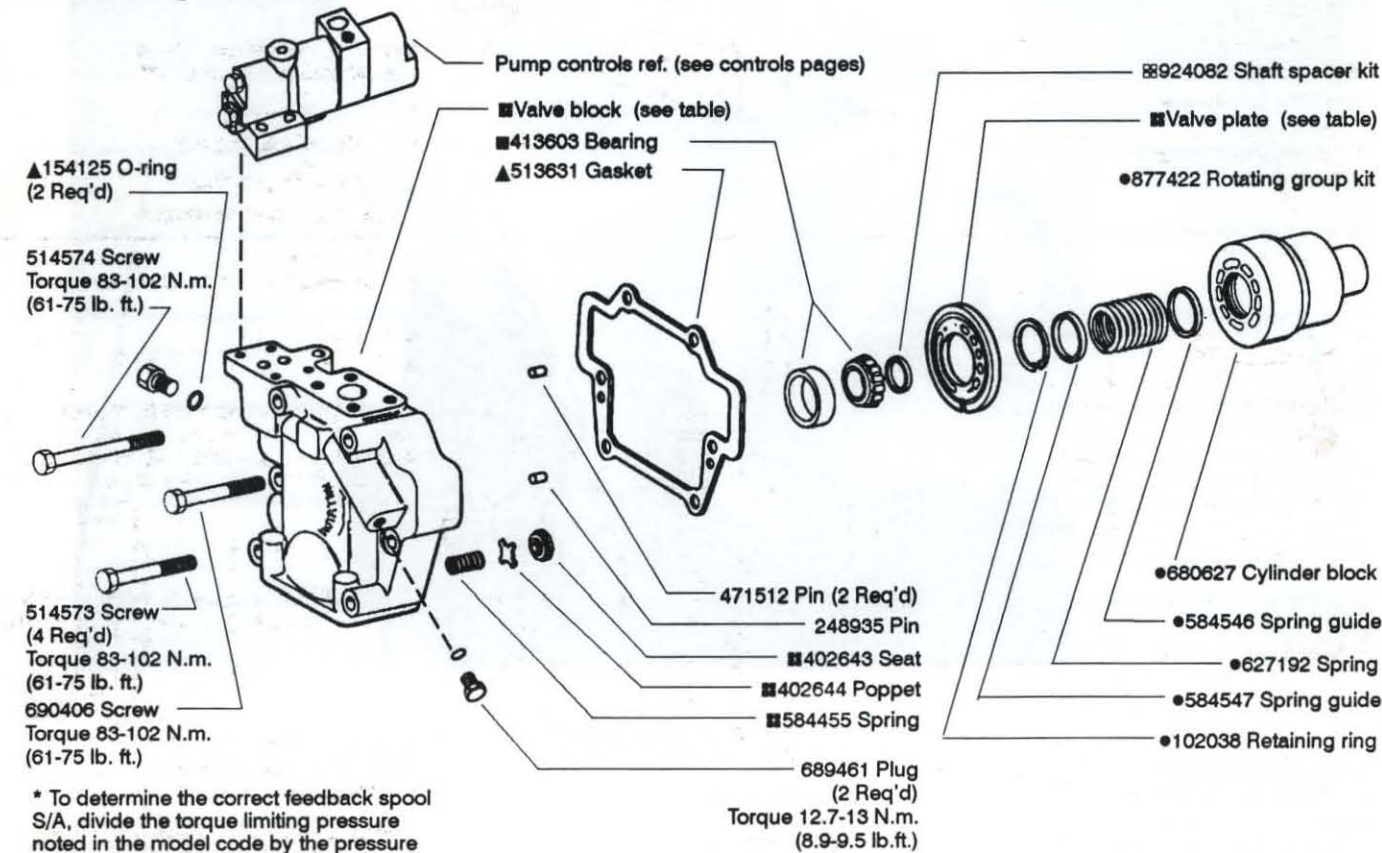

* To determine the correct feedback spool S/A, divide the torque limiting pressure noted in the model code by the pressure limiting control cracking pressure (i.e. T/C=Ratio). On a dual level pressure limiting control, use the high level pressure in this calculation.

Model designation	Valve Block	Valve Plate
98C-LF-10-C*	513632	584540
98C-LM-10-C*	864279	
98C-RF-10-C*	513603	627371
98C-RM-10-C*	864258	
98C-LF-10-CT	513635	584540
98C-LM-10-CT	860523	
98C-RF-10-CT	860524	627371
98C-RM-10-CT	860525	
98C-LSF-10-C	860798	584540
98C-LSM-10-C	860799	
98C-RSF-10-C	860790	627371
98C-RSM-10-C	860791	
98QIC-LF-10-C*	513632	514120
98QIC-RF-10-C*	513603	514122

Shaft	Type	Key
527167	1 - Str. keyed	114516
864453	3 - Str. keyed thru	
513627	2 - Splined	
864454	13 - Splined thru	140282

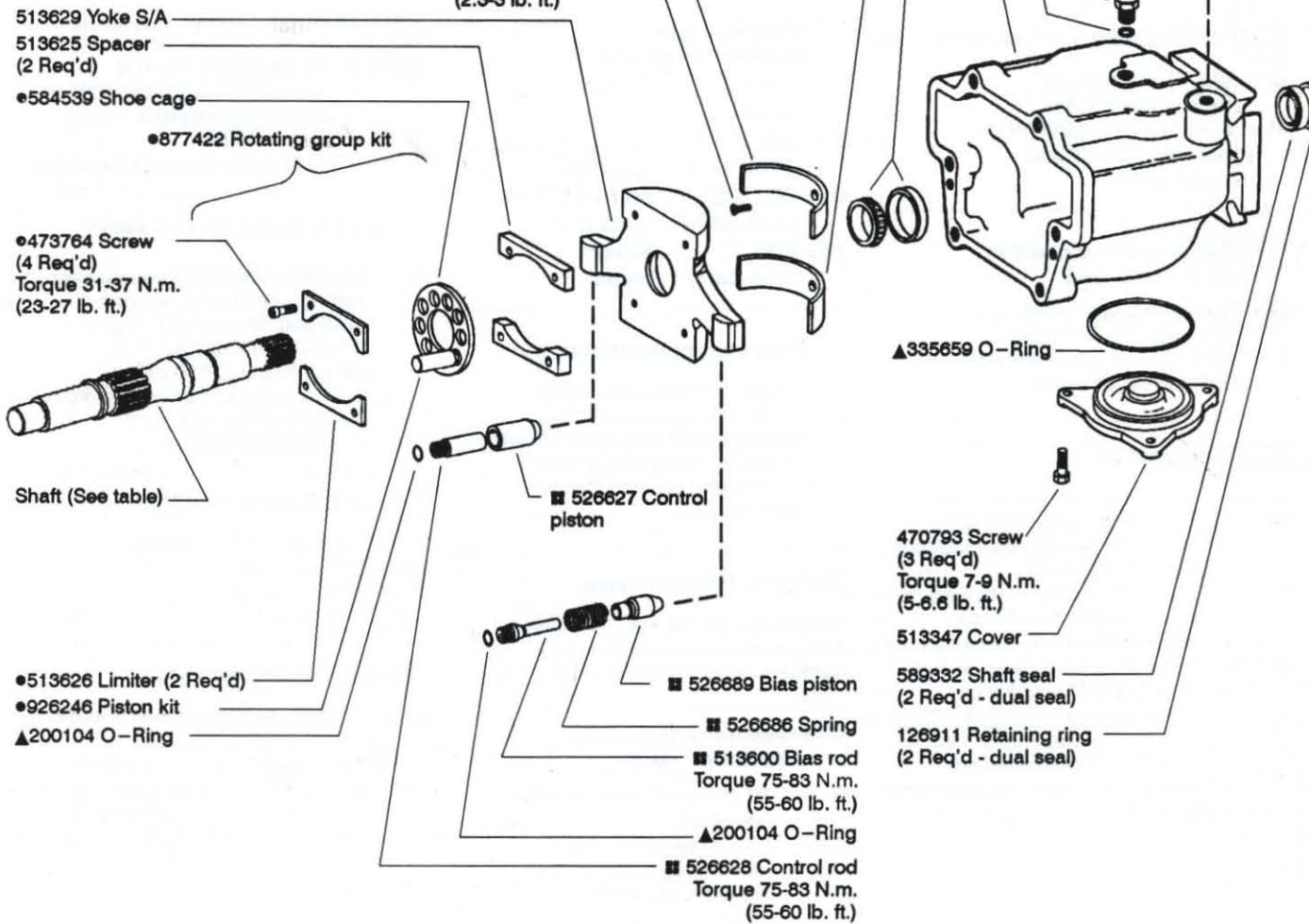

NOTE
For satisfactory service life of these components in industrial applications, use full flow filtration to provide fluid which meets ISO cleanliness code 14/12 or cleaner.

- ▲ Available in single shaft seal kit 02-102263 Equivalent double shaft seal kit 02-102264
- Available in rotating group kit 877422
- Available in bearing kit 877425

NOTE
Right hand rotation shown. View is opposite for left hand rotation. Please refer to Overhaul Manual M-2210-S.

NOTE
Use shims as required to obtain 0.01-0.10 mm (.0004-.004 in.) axial shaft endplay.

Load Sensing & Pressure Compensator Control C(M)*V

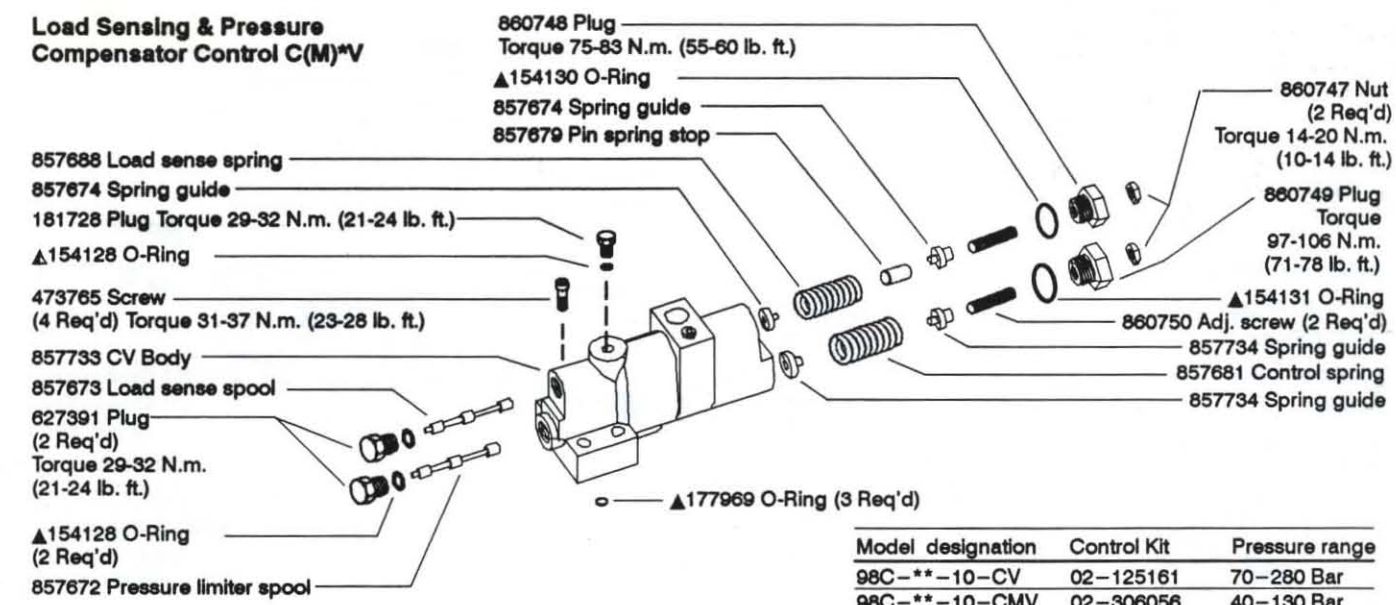

Model designation	Control Kit	Pressure range
98C-**-10-CV	02-125161	70-280 Bar
98C-**-10-CMV	02-306056	40-130 Bar

(All parts shown are included in control kit)

Pressure Compensator Control C & CM

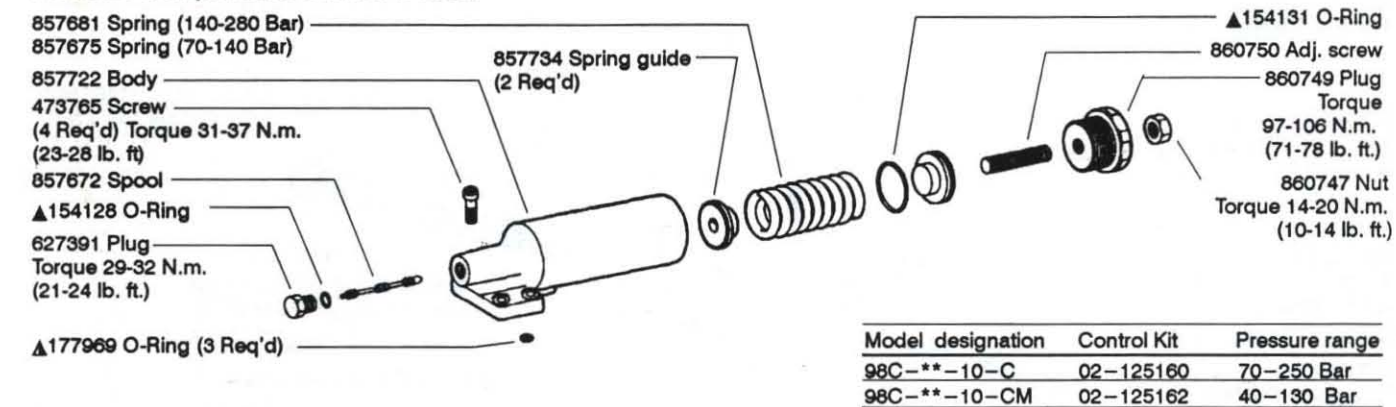

Model designation	Control Kit	Pressure range
98C-**-10-C	02-125160	70-250 Bar
98C-**-10-CM	02-125162	40-130 Bar

(All parts shown are included in control kit)

Industrial Control (I.C.)

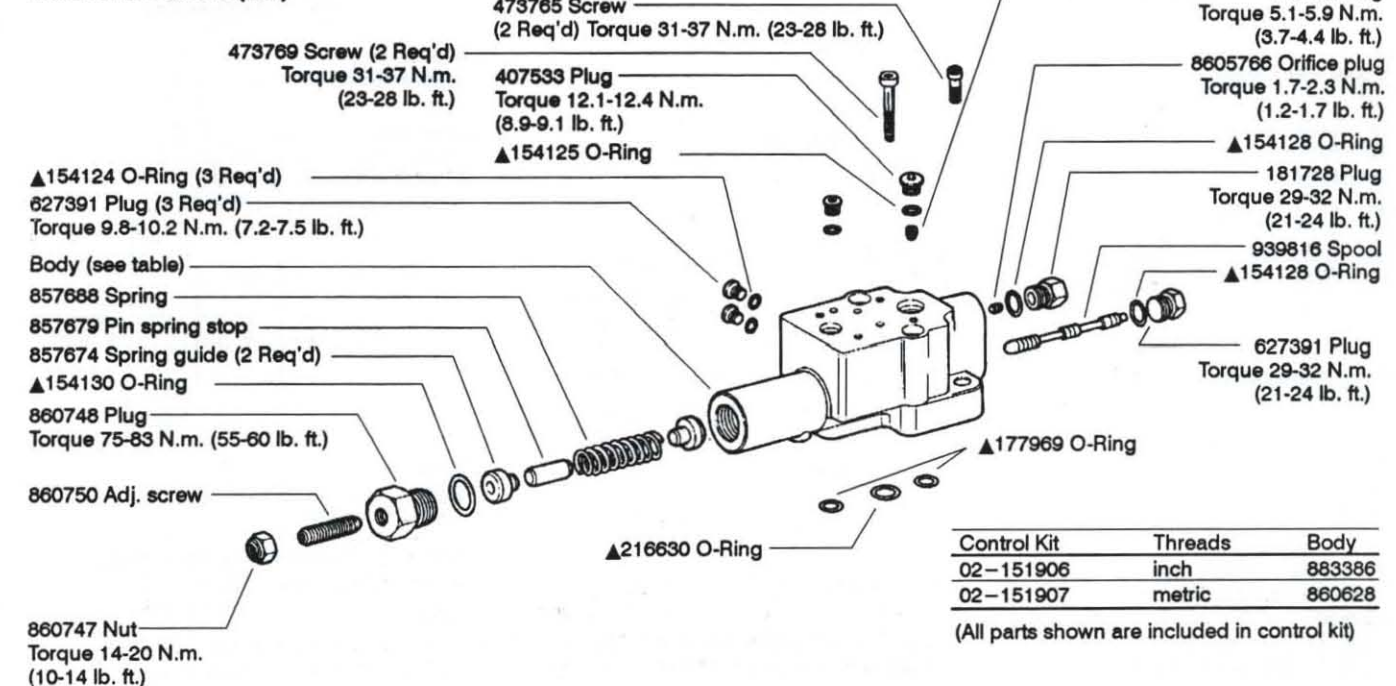

Control Kit	Threads	Body
02-151906	inch	883386
02-151907	metric	860628

(All parts shown are included in control kit)

PVH98 Variable Displacement Piston Pump

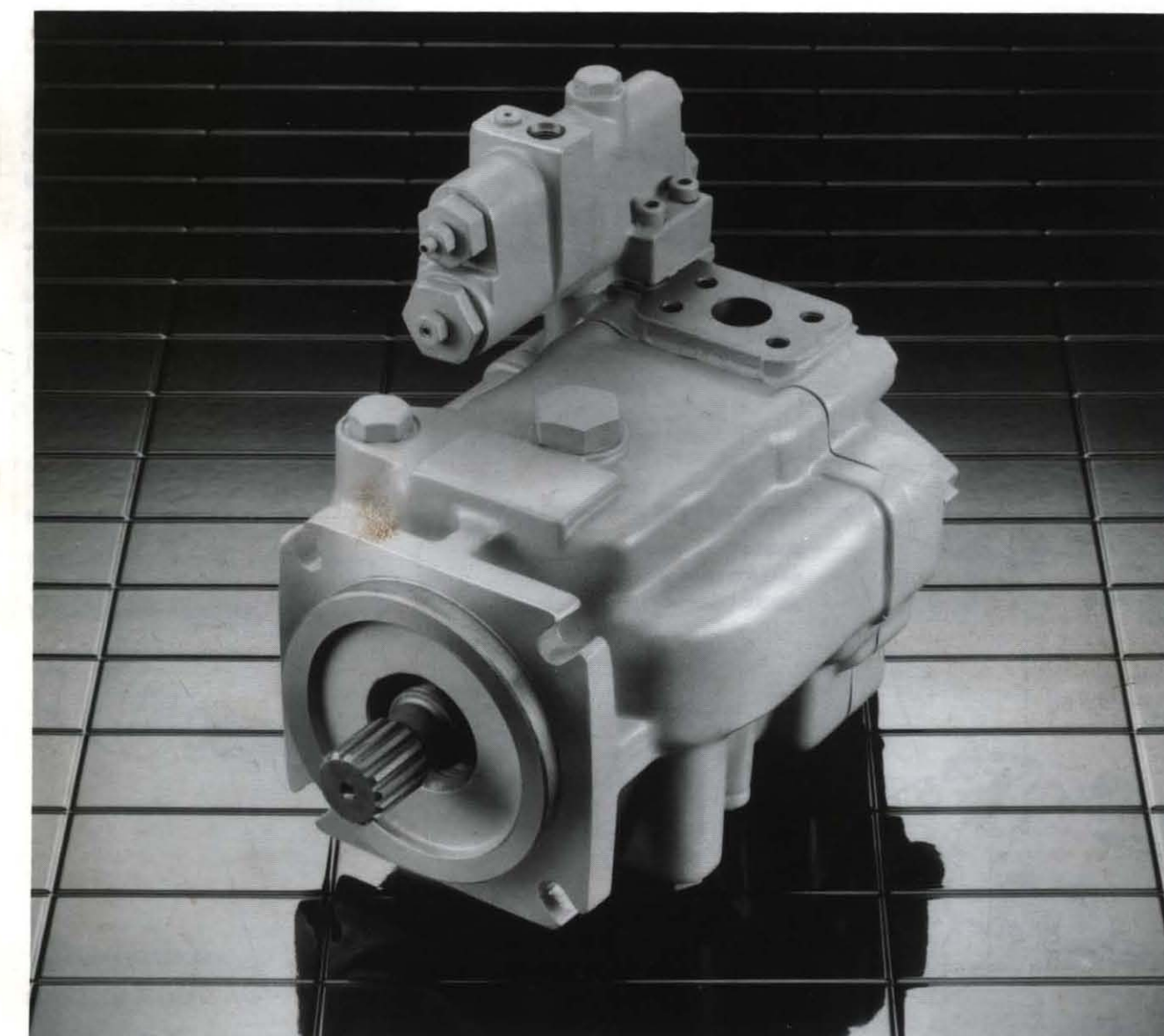

Vickers, Incorporated
A TRINOVA Company
5445 Corporate Drive
P.O. Box 302
Troy, Michigan 48007-0302

Model Codes

Industrial pumps

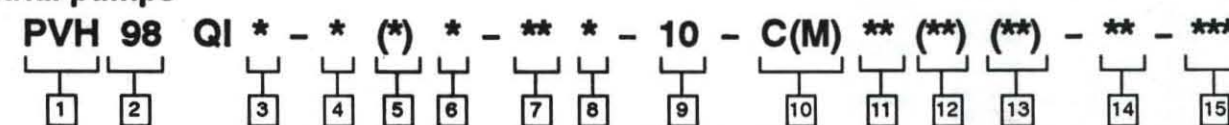

Mobile pumps

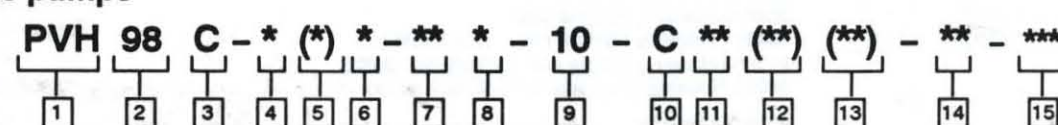

- 1** Piston pump, variable displacement
- 2** Maximum geometric displacement
98 = 98.3 cm³/r (6.0 in³/r)
- 3** Mounting flange, prime mover end
C = SAE "C" 4-bolt type (SAE J744-127-4)
M = ISO 3019/2-125B4HW (Option for PVH57 and PVH74 only)
- 4** Shaft rotation, viewed at prime mover end
R = Right hand, clockwise (Standard on QI models)
L = Left hand, counterclockwise (Optional on QI models)
- 5** Configuration
Blank = Non-thru-drive (single pump)
A = Thru-drive pump with SAE "A" 2-bolt rear flange mounting (SAE J744-82-2)
B = Thru-drive pump with SAE "B" 2- and 4-bolt rear flange mountings† (SAE J744-101-2/4)
C = Thru-drive pump with SAE "C" 2- and 4-bolt rear flange mountings† (SAE J744-127-2/4)
S = Adjustable maximum volume stop (non-thru-drive and non-torque-control pumps only)
- 6** Main ports
F = SAE 4-bolt flange pads (standard)
M = SAE 4-bolt pads with metric mounting bolt threads (PVH57 & PVH74 only)
- 7** Shaft-end type, at prime mover end
1 = SAE "C" Straight (J744-32-1) keyed
2 = SAE "C"† Splined 14 tooth (J744-32-4) 12/24 D.P.
3 = SAE "CC" Splined 17 tooth (J744-38-4) 12/24 D.P.
13 = SAE "C" Straight (J744-38-1) keyed
- 8** Shaft seal, prime mover end
S = Single, one-way (standard)
D = Double, two-way (optional) Recommended on second pump of tandem assembly (PVH**/PVH**) and on "wet mount" applications.
- 9** Pump design number
10 (Subject to change. Installation dimensions unaltered for design numbers 10 to 19 inclusive.)
- 10** Pressure compensator adjustment range
C = 70-250 bar (1015-3625 psi) (standard)
CM = 40-130 bar ((580-1885 psi) (optional QI version)
IC = Industrial control, 20 bar (290 psi) differential pressure setting
- 11** Pressure compensator factory setting in tens of bar
25 = Normal factory setting of 250 bar for "C" models.
7 = Normal factory setting of 70 bar for "CM" models.
- 12** Additional control functions
Blank = No additional controls
V = Load sensing, 20 bar (290 psi) differential pressure setting
T = Torque limiter
VT = Load sensing and torque limiter
- 13** Torque limiter factory setting
** = Customer desired torque limiter setting specified in ten bar (145 psi) increments, e.g.:
8 = 80 bar (1160 psi);
18 = 180 bar (2610 psi).
The torque setting range is from 30-80% of the specified compensator setting.
- 14** Control design number
31 = C, CM, or C**V controls.
13 = C**T controls
14 = C**VT controls
10 = IC control
- 15** Special features suffix
027 = Composite 2-bolt/4-bolt mounting conforming to SAE "C"
031 = Thru-drive SAE "A" pad cover
041 = No case-to-inlet relief (for use with supercharged circuits, 50 psi)
057 = Shaft-up operation (vertical mount)

† Built from pump with SAE "A" rear pad to which suitable flange adapter is bolted. For best availability and flexibility, order PVH SAE "A" thru-drive pump and SAE "B" or "C" adapter kit separately.

Pressure Compensator (CT, CVT)

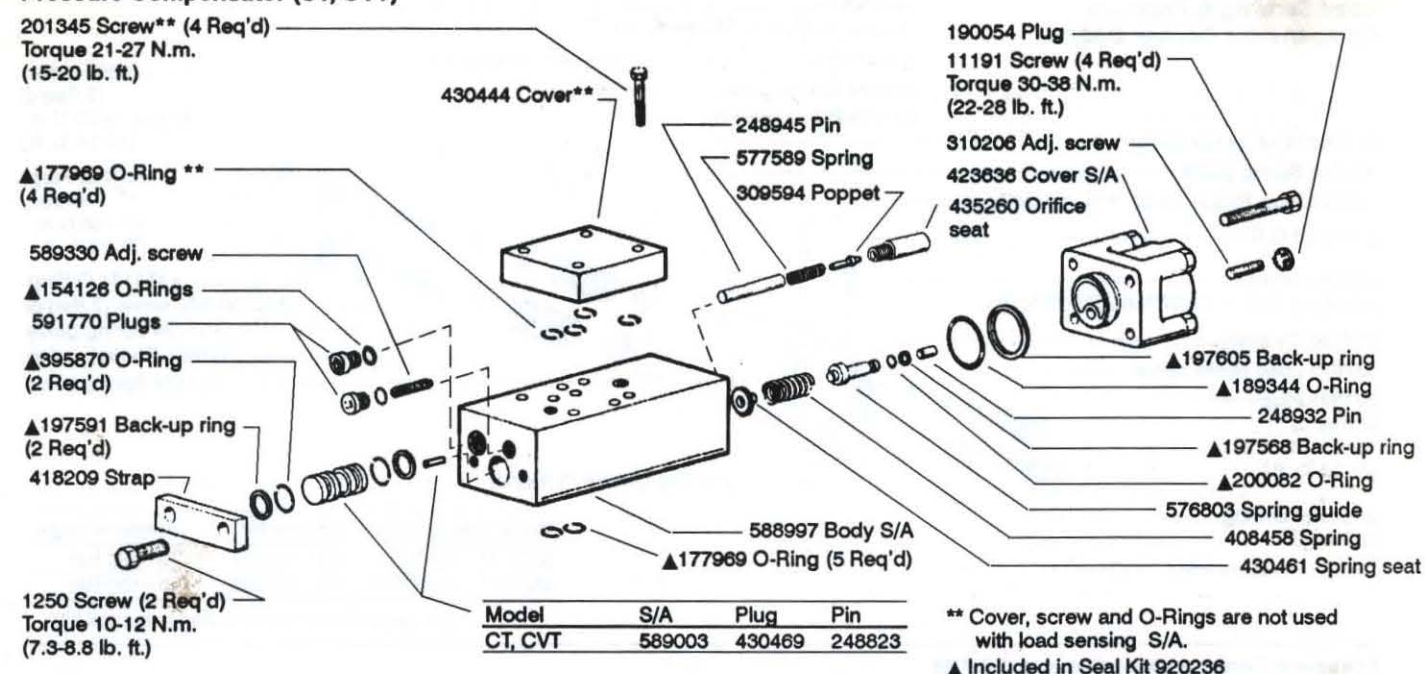

Torque Control/Load Sense S/A (CVT)

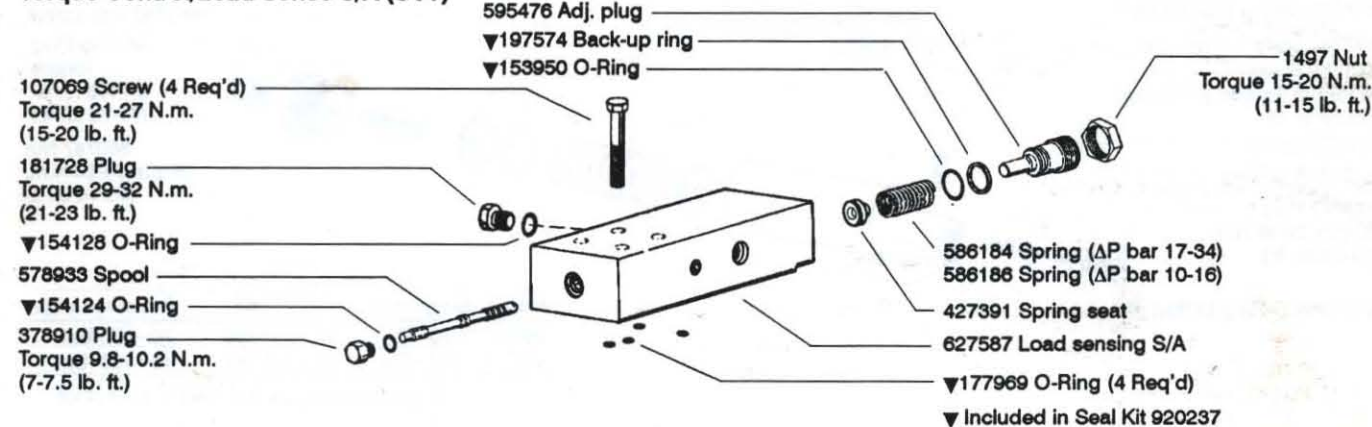

Thru-drive

Model designation	Valve block
98*-LAF-10-C	526692
98*-LAM-10-C	864266
98*-RAF-10-C	864242
98*-RAM-10-C	864243
98*-LAF-10-CT	526693
98*-LAM-10-CT	860526
98*-RAF-10-CT	883350
98*-RAM-10-CT	860528

Model designation	Adapter (SAE "B" & "C" pad)
98*-*BF-10-C	526670
98*-*BM-10-C	876393
98C-*CF-10-C	692934
98C-*CM-10-C	876391
031 Suffix A cover	939790

□ Available in adapter pad kit
876390 SAE B (inch)
876394 SAE B (metric)
876389 SAE C (inch)
876392 SAE C (metric)

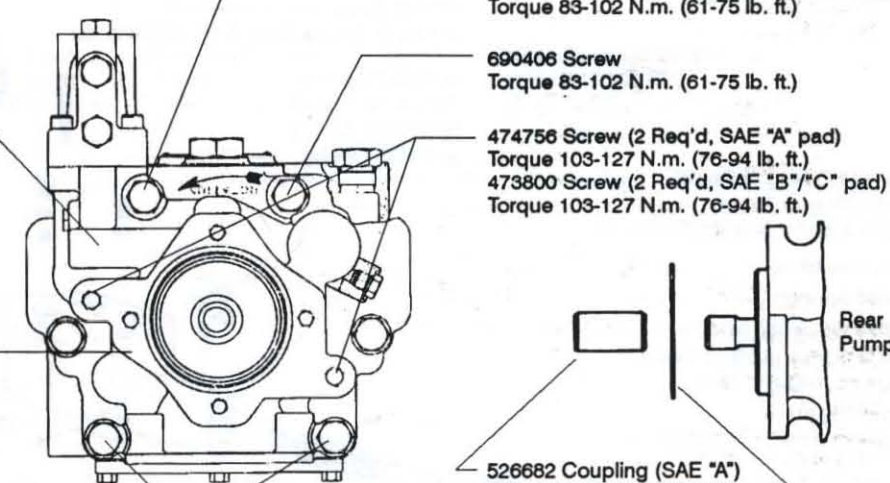

▲ Available in single shaft seal kit 02-102263
Equivalent double shaft seal kit 02-102264