

Model Code

Service Data

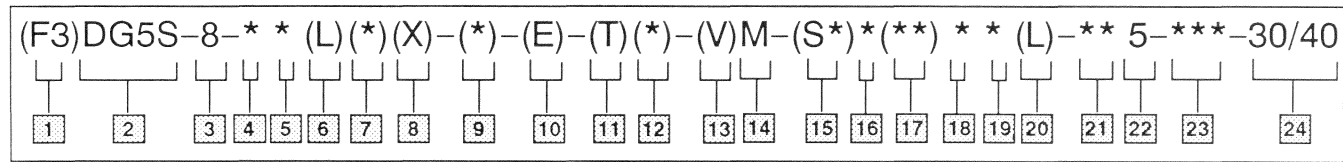

1 Seals for mineral oil & fire resistant fluids

2 Directional control valve
Manifold or subplate mounted
Solenoid controlled
Pilot operated
Rated pressure 210 Bar (3000 psi)

3 Interface
8 - NFPA-D06 (ISO-4401-08)

4 Spool type (see table)

5 Spool/Spring arrangement
A - Spring offset, to CYL. A
B - Spring centered, sol. A removed
C - Spring centered
F - Spring offset, to CYL. A shift to center
N - No spring detented

6 Left hand
L - Left hand (single solenoid only)
Blank - Omit when not required

7 Manual override option
Blank - Plain override solenoid ends only
H - Waterproof override solenoid ends only
H2 - Waterproof override both ends of single solenoid
P2 - Plain override both ends of single solenoid
Y - Lockable manual overrides solenoid ends only/DC only
Z - No overrides in either end

8 Response type
X - Fast response
Blank - Standard low shock models

9 Spool control modifications
1 - Stroke adjustment
2 - Pilot choke adjustment
3 - Pilot choke & stroke adjustment
7 - Stroke adjustment CYL. A only
8 - Stroke adjustment CYL. B only
2-7 - Dual pilot choke & stroke ADJ. A port end only
2-8 - Dual pilot choke & stroke ADJ. B port end only
Blank - Omit when not required

10 Pilot pressure
E - External pilot pressure
Omit - Internal pilot pressure

11 Pilot drain
T - Internal pilot Drain
Omit - External pilot drain

12 Pressure port check valve
K - 0.35 bar (5 psi cracking pressure)
R - 3.45 bar (50 psi cracking pressure)
S - 5.20 bar (75 psi cracking pressure)
Blank - Omit when not required

13 Solenoid energization identity
Blank - Standard arrangement for ANSI B93.9 (energise solenoid A for flow P to A port)
V - Solenoid identification determined by position of solenoid. (Solenoid A at port A end and/or solenoid B at port B end. (All 4 & 8 spools are always V code)

14 Flag symbol heading electrical options & features

15 Spool indicator switch
Available on high performance models, DG4V-3, only.
Omit when not required.
S1 - Options available on U only
S2 - Options available on U only
S3 - Options available on P* only
S4 - Options available on P* only
S5 - Options available on FW/FJ only

16 Coil type
U - ISO 4400
F - Flying lead
SP1 - Single 6,3 MM spade to IEC 760
SP2 - Dual 6,3 MM spade to IEC 760

17 Electrical connections (F type coil only) omit if not required
T - Wired terminal block
PA - Instaplug male receptacle only
PB - Instaplug male & female receptacle
PA3 - Three pin connector
PA5 - Five pin connector

18 Housing (F type coils only)
W - 1/2 NPT thread wiring housing
J - 20 mm thread wiring housing

19 Electrical options
1 - ISO with fitted plug, U type coils only
6 - ISO with fitted plug, & lights
U type coils only

20 Solenoid indicator lights (F build only) used with T terminal block models. (Omit if not required)

21 Coil identification

22 Pilot valve code (tank pressure rating)
2 - 10 bar (145 psi) DG4V3-60
5 - 100 bar (1450 psi) DG4V3S-60
6 - 160 bar (2285 psi) DG4V3-60
7 - 210 bar (3000 psi) DG4V3-60

23 Pilot valve port orifices

24 Design
30 - DG4V3S-60 pilot valve
40 - DG4V3-60 pilot valve

6 Thru **23** included in pilot valve model code

Solenoid Controlled Pilot Operated Directional Valve

DG5S-8-**(L)-(*) (X)-(*)-(E)-(T)(*)-(V)M-(S*)-*(**) ** (L)-***-***-30/40

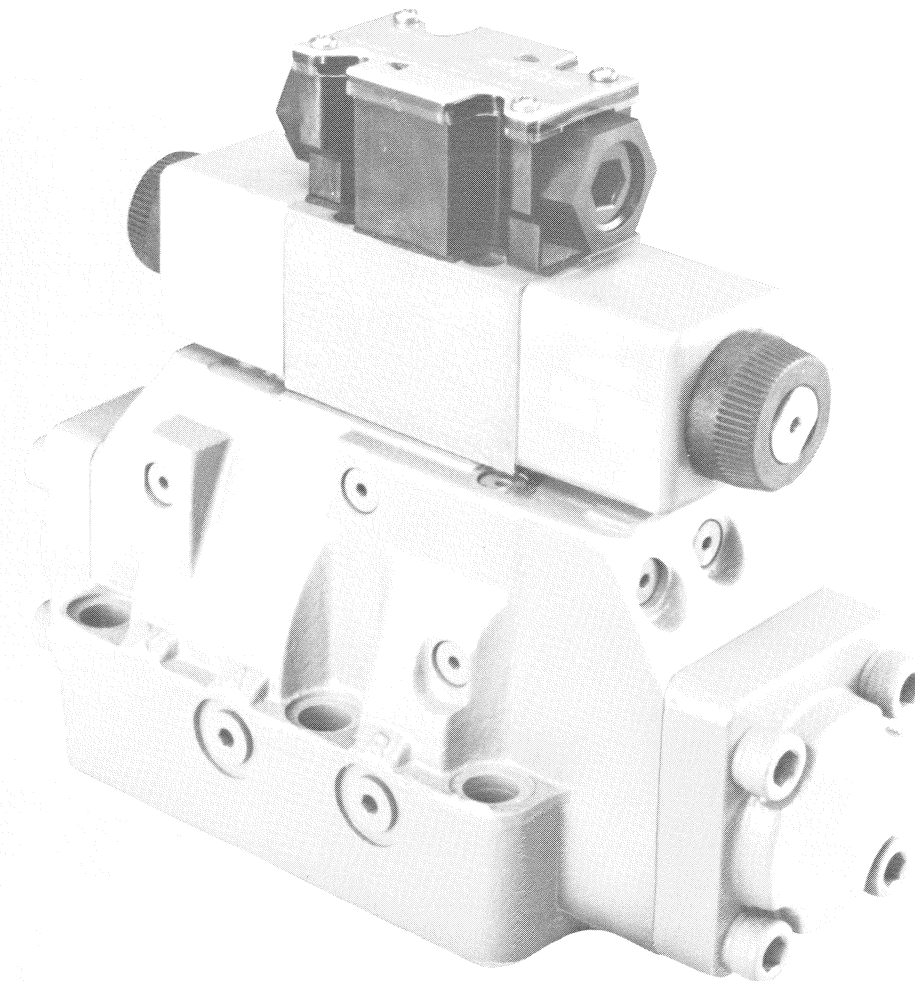

Parts shown included in stroke ADJ. kit 941154. Order two kits if stroke ADJ. is required both ends.

470843 Screw (4 Req'd)
Torque 49-59 N.m.
(36-44 lb. ft.)

135369 ADJ. Screw
289339 Cover
▲ 262330 O-Ring
▲ 262402 O-Ring

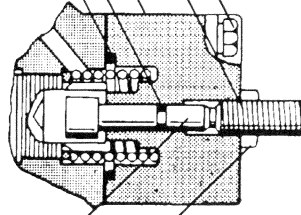

223075 Piston
1489 Nut

MAIN STAGE SPOOL TYPE	AVAILABLE VALVE TYPE	SPOOL	MAIN STAGE ID PLATE		
			"A" ONLY	B/C/F/N	
0	A/B/C/F/N	363495	400976	400976	
1		*276623	400977	400977	
2		363496	400978	400978	
3		*276625	400979	400979	
4		276626	400980	400980	
6		363498	400981	400981	
8		363499	400980	400980	
9		363500	400976	400976	
11		*276623	632700	632700	
31		*276625	580475	580475	
33		363501	400981	400981	
52/521		C	*420583	573685	573685

* SPOOL ASSEMBLY NOTE

Assemble type 1 & 3 spools with narrow center land toward "A" end of valve. "A" end is defined as being closest to CYL. port "A". Type 11 & 31 spools are installed in reverse of type 1 & 3 with narrow center lands toward "B" end of valve. Assemble type 52 spool with two narrow center lands toward CYL. port "B" end of valve. Assemble type 521 spool with two narrow center lands toward CYL. port "A" end of valve.

PLUG	TORQUES (OILED)	
	N.m.	lb. in.
113000	5.0-5.9	45-52
237588		
343740	15.0-16.0	133-142
398071	9.8-10.2	87-90
407533	12.1-12.4	107-110

VALVE MODEL CODE	MAIN STAGE SPOOL TYPE	PILOT VALVE MODEL CODE
DG5S-8-*A-30	0, 1, 2, 3, 6, 9,	DG4V-3S-2A-60
DG5S-8-*A-40	11, 31, 33	DG4V-3-2A-60
DG5S-8-*A-30	4 & 8	DG4V-3S-28A-60
DG5S-8-*A-40		DG4V-3-28A-60
DG5S-8-*B-30	0, 1, 2, 3, 6, 9,	DG4V-3S-6B-60
DG5S-8-*B-40	11, 31, 33	DG4V-3-6B-60
DG5S-8-*B-30	4 & 8	DG4V-3S-68B-60
DG5S-8-*B-40		DG4V-3-68B-60
DG5S-8-*C-30	0, 1, 2, 3, 6, 9,	DG4V-3S-6C-60
DG5S-8-*C-40	11, 31, 33, 52, 521	DG4V-3-6C-60
DG5S-8-*C-30	4 & 8	DG4V-3S-68C-60
DG5S-8-*C-40		DG4V-3-68C-60
DG5S-8-*F-30	0, 1, 2, 3, 6, 9,	DG4V-3S-6F-60
DG5S-8-*F-40	11, 31, 33	DG4V-3-6F-60
DG5S-8-*F-30	4 & 8	DG4V-3S-68F-60
DG5S-8-*F-40		DG4V-3-68F-60
DG5S-8-*N-30	0, 1, 2, 3, 6, 9,	DG4V-3S-6N-60
DG5S-8-*N-40	11, 31, 33	DG4V-3-6N-60
DG5S-8-*N-30	4 & 8	DG4V-3S-68N-60
DG5S-8-*N-40		DG4V-3-68N-60

See pilot valve service drawing for parts breakdown

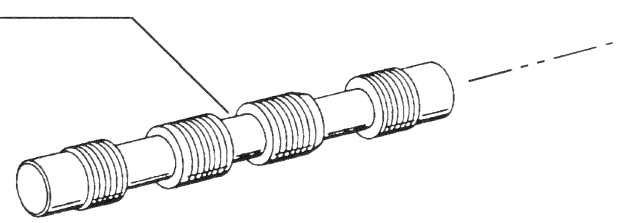
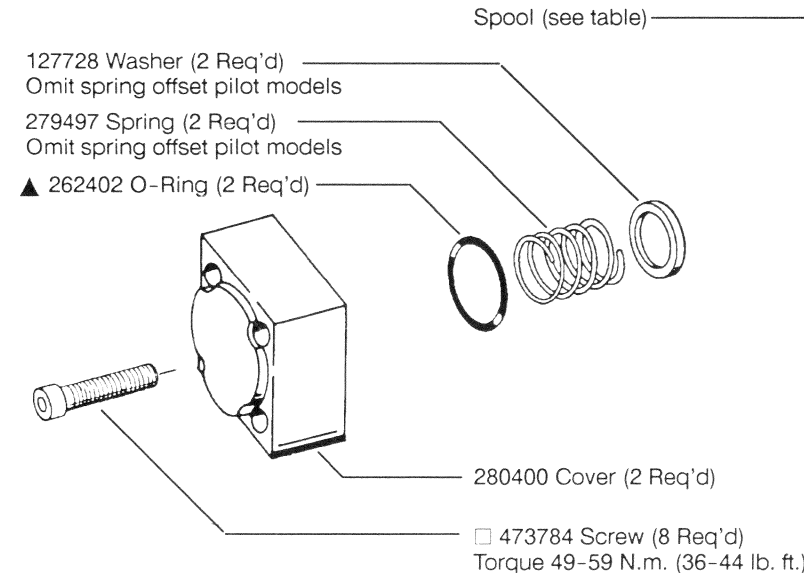

- ▲ Included In F3 Seal Kit 696894
- ★ Included In Plug Kit 941167
- Included In Fastener Kit 941165
- ◆ Not Available For Sale
- ♣ Used On Check Valve Models Only
- Plug Torques (See Table)
- Available Only In Kit Of 25 Each

PILOT STAGE BOLT KIT (INCLUDES 4 ATTACHING BOLTS)

MODEL	BOLT KIT
W/O Pilot choke	696892
W/ Pilot choke	696893
Torque 4.5-5.7 N. m. (39.8-50.4 lb. in.)	
See pilot choke service drawing for parts breakdown	

This solenoid removed on right hand A, B, & F models. Refer to service drawings for more detailed information on left hand valves.

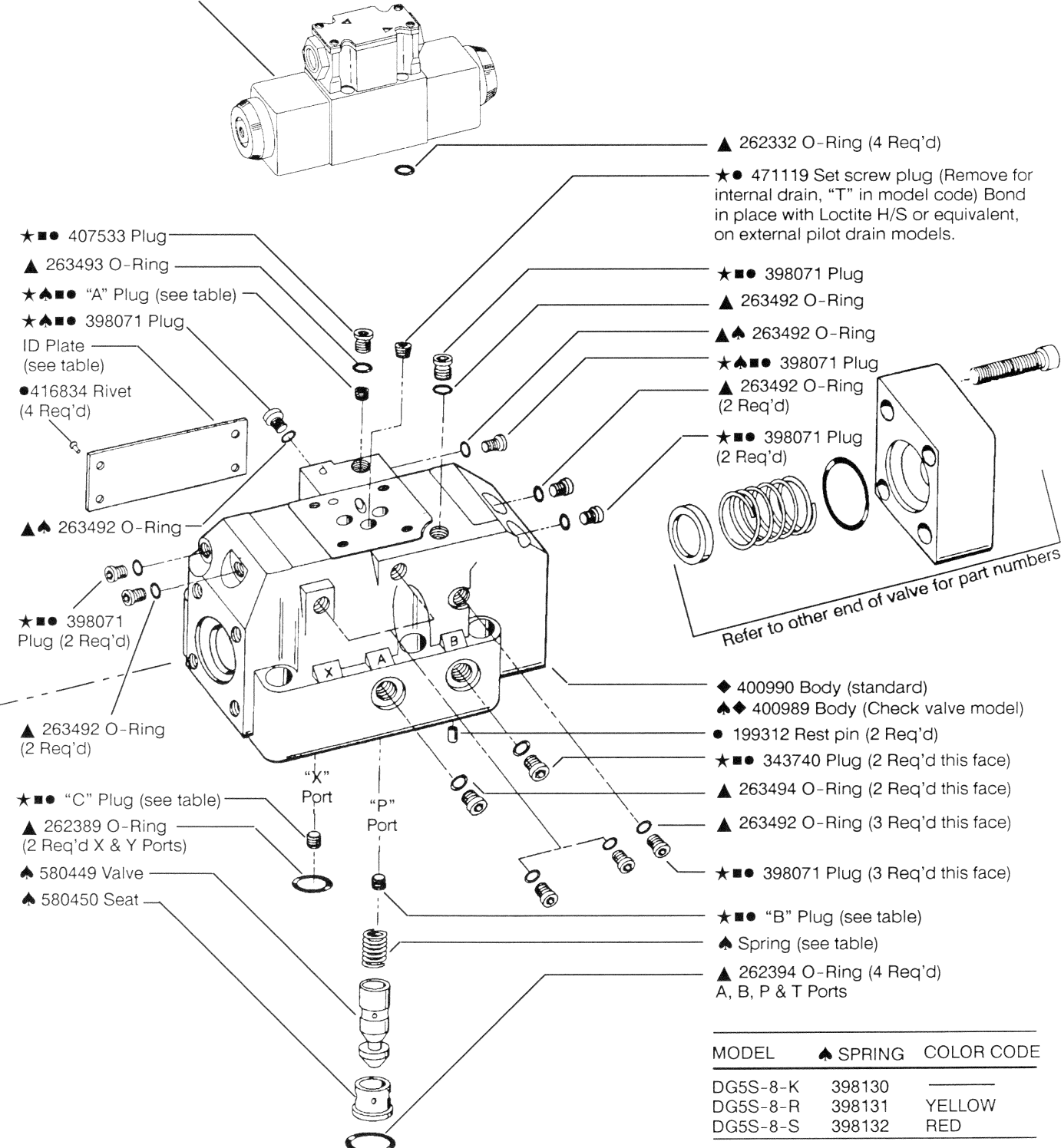

PLUG INSTALLATION TABLE

MODEL	"A" PLUG	"B" PLUG	"C" PLUG
DG5S-8-*	DOES NOT EXIST	237588	—
DG5S-8-**-E		113000	237588
DG5S-8-**-X		—	—
DG5S-8-**-X-E		113000	—
DG5S-8-**-KRS	237588	DOES NOT EXIST	—
DG5S-8-**-E-KRS	113000		237588
DG5S-8-**-X-KRS	—		—
DG5S-8-**-X-E-KRS	113000		—
113000 Solid plug		237588 Orifice plug	