

Model Code

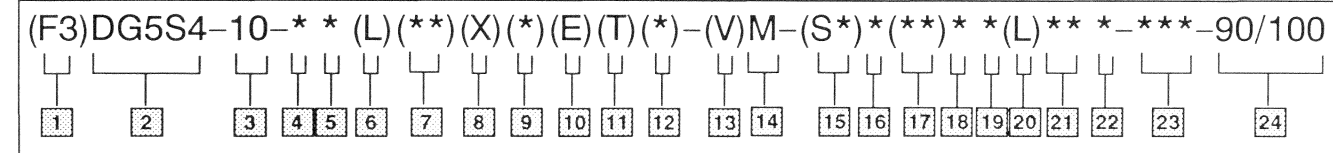

1 Seals for mineral oil & fire resistant fluids

2 Directional control valve
Manifold or subplate mounted
Solenoid controlled
Pilot operated, Sliding spool
4 way flow direction

3 Interface (Valve size 1-1/4 inch)
10 - NFPA-D10 (ISO-4401-10)

4 Spool type (see table)

5 Spool/Spring arrangement
A - Spring offset, to CYL. A
B - Spring centered, sol. A removed
C - Spring centered
F - Spring offset, to CYL. A shift to center
N - No spring detented

6 Left hand
L - Left hand (single solenoid only)
Blank - Omit when not required

7 Manual override option
Blank - Plain override solenoid ends only
H - Waterproof override solenoid ends only
H2 - Waterproof override both ends of single solenoid
P2 - Plain override both ends of single solenoid
Y - Lockable manual overrides solenoid ends only/DC only
Z - No overrides in either end

8 Response type
X - Fast response
Blank - Standard low shock models

6 Thru **23** included in pilot valve model code

9 Spool control modifications
1 - Stroke adjustment
2 - Pilot choke adjustment
3 - Pilot choke & stroke adjustment
7 - Stroke adjustment CYL. A only
8 - Stroke adjustment CYL. B only
2-7 - Dual pilot choke & stroke ADJ. A port end only
2-8 - Dual pilot choke & stroke ADJ. B port end only
Blank - Omit when not required

10 Pilot pressure
E - External pilot pressure
Omit - Internal pilot pressure

11 Pilot drain
T - Internal pilot Drain
Omit - External pilot drain

12 Pressure port check valve
K - 0.35 bar (5 psi cracking pressure)
R - 3.45 bar (50 psi cracking pressure)
S - 5.20 bar (75 psi cracking pressure)
Blank - Omit when not required

13 Solenoid energization identity
Blank - Standard arrangement for ANSI B93.9 (energise solenoid A for flow P to A port)
V - Solenoid identification determined by position of solenoid. (Solenoid A at port A end and/or solenoid B at port B end. (All 4 & 8 spools are always V code)

14 Flag symbol heading electrical options & features

15 Spool indicator switch
Available on high performance models, DG4V-3, only.
Omit when not required.

S1 - Options available on U only)
S2 - Options available on U only)
S3 - Options available on P* only
S4 - Options available on P* only
S5 - Options available on FW/FJ only

16 Coil type
U - ISO 4400
F - Flying lead
SP1 - Single 6,3 MM spade to IEC 760
SP2 - Dual 6,3 MM spade to IEC 760

17 Electrical connections (F type coil only) omit if not required
T - Wired terminal block
PA - Instaplug male receptacle only
PB - Instaplug male & female receptacle
PA3 - Three pin connector
PA5 - Five pin connector

18 Housing (F type coils only)
W - 1/2 NPT thread wiring housing
J - 20 mm thread wiring housing

19 Electrical options
1 - ISO with fitted plug, U type coils only
6 - ISO with fitted plug, & lights
U type coils only

20 Solenoid indicator lights (F build only) used with T terminal block models. (Omit if not required)

21 Coil identification

22 Pilot valve code (tank pressure rating)
2 - 10 bar (145 psi) DG4V3-60
5 - 100 bar (1450 psi) DG4V3S-60
6 - 160 bar (2285 psi) DG4V3-60
7 - 210 bar (3000 psi) DG4V3-60

23 Pilot valve port orifices

24 Design
90 - DG4V3S-60 pilot valve
100 - DG4V3-60 pilot valve

Service Data



Solenoid Controlled Pilot Operated Directional Valves

(F3)DG5S4-10-*(L)(**)(X)(*)(E)(T)(*)-(V)M-(S*)*(**)* *(L)** *-***-90/100

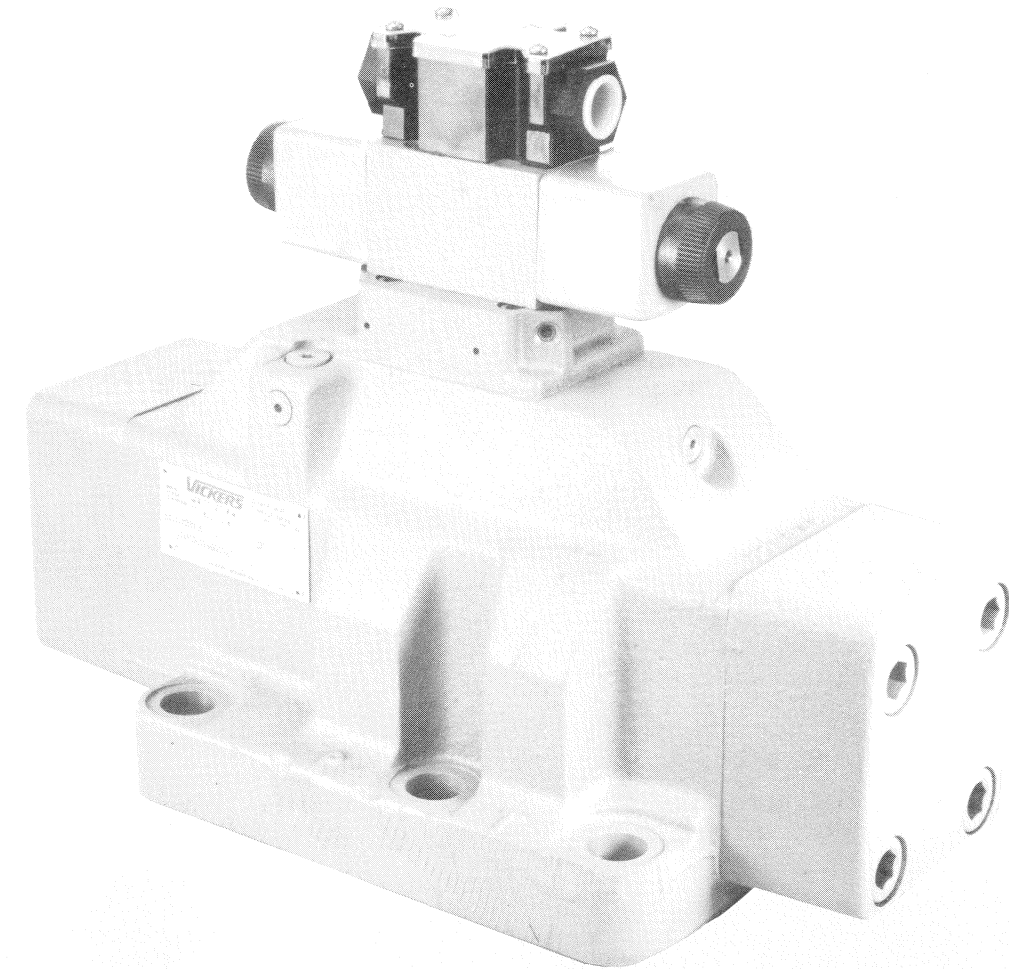

Vickers Incorporated
A TRINOVA Company
5445 Corporate Drive
P. O. Box 302
Troy, Michigan 48007-0302
U.S.A.

MAIN STAGE SPOOL TYPE	AVAILABLE VALVE TYPE	SPOOL	MAIN STAGE ID PLATE	
			"A" ONLY	B/C/N
0	A/B/C/N	364037	400975	400976
1		*331404		400977
2		364038		400978
3		*277479		400979
4		281193		400980
6		364039		400981
8		364041		400980
9		277563		400976
11		*331404		632700
31		*277479		580475
33		364042		400981

*** SPOOL ASSEMBLY NOTE**

Assemble type 1 & 3 spools with narrow center land toward "A" end of valve. "A" end is defined as being closest to CYL. port "A". Type 11 & 31 spools are installed in reverse of type 1 & 3 with narrow center lands toward "B" end of valve.

PLUG INSTALLATION TABLE

MODEL	"A" PLUG	"B" PLUG	"C" PLUG
DG5S4-10*	DOES NOT EXIST	30560	
DG5S4-10*-E		7074	30560
DG5S4-10*-X			
DG5S4-10*-X-E			
DG5S4-10*-K/R/S	161809	7074	
DG5S4-10*-E-K/R/S	113000		30560
DG5S4-10*-X-K/R/S			
DG5S4-10*-X-E-K/R/S	113000		

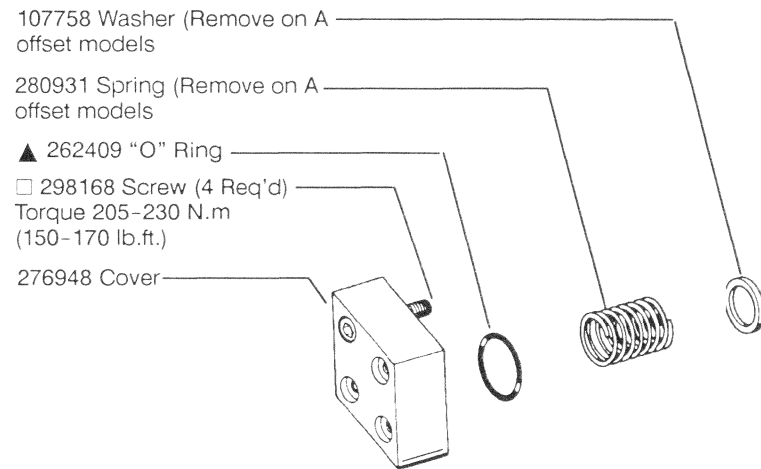

VALVE MODEL CODE	MAIN STAGE SPOOL TYPE	PILOT VALVE MODEL CODE
DG5S4-10*A	O, 1, 2, 3, 6, 9, 11, 31, 33	DG4V-3(S)-2A-60
	4 & 8	DG4V-3(S)-2AL-VM-60
DG5S4-10*B	O, 1, 2, 3, 6, 9, 11, 31, 33	DG4V-3(S)-6B-60
	4 & 8	DG4V-3(S)-6BL-VM-60
DG5S4-10*C	O, 1, 2, 3, 6, 9, 11, 31, 33, 52, 521	DG4V-3(S)-6C-60
	4 & 8	DG4V-3(S)-6C-VM-60
DG5S4-10*N	O, 1, 2, 3, 6, 9, 11, 31, 33	DG4V-3(S)-6N-60
	4 & 8	DG4V-3(S)-6N-VM-60

See pilot valve service drawing for parts breakdown

PLUG TORQUES (OILED)

PLUG	N.M	lb. in.
7074	8.5-9.6	75-85
30560	8.5-9.6	75-85
113000	5.0-5.9	45-52
161809	5.0-5.9	45-52
343740	15.0-16.0	133-147
363889	20.5-22.5	181-199
407533	12.1-12.4	107-110

NOTE

SAE straight thread plugs used on exterior of valve.

NOTE

Parts included in service kits are not sold separately.

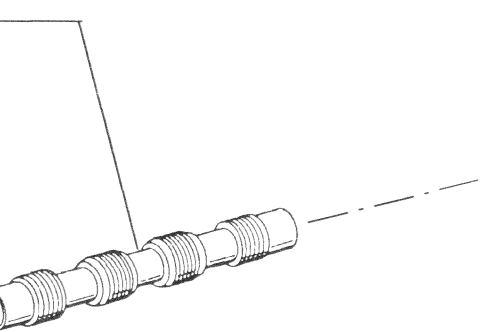

SEAL KIT NOTE

Valves are manufactured as shown with F3 seals used internally. Interface seals are standard Nitrile material and are converted to F3 in the seal kit. All seals in the seal kit are F3.

- ▲ Included In F3 Seal Kit 696898
- ★ Included In Plug Kit 941263
- Included In Fastener Kit 941262
- ◆ Not Available For Sale
- ♣ Used On Check Valve Models Only
- Plug Torques (See Table)
- Available Only In Kit Of 25 Each

MODEL SPRING

DG5S4-10-K	247287
DG5S4-10-R	276428
DG5S4-10-S	432353

This solenoid removed on right hand A, & B, models. Refer to service drawings for more detailed information on left hand valves.

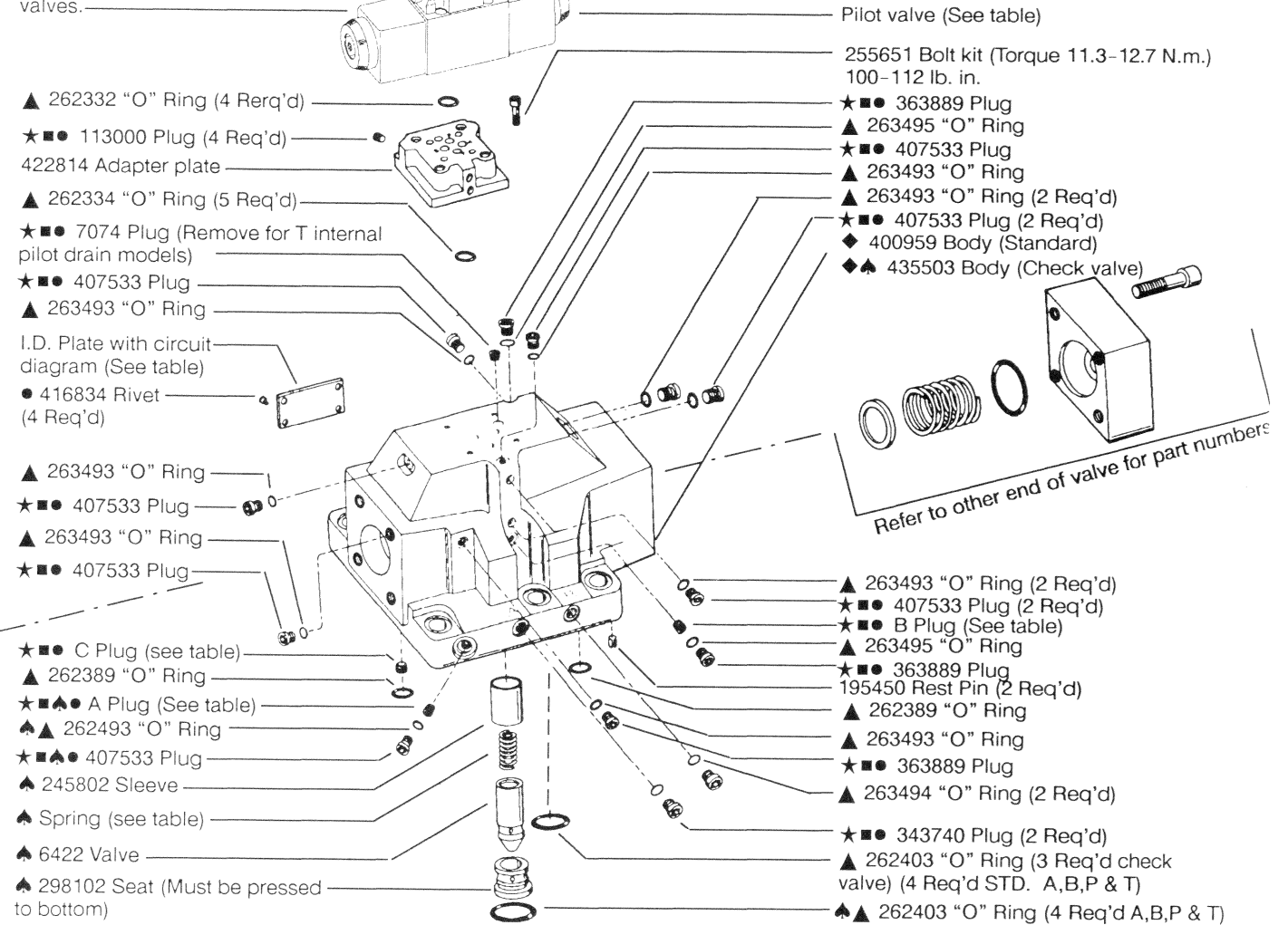

Stroke Adjustment Parts

(Either end of valve or both ends.)

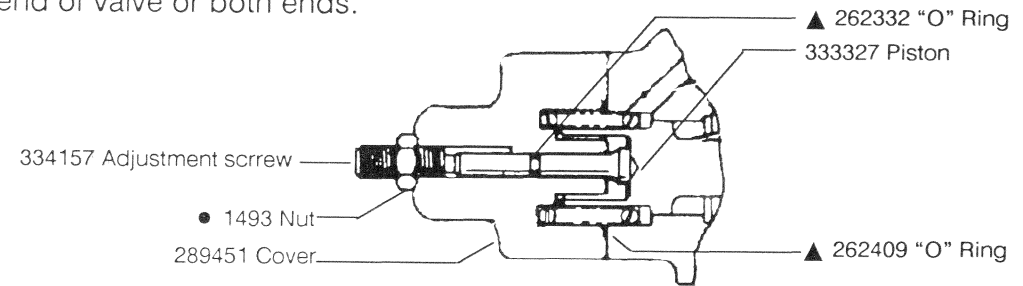

NOTE

For satisfactory service life of these components in industrial applications, use full flow filtration to provide fluid which meets ISO cleanliness code 18/15 or cleaner.