

## Model Code

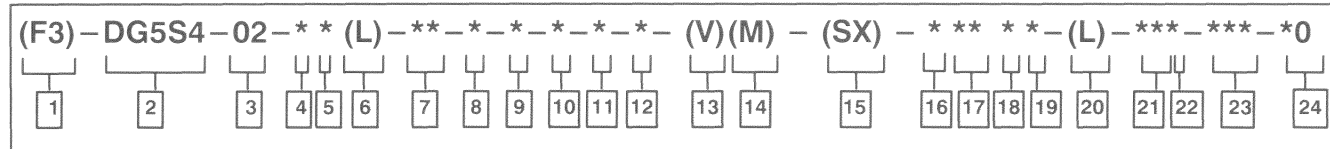

### 1 Interface seals

F3 – Special seals  
Blank – Standard seals

### 2 Valve type

D – Directional control valve  
G – Manifold or gasket mounted  
5 – Solenoid controlled, pilot operated  
S – Sliding spool action  
4 – Four-way flow

### 3 Valve series

02 – 20 series valve size

### 4 Spool type

### 5 Spool/spring arrangement

A – Spring offset to A  
B – Spring centered, shift to offset  
C – Spring centered  
F – Spring offset, shift to center  
N – No spring, detented

### 6 Left hand assembly

L – Single solenoid models only  
(omit for right hand assembly).

### 7 Manual operator in pilot valve end cap

H – Overrides in solenoid ends only  
H2 – Waterproof overrides in both ends of single solenoid  
P2 – Overrides in both ends of single solenoid  
Y – Lockable manual overrides in solenoid ends only (DC only)  
Z – No overrides in either end

### 8 Response

X – Fast response  
(omit for standard models)

### 9 Spool control modifications (omit when not required)

1 – Stroke adjustment both ends (used w/B, C, and F spool/spring arrangement only)  
2 – Pilot choke adjustments, all models  
3 – Pilot choke and stroke adjustment, both ends (B, C, and F models only)  
7 – Stroke adjustment cyl. A end only (not available on N and AL)  
8 – Stroke adjustment cyl. B end only (not available on N and A)  
2-7 – Pilot choke and stroke adjustment cyl. A end (not available on N and AL)  
2-8 – Pilot choke and stroke adjustment, cyl. B end (not available on N and A models)

### 10 External pilot pressure

E – External pilot pressure  
(omit for internal pilot pressure models)

### 11 Pilot drain

T – Internal pilot drain  
(omit for external pilot drain)

### 12 Mounting screw option

Blank – 2500–20 UNC-2A screws  
M – M6X1 – 6g screws

### 13 Solenoid Energization Identity

Blank – Standard arrangement for ANSI B93.9 (i.e. energize solenoid A to allow flow P to A)  
V – Solenoid identification determined by position of solenoid (i.e. solenoid A at port A end/solenoid B at port B end).  
NOTE: Type 4 & 8 spools are always V

### 14 Flag symbol heading electrical features and options

### 15 Spool position monitor switch (A, B, and F models only)

S1\* – Proximity switch, normally open  
S2\* – Proximity switch, normally closed  
S3\*\* – Limit switch, normally open  
S4\*\* – Limit switch, normally closed  
S5\*\*\* – Limit switch – unwired

\*Available on U models only

\*\*Available on PA, PB, PA5 models only

\*\*\*Available on FW & FJ models only

### 16 Coil Type

U – ISO 4400 (DIN 43650)  
P – Plug-in coil  
F – Flying lead  
SP1 – Single 6.3mm spade to IEC 760  
SP2 – Dual 6.3mm spade to IEC 760  
X1 – Flame proof solenoids to EEX-O-11B-T4  
X2 – Special protection solenoids to CSA/UL

### 17 Electrical plug features (F type coils only)

T – Wired terminal block  
PA – Insta-plug male connector only  
PB – Insta-plug male and female receptacles  
PA3 – NFPA 3-pin conduit connector  
PA5 – NFPA 5-pin conduit connector

### 18 Housing (F type coils only)

W – Wiring housing with 1/2" NPT thd connectors  
J – 20mm thread

### 19 Electrical options

1 – ISO 4400 with fitted plug (U type coils only)  
7 – Surge damper

### 20 Solenoid indicator lights

L – For models with flying lead ("F") and terminal block ("T") only (Omit if not required.)

### 21 Coil identification letter (Refer to I-3886-S)

### 22 Tank Pressure Rating

2 – 10 bar (145 psi) switch models  
4 – 70 bar (1000 psi) hazardous models  
6 – 160 bar (2285 psi) A.C. models  
7 – 210 (3000 psi) D.C. models

### 23 Pilot valve port orifices (omit if not required)

### 24 Design

20 – DG4V3S-60 pilot valve  
30 – DG4V3-60 pilot valve

## Service Data

# VICKERS

## Directional Control Valve

(F3)–DG5S4-02-\*\*(L)–30

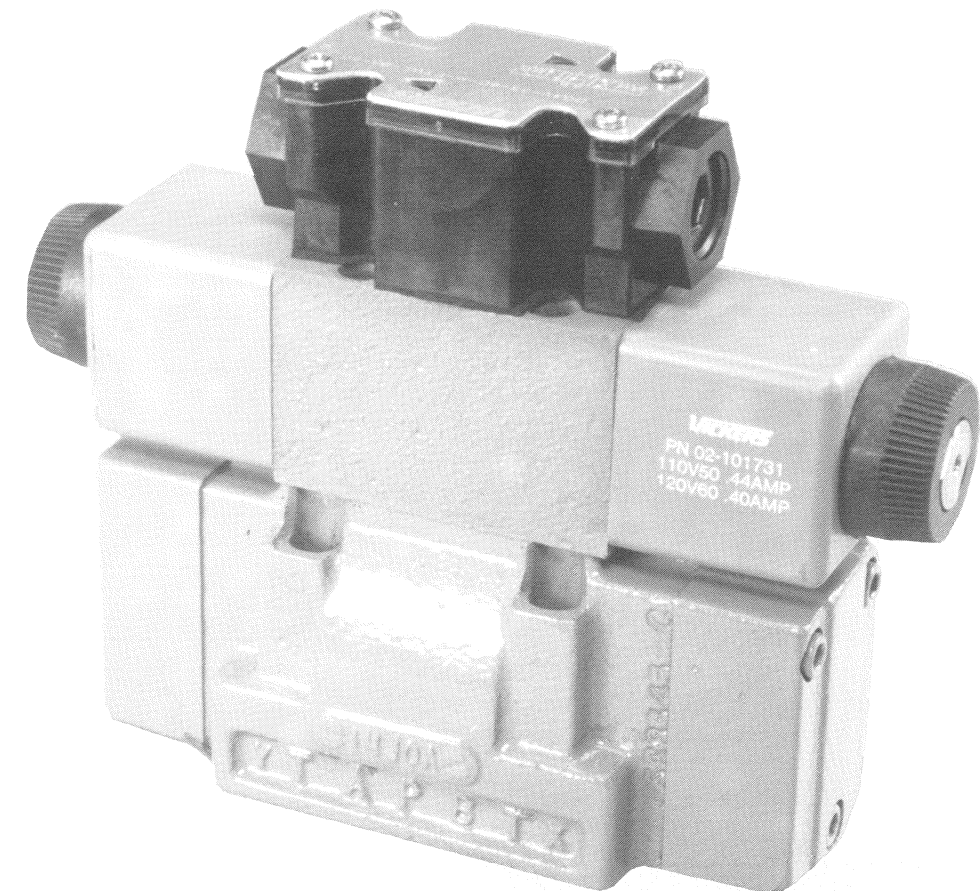

Spool/Spring Arrangement			
Spool Type	A	B,C,F	N
0	500438	500438	500481
1*	—	500442	—
2	500437	500437	500480
3*	—	500440	—
4	—	500450	—
6	500439	500439	500482
7	—	500444	—
8	—	500448	—
9	500447	500447	500483
11**	—	500442	—
31**	—	500440	—
33	—	500449	500484

\* Assemble type 1 & 3 spools with narrow center land towards "A" end of valve.

\*\* Assemble type 11 & 31 spools with narrow center land towards "B" end of valve.

Model	End Cover
A,B,C,F	500451
N	500474
Stroke Adj	568371

For satisfactory service life of these components in industrial applications, use full flow filtration to provide fluid which meets ISO cleanliness code 18/15 or cleaner. OFP, OFR and OFRS series filters are recommended.

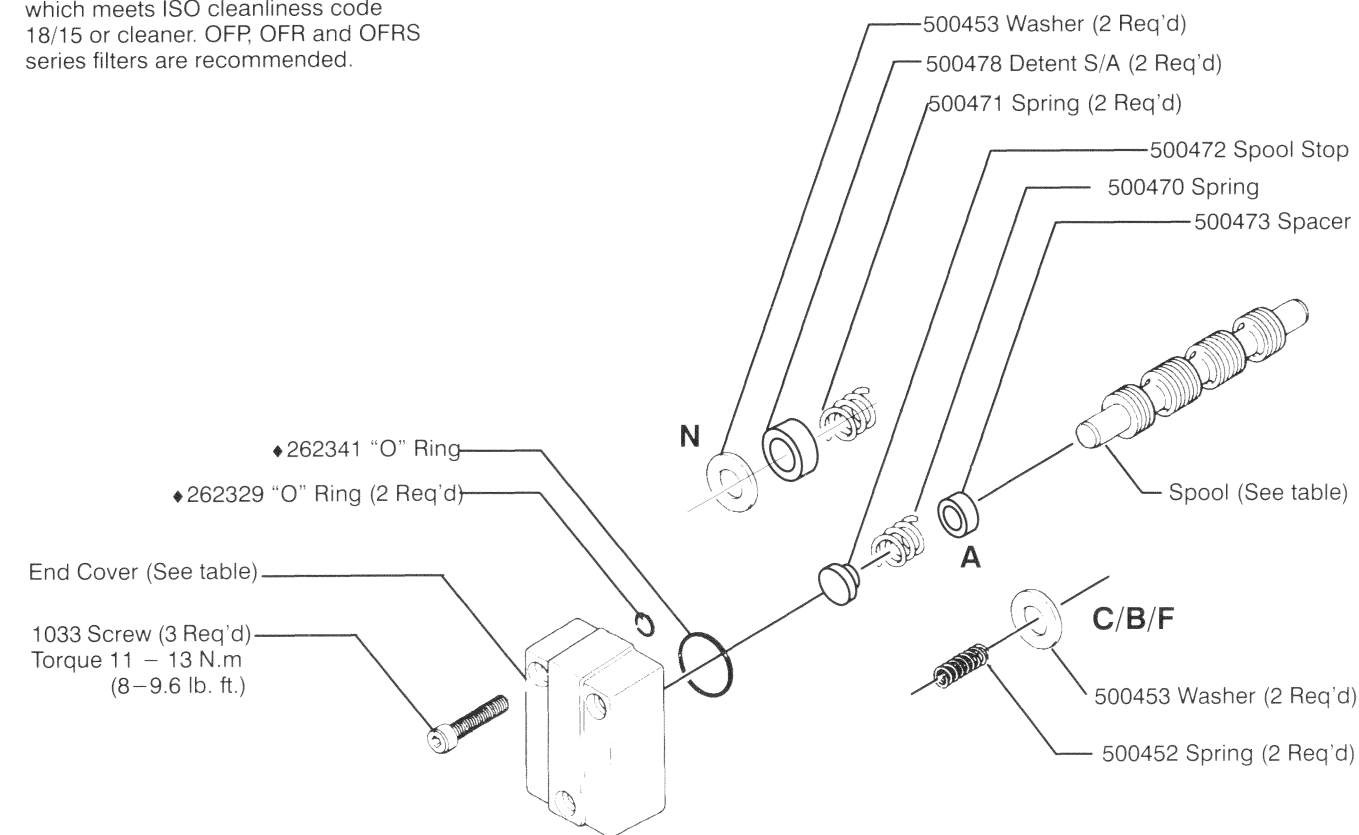

### Pilot Stage Attaching Screws (4 Req'd)

Without Pilot Choke and U, P, F, SP1, or SP2 coils	51969
Without Pilot Choke and X1, X2 coils	582176
With pilot choke and U, P, F, SP1, or SP2 coils	207897
With pilot choke and X1, X2 coils	207900

Torque 4.5 – 5.7 N.m (39.9–50.5 lb. in.)

Valve Model	Main Stage Spool	Pilot Valve Model
DG5S4-02-*A(P)(L)-10	0,2,6,9	DG4V3-2A-60
DG5S4-02-*B/F(P)(L)-10	0,1,2,3,6,7,9, 11,31,33	DG4V3-6B/6F-60
	4,8	DG4V3-68B/68F
DG5S4-02-*N-10	0,2,6,9,33	DG4V3-2N-60
DG5S4-02-C-10	0,1,2,3,4,6,7,8,9, 11,31,33	DG4V-3-6C-60

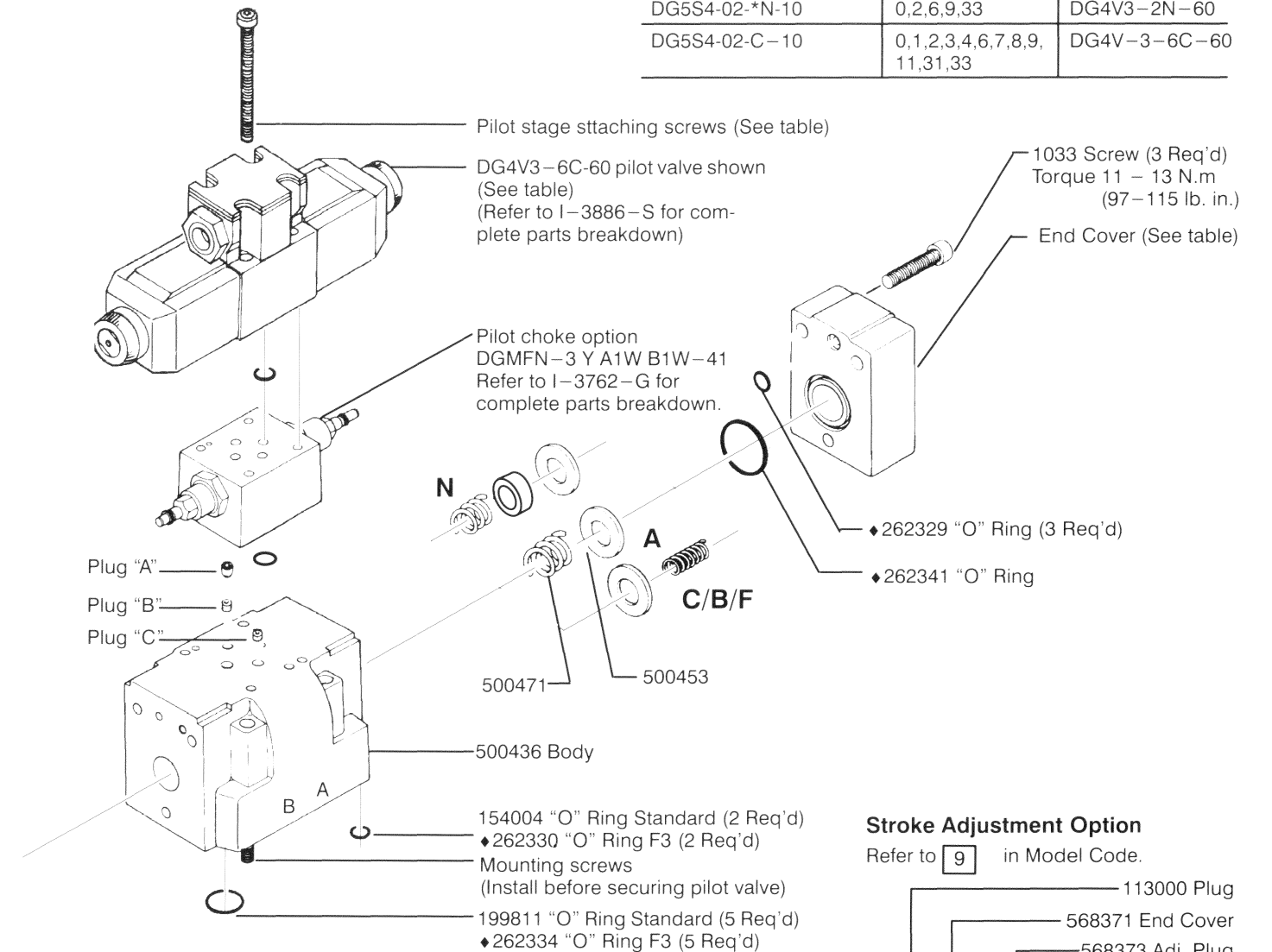

### Stroke Adjustment Option

Refer to **9** in Model Code.

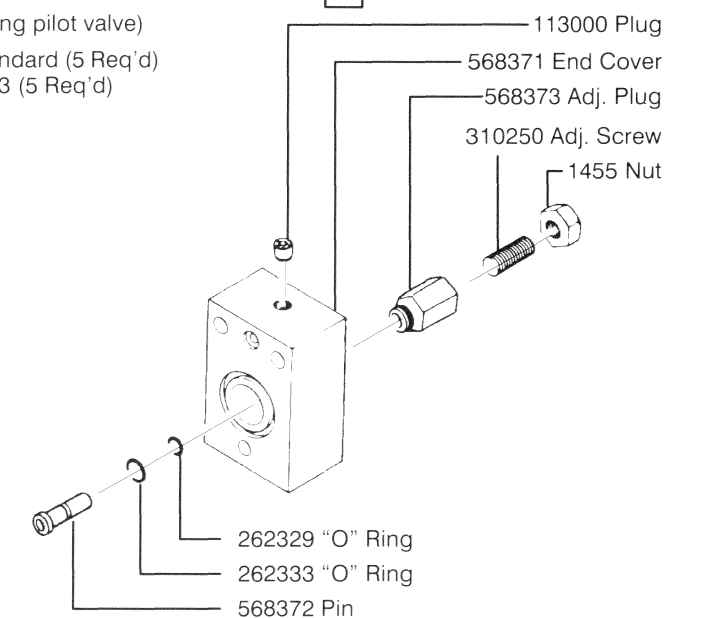

Plug Installation Table

Model	Plug "A"	Plug "B"	Plug "C"
DG5S4-02-*M-*-*-*10	237588	OMIT	
DG5S4-02-X-M-*-*-*10	OMIT	OMIT	500455
DG5S4-02-*E-M-*-*-*10	237588	500469	
DG5S4-02-*T-M-*-*-*10	237588	OMIT	OMIT

237588 Orifice Plug (∅ 0.062)