

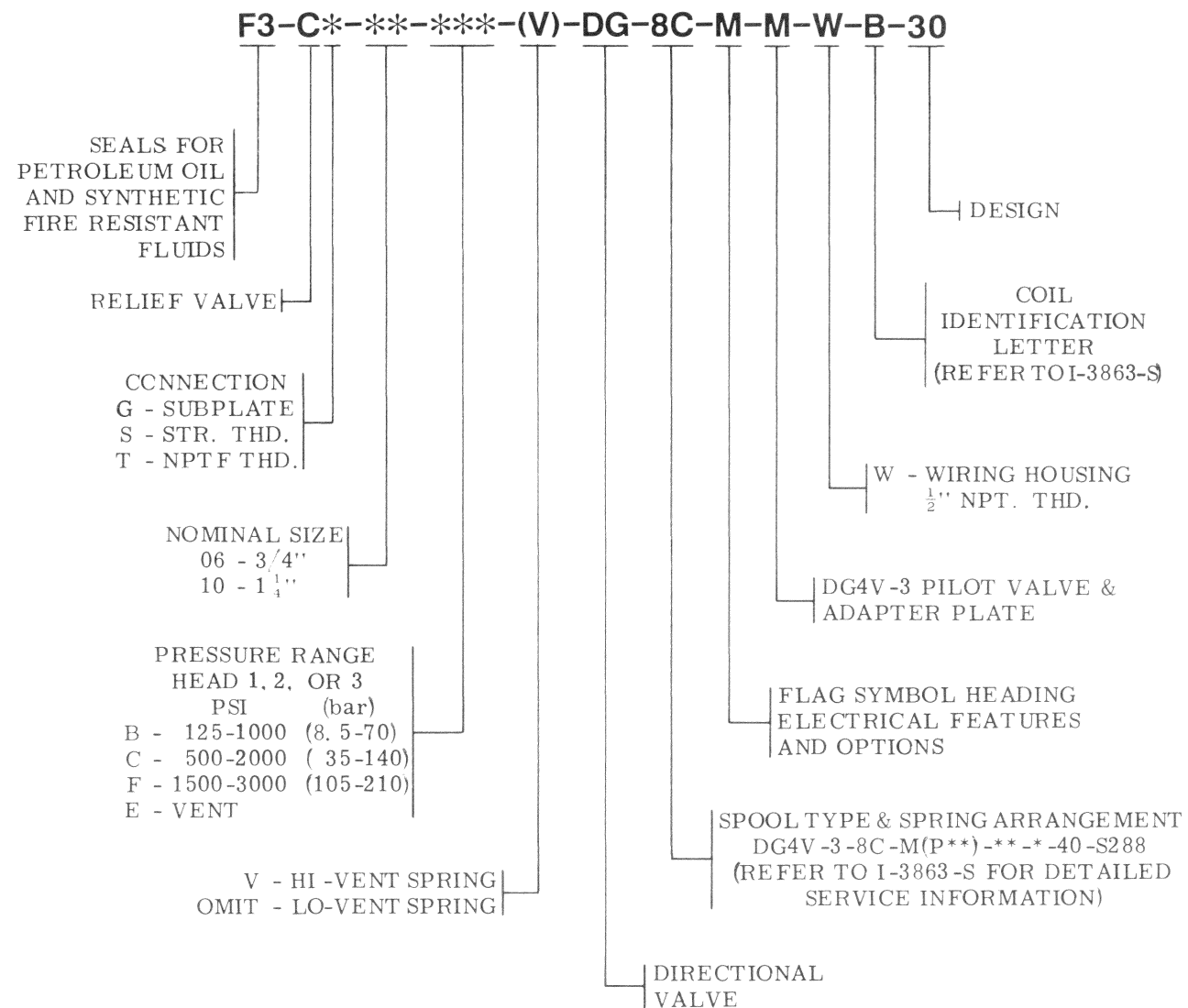

Service Parts Information

MODEL CODE BREAKDOWN



Multi-Pressure Relief Valve

CG/CS/CT-06-**(*)-(V)-DG8C(P)(L)-M(***)-M-**-*-30
 CG/CS/CT-10-**(*)-(V)-DG8C(P)(L)-M(***)-M-**-*-30

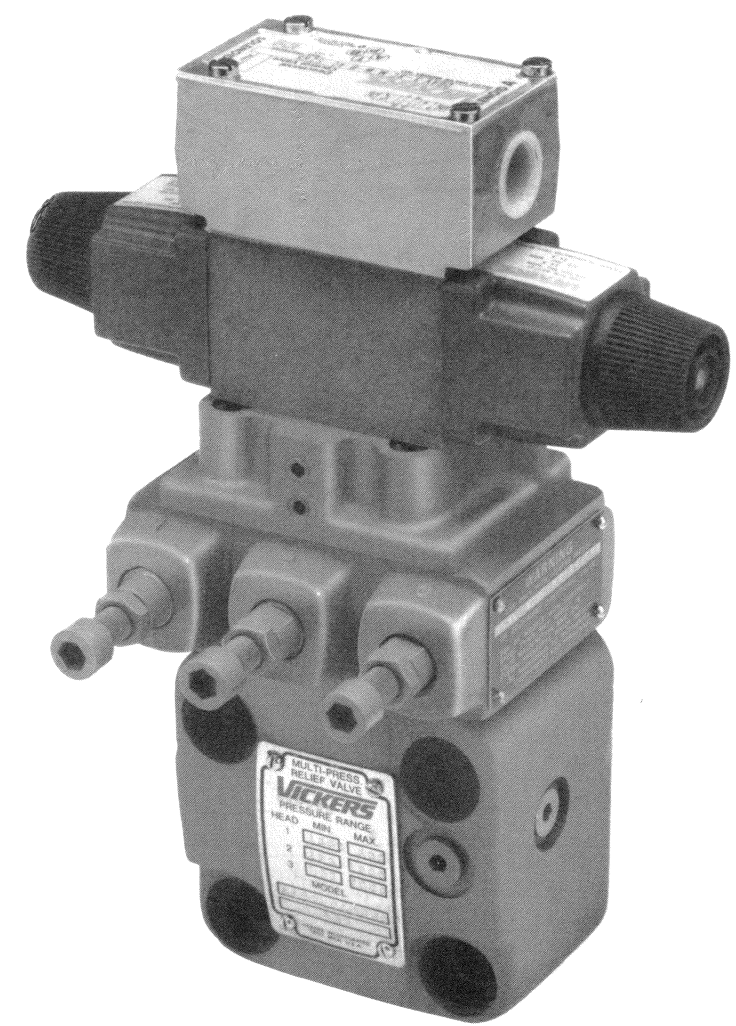

Vickers, Incorporated

1401 Crooks Road
 Troy, Michigan 48084

Released 8-1-86

I-3692-S

For satisfactory service life of these components, use full flow filtration to provide fluid which meets ISO cleanliness code 18 15 or cleaner. Selections from Vickers OFP, OFR, and OFRS series are recommended.

Litho in U. S. A.

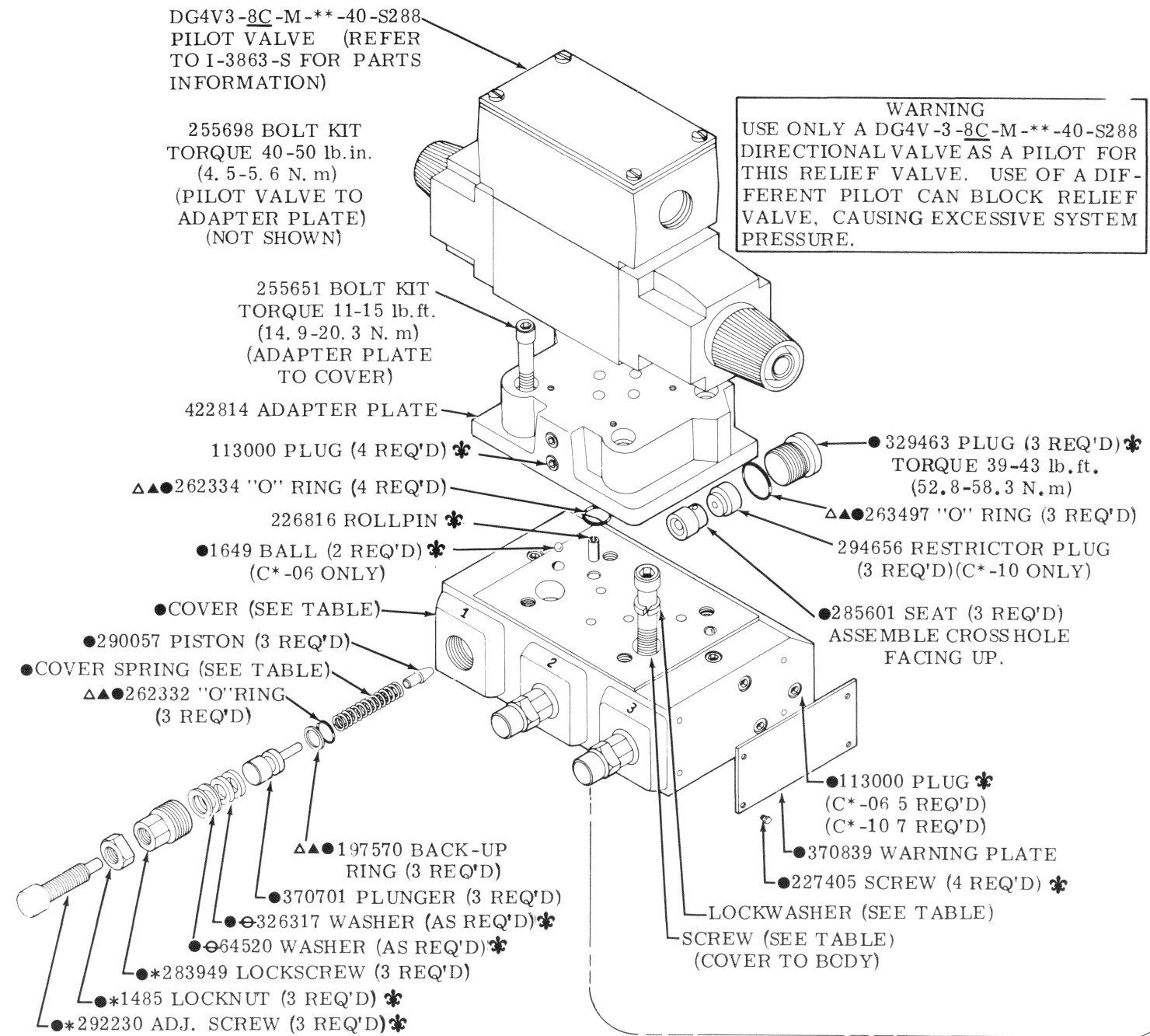

WARNING
USE ONLY A DG4V-3-8C-M-**-40-S288 DIRECTIONAL VALVE AS A PILOT FOR THIS RELIEF VALVE. USE OF A DIFFERENT PILOT CAN BLOCK RELIEF VALVE, CAUSING EXCESSIVE SYSTEM PRESSURE.

MODEL	COVER SPRING	PRESSURE RANGE PSI - (bar)	COVER KITS FOR C*-06-*** ARE AVAILABLE FOR SEVERAL SPRING ARRANGEMENTS.	
C*--B	2280	125-1000 (8.5-70)	SPRING ORDER IN HEAD 1 2 3	●INCLUDED IN KIT (-06 ONLY)
C*--C	583937	500-2000 (35-140)	-CBF-	942198
C*--F	2281	1500-3000 (105-210)	-CBC-	942202
			-FFB-	942326

MODEL	SCREW (4 REQ'D)	TORQUE		L'WASHER (4 REQ'D)
		lb. ft.	N. m	
C*-06	1036	11-15	14.9-20.3	68907
C*-10	1076	35-43	47.5-58.3	68909

*NOTE
COAT 292230 ADJ. SCREW, 283949 LOCKSCREW AND 1485 LOCKNUT WITH OIL PRIOR TO ASSEMBLY.

MODEL	"O" RING	SEAT	HYDRO CONE	LO-VENT SPRING	HI-VENT SPRING	COVER
C*-06	●▲262361	343153	343154	2077	184458	370664
C*-10	▲262367	283954	283952	291822	291821	370669

NOTE: USE EITHER A LO-VENT OR HI-VENT SPRING. DO NOT USE BOTH. SEE MODEL CODE

⊖ THIS PART USED AT FINAL TEST TO OBTAIN CORRECT PRESSURE RANGE.

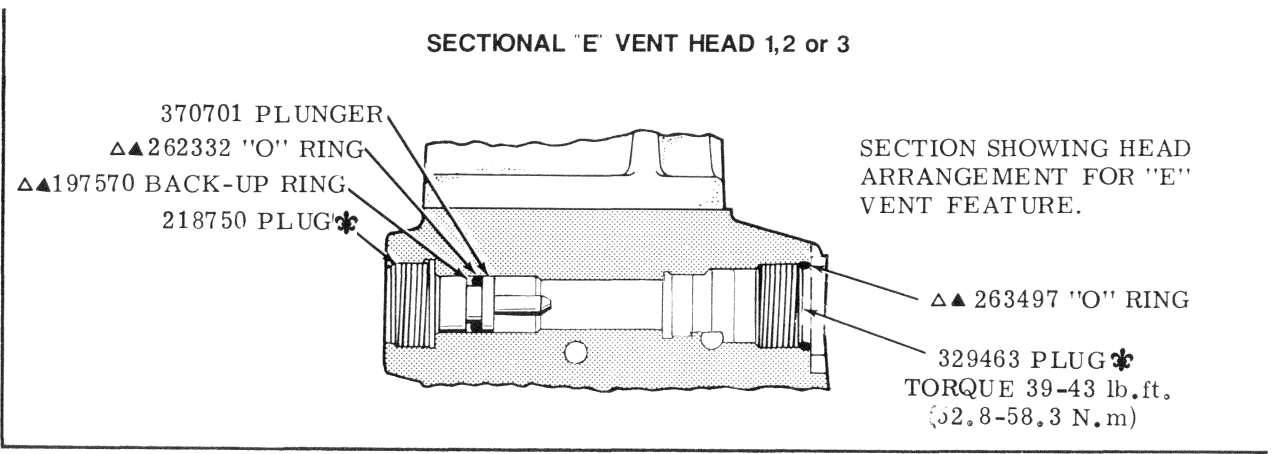

PART	KIT	PART	KIT
1485	944064	226816	944071
1649	944067	227405	944074
AX-36212	944053	292230	944072
64520	944068	326317	944073
113000	944055	329463	944041
160571	944069	343740	944038
218750	944070		

PARTS WITH * AVAILABLE ONLY IN KITS OF 25. REFERENCE KIT ON PARTS ORDER.

MODEL	BODY	
	-06	-10
CG-	580456	581703
CS-	581701	580430
CT-	590348	590300

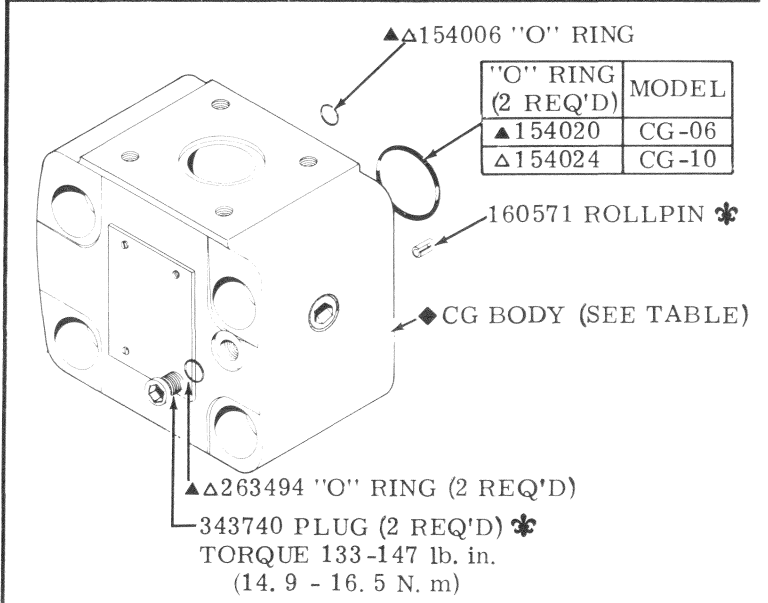
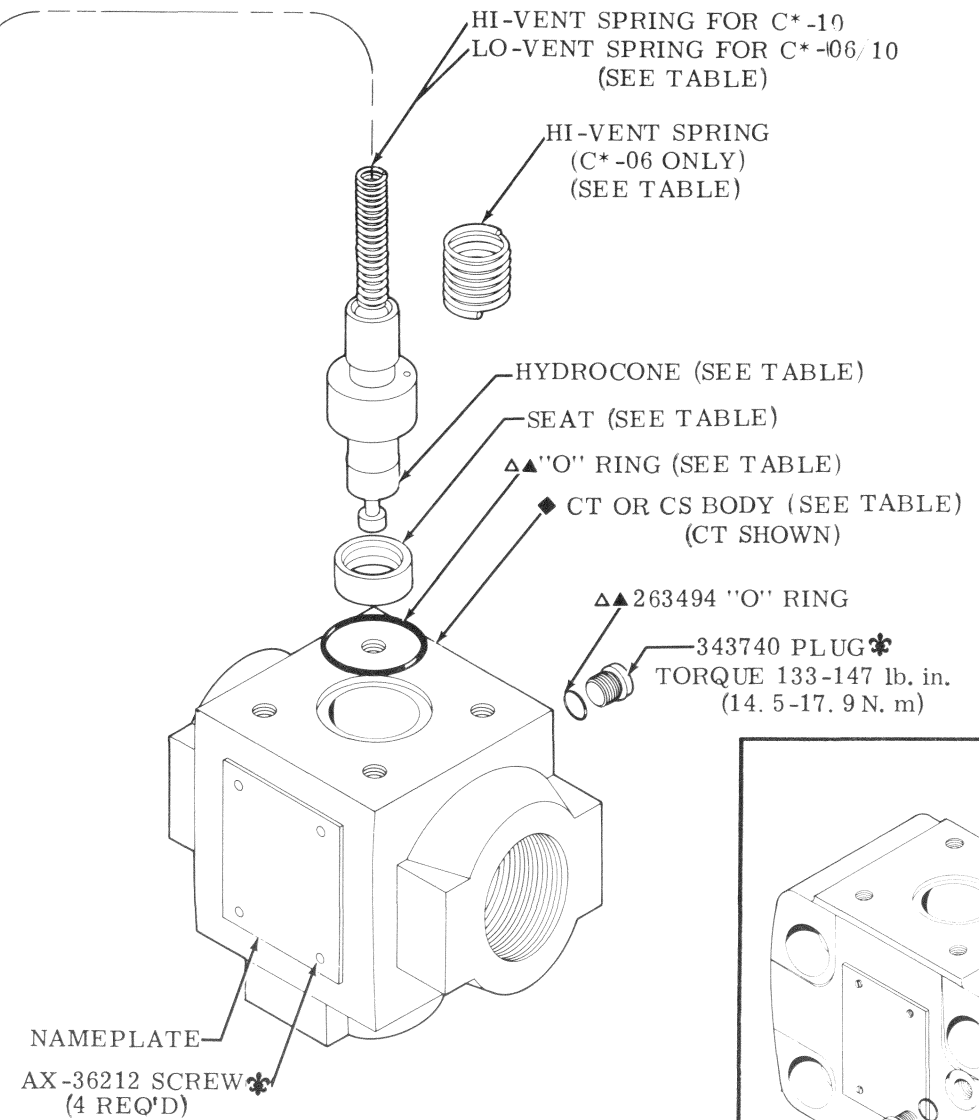

* AVAILABLE ONLY IN KITS OF 25
▲ INCLUDED IN F3 -06 SEAL KIT 919684
▲ INCLUDED IN F3 -10 SEAL KIT 919685
◆ NOT AVAILABLE FOR SALE