

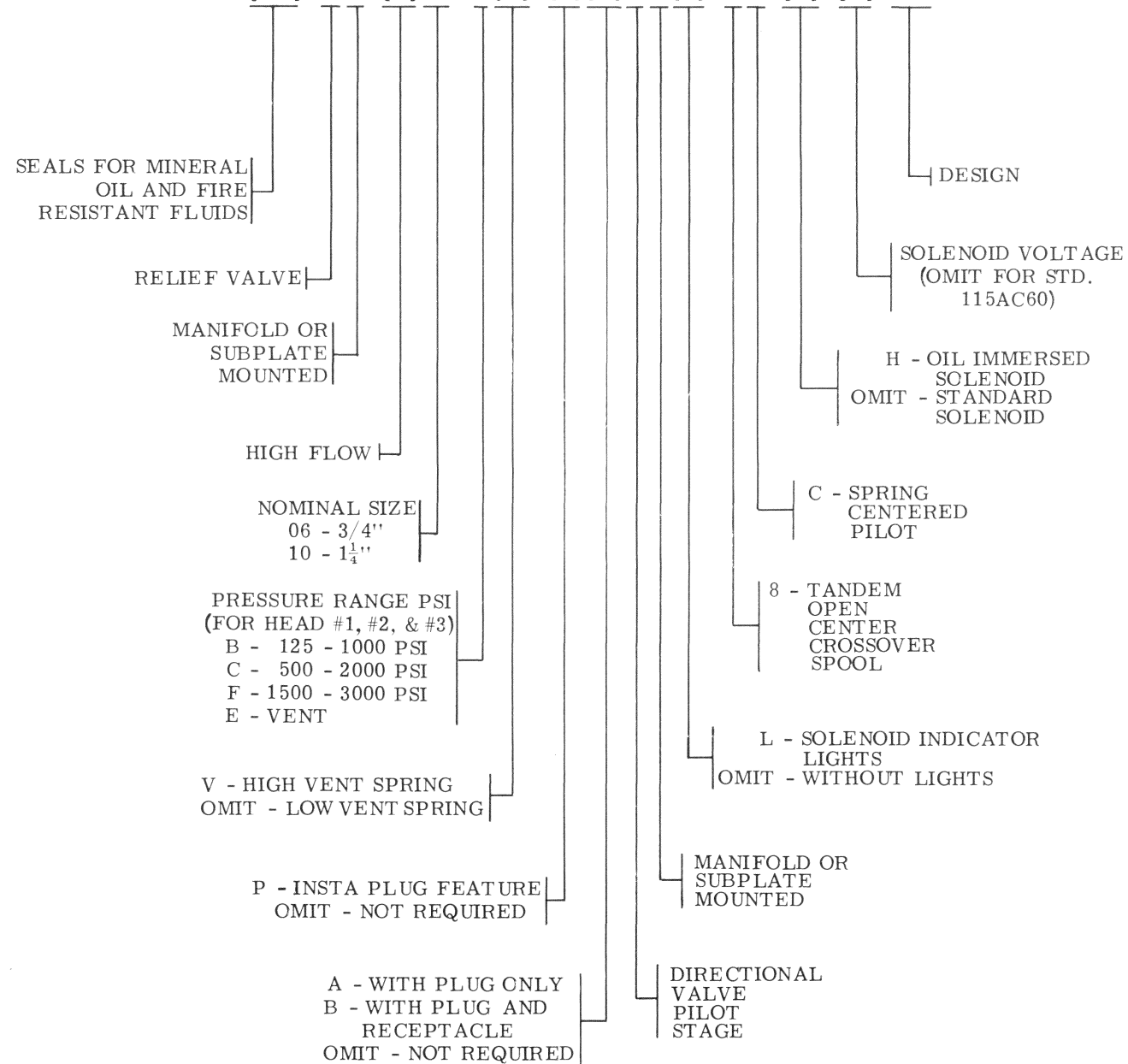

# Service Parts Information

## MODEL CODE BREAKDOWN

**(F3)-CG-(H)\*\*-\* (V)-(P)(\*)DG(L)-8C-(H)-(\*)-20**



CG-(H)-06-\* (V)-(P)(\*)DG(L)-8C-(H)-(\*)-20  
 CG-(H)-10-\* (V)-(P)(\*)DG(L)-8C-(H)-(\*)-20

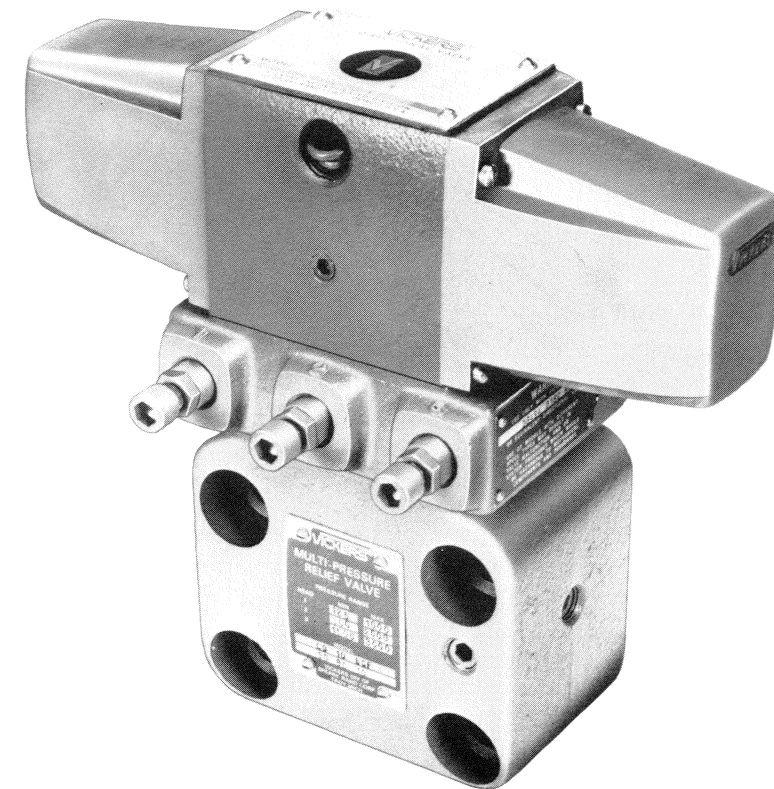

Vickers, Incorporated

1401 Crooks Road  
 Troy, Michigan 48084

Revised 11-1-85

I-3684-S

For satisfactory service life of these components, use full flow filtration to provide fluid which meets ISO cleanliness code 18/15 or cleaner. Selections from Vickers OFF, OFR, and OFRS series are recommended.

MODEL	HEAD #1		HEAD #2		HEAD #3		●CG-(H)06 COVER S/A
	●SPRING	PRESSURE RANGE PSI	●SPRING	PRESSURE RANGE PSI	●SPRING	PRESSURE RANGE PSI	
CG-(H)06/(H)10-CBF			2280	125 - 1000	2281	1500 - 3000	942198
CG-(H)06/(H)10-CEB	583937	500 - 2000	VENT		2280	125 - 1000	
CG-(H)06/(H)10-CBC			2280	125 - 1000	583937	500 - 2000	942202
CG-(H)06/(H)10-FFB	2281	1500 - 3000	2281	1500 - 3000	2280	125 - 1000	942326

●INCLUDED IN  
COVER SUBASSY

INSTA-PLUG CONNECTORS FOR  
DG4S4 PILOT STAGE ARE SHOWN  
ON DRAWING I-3487-S.

OIL IMMERSED SOLENOID  
INFORMATION IS SHOWN  
ON DRAWING I-3498-S.

WARNING  
DO NOT USE OTHER THAN A DG4S4-018C-\*-50  
DIRECTIONAL VALVE AS THE PILOT FOR THIS  
RELIEF VALVE. USE OF A DIFFERENT PILOT  
CAN BLOCK THE RELIEF VALVE CAUSING EX-  
CESSIVE SYSTEM PRESSURE.

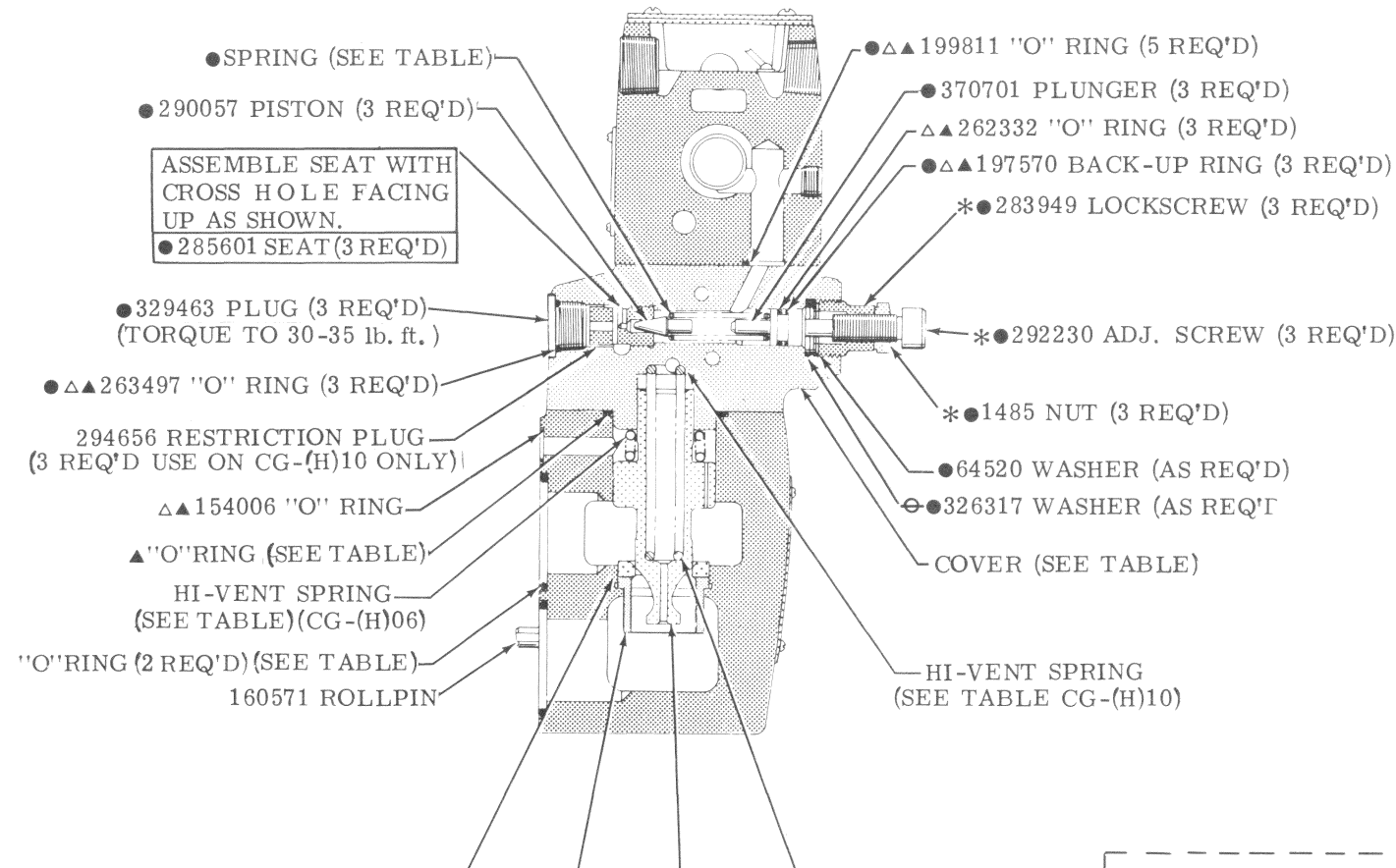

MODEL	"O" RING	"O" RING (2 REQ'D)	BODY	SEAT	SLEEVE	HYDRO CONE	LO-VENT SPRING	HI-VENT SPRING	●COVER
CG-06				343153					
CG-H06	●▲262361	▲154020	580456	589473	589472	343154	2077	184458	370664
CG-10				283954					
CG-H10	●▲262367	▲154024	581703	587996	400730	283952	291822	291821	370669

⊖THIS PART USED AT FINAL  
TEST TO OBTAIN CORRECT  
PRESSURE RANGE.

USE EITHER A LO-VENT OR  
HI-VENT SPRING AS SHOWN.  
DO NOT USE BOTH.

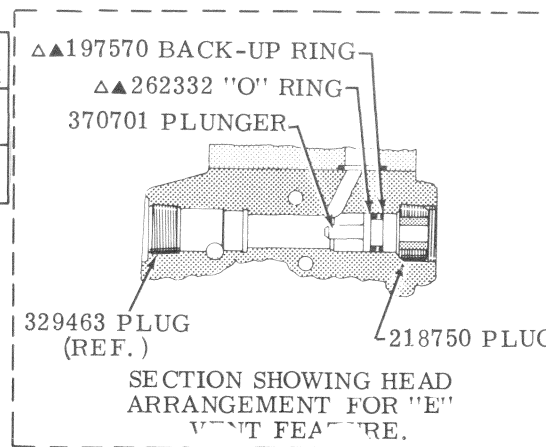

\*NOTE  
COAT 292230 ADJ. SCREW, 283949  
LOCK SCREW, AND 1485 LOCKNUT  
WITH OIL PRIOR TO ASSEMBLY.

DG4S4-018C-\*-50 PILOT VALVE  
(REFER TO I-3477-S FOR PARTS  
INFORMATION)

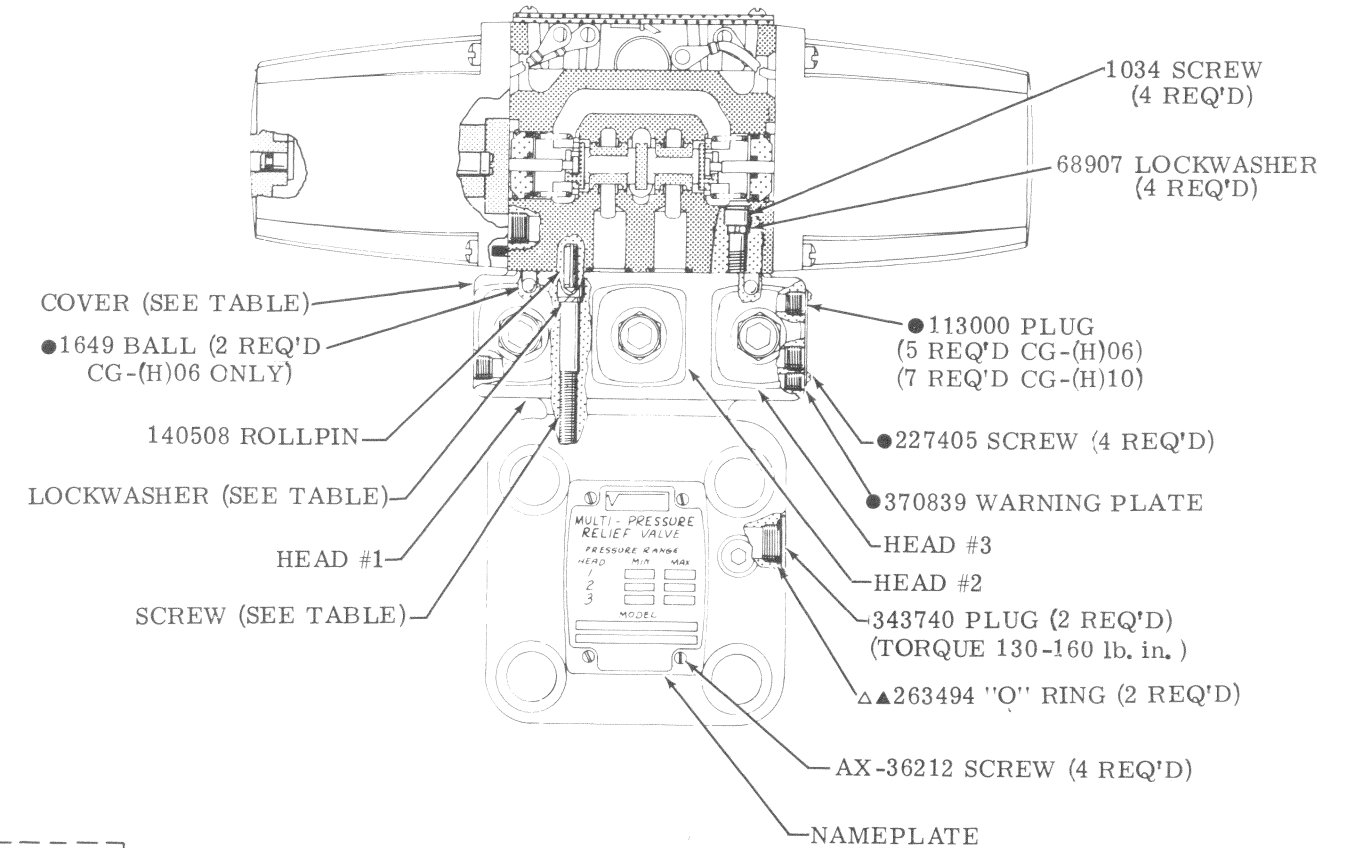

MODEL	SCREW (4 REQ'D)	LOCKWASHER (4 REQ'D)
CG-(H)06	1036	68907
CG-(H)10	1076	68909

▲ INCLUDED IN  
(F3)CG-(H)06  
SEAL KIT 919684

▲ INCLUDED IN  
(F3)CG-(H)10  
SEAL KIT 919685

ALL SEALS, EXCEPT DIRECTIONAL VALVE &  
RELIEF VALVE INTERFACE SEALS, ARE F3.  
USE F3 SEAL KIT TO SERVICE ALL UNITS.