

VALVE MODEL CODE	MAIN STAGE SPOOL	VALVE TYPE	SPOOL	I.D. PLATE W/ CIRCUIT DIAGRAM	
				A ONLY	B, C, N
DG5S4-100-	A/B/C/N		364037	400975	400976
DG5S4-101-	B/C		*331404		400977
DG5S4-102-	A/B/C/N		364038	400975	400978
DG5S4-103-	B/C		*277479		400979
DG5S4-104-	B/C		281193		400980
DG5S4-106-	A/B/C/N		364039	400975	400981
DG5S4-108-	B/C		364041		400980
DG5S4-109-	A/B/C/N		277563	400975	400976
DG5S4-1031-	B/C		*277479		580475
DG5S4-1033-	A/B/C/N		364042	400975	400981

*ASSEMBLE TYPE 1 & 3 SPOOLS WITH NARROW CENTER LAND TOWARD 'A' END OF VALVE. 'A' END OF VALVE IS DEFINED AS BEING CLOSEST TO CYLINDER PORT 'A'. THE TYPE 31 SPOOL IS INSTALLED IN REVERSE OF TYPE '3', WITH NARROW CENTER LAND TOWARD 'B' END OF VALVE.

PLUG INSTALLATION TABLE			
MODEL	PLUG "A"	PLUG "B"	PLUG "C"
DG5S4-10**-53		30560	OUT
DG5S4-10**-E-53	DOES NOT EXIST	7074	30560
DG5S4-10**-X-53		OUT	
DG5S4-10**-X-E-53			OUT
DG5S4-10**-K/L/R/S-53	161809		
DG5S4-10**-E-K/L/R/S-53	113000	7074	30560
DG5S3-10**-X-K/L/R/S-53		OUT	
DG5S4-10**-X-E-K/L/R/S-53	113000		OUT

PILOT ATTACHING PARTS		
MODEL	BOLT (4 REQ'D)	L'WASHER (4 REQ'D)
W/OUT PILOT CHOKE	□ 1034	
W/ PILOT CHOKE (SEE BACK PAGE)	▧ 10937	▧ 68907

TORQUE TO 100-112 lb. in. (11.3-12.7 N. m)

VALVE MODEL CODE	MAIN STAGE SPOOL TYPE	VALVE IS ASSEMBLED:	
		LEFT HAND	RIGHT HAND (STD)
DG5S4-10*A-53	0, 2, 6, 9, 33	DG4S4-012A-*-50-LH	DG4S4-012A-*-50
DG5S4-10*B-53	0, 1, 2, 3, 6, 9, 31, 33	DG4S4-016C-*-50-S163	DG4S4-016C-*-50-S87
	4 & 8	DG4S4-0168C-*-50-S163	DG4S4-0168C-*-50-S87
DG5S4-10*C-53	0, 1, 2, 3, 6, 9, 31, 33		DG4S4-016C-*-50
	4 & 8		DG4S4-0168C-*-50
DG5S4-10*N-53	0, 2, 6, 9, 33		DG4S4-012N-*-51

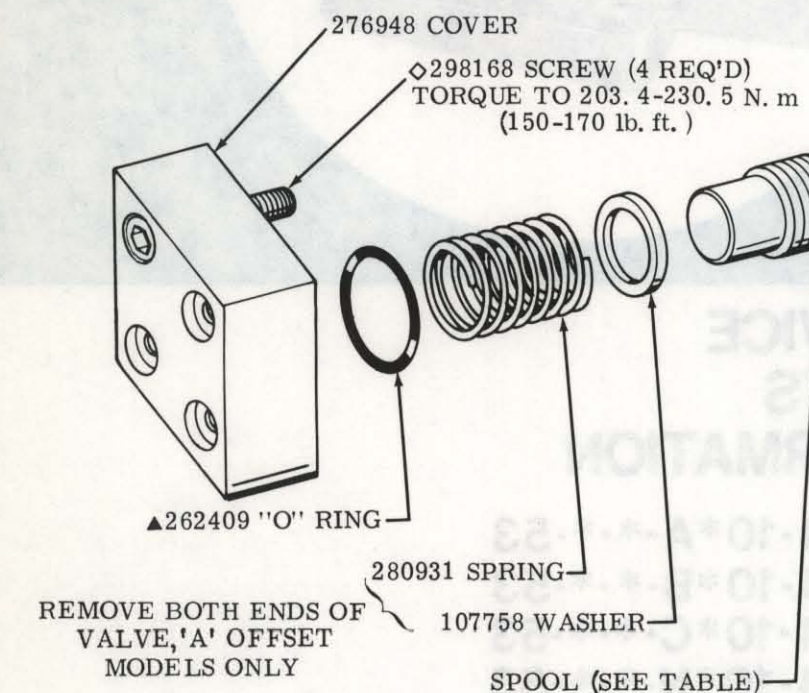

- ▲▲ INCLUDED IN F3 SEAL KIT 920213
- ◇ INCLUDED IN FASTENER KIT 941262
- INCLUDED IN BOLT KIT 255633
- ▧ INCLUDED IN BOLT KIT 255637
- * INCLUDED IN PLUG KIT 941263
- PLUG TORQUES (SEE TABLE)
- ◆ NOT AVAILABLE FOR SALE
- ⊕ USED ON CHECK VALVE MODELS ONLY

NOTE
PARTS INCLUDED IN SERVICE KITS NOT SOLD SEPARATELY

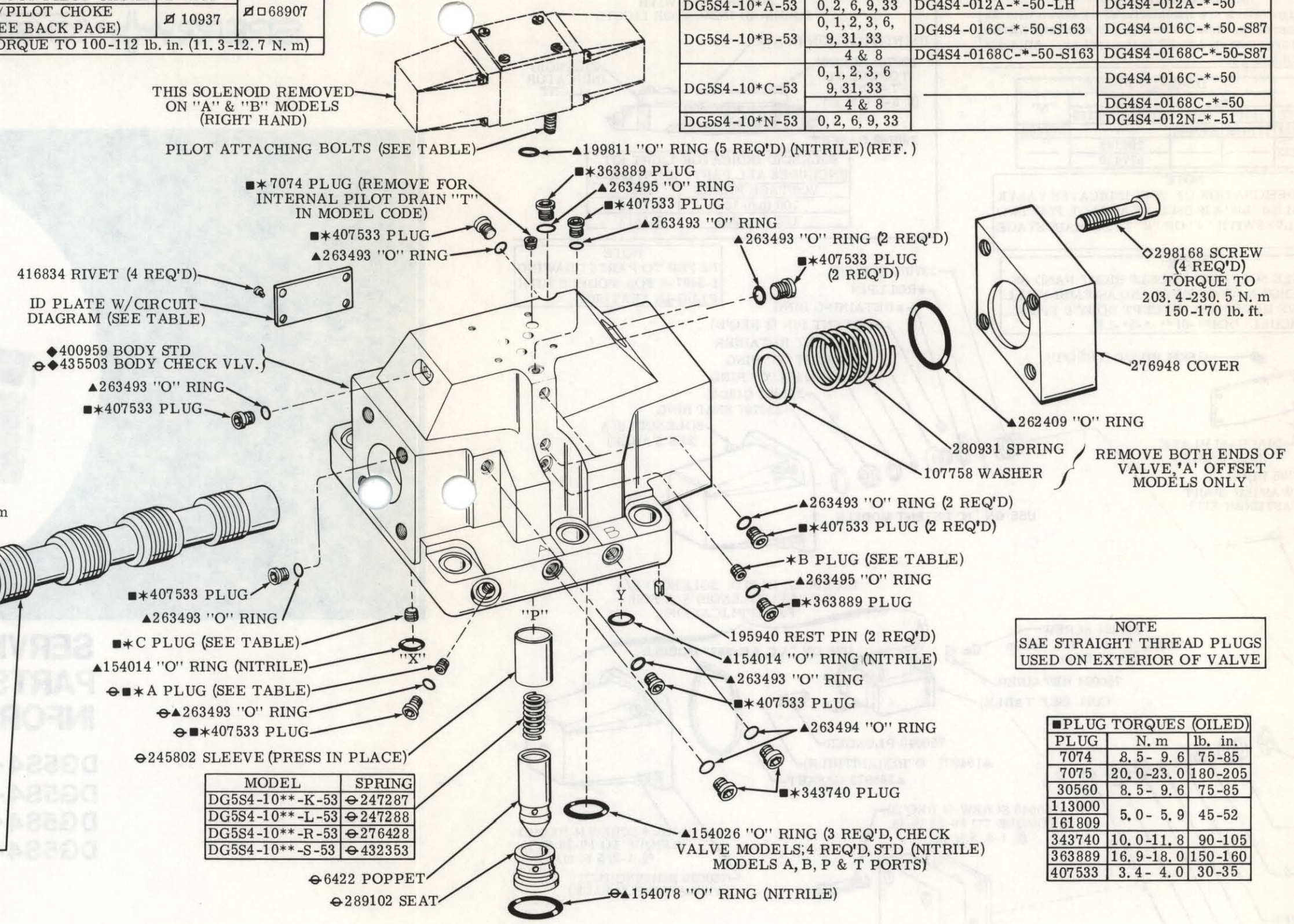

NOTE
SAE STRAIGHT THREAD PLUGS USED ON EXTERIOR OF VALVE

SEAL KIT NOTE
The -53 design valves are manufactured as shown with F3 seals used internally. Interface seals are standard Nitrile material and are converted to F3 in the seal kit. All seals in the seal kit are F3.

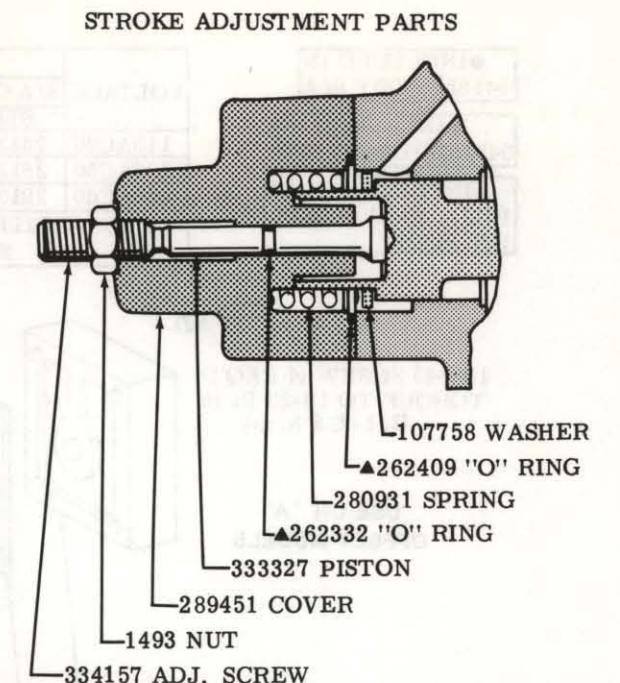
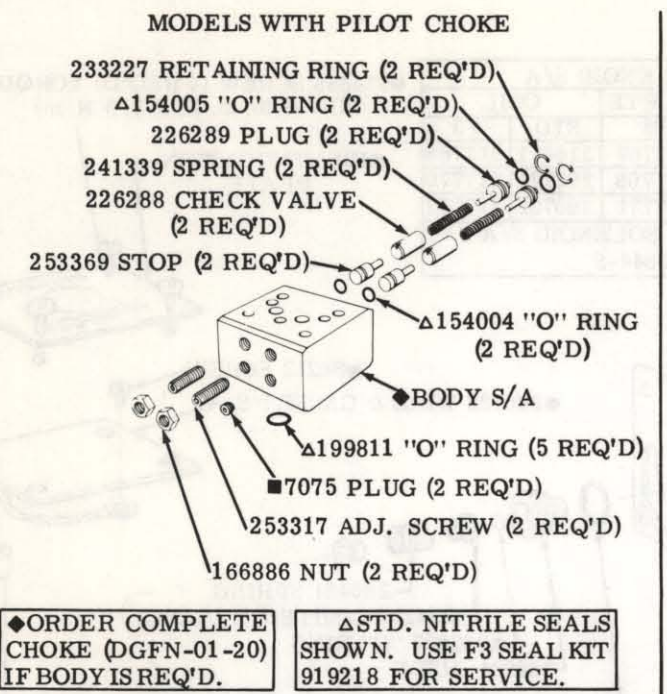

MODEL CODE BREAKDOWN

(F3)-(P) DG5S4(L)-10**(X)(*)-(E)-(T)-(*)-(**AC**)-53-LH**

- MULTI-FLUID CAPABILITY (VITON SEALS)
- ELECTRICAL PLUG FEATURE (SEE NOTE BELOW)
- DIRECTIONAL VALVE
- SUBPLATE OR MANIFOLD MOUNTED
- SOLENOID CONTROLLED
- PILOT OPERATED
- SLIDING SPOOL
- FLOW DIRECTIONS 4 - 4 WAY
- L - SOLENOID INDICATOR LIGHTS
- OMITTED - NONE
- 1.25 INCH SERIES 100
- TYPE OF MAIN STAGE SPOOL
- VALVE TYPE
 - A - SPRING OFFSET
 - B - SPRING CENTERED (ONE SOLENOID)
 - C - SPRING CENTERED
 - N - NO SPRING DETENTED
- LEFT HAND ASSEMBLY
- DESIGN
- VOLTAGE & FREQUENCY OMITTED - 115AC60 STD.
- CHECK VALVE
- OMITTED - NO CHECK VALVE
- K - 5 PSI (0.35 bar)
- L - 35 PSI (2.4 bar)
- R - 50 PSI (3.45 bar)
- S - 75 PSI (5.2 bar)
- T - INTERNAL PILOT DRAIN
- OMITTED - EXTERNAL PILOT DRAIN
- E - EXTERNAL PILOT PRESSURE
- OMITTED - INTERNAL PILOT PRESSURE
- SPOOL CONTROL MODIFICATIONS (OMIT IF NOT REQUIRED)
 - 1-STROKE ADJUSTMENTS
 - 2-PILOT CHOKE ADJS.
 - 3-PILOT CHOKE & STROKE ADJ
 - 7-STROKE ADJ "A" END ONLY
 - 8-STROKE ADJ "B" END ONLY
- "X" - FAST RESPONSE MODEL
- OMITTED - LOW SHOCK MODEL

ELECTRICAL PLUG FEATURE (OMIT IF NOT REQUIRED)

PA - INSTA-PLUG, MALE RECEPTACLE ONLY	PA3 (3 PIN) & PA5 (5 PIN) RECEPTABLES THAT MEET NFPA HYDRAULIC VALVE ELECTRICAL STANDARD T3.5.29M-1980.
PB - INSTA-PLUG, MALE & FEMALE RECEPTACLE	

To insure sustained efficiency and maximum trouble-free life of this precision equipment, initial and continuous filtration of the fluid medium to 35 microns absolute or less is essential. (For information pertaining to Sperry Vickers economical filters, see bulletin 81-216.)

- INCLUDED IN 941853 BODY S/A
- * INCLUDED IN 942132 DETENT KIT
- ▲ INCLUDED IN F3 PILOT VALVE SEAL KIT 919214

VOLTAGE	SOLENOID S/A			
	S/A COMPLETE		COIL	
	STD	F3	STD	F3
115AC60	281291	317767	316011	317768
230AC60	281292	317769	298721	317770
460AC60	281293	317771	298722	317772

FOR ADDITIONAL SOLENOID S/A'S SEE I-3544-S

- 174638 SCREW (4 REQ'D) TORQUE TO 7-9 lb. in. (0.8-1.0 N.m)
- IDENTIFICATION PLATE

SEAL KIT NOTE
The -53 design valves are manufactured as shown with F3 seals used internally. Interface seals are standard Nitrile material and are converted to F3 in the seal kit. All seals in the seal kit are F3.

SPOOL	DIAGRAM PLATE				
	"A"		"C"		
TYPE	PART	LH	RH	STD/S87/S163	"N"
2	213231	577490	290348		577486
6	213232			290345	
68				577480	

NOTE
A SPOOL DESIGNATION OF (68B) INDICATES VALVE IS ASSEMBLED "LH" & IS USED AS A PILOT FOR TWO STAGE VALVES WITH "4" OR "8" TYPE MAIN STAGE SPOOLS.

NOTE
FOR SINGLE SOLENOID MODELS RIGHT HAND ASSEMBLY SHOWN. FOR LEFT HAND ASSEMBLY ALL PARTS ARE REVERSED, EXCEPT BODY & SPOOL. EX. LH MODEL: DG4S4-01**-*-5*-LH

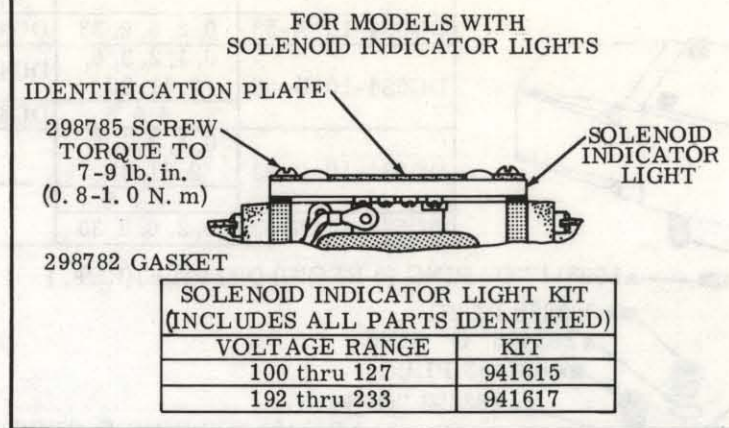

NOTE
REFER TO PARTS DRAWING I-3487-S FOR MODELS WITH PLUG-IN FEATURE.

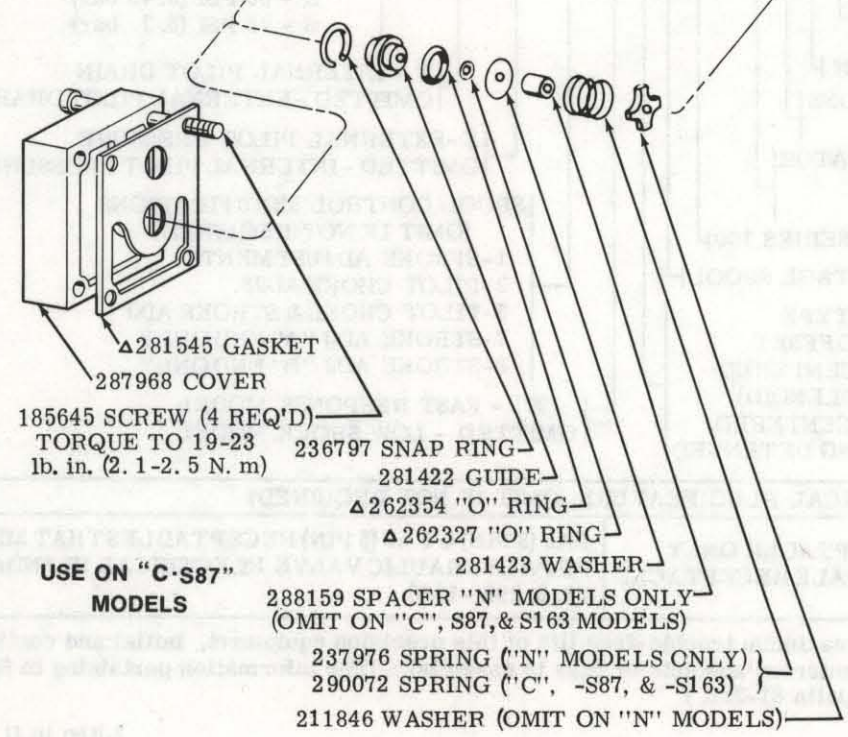
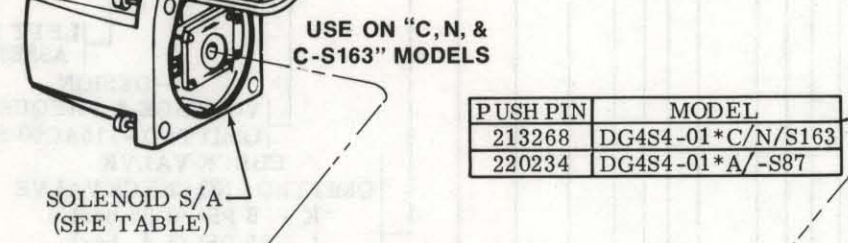
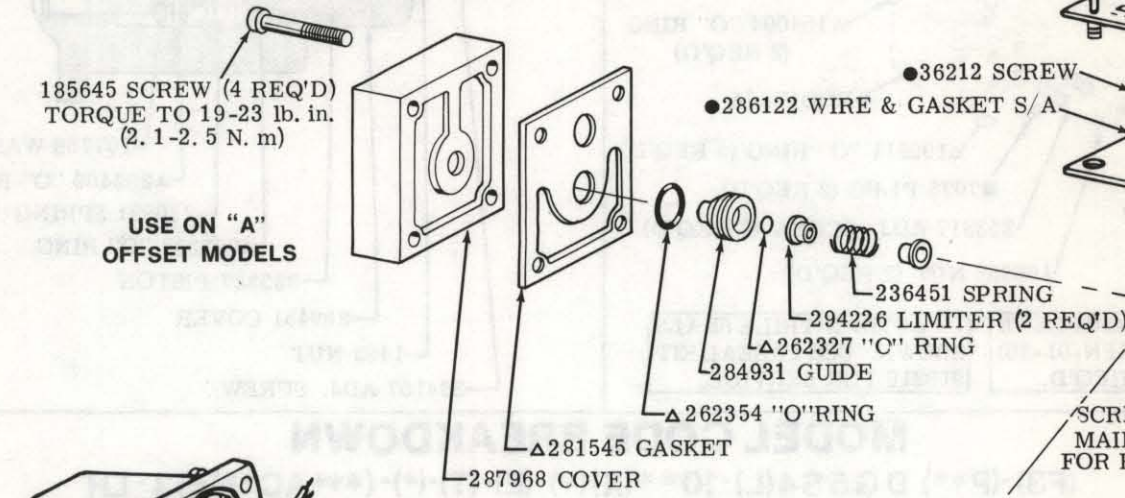

MODEL	PUSH PIN
DG4S4-01*A/C/N/S87	213268
DG4S4-01**-S163	220234

- 7074 PLUG
- 941853 BODY S/A
- ▲ 199811 "O" RING (5 REQ'D) (NITRILE)

MODEL	PUSH PIN
DG4S4-01*A/C/N/S87	213268
DG4S4-01**-S163	220234

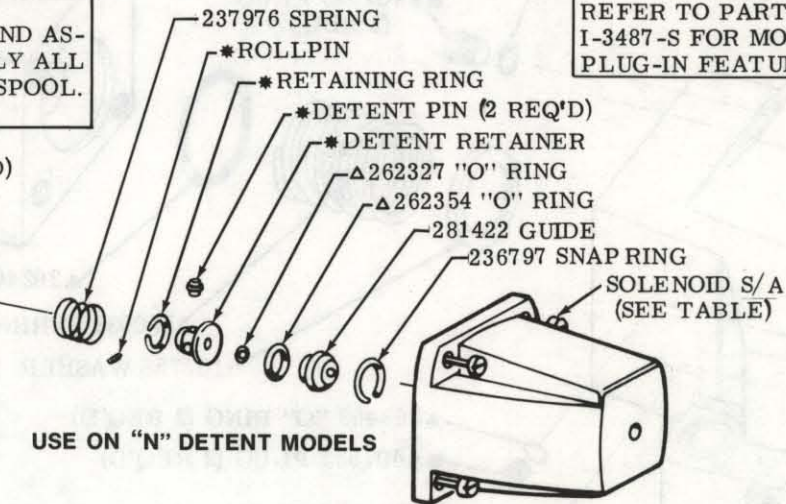
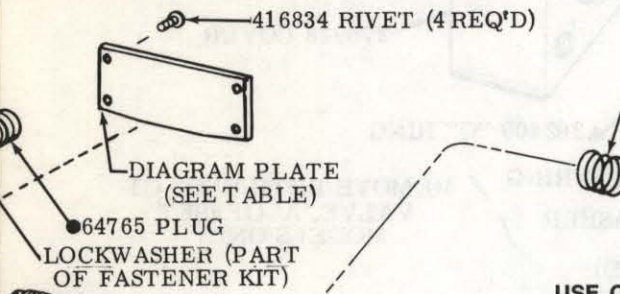
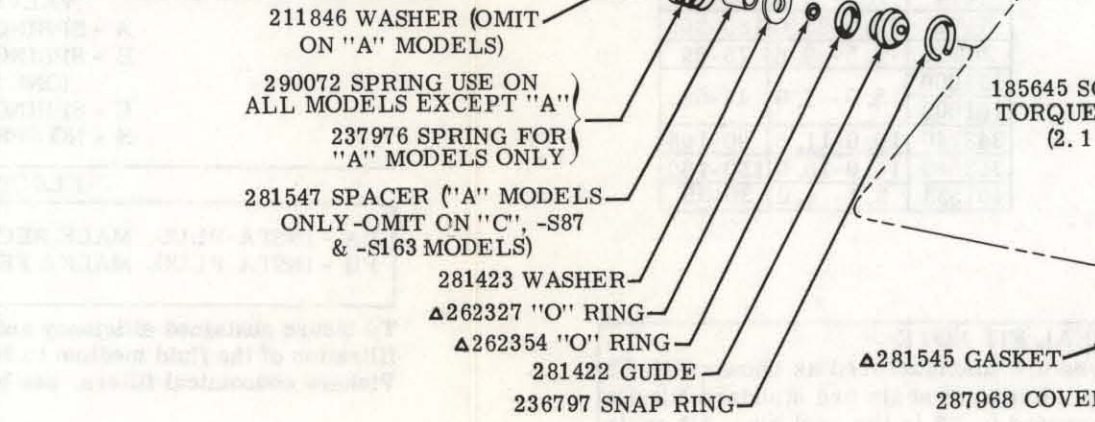

INCLUDED IN STD. SOLENOID S/A. USE "F3" SOLENOID S/A FOR "F3" APPLICATIONS.

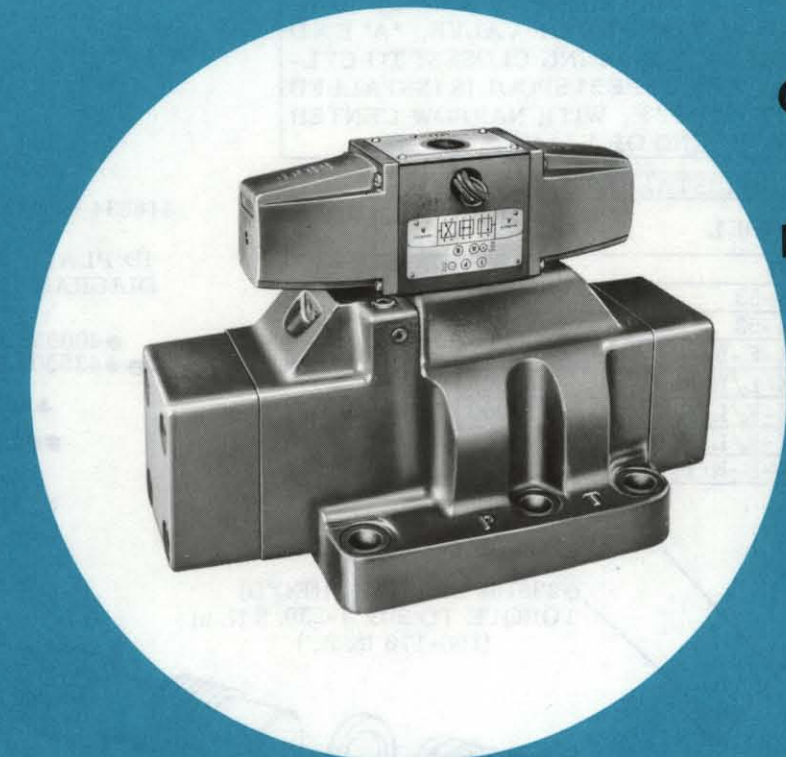
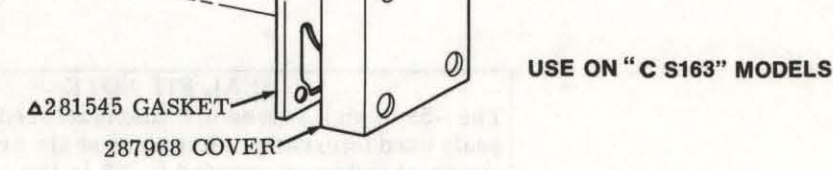
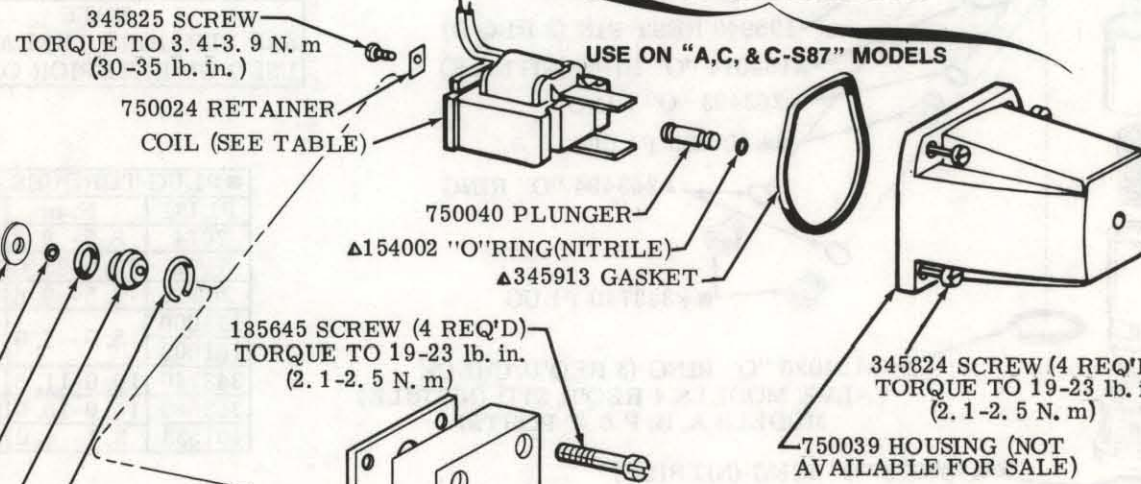

AIR GAP SOLENOID CONTROLLED PILOT OPERATED DIRECTIONAL CONTROL VALVE

SERVICE PARTS INFORMATION

- DG5S4-10*A-**-53
- DG5S4-10*B-**-53
- DG5S4-10*C-**-53
- DG5S4-10*N-**-53

SPERRY VICKERS
TROY, MI. 48084