

**PILOT CHOKE**

MODEL NO. DGMFN-3-Y-A2W-B2W-20

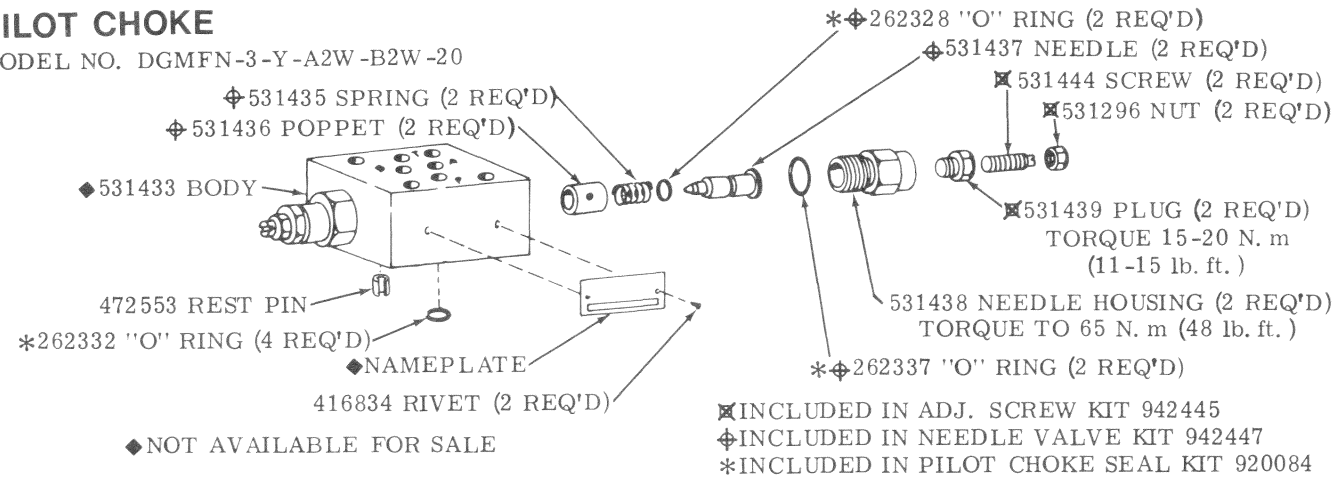

**MODEL CODE BREAKDOWN**

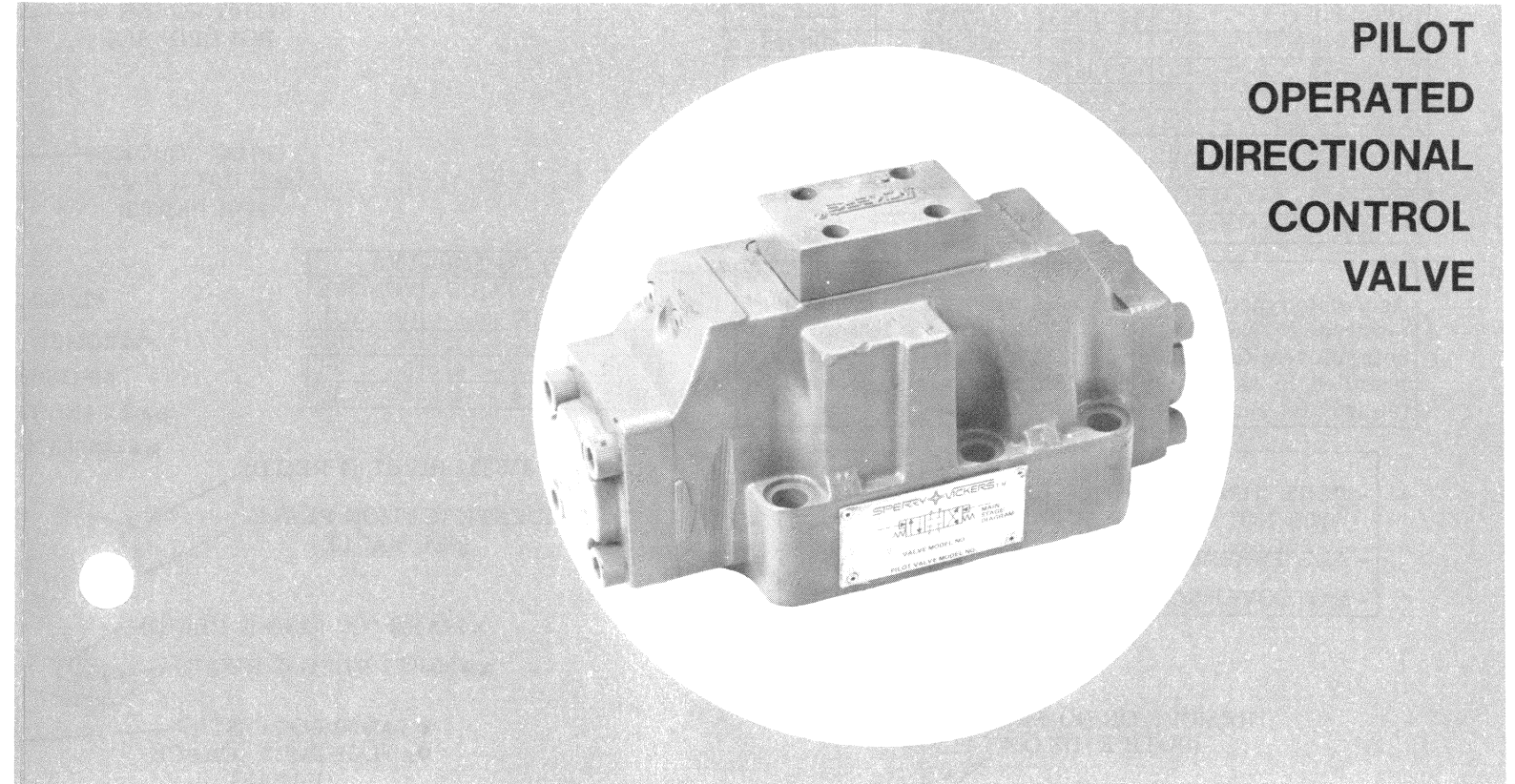
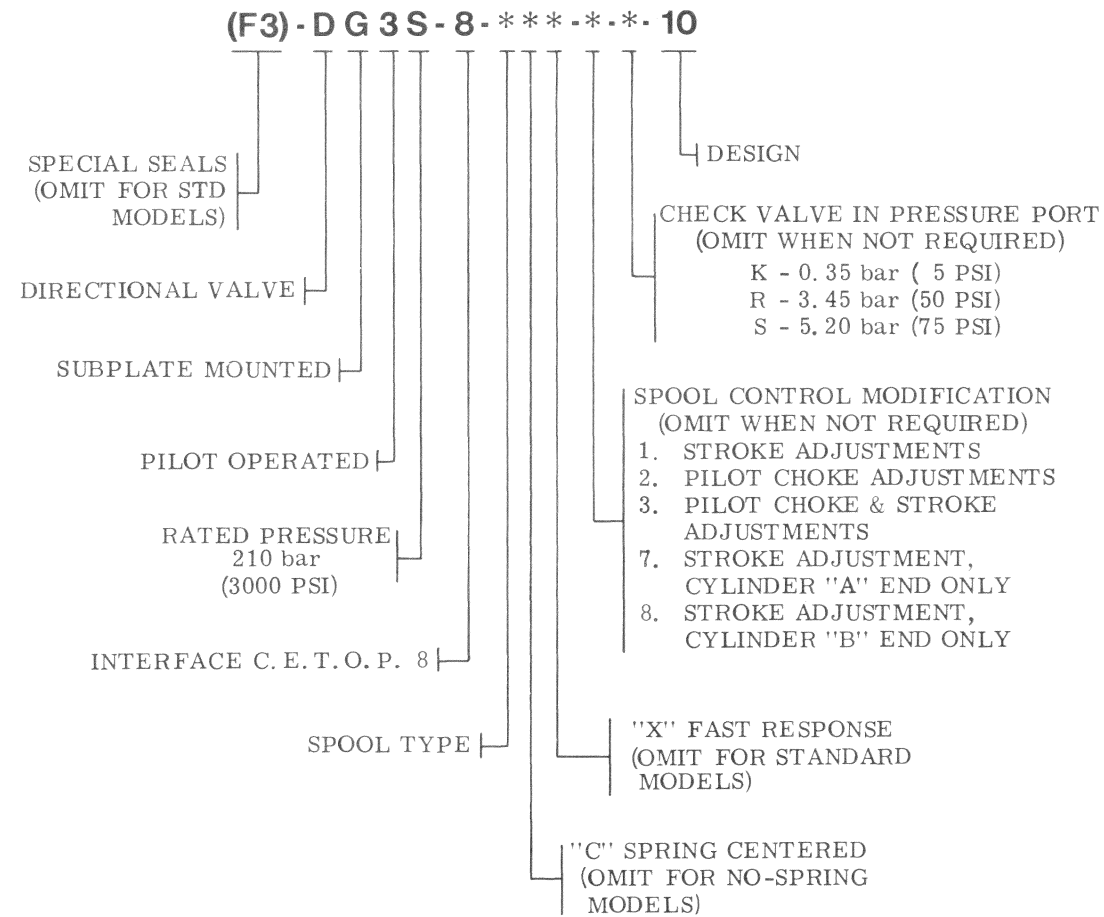

**SERVICE PARTS INFORMATION**

- (F3)-DG3S-8-\*C\*-\*\*-10 Spring Centered**
- (F3)-DG3S-8-\*\*\*-\*\*-10 No-Spring**

To insure sustained efficiency and maximum trouble-free life of this precision equipment, initial and continuous filtration of the fluid medium to 25 microns absolute or less is essential. (For information pertaining to Sperry Vickers economical 3 or 10 micron filters, see installation drawing 522140.)

MODEL	SPOOL	I. D. PLATE WITH CIRCUIT DIAGRAM	
		SPRING CTR	NO-SPRING
DG3S-8-0(C)*--*-10	393495	400976	400975
DG3S-8-1 C *--*-10	*276623	400977	—
DG3S-8-2(C)*--*-10	363496	400978	400975
DG3S-8-3 C *--*-10	*276625	400979	—
DG3S-8-4 C *--*-10	276626	400980	—
DG3S-8-6(C)*--*-10	363498	400981	400975
DG3S-8-8 C *--*-10	363499	400980	—
DG3S-8-9(C)*--*-10	363500	400976	400975
DG3S-8-31 C *--*-10	*276625	580475	—
DG3S-8-33 C *--*-10	363501	400981	—

**\*NOTE**  
Assemble type '1' and '3' spools with narrow center land towards 'A' end of valve. 'A' end of valve is defined as being closest to cylinder port 'A'. Type '31' spools are installed in reverse of type '3', with narrow center land toward 'B' end of valve.

**NOTE**  
- PART NUMBERS INCLUDED IN SERVICE KITS WILL NOT BE SOLD SEPARATELY  
- ALL THREADED FASTENERS ARE METRIC  
- END COVER SCREWS ARE METRIC GRADE 12.9

COVER ATTACHING SCREWS	
MODEL	SCREW (4 REQ'D)
WITHOUT PILOT CHOKE	□473726
WITH PILOT CHOKE	◊473734

TORQUE TO 4.5 - 5.7 N.m  
(39.8 - 50.4 lb. in.)

■ PLUG TORQUES		
PLUG	TORQUE (N. m.)	TORQUE (lb. in.)
343740	10.0 - 11.8	90 - 105
398071	3.4 - 4.0	30 - 35
407533	3.4 - 4.0	30 - 35

REMOVE ON NO-SPRING MODELS (BOTH ENDS OF VALVE)

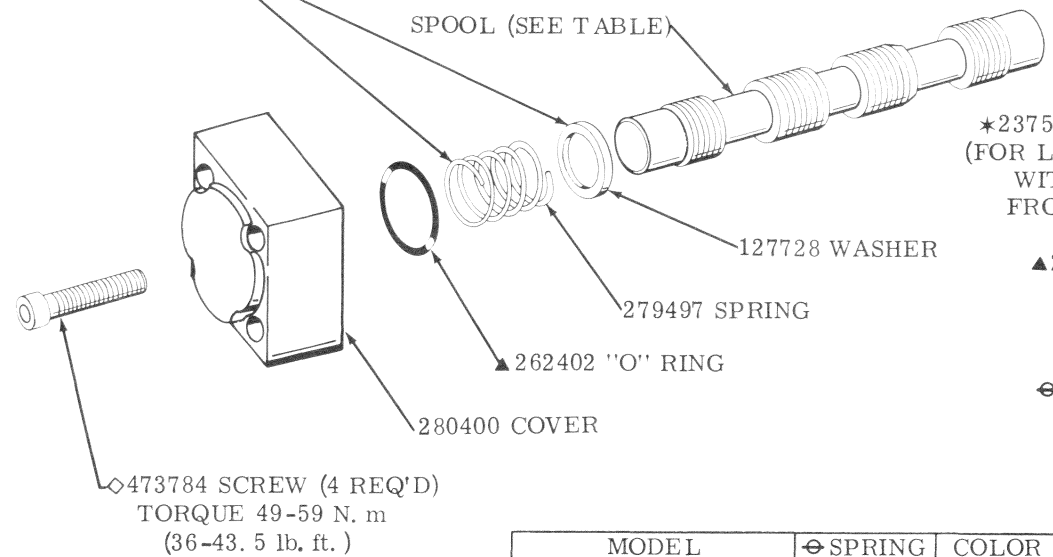

MODEL	⊖ SPRING	COLOR
DG3S-8-(C)*--*-K-10	398130	—
DG3S-8-(C)*--*-R-10	398131	YELLOW
DG3S-8-(C)*--*-S-10	398132	RED

941157 COVER & ROLLPIN S/A

PILOT CHOKE (SEE BACK PAGE FOR PARTS)

416834 RIVET (4 REQ'D)  
IDENTIFICATION PLATE (SEE TABLE)

▲263492 'O' RING (2 REQ'D)  
■\*398071 PLUG (2 REQ'D)  
◆400990 BODY (STD)  
◆400989 BODY (CHECK VALVE)

\*237588 ORIFICE PLUG (FOR LOW SHOCK MODELS WITH 'X' OMITTED FROM MODEL CODE)

▲262389 'O' RING (2 REQ'D) (X & Y PORTS)

⊖ SPRING (SEE TABLE)

⊖ 580449 VALVE

⊖ 580450 SEAT

▲262394 'O' RING (4 REQ'D) (A, B, P & T PORTS)

262335 'O' RING (2 REQ'D)  
262332 'O' RING (4 REQ'D) (REF.)  
472553 ROLLPIN  
⊖▲263493 'O' RING  
\*⊖113000 PLUG  
⊖▲263492 'O' RING  
■\*⊖398071 PLUG

■\*⊖407533 PLUG  
\*471119 SET SCREW (BOND IN PLACE WITH LOCTITE H/S OR EQUIVALENT)

■\*398071 PLUG ▲263492 'O' RING  
■\*⊖398071 PLUG ▲263492 'O' RING

▲263492 'O' RING (2 REQ'D)  
■\*398071 PLUG (2 REQ'D)

199312 REST PIN (2 REQ'D)  
\*113000 PLUG (DOES NOT EXIST ON CHECK VALVE MODELS)

▲263494 'O' RING (2 REQ'D)

■\*343740 PLUG (2 REQ'D)

▲262492 'O' RING (3 REQ'D)

■\*398071 PLUG (3 REQ'D)

▲262394 'O' RING (4 REQ'D) (A, B, P & T PORTS)

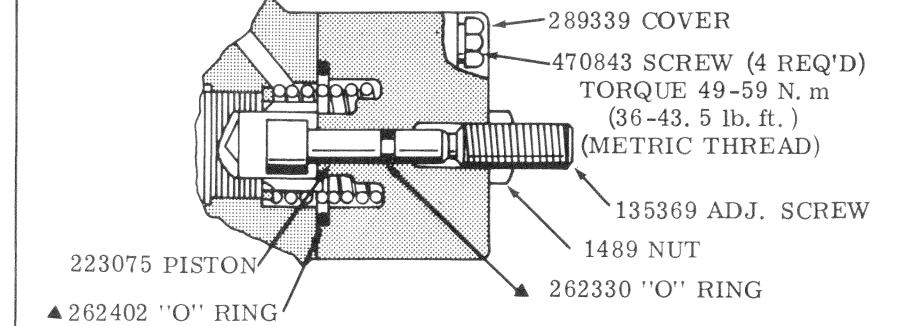

PARTS SHOWN INCLUDED IN STROKE ADJUSTMENT KIT 941154. ORDER TWO KITS IF STROKE ADJUST FOR BOTH ENDS IS REQUIRED.

⊖473784 SCREW (4 REQ'D)  
TORQUE 49-59 N.m  
(36-43.5 lb. ft.)

280400 COVER

▲262402 'O' RING

279497 SPRING  
127728 WASHER

REMOVE ON NO-SPRING MODELS (BOTH ENDS)

▲INCLUDED IN F3 SEAL KIT 920149  
□INCLUDED IN FASTENER KIT 941164  
◊INCLUDED IN FASTENER KIT 941166  
◊INCLUDED IN FASTENER KIT 941165  
\*INCLUDED IN PLUG KIT 941167  
◆NOT AVAILABLE FOR SALE  
⊖USED ON CHECK VALVE MODELS ONLY