

MODEL CODE BREAKDOWN

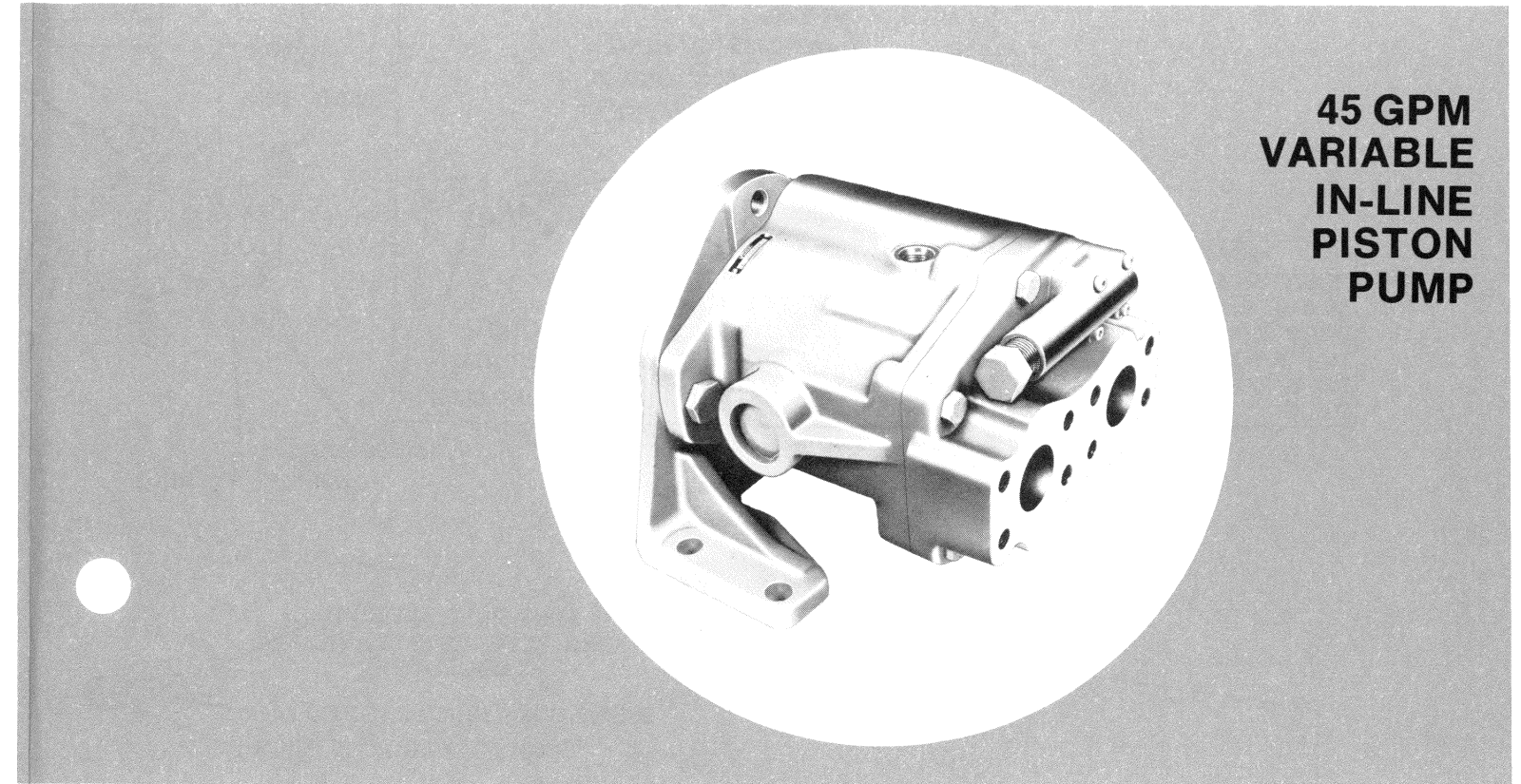
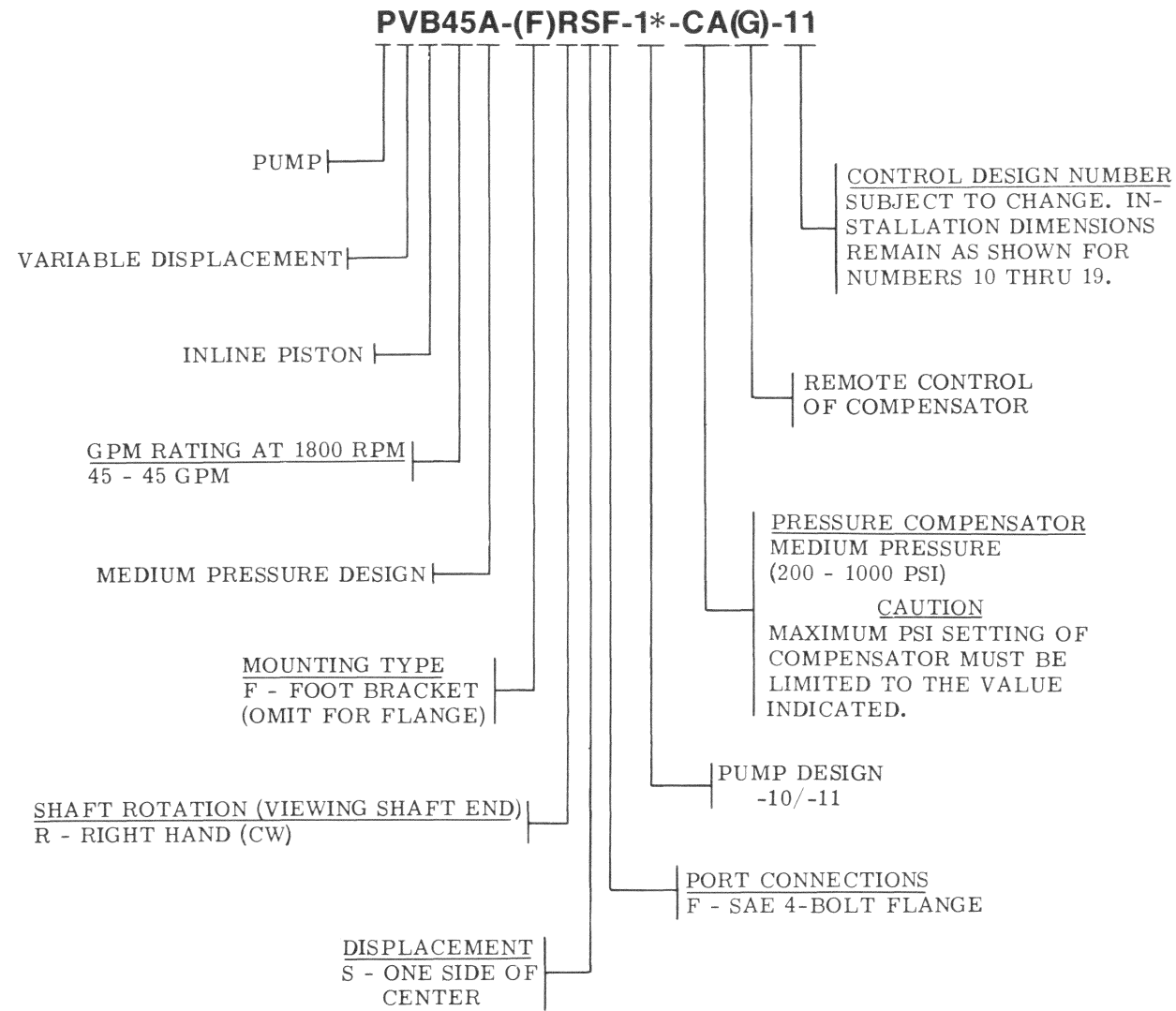

**SERVICE
PARTS
INFORMATION**

F3-PVB45A-(F)RSF-10/11-CA-11

F3-PVB45A-(F)RSF-11-CAG-11

To insure sustained efficiency and maximum trouble-free life of this precision equipment, initial and continuous filtration of the fluid medium to 25 microns absolute or less is essential. (For information pertaining to Sperry Vickers economical 3 or 10 micron filters, see installation drawing 522140.)

Litho in U.S.A.

SPERRY VICKERS
TROY, MI. 48064

Revised 8-1-80

I-3294-S

**WARNING: USE THIS DRAWING FOR PARTS INFORMATION ONLY.
SEE OVERHAUL MANUAL I-3230-S FOR MAINTENANCE INFORMATION**

● INCLUDED IN PRESSURE COMPENSATOR S/A				
MODEL	SPOOL	BODY	PLUG	KIT
PVB45A-CA	356986	345858	360430	942287
PVB45A-CAG	296234	306144	386913	942444

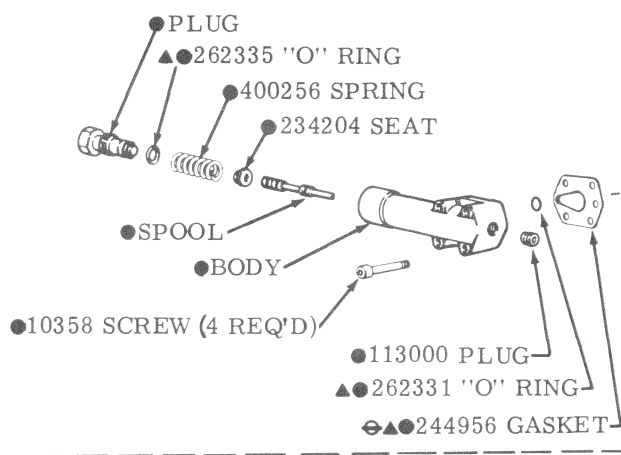

⚠ CAUTION
POSITION GASKET WITH SMALL END OF TEAR-DROP HOLE POINTING IN DIRECTION OF COMPENSATOR ADJUSTING PLUG.

* INCLUDED IN VALVE PLATE S/A	MODEL
942285	PVB45A-(F)RSF-1*-CA-11

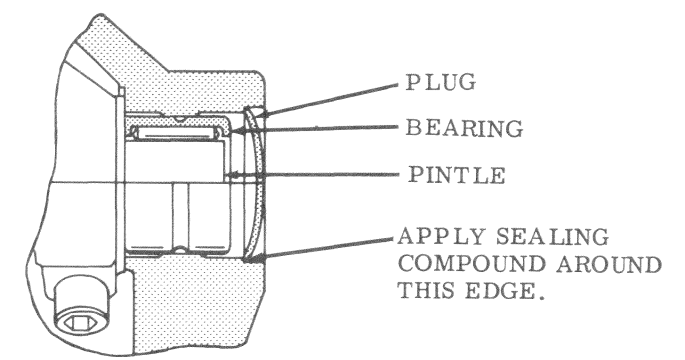
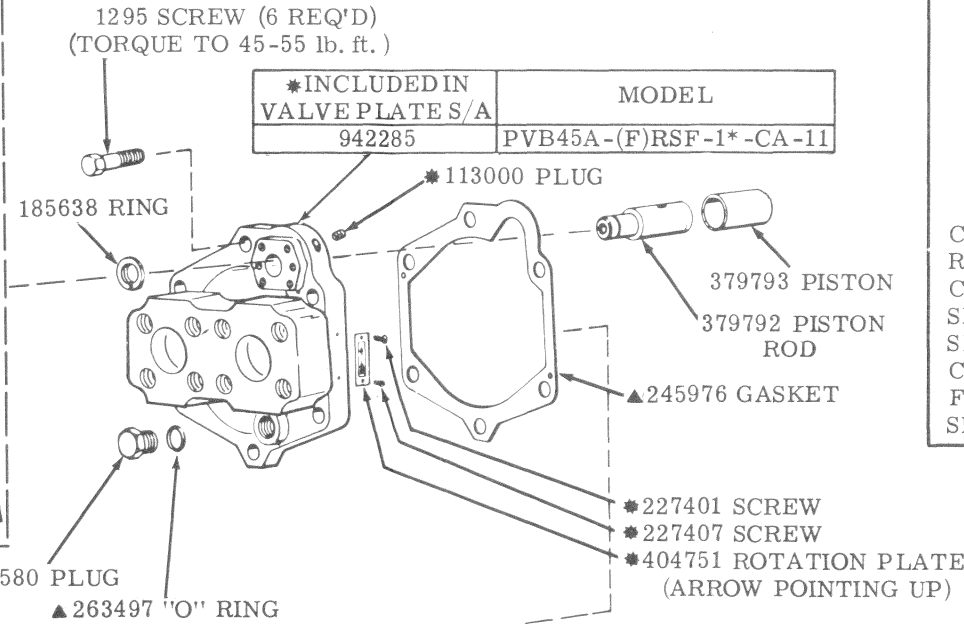

PLUG INSTALLATION PROCEDURE

CLEAN BOTH MATING SURFACES WITH A SUITABLE SOLVENT. REMOVE ALL CONTAMINATION. THE SURFACE MUST BE CLEAN AND DRY BEFORE INSTALLATION OF THE PLUG. APPLY SEALING COMPOUND (LOCTITE PLASTIC GASKET OR EQUIVALENT) SPARINGLY AROUND THE OUTER EDGE OF THE PLUG. EXERCISE CARE DURING ASSEMBLY TO PREVENT EXCESS SEALING COMPOUND FROM ENTERING THE BEARING. INSTALL THE PLUG IN PLACE AS SHOWN ABOVE.

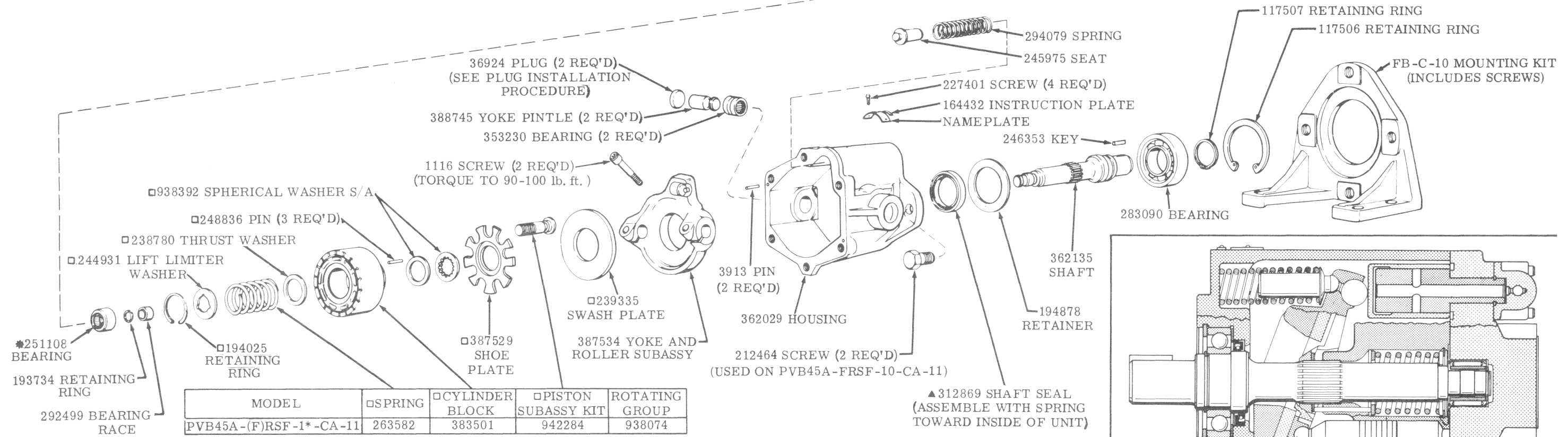

MODEL	□ SPRING	□ CYLINDER BLOCK	□ PISTON SUBASSY KIT	ROTATING GROUP
PVB45A-(F)RSF-1*-CA-11	263582	383501	942284	938074

▲ INCLUDED IN F3 SEAL KIT 920143 □ STANDARD SEAL KIT 920142 □ INCLUDED IN ROTATING GROUP

