

Service Parts Information

**45 GPM
Variable
Delivery
Inline Piston
Pumps**

PVB45-(F)*SF-20-C(*)(*)-11-(S67)

MODEL CODE BREAKDOWN

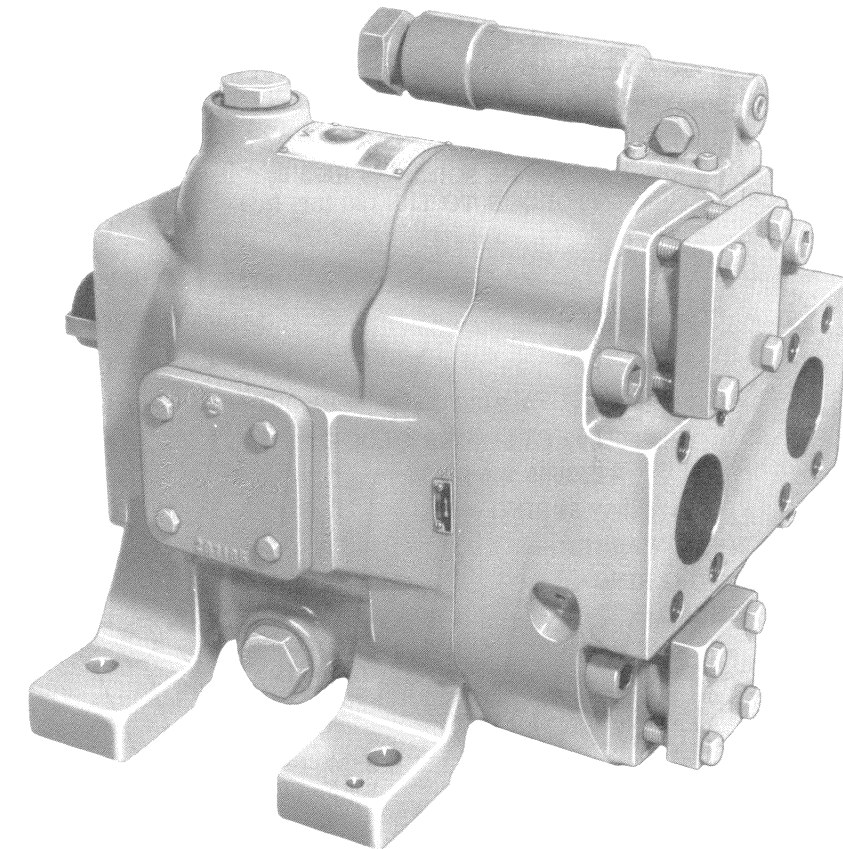
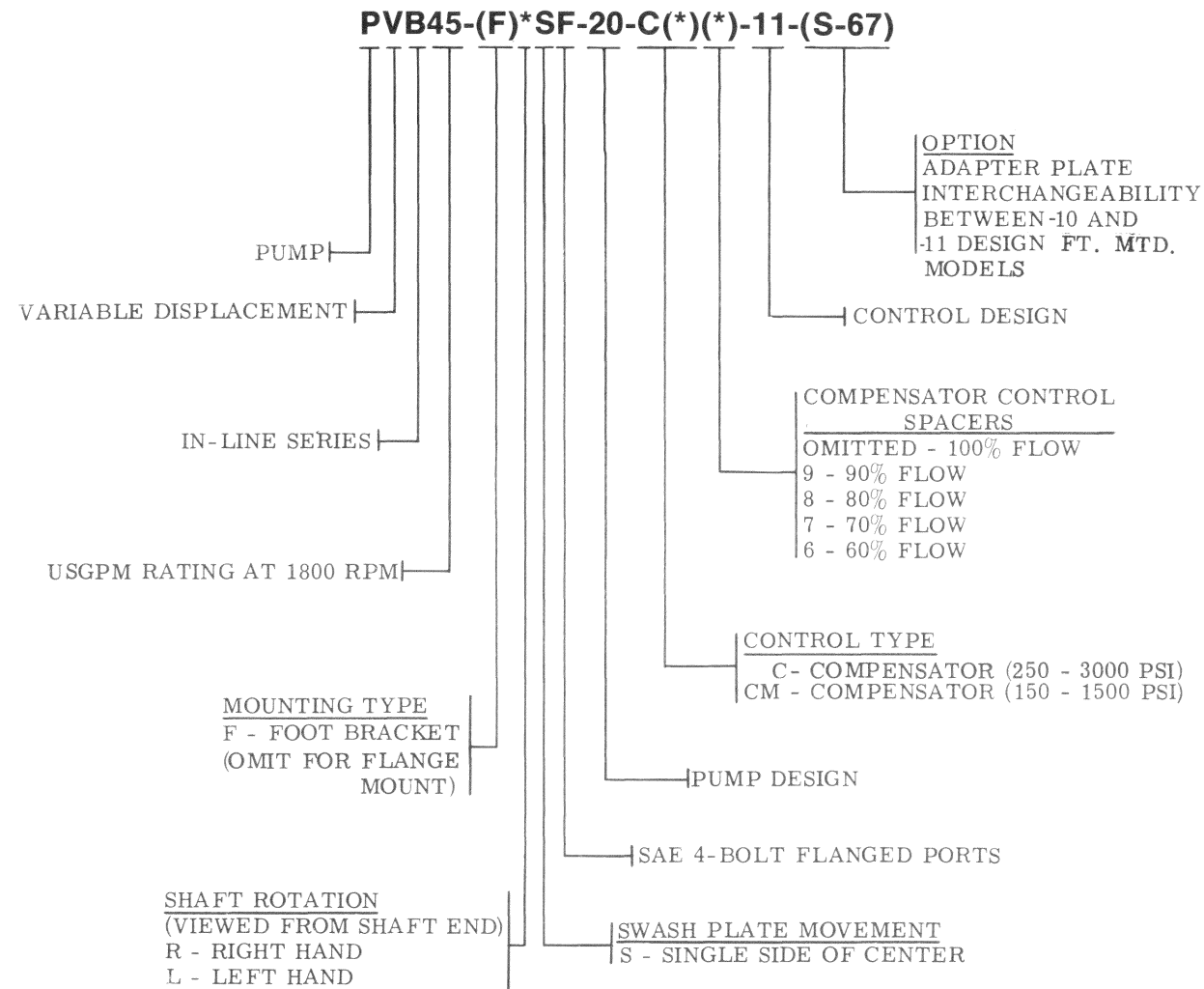

Vickers, Incorporated

1401 Crooks Road
Troy, Michigan 48084

Revised 8-1-87

I-3292-S

For satisfactory service life of these components, use full flow filtration to provide fluid which meets ISO cleanliness code 16/13 or cleaner. Selections from Vickers OFP, OFR, and OFRS series are recommended.

MODEL	SPACER
C/CM	NONE
C9/CM9	381291
C8/CM8	381292
C7/CM7	381293
C6/CM6	381294

USED ON EARLY MODELS ONLY

- ▲154127 "O" RING
- 200503 PLUG
- ▲247354 SEAT
- ▲247355 BODY
- ▲187000 "O" RING
- ▲154013 "O" RING
- ▲154004 "O" RING
- ▲82031 PLUG (●SEE NOTE)
- ▲154005 "O" RING

●82031 ORIFICE PLUG (MUST BE INSTALLED IN THE DRAIN PORT OF THE COMPENSATOR BODY, BELOW THE MOUNTING SURFACE.)

SEE PARTS DRAWING I-3963-S FOR PORT FLANGE DATA

VALVE PLATE	MODEL
352155	PVB45-(F) RSF-20-C*-11
351099	PVB45-(F) LSF-20-C*-11

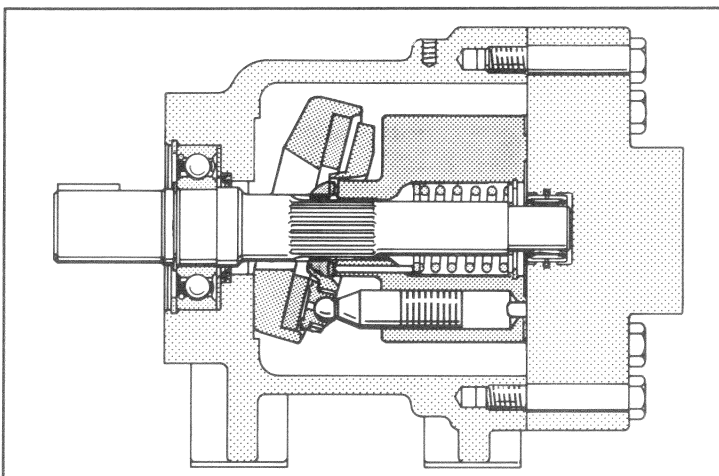
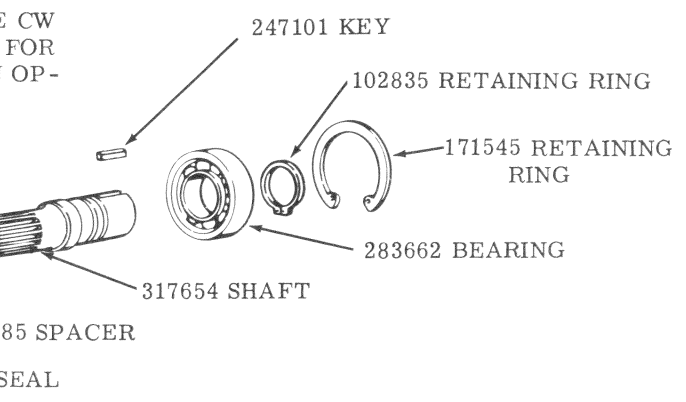
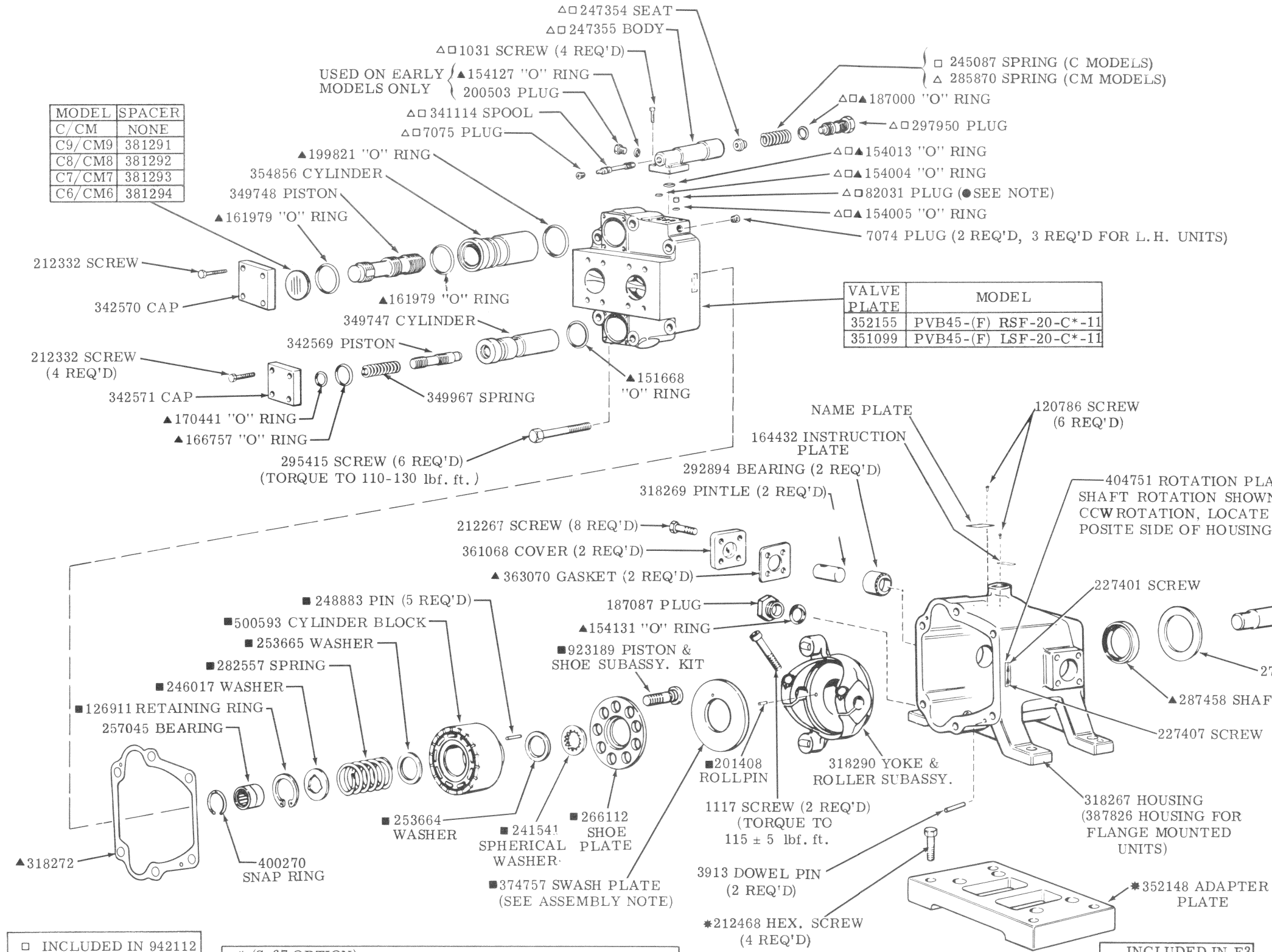
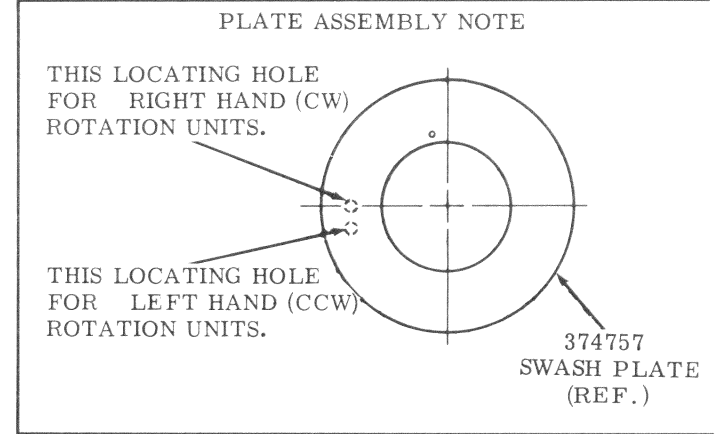

□ INCLUDED IN 942112 "C" COMPENSATOR S/A

△ INCLUDED IN 942133 "CM" COMPENSATOR S/A

* (S-67 OPTION): INTERCHANGEABILITY WITH THE -10 & -11 DESIGN FOOT MOUNTED PUMPS IS PROVIDED WITH ADAPTER PLATE 352148 AND (4) 212468 SCREWS. MODELS ORDERED WITH S-67 SUFFIX WILL HAVE THE ADAPTER PLATE ATTACHED.

■ INCLUDED IN 938279 ROTARY GRC

INCLUDED IN F3 GASKET KIT 919695

▲ INCLUDED IN 919640 GASKET KIT