

MODEL CODE BREAKDOWN

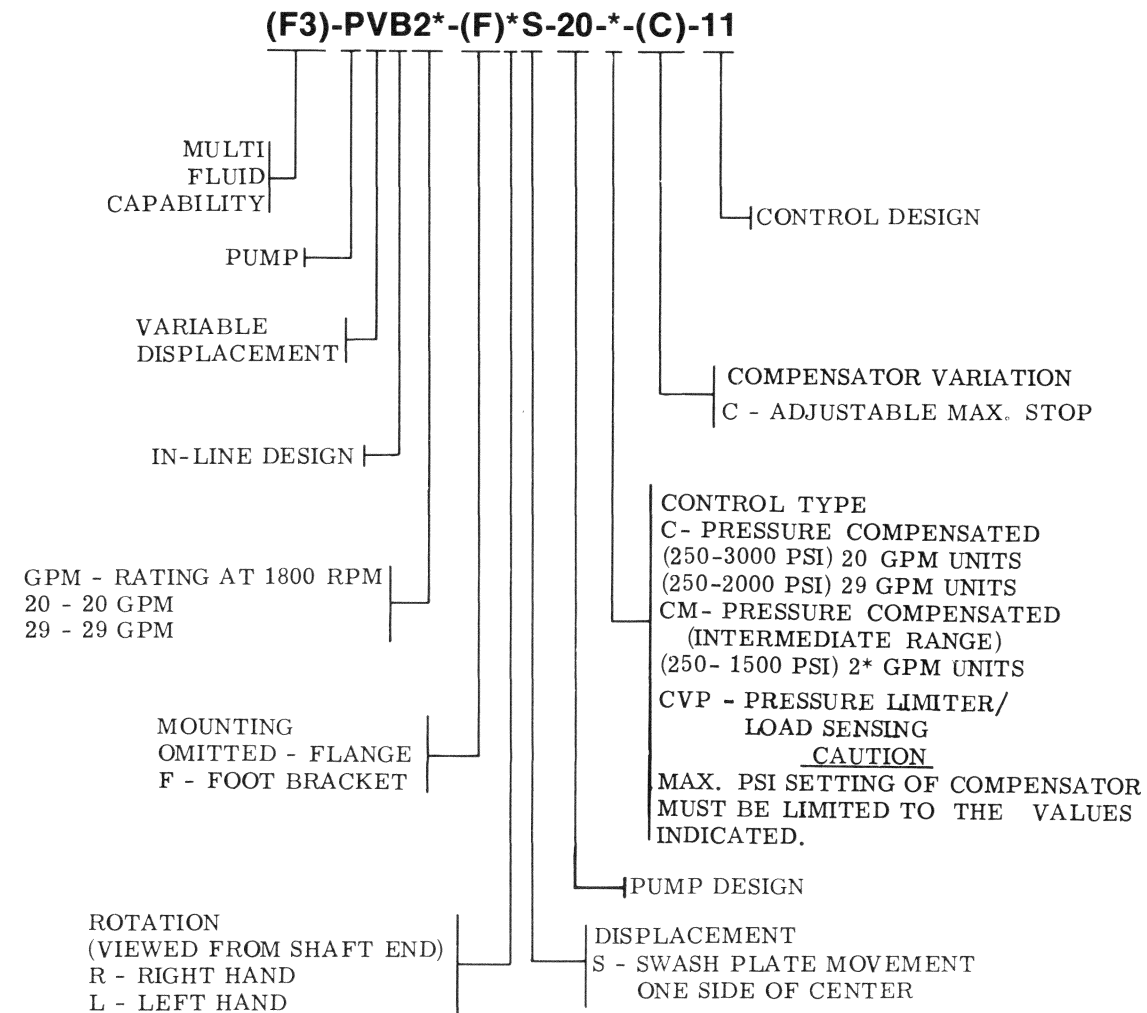

Variable Inline Piston Pump

PVB20-*S-20-*(*)-11
PVB29-*S-20-*(*)-11

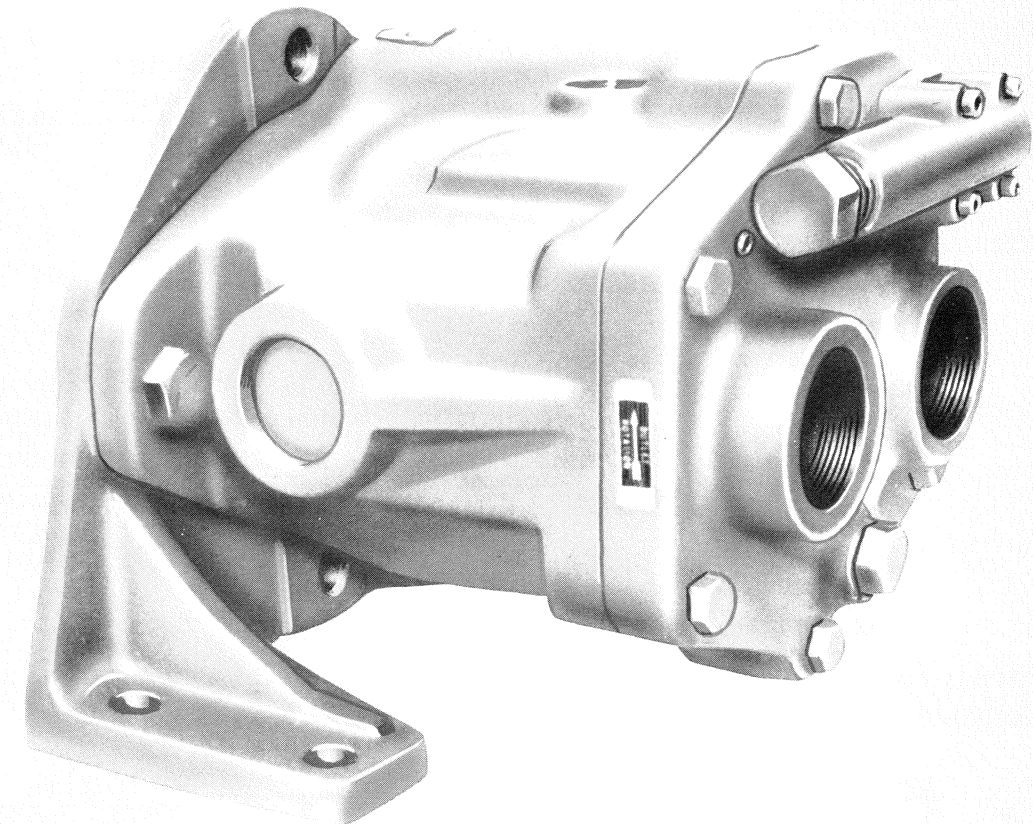

For satisfactory service life of these components in industrial applications, use full flow filtration to provide fluid which meets ISO cleanliness code 16/13 or cleaner. Selections from Vickers OFP, OFR, and OFRS series are recommended.

Litho in U. S. A.

Vickers, Incorporated
5445 Corporate Drive
P.O. Box 302
Troy, Michigan
48007-0302
USA

Revised 12-01-87

I-3267-S

● INCLUDED IN PRESSURE COMPENSATOR SUBASSYS SHOWN IN TABLE.

PRESSURE RANGE (PSI)	COMPEN-SATOR SUBASSY	SPRING
(C) 250-2500 (20) 250-2000 (29)	942158	239371 ●
(CM) 250-1500	942159	265693 ●

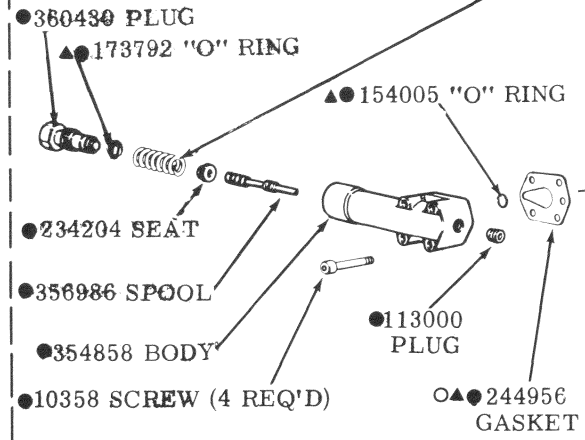

CAUTION
POSITION GASKET WITH SMALL END OF TEARDROP HOLE POINTING IN DIRECTION OF COMPENSATOR ADJUSTING PLUG.

▲ INCLUDED IN 919683 SEAL KIT

□ F3 EQUIVALENT 919847 SEAL KIT

NOTE: TYPE 'C' & 'CM' COMPENSATOR CONTROL PARTS SHOWN. REFER TO PARTS DRWG. I-3243-S FOR 'CVP' PRESSURE LIMITER & LOAD SENSING COMPENSATOR CONTROL.

1295 SCREW (6 REQ'D)
(TORQUE TO 44-45 lb. ft.)

*INCLUDED IN VALVE PLATE SUBASSY	MODEL
942169	PVB20-(F)RS-20-C(M)-(*)-11
942170	PVB20-(F)LS-20-C(M)-(*)-11
942171	PVB29-(F)RS-20-C(M)-(*)-11
942172	PVB29-(F)LS-20-C(M)-(*)-11

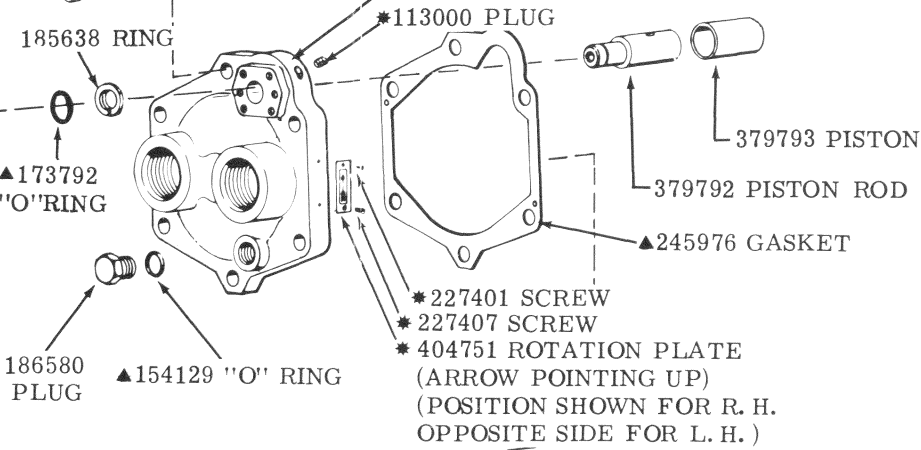

● INCLUDED IN ADJUSTABLE MAXIMUM STOP SUBASSY 942192.

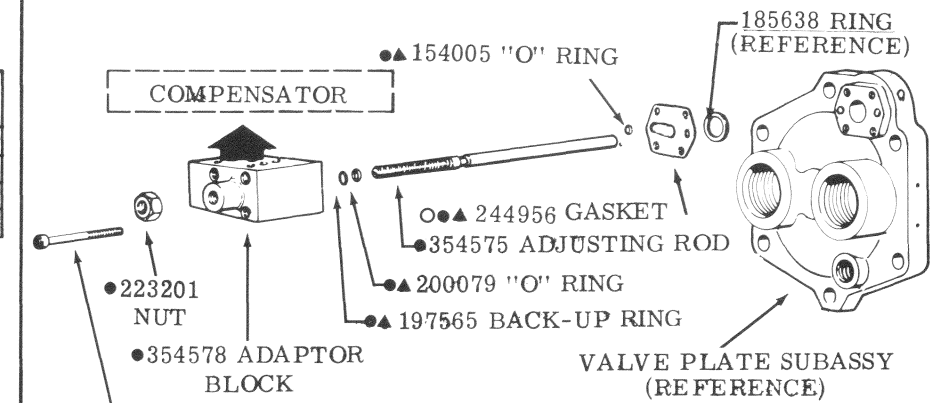

NOTE
The adjustable maximum stop feature (shown) may be used for manual adjustment of pump output flow. To assist initial priming, manual adjustment control setting must be at least 40% of maximum flow position. Maximum flow position occurs when rod is fully extended.

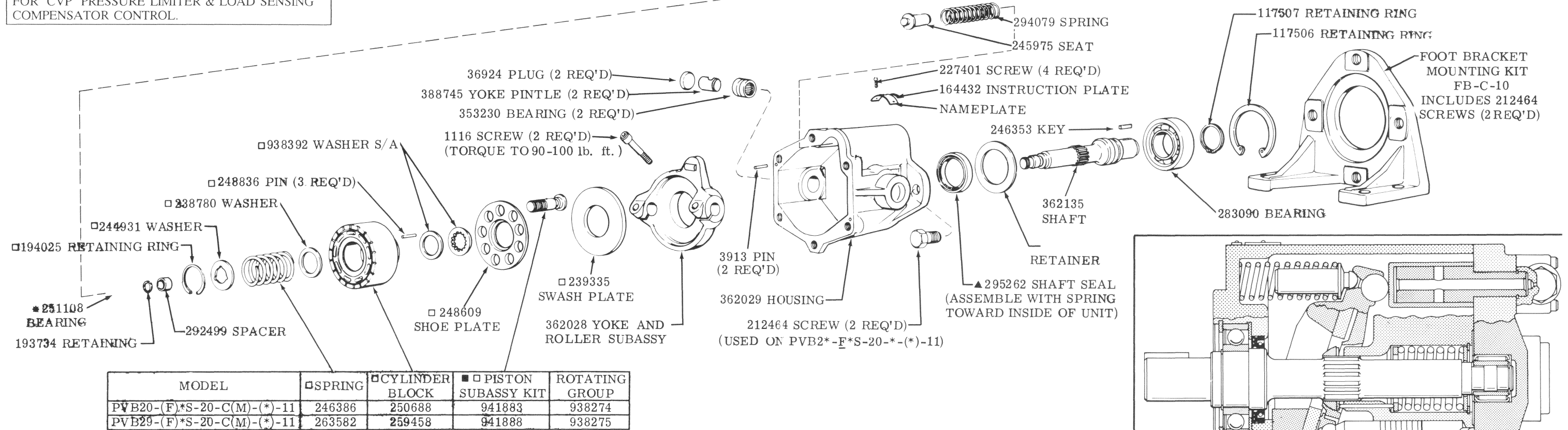

MODEL	□ SPRING	□ CYLINDER BLOCK	■ □ PISTON SUBASSY KIT	ROTATING GROUP
PVB20-(F)*S-20-C(M)-(*)-11	246386	250688	941883	938274
PVB29-(F)*S-20-C(M)-(*)-11	263582	259458	941888	938275

■ INCLUDES 9 PISTON & SHOE S/A

□ INCLUDED IN ROTATING GROUP

