

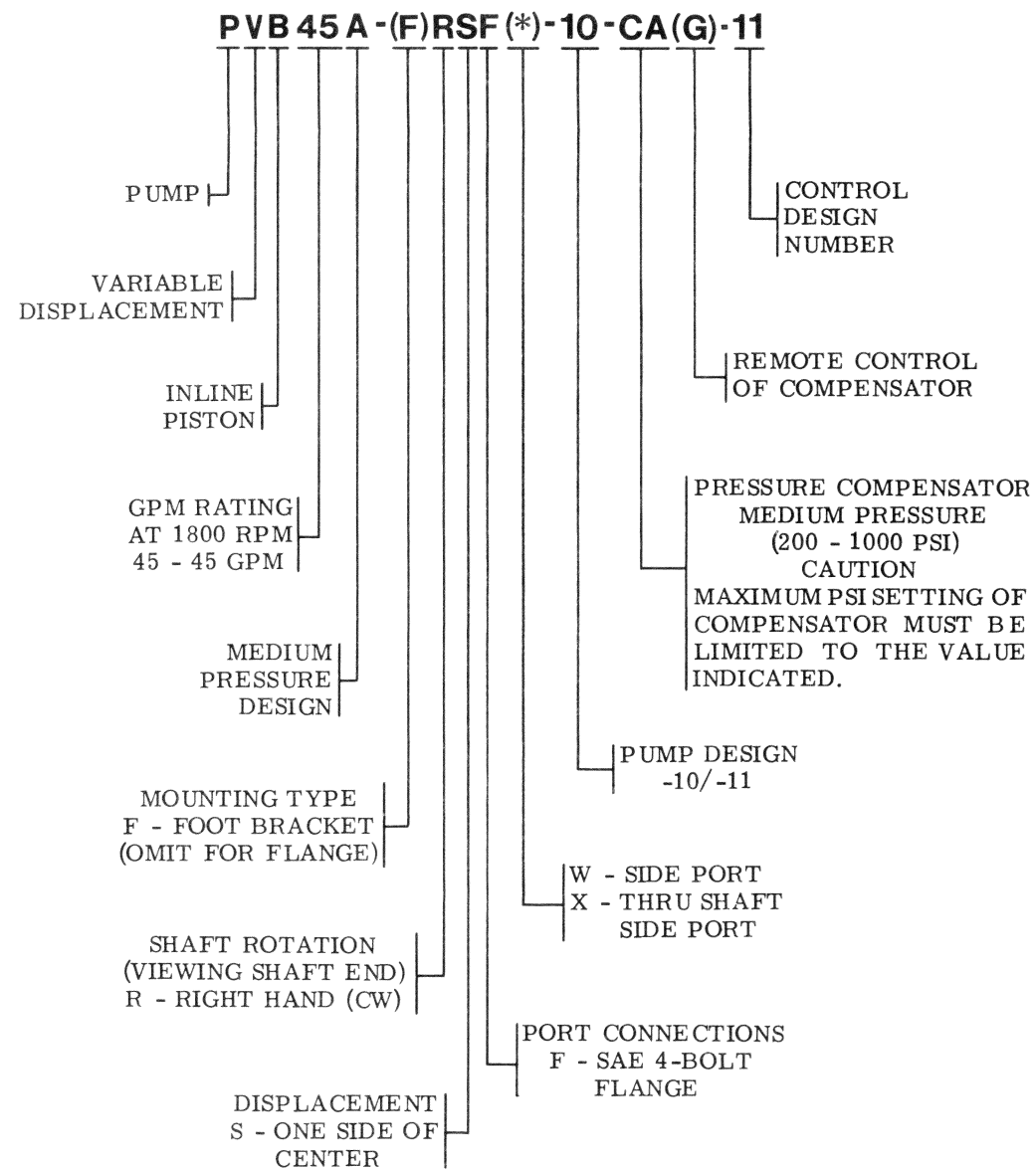

# Service Parts Information

## MODEL CODE BREAKDOWN



Thru Shaft, Side Ported Inline Piston Pumps

PVB45A-(F)RSFW-10-CA(G)-11  
PVB45A-(F)RSFX-10-CA(G)-11

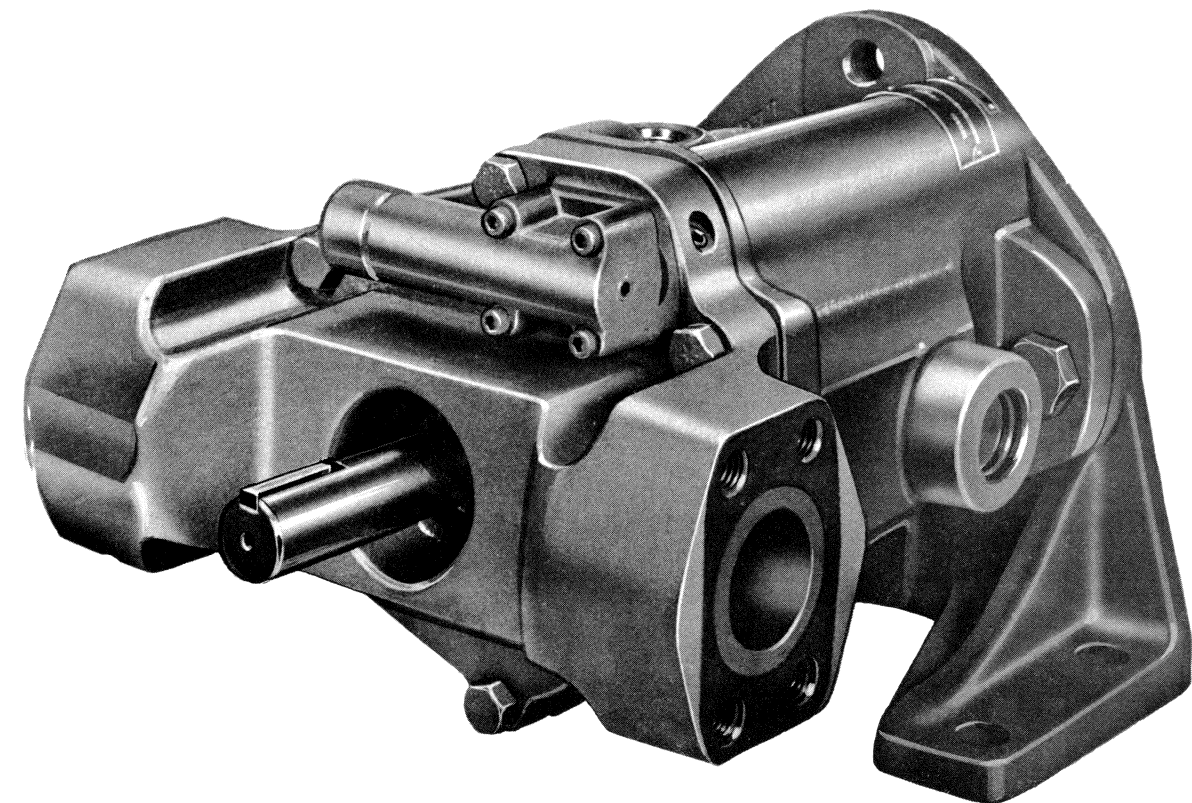

Vickers, Incorporated

1401 Crooks Road  
Troy, Michigan 48084

Revised 5-1-85

I-3256-S

For satisfactory service life of these components in industrial applications, use full flow filtration to provide fluid which meets ISO cleanliness code 16/13 or cleaner. Selections from Vickers OFP, OFR, and OFRS series are recommended.

Litho in U. S. A.

A Libbey-Owens-Ford Company

● INCLUDED IN PRESSURE COMPENSATOR S/A				
MODEL	SPOOL	BODY	PLUG	KIT
PVB45A-CA	356986	345858	360430	942287
PVB45A-CAG	296234	306144	386913	942444

□ NOTE  
POSITION GASKET WITH SMALL END OF TEARDROP HOLE POINTING IN DIRECTION OF COMPENSATOR ADJ. PLUG.

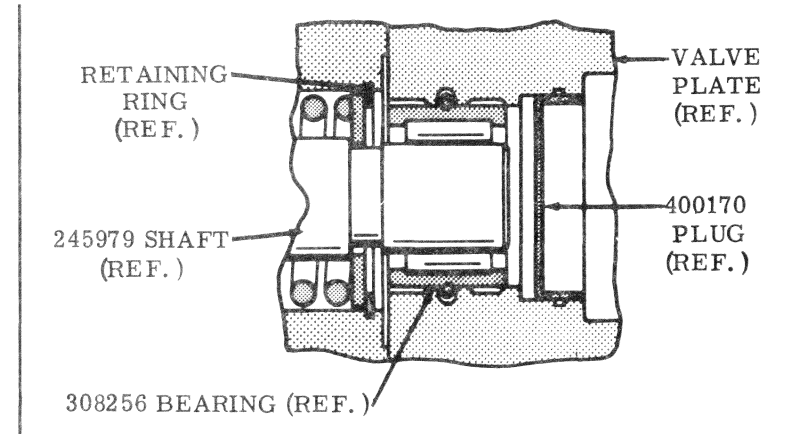

⊕ PLUG ASSEMBLY NOTE  
MAKE CERTAIN 400170 PLUG O. D. AND MATING I. D. IN VALVE PLATE IS CLEAN. APPLY SEALING COMPOUND (LOCTITE GRADE "A" OR EQUIVALENT) TO PLUG O. D. AND PRESS PLUG INTO VALVE PLATE AS SHOWN.

CAUTION  
DO NOT ALLOW SEALING COMPOUND TO CONTACT BEARING ROLLERS.

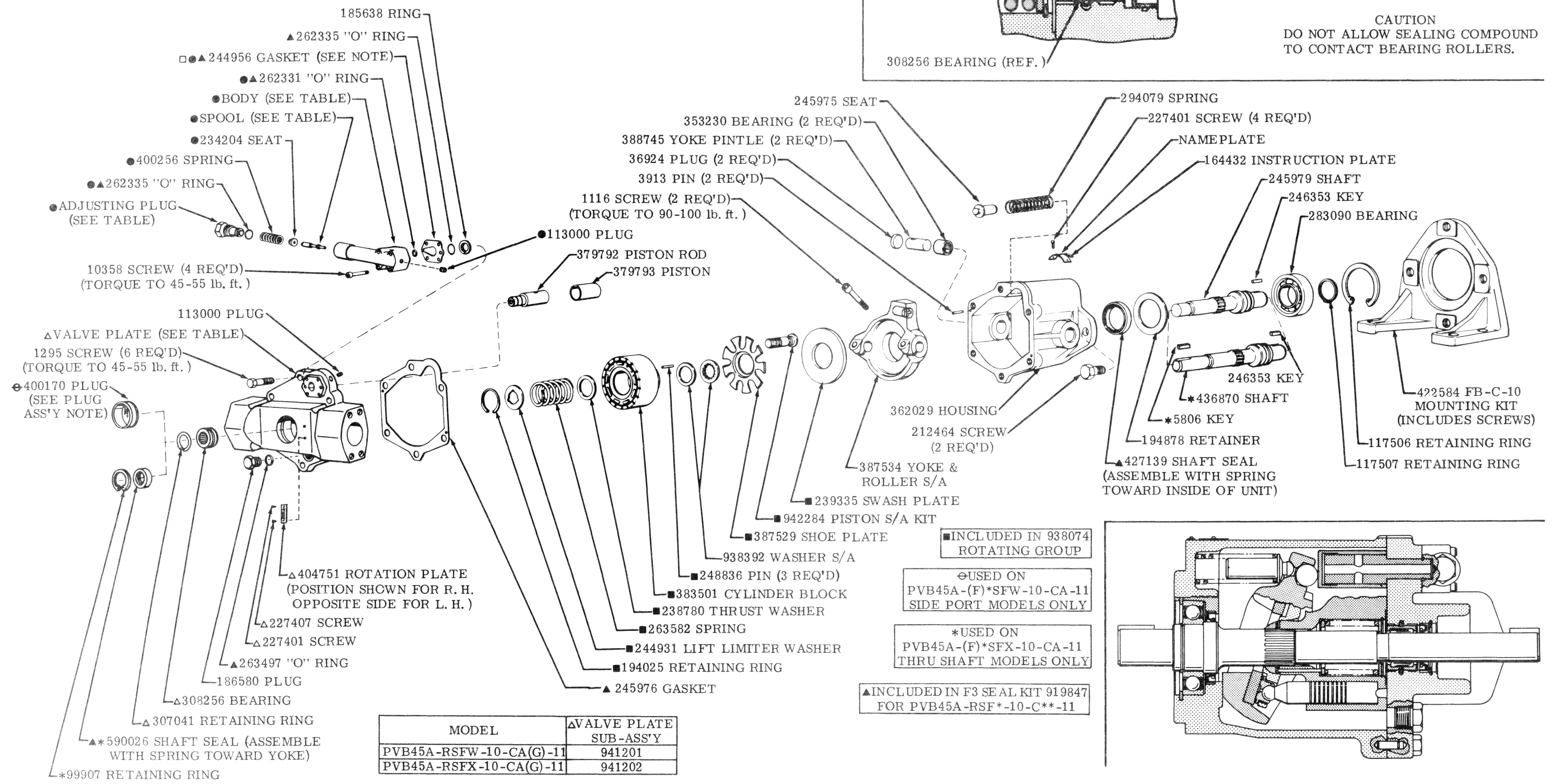

■ INCLUDED IN 938074 ROTATING GROUP

⊕ USED ON PVB45A-(F)\*SFW-10-CA-11 SIDE PORT MODELS ONLY

\*USED ON PVB45A-(F)\*SFX-10-CA-11 THRU SHAFT MODELS ONLY

▲ INCLUDED IN F3 SEAL KIT 919847 FOR PVB45A-RSF\*-10-C\*\*-11

MODEL	▲ VALVE PLATE SUB-ASS'Y
PVB45A-RSFW-10-CA(G)-11	941201
PVB45A-RSFX-10-CA(G)-11	941202

