

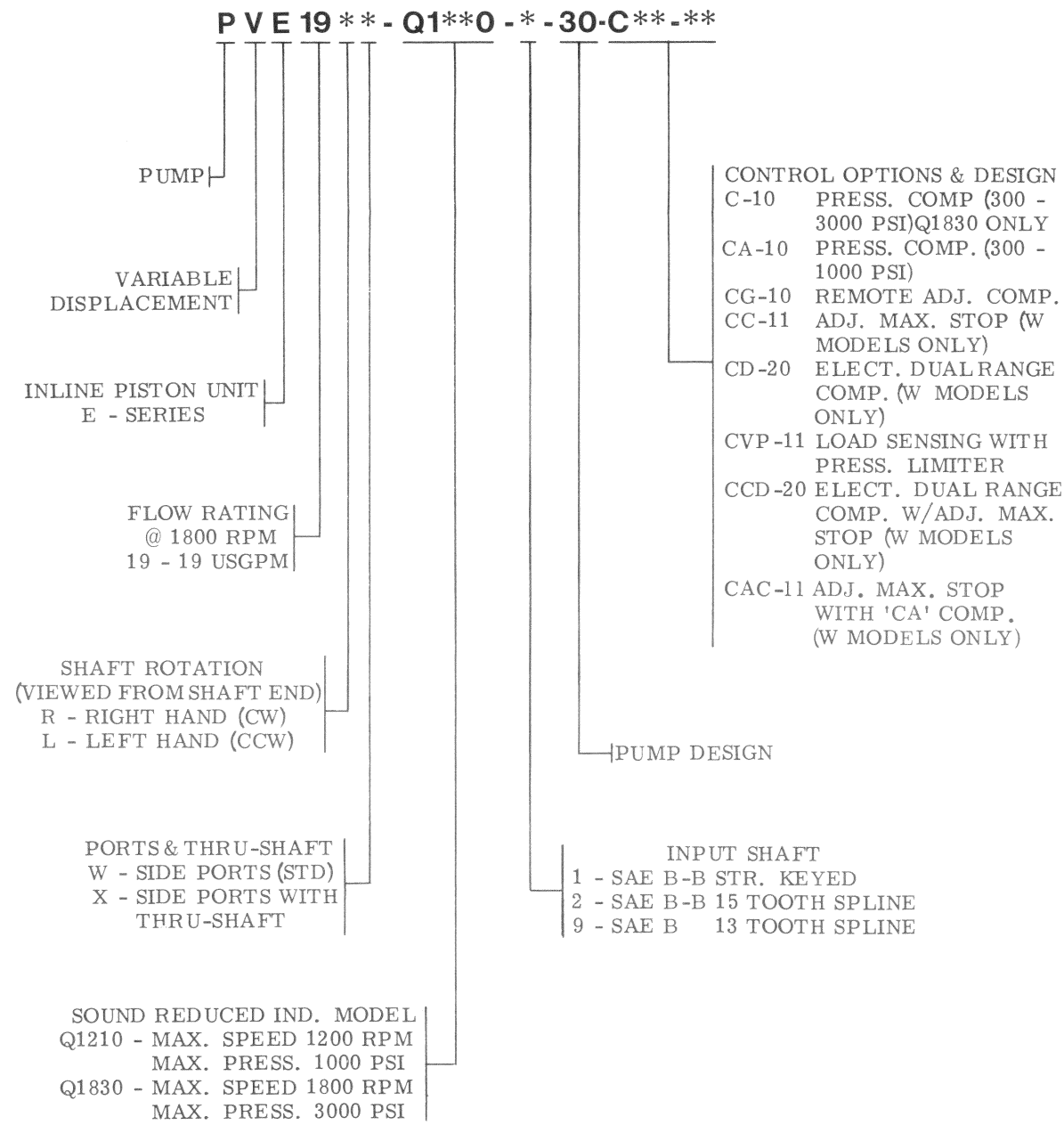

Service Parts Information

MODEL CODE BREAKDOWN



Pressure
Compensated
Variable
Displacement
Piston Pumps

PVE19**-Q1210*-30-C**-10/11
PVE19**-Q1830*-30-C**-10/11

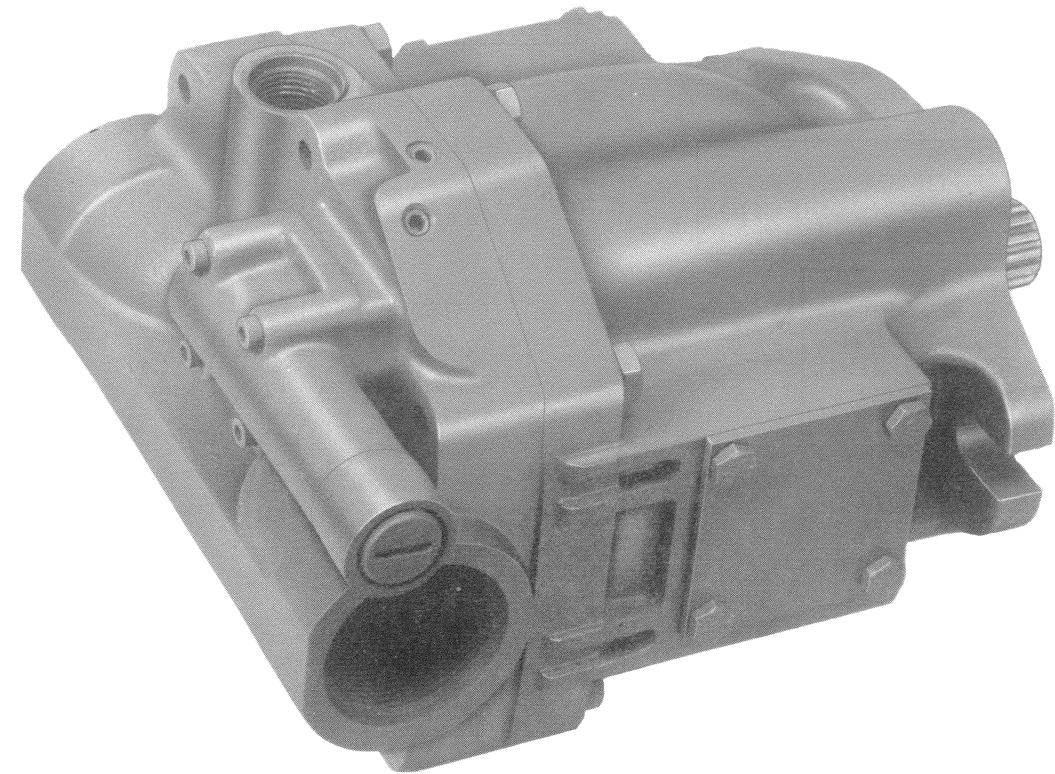

Vickers, Incorporated

1401 Crooks Road
Troy, Michigan 48084

Revised 10-1-85

I-3251-S

For satisfactory service life of these components, use full flow filtration to provide fluid which meets ISO cleanliness code 16/13 or cleaner. Selections from Vickers OFP, OFR, and OFRS series are recommended.

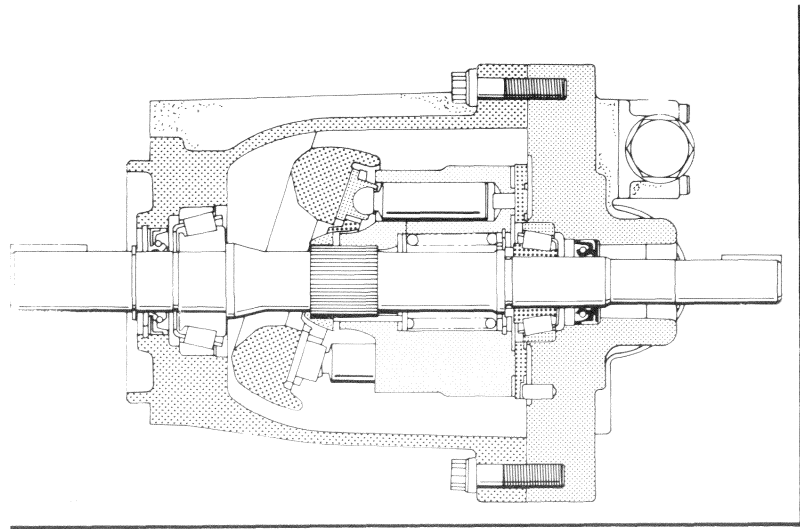

C, CG, & CA COMPENSATOR
 (SHOWN FOR R. H. SHAFT ROTATION.
 ROTATE 180° FOR L. H. SHAFT ROTATION)

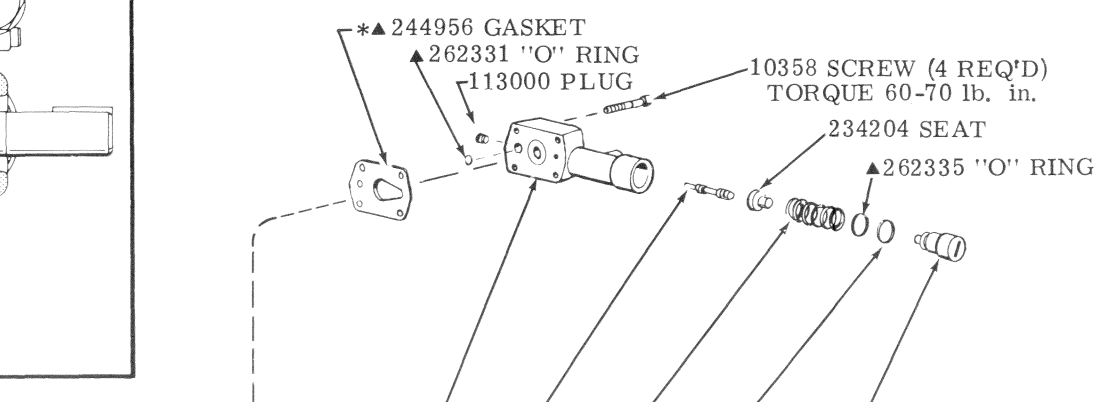

MODEL	BODY	SPOOL	SPRING	BACKUP RING	PLUG	COMP. S/A KIT
PVE19**-Q1830-*-30-C-10	241568	241717	239371	—	360430	941352
PVE19**-Q1210-*-30-CG-10	412890	296234	265693	▲197573	412940	941353
PVE19**-Q1830-*-30-CG-10	—	—	239371	—	—	941354
PVE19**-Q1210-*-30-CA-10	241568	241717	265693	—	360430	941355

- INCLUDED IN**
- ▲ PVE19*W - SEAL KIT 920227
 - ▲ PVE19*X - SEAL KIT 920228
 - BRG. SPACER KIT 942401
 - PINTLE SHIM KIT 923938
 - ROT. GRP. KIT (Q1210) 938098
 - ROT. GRP. KIT (Q1830) 923948
 - YOKE BRG. KIT 923987
 - ▲ SHAFT BRG. KIT 923988

***CAUTION**
 POSITION GASKET WITH SMALL END OF TEARDROP HOLE POINTING IN DIRECTION OF COMPENSATOR ADJUSTING PLUG.

NOTE
 SEE DRAWING I-3255-S FOR "CC" & "CD" ADJUSTABLE MAXIMUM STOP CONTROL AND ELECTRIC DUAL RANGE COMPENSATOR.

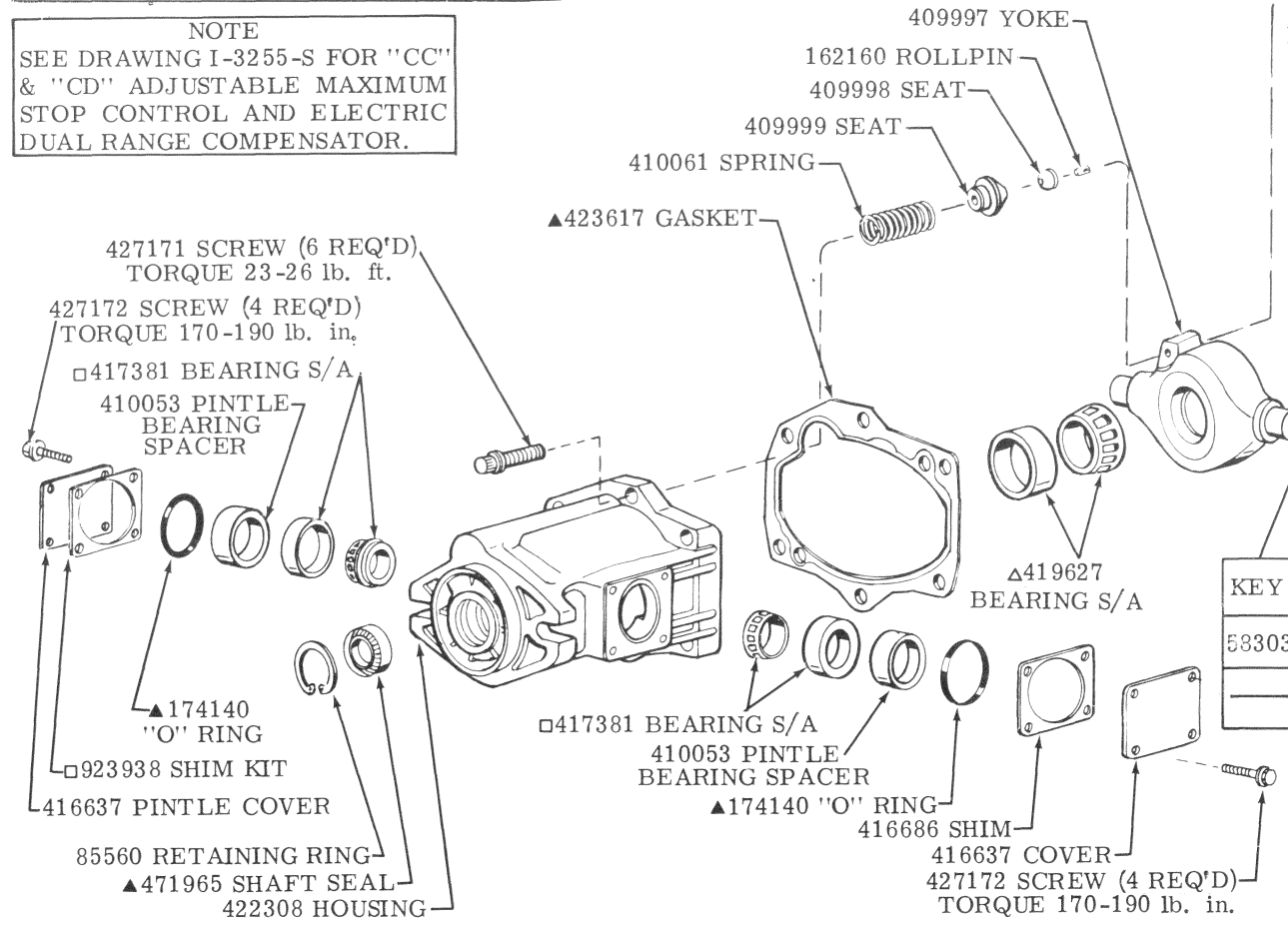

KEY	RETAINING RING	SHAFT	THRU-SHAFT KEY	MODEL
53303	112531	428883	—	PVE19**-1
—	—	585114	142843	PVE19*X-1
—	—	423415	—	PVE19**-2
—	—	424544	—	PVE19**-9

CVP COMPENSATOR

(SHOWN FOR R. H. SHAFT ROTATION.
 ROTATE 180° FOR L. H. SHAFT ROTATION.
 SEE TABLE BELOW FOR 'CVP' COMP. S/A.)

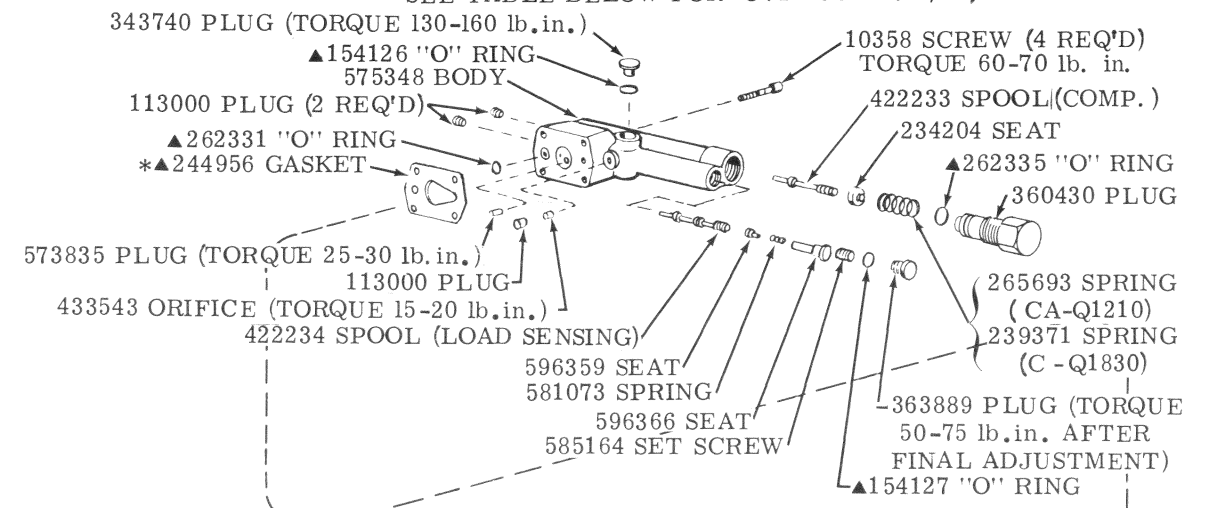

MODEL	SPRING	COLOR
Q1210	632570	YELLOW
Q1830	402579	RED

MODEL	ROTATION (VIEWED FROM SHAFT END)	VALVE BLOCK	WAFER PLATE	CVP COMP. S/A
PVE19RW-Q1210	RIGHT HAND (CLOCKWISE)	429729	585122	941350
PVE19RW-Q1830			629539	941351
PVE19RX-Q1210		585127	585122	941350
PVE19RX-Q1830			629539	941351
PVE19LW-Q1210	LEFT HAND (C'CLOCKWISE)	586133	583148	941350
PVE19LW-Q1830			631476	941351
PVE19LX-Q1210		585129	583148	941350
PVE19LX-Q1830			631476	941351

MODEL	PISTON	SEAL RING	STOP	PISTON ROD	COMP. PISTON & ROD S/A KIT
PVE19**-Q1210-*-30-*(*)-1*	404958	588523	588936	585124	941356
PVE19**-Q1830-*-30-*(*)-1*		—	—	404957	923960