

MODEL CODE BREAKDOWN

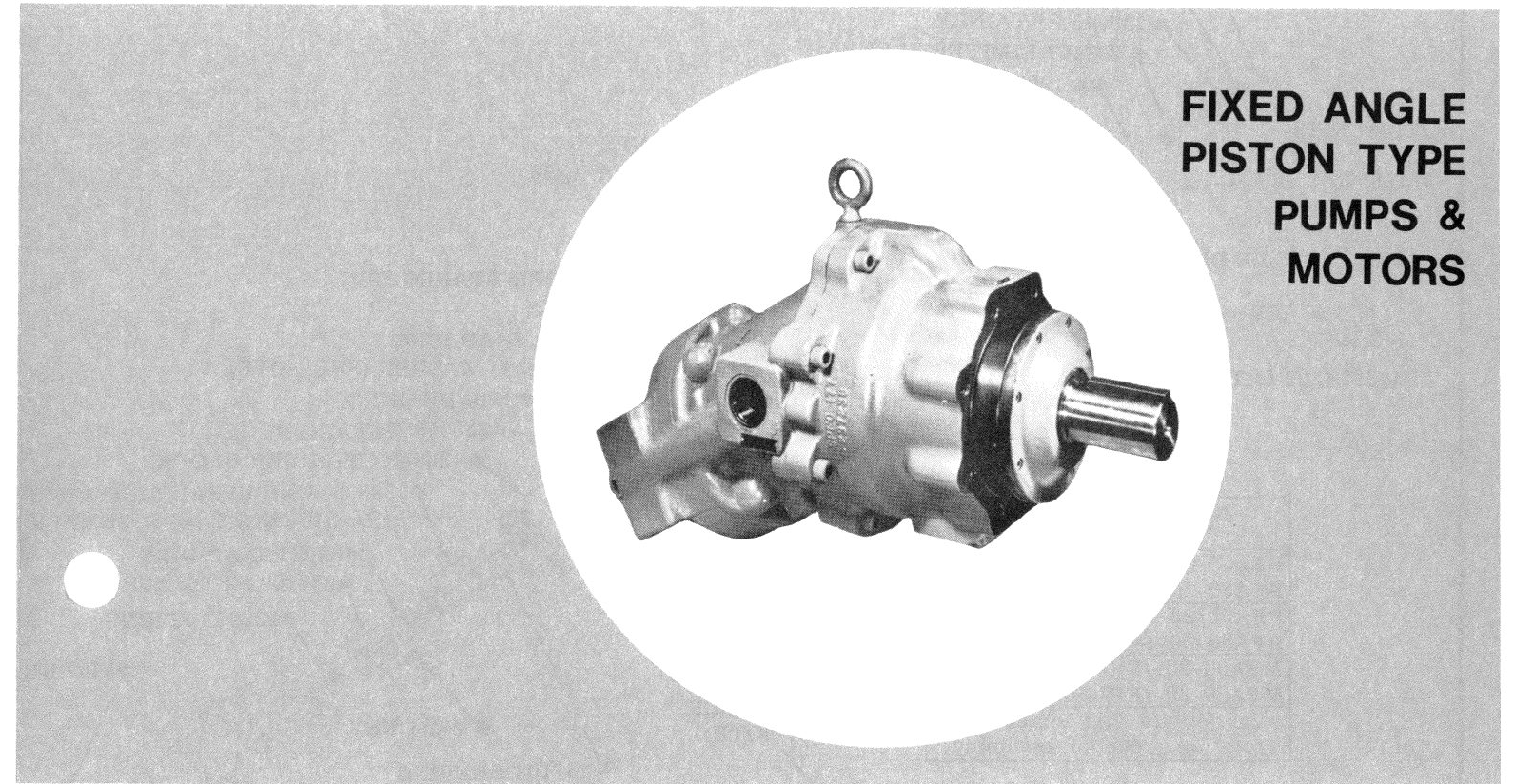
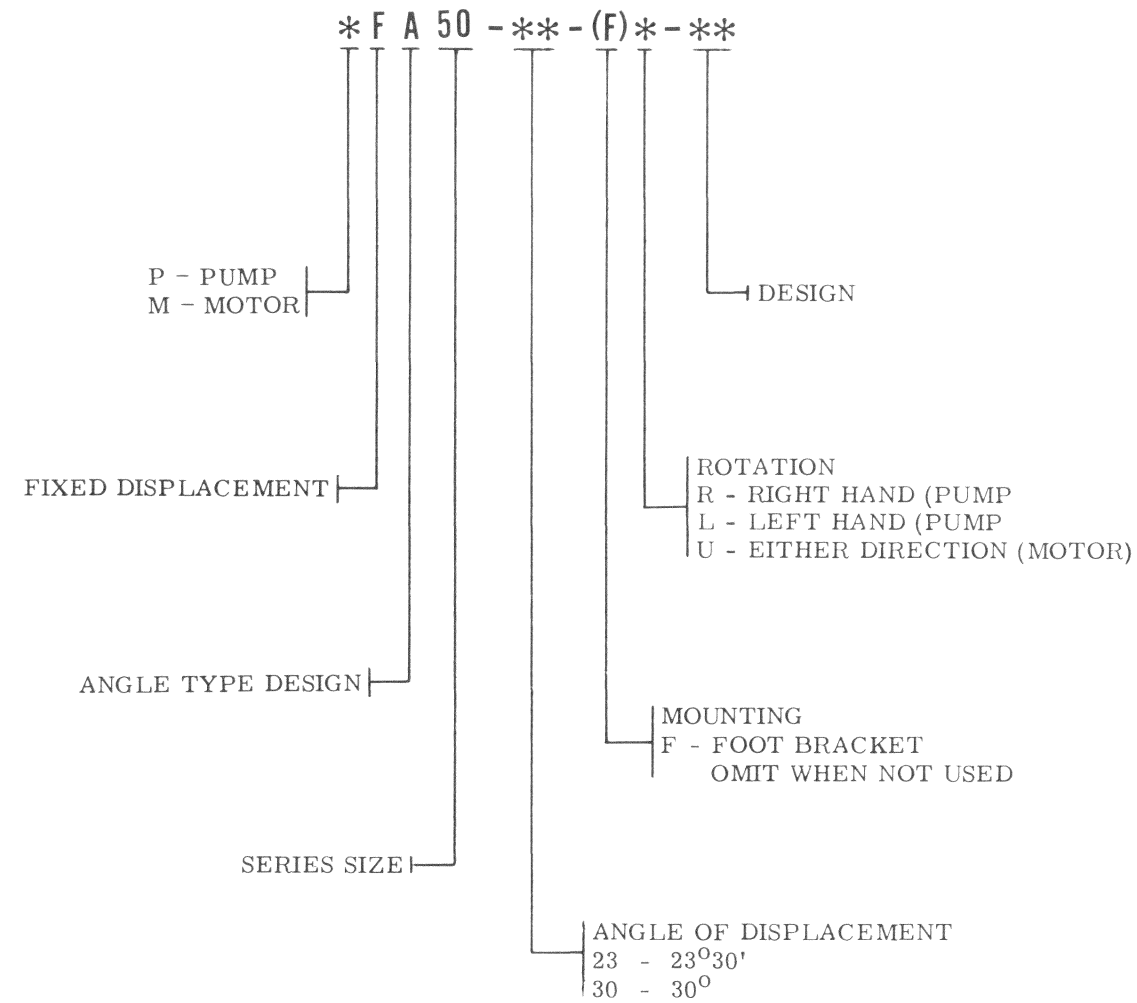

SERVICE PARTS INFORMATION

PFA50 - ** - (F) * - 10/11/12
MFA50 - ** - (F) U - 10/11

To insure sustained efficiency and maximum trouble-free life of this precision equipment, initial and continuous filtration of the fluid medium to 25 microns absolute or less is essential. (For information pertaining to Sperry Vickers economical 3 or 10 micron filters, see installation drawing 522140.)

Litho in U.S.A.

SPERRY VICKERS
TROY, MI. 48084

Revised 6-1-77

I-3220-S

PFA50-**-(-F)*-10/11/12

MFA50-**-(-F)U-10/11

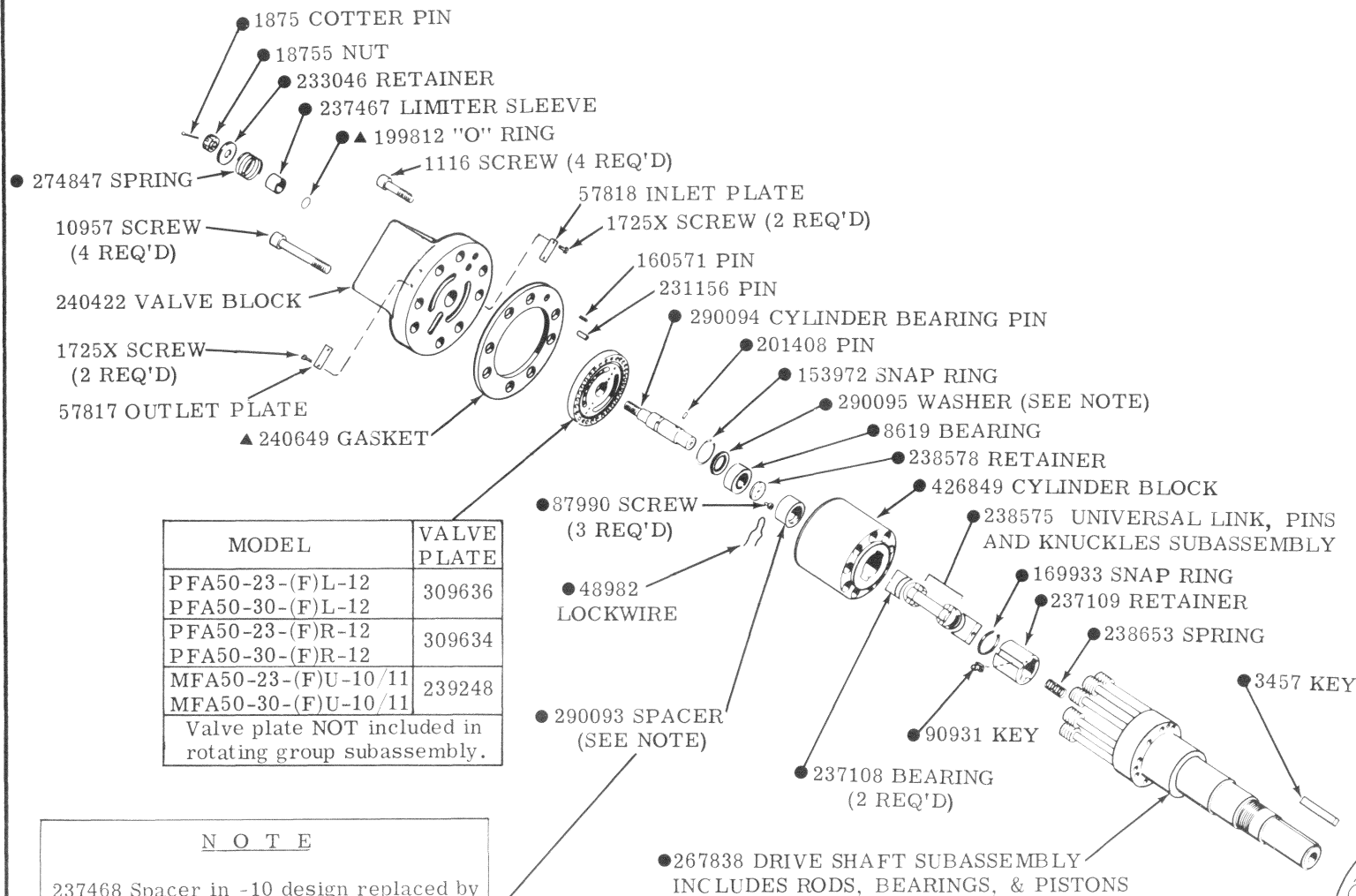

MODEL	VALVE PLATE
PFA50-23-(-F)L-12	309636
PFA50-30-(-F)L-12	309636
PFA50-23-(-F)R-12	309634
PFA50-30-(-F)R-12	309634
MFA50-23-(-F)U-10/11	239248
MFA50-30-(-F)U-10/11	239248

Valve plate NOT included in rotating group subassembly.

NOTE

237468 Spacer in -10 design replaced by 290093 spacer AND 290095 washer used in -11 and -12 designs. When replacing these items, re-stamp the name plate with the new design number.

CONNECTION FLANGES (OPTIONAL)
MODEL FL4-50-16WS-10 INCLUDES:

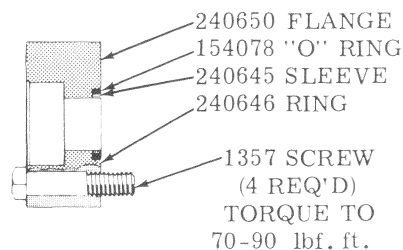

● INCLUDED IN 938047 ROTATING GROUP SUBASSEMBLY

▲ INCLUDED IN 919200 GASKET KIT

MODEL	ANGLE HOUSING
PFA50-23-(-F)R-1*	258496
PFA50-23-(-F)L-1*	258496
MFA50-23-(-F)U-1*	258496
PFA50-30-(-F)R-1*	240199
PFA50-30-(-F)L-1*	240199
MFA50-30-(-F)U-1*	240199

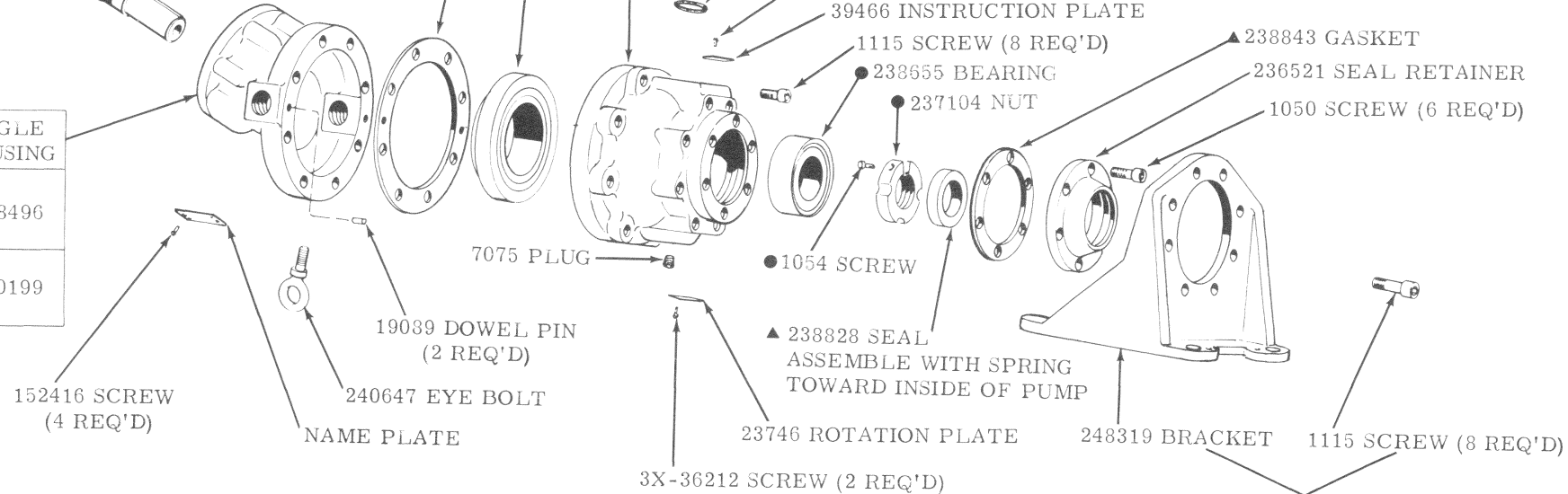

USED ONLY ON BRACKET MOUNTED MODELS
*FA50-**-F*-1*

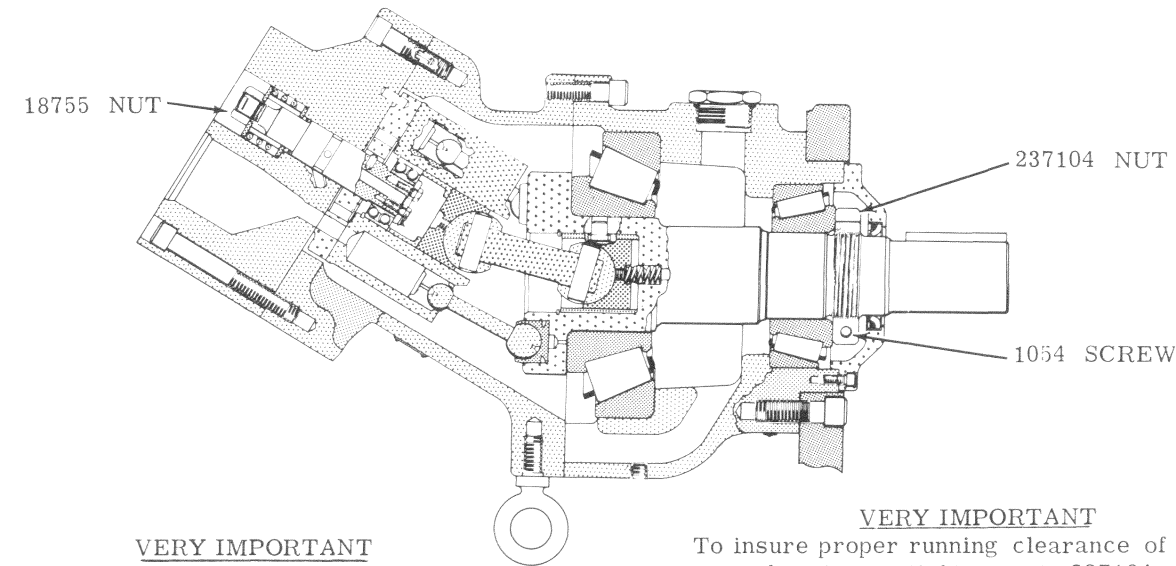

VERY IMPORTANT

To provide proper running clearance of cylinder block, tighten 18755 nut so valve block, valve plate and cylinder block are clamped snugly together. Then back the nut off from 1/6 to 1/4 turn to align the slot with the key hole in the pin.

VERY IMPORTANT

To insure proper running clearance of front and rear bearings, tighten nut 237104 so drive shaft subassembly and front bearing are clamped snugly together. Then back off nut until there is .003 to .005 clearance between nut and bearing. Insert screw 1054 in nut and tighten. Re-check clearance. Tap end of shaft until nut is flush with front bearing.

DRAIN CONNECTION INSTRUCTIONS

Any one of three drain connections may be used. A full size unrestricted case drain line must be connected from the drain port directly to the reservoir in such a manner that the housing remains filled with fluid. Drain line loop must extend above top of case and terminate below fluid level in reservoir to prevent syphoning action.

For unused drain ports