

PVA120-**-10/11/12/13
MVA120-**-10/11/12/13

SPECIAL VICKERS

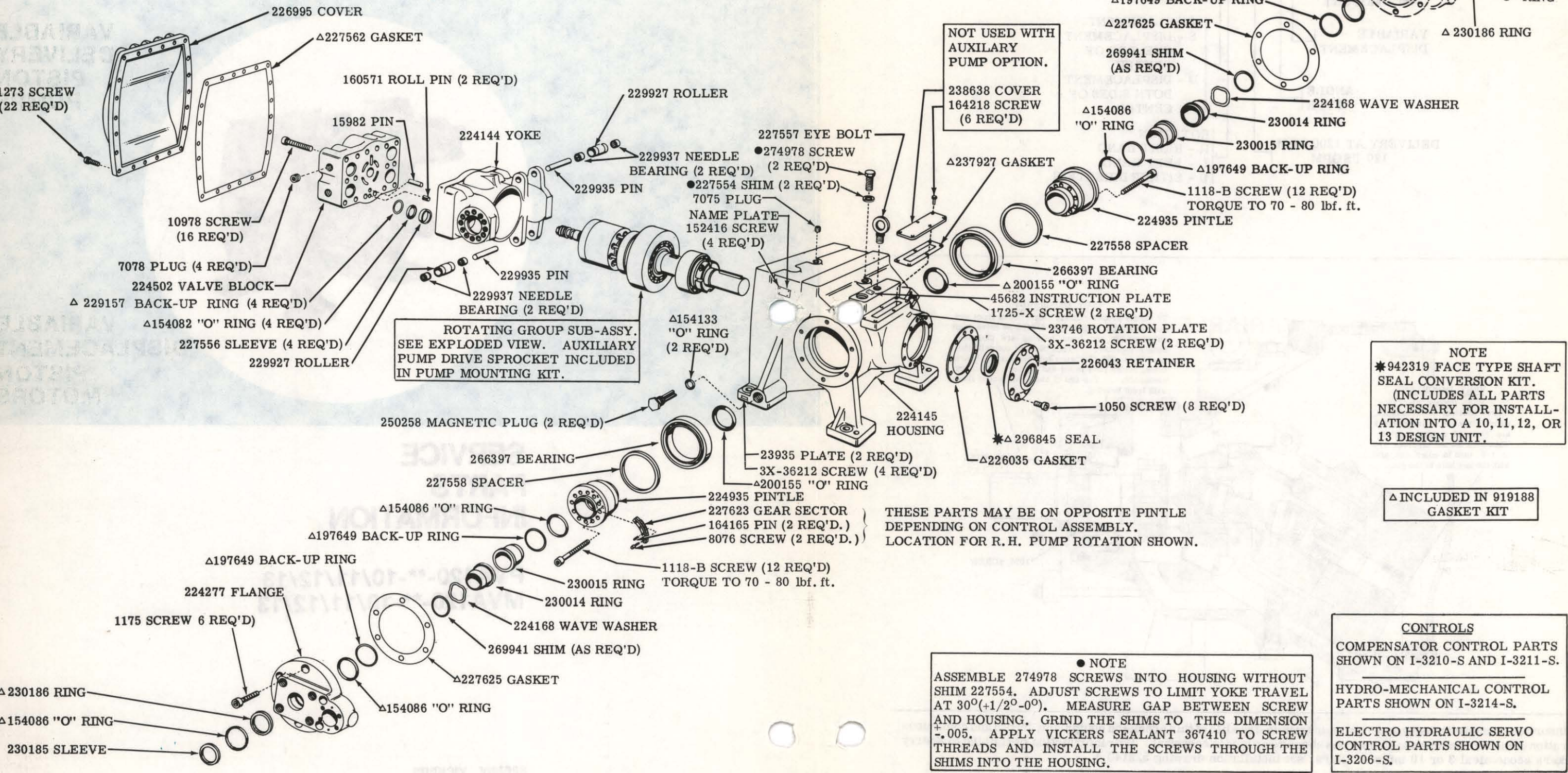

**ROTATING GROUP SUBASSEMBLY
EXPLODED VIEW**

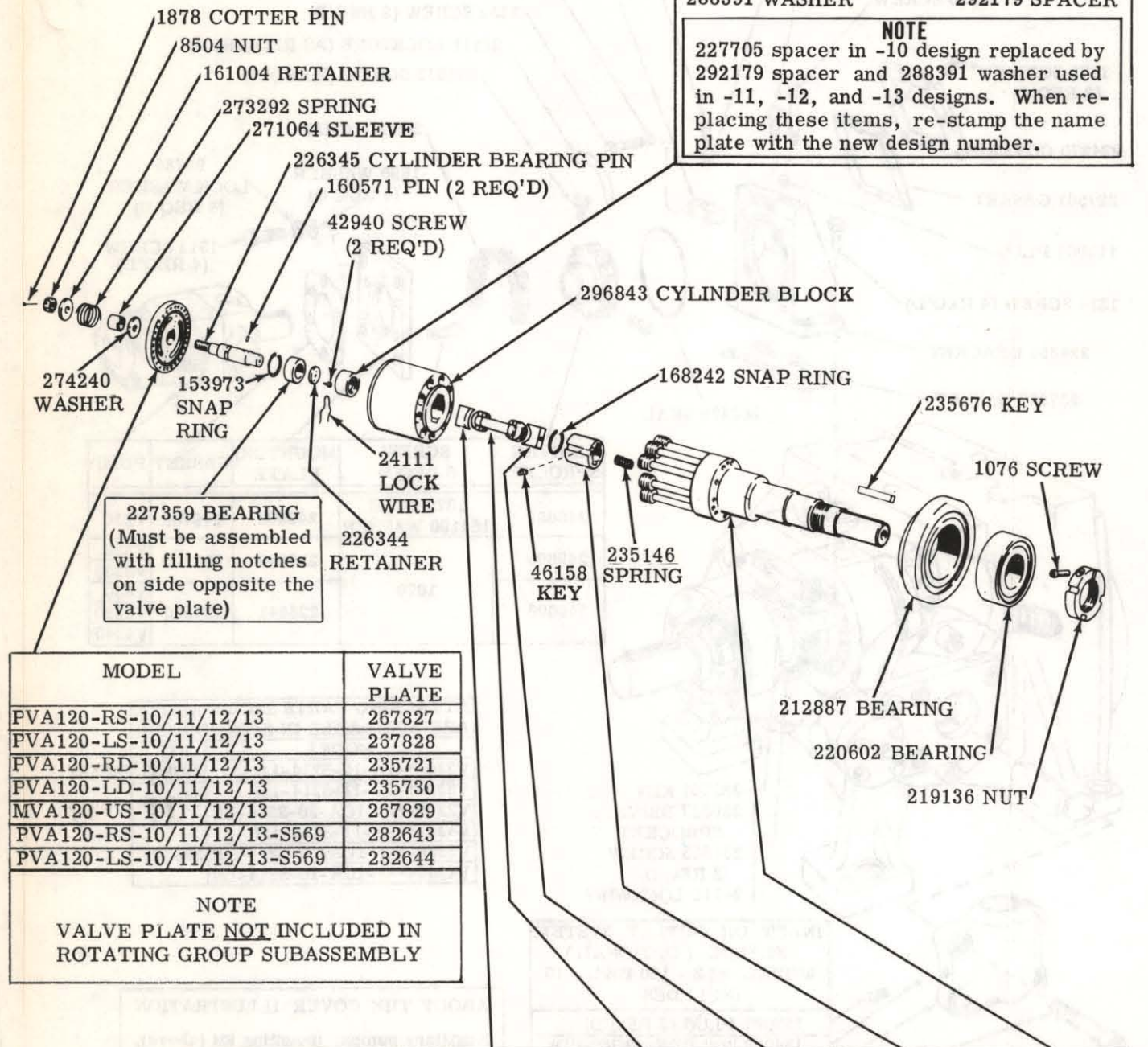

MODEL	VALVE PLATE
PVA120-RS-10/11/12/13	267827
PVA120-LS-10/11/12/13	237828
PVA120-RD-10/11/12/13	235721
PVA120-LD-10/11/12/13	235730
MVA120-US-10/11/12/13	267829
PVA120-RS-10/11/12/13-S569	282643
PVA120-LS-10/11/12/13-S569	232644

NOTE
VALVE PLATE NOT INCLUDED IN ROTATING GROUP SUBASSEMBLY

DESIGN NUMBER	ROTATING GROUP	BEARING	UNIV. LINK & PIN	BEARING	RETAINER	SHAFT S/A
10, 11, 12	*	220162	220161	220162	220163	226033
13	938070	350756	349456	341841	341842	344755

* USE ROTATING GROUP. 938070 TO SERVICE 10/11/12, & 13 DESIGNS.

**AUXILIARY PUMPS:
ATTACHING PARTS & SYSTEM FLANGES**

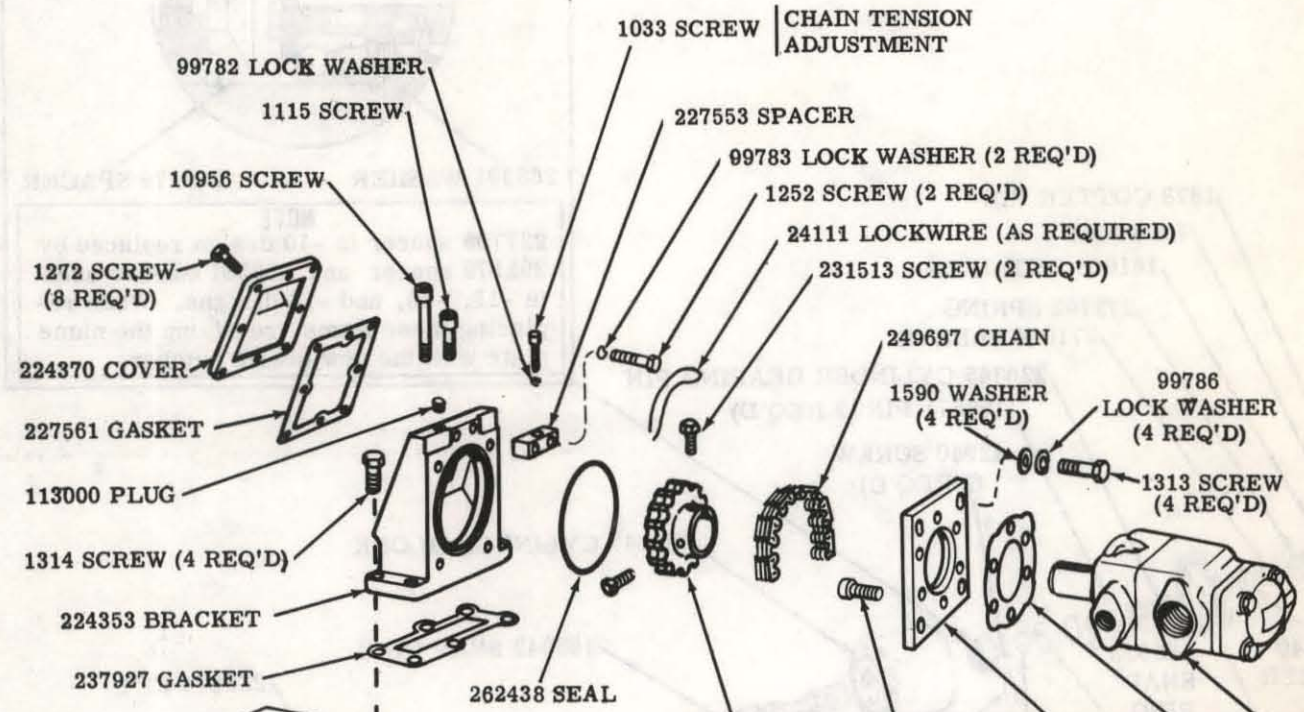

DRIVEN SPROCKET	SCREW 6 REQ'D	MOUNTING PLATE	GASKET	PUMP
249699	1072 WITH 161190 WASHER	249698	249700	V210
249695	1070	236520	238840	V330
				V2230
249696		225841	227560	V430 V3230 V4240

ATTACHING PARTS SHOWN ABOVE ARE AVAILABLE IN KITS. ORDER:

MODEL	KIT
V210-*-1A-12-S214-LH	293265
V330-*-1A-11-S214-LH	293266
V2230-*-1CA-20-S214-LH	
V430-*-1A-11-S214-LH	
V3230-*-1CA-10-S214-LH	293264
V4240-*-1CA-10-S214-LH	

INLET OR OUTLET SYSTEM FLANGE (OPTIONAL)
MODEL FL2 - 120 BWL - 10 INCLUDES

189087 PLUG (2 REQ'D)
154006 "O" RING (2 REQ'D)
224450 FLANGE
11001 SCREW (4 REQ'D)

ABOUT THE COVER ILLUSTRATION
Auxiliary pumps, mounting kit (above), cylinders, control and indicator are optional equipment.

MODEL CODE BREAKDOWN

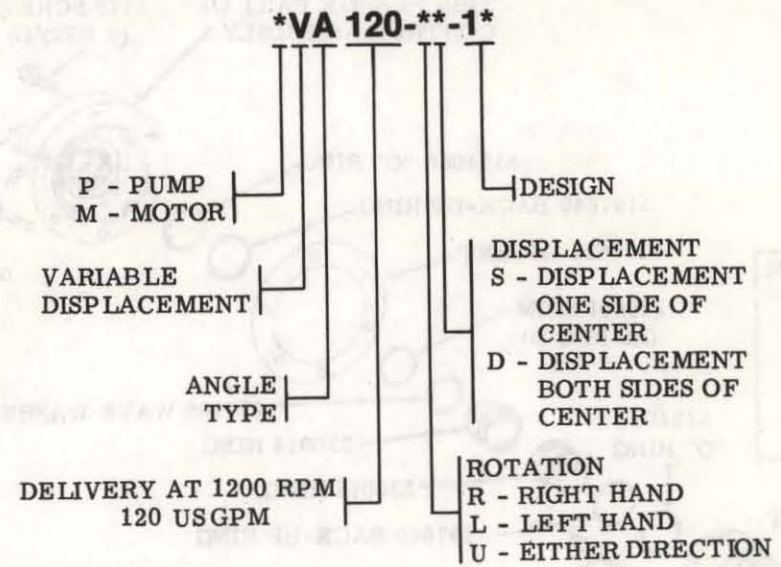

VERY IMPORTANT
To provide proper clearance, tighten 8504 nut so valve block, valve plate and cylinder block are clamped snugly together. Then back the nut off from 1/6 to 1/4 turn to align the slot with the key hole in the pin.

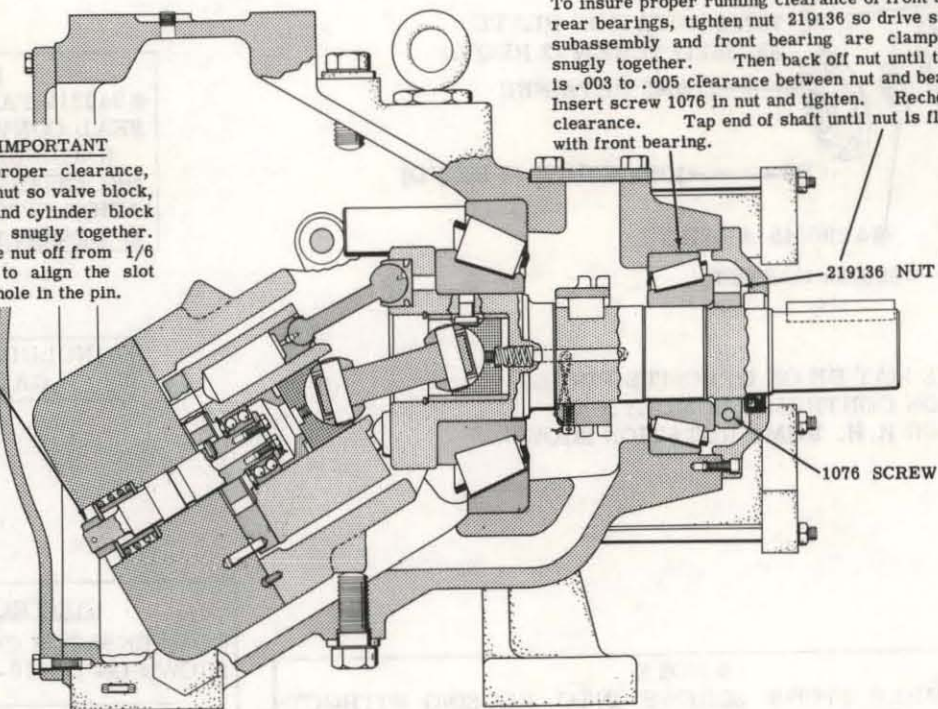

VERY IMPORTANT
To insure proper running clearance of front and rear bearings, tighten nut 219136 so drive shaft subassembly and front bearing are clamped snugly together. Then back off nut until there is .003 to .005 clearance between nut and bearing. Insert screw 1076 in nut and tighten. Recheck clearance. Tap end of shaft until nut is flush with front bearing.

To insure sustained efficiency and maximum trouble-free life of this precision equipment, initial and continuous filtration of the fluid medium to 25 microns absolute or less is essential. (For information pertaining to Sperry Vickers economical 3 or 10 micron filters, see installation drawing 522140.)

Litho in U. S. A.

SPERRY VICKERS

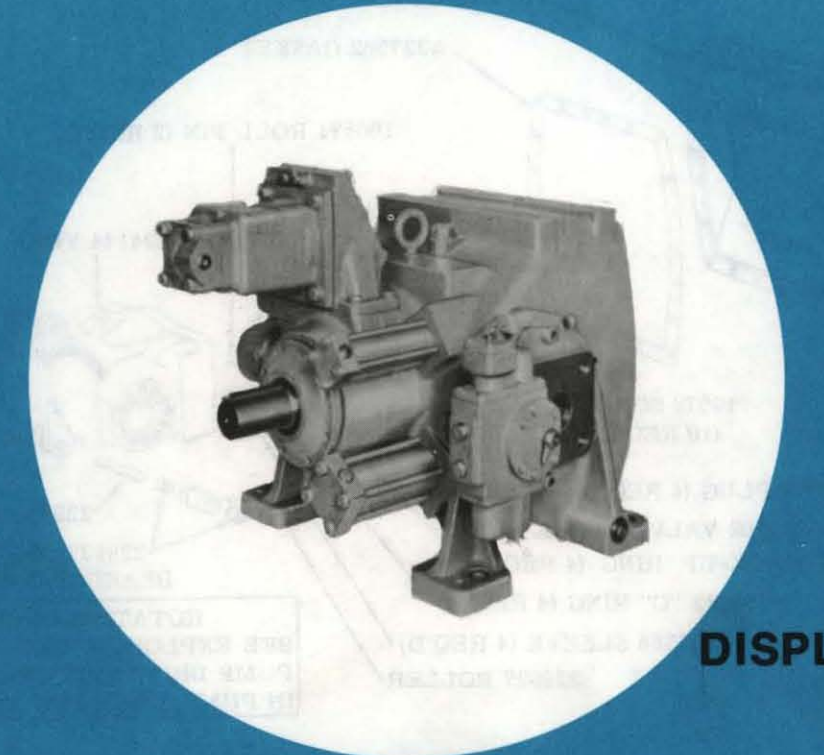

VARIABLE DELIVERY PISTON PUMPS

VARIABLE DISPLACEMENT PISTON MOTORS

SERVICE PARTS INFORMATION

PVA120--10/11/12/13
MVA120-**-10/11/12/13**

SPERRY VICKERS
TROY, MI. 48064