

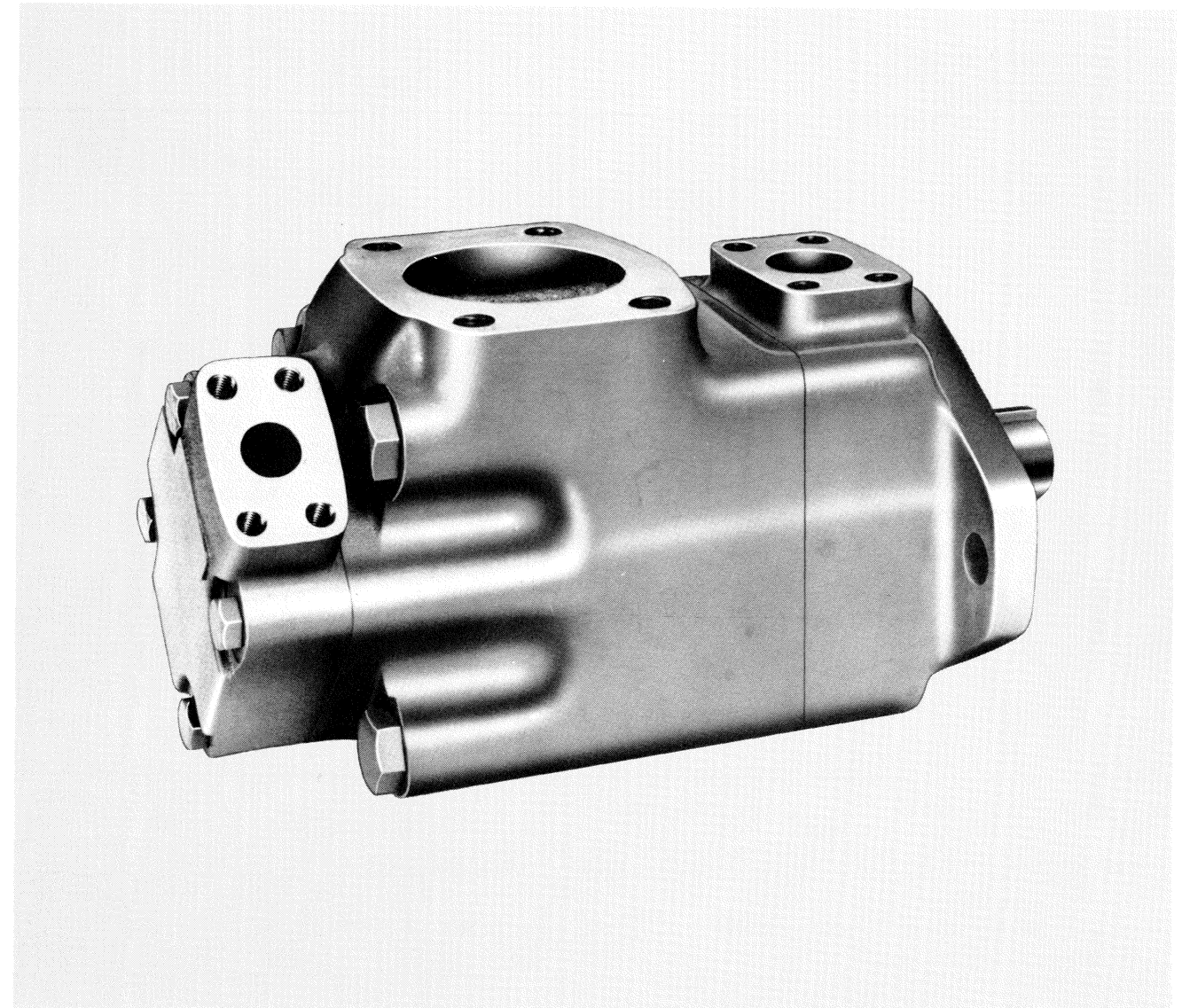

Service Data

Vane Type Double Pump

4525VQ Series -20 Design



Vickers Incorporated
 5445 Corporate Drive
 P. O. Box 302
 Troy, Michigan 48007-0302
 U.S.A.

Revised 10-01-89

SHARP EDGE OF VANE MUST
 LEAD DIRECTION OF ROTATION

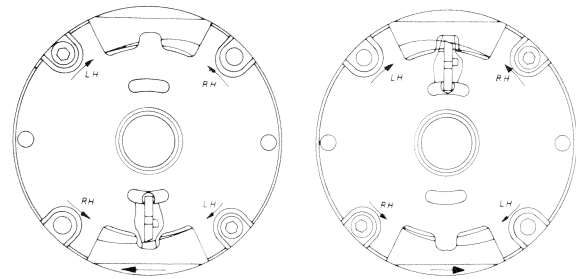

COVER END CARTRIDGE R. H. ROTATION SHAFT END CARTRIDGE R. H. ROTATION

NOTE
 STANDARD RIGHT HAND SHAFT ROTATION
 CARTRIDGES SHOWN: REVERSE FOR LEFT
 HAND ROTATION.

TO REVERSE CARTRIDGE KIT ROTATION,
 REMOVE THE TWO SCREWS, AND REVERSE
 THE LOCATION OF THE INLET SUPPORT
 PLATE AND OUTLET SUPPORT PLATE. RE-
 INSTALL THE TWO SCREWS HAND TIGHT.
 USE PUMP COVER TO ALIGN ALL SECTIONS
 OF THE CARTRIDGE. REMOVE COVER CARE-
 FULLY AND TIGHTEN SCREWS TO RECOM-
 MENDED TORQUE.

MODEL CODE BREAKDOWN

(F3) - 4525 VQ ** A ** - * 1 ** 20 (*) - 28*

1 2 3 4 5 6 7 8 9 10 11 12

1 VITON SEALS
 (OMIT IF NOT REQUIRED)

2 SERIES DESIGNATION

3 INTRA-VANE PUMP

4 US GPM CAPACITY
 (SHAFT END PUMP)
 SAE RATING 1200 RPM - 100 PSI (7 bar)
 42 - 42 GPM 57 - 57 GPM
 47 - 47 GPM 60 - 60 GPM
 50 - 50 GPM

5 SAE PORT CONNECTIONS

CODE	INLET	OUTLET #1	OUTLET #2
A	4-BOLT FLG.	4-BOLT FLG.	4-BOLT FLG.
E	4-BOLT FLG.	4-BOLT FLG.	SAE ST. THD.

6 US GPM CAPACITY
 (COVER END PUMP)
 SAE RATING 1200 RPM - 100 PSI (7 bar)
 12 - 12 GPM 19 - 19 GPM
 14 - 14 GPM 21 - 21 GPM
 17 - 17 GPM

7 MOUNTING
 F - FOOT (SINGLE SHAFT SEAL)
 S - FLANGE (DOUBLE SHAFT SEAL)
 OMITTED - FLANGE, SINGLE SHAFT
 SEAL ASSEMBLY

8 SHAFT
 1 - STRAIGHT WITH SQUARE KEY
 STANDARD
 11 - SPLINED
 19 - SPLINED
 86 - STRAIGHT WITH SQUARE
 KEY HEAVY DUTY
 114 - SPLINED

9 OUTLET PORT POSITIONS
 (VIEWED FROM COVER END OF PUMP)

With No. 1 Outlet Opposite Inlet :
 AA - No. 2 Outlet - 135° CCW From Inlet
 AB - No. 2 Outlet - 45° CCW From Inlet
 AC - No. 2 Outlet - 45° CW From Inlet
 AD - No. 2 Outlet - 135° CW From Inlet

With No. 1 Outlet 90° CCW From Inlet :
 BA - No. 2 Outlet - 135° CCW From Inlet
 BB - No. 2 Outlet - 45° CCW From Inlet
 BC - No. 2 Outlet - 45° CW From Inlet
 BD - No. 2 Outlet - 135° CW From Inlet

With No. 1 Outlet Inline With Inlet :
 CA - No. 2 Outlet - 135° CCW From Inlet
 CB - No. 2 Outlet - 45° CCW From Inlet
 CC - No. 2 Outlet - 45° CW From Inlet
 CD - No. 2 Outlet - 135° CW From Inlet

With No. 1 Outlet 90° CW From Inlet :
 DA - No. 2 Outlet - 135° CCW From Inlet
 DB - No. 2 Outlet - 45° CCW From Inlet
 DC - No. 2 Outlet - 45° CW From Inlet
 DD - No. 2 Outlet - 135° CW From Inlet

10 DESIGN

11 ROTATION
 (VIEWED FROM SHAFT END)
 L - LEFT HAND (CCW ROTATION)
 OMITTED - RIGHT HAND ROTATION

12 MOUNTING
 282 - SAE 2-BOLT MOUNTING
 283 - FOOT MOUNTING

For satisfactory service life of these components, use full flow filtration to provide fluid which meets ISO cleanliness code 16/13 or cleaner. Selections from pressure, return, and in-line filter series are recommended.

Litho in U.S.A.

I-3172-S

MODEL DESIGNATION	COVER TYPE	COVER
4525VQ*A**-**10	4-BOLT	231532
4525VQ*E**-**10	STRAIGHT THREAD	242250

4525VQ * * A * * (*) - S * * 20 (*)				
SHAFT PART NUMBER	KEY	SECONDARY SHAFT SEAL	SHAFT NO.	TYPE
233524	217596	---	1	STR. KEYED STD.
233527	---	---	11	SPLINE
247102	---	---	19	SPLINE
361762	239751	---	86	STR. KEYED, HEAVY DUTY
413024	---	429282	114	SPLINE

MOUNTING ASSEMBLY 4525VQ**A**F-***20(*)		
INCLUDED IN FOOT BRACKET KIT NO. FB-C-10	SCREW (2 REQ'D) 205533	MOUNTING BRACKET 205077

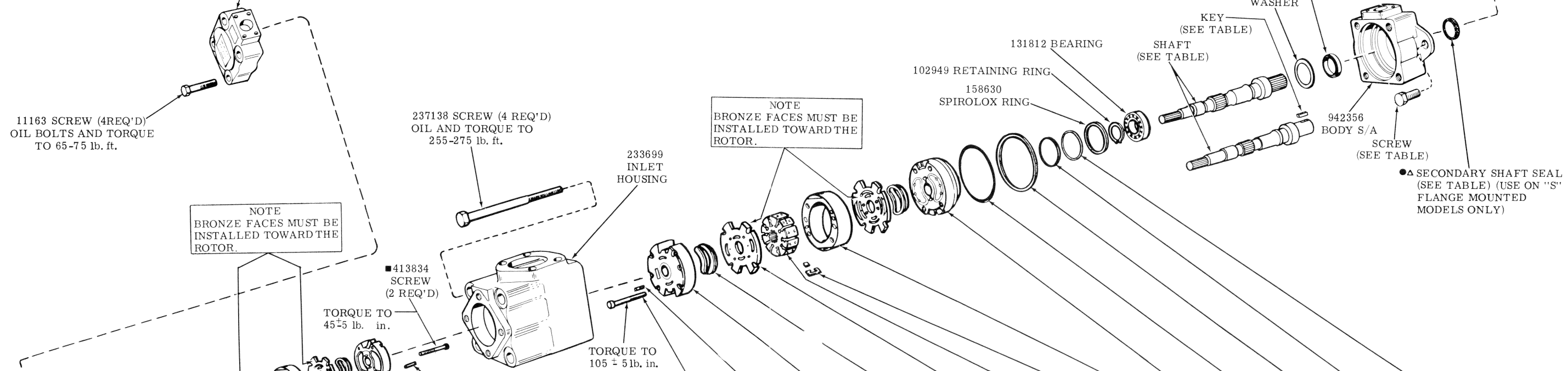

SHAFT END CAPACITY (US GPM)	SCREW (2 REQ'D)	PIN (2 REQ'D)	INLET SUPPORT PLATE	▲ SEAL PACK (4 REQ'D)	FLEX-SIDEPLATE KIT	ROTOR	VANE KIT	RING	OUTLET SUPPORT PLATE	▲ "O" RING	▲ *SEAL RING	▲ "O" RING	▲ BACK-UP RING	STD. CART. KIT	F3 CART. KIT
THESE PARTS ARE INCLUDED IN CARTRIDGE KIT															
4525VQ42A-****-***20(*)					923954 INCL. 2 FLEX SIDE PLATES	283871	922701 (INCLUDES 10 VANES & 10 INSERTS)	297510					588509	416435	419511
4525VQ47A-****-***20(*)								297718						421234	421954
4525VQ50A-****-***20(*)	380109	422208	430708 S/A	433768 S/A				297502	425510	154107	419675	154087		416436	419510
4525VQ57A-****-***20(*)								306772						421233	421955
4525VQ60A-****-***20(*)								297503						416437	419509

▲ BACK-UP RING	▲ "O" RING	▲ *SEAL RING	▲ "O" RING	OUTLET SUPPORT PLATE	▲ SEAL PACK (4 REQ'D)	FLEX SIDE PLATE KIT	ROTOR	VANE KIT	RING	INLET SUPPORT PLATE	STD. CART. KIT	F3 CART. KIT	COVER END CAPACITY (US GPM)
THESE PARTS ARE SERVICED IN CARTRIDGE KIT													
588507	154078	419673	154095	419079	433764 S/A	923956 INCL. 2 FLEX SIDE PLATES	270597	922710 (10 VANES & INSERTS)	326984	419080	421244	421576	4525VQ***12(*)***20(*)
									326985		421235	421577	4525VQ***14(*)***20(*)
									326986		421236	421578	4525VQ***17(*)***20(*)
									326987		421237	421579	4525VQ***19(*)***20(*)
									326988		421238	421580	4525VQ***21(*)***20(*)

- INCLUDED IN CARTRIDGE KIT
- ASSEMBLE SEAL WITH SPRING LOADED SEALING MEMBER TOWARD BEARING.
- ASSEMBLE SEAL FLUSH WITH PILOT FACE WITH SPRING LOADED SEALING MEMBER FACING INWARD AS SHOWN.
- * INSTALL SEAL RING IN BODY OR COVER, THEN INSTALL CARTRIDGE KIT.
- ▲ INCLUDED IN SINGLE SHAFT SEAL KIT 920068 F3 EQUIVALENT SEAL KIT 920070
- ▲▲ INCLUDED IN DOUBLE SHAFT SEAL KIT 920069 F3 EQUIVALENT SEAL KIT 920071

