

MODEL CODE BREAKDOWN

(F3) 45VT****-286*20(L)-28*

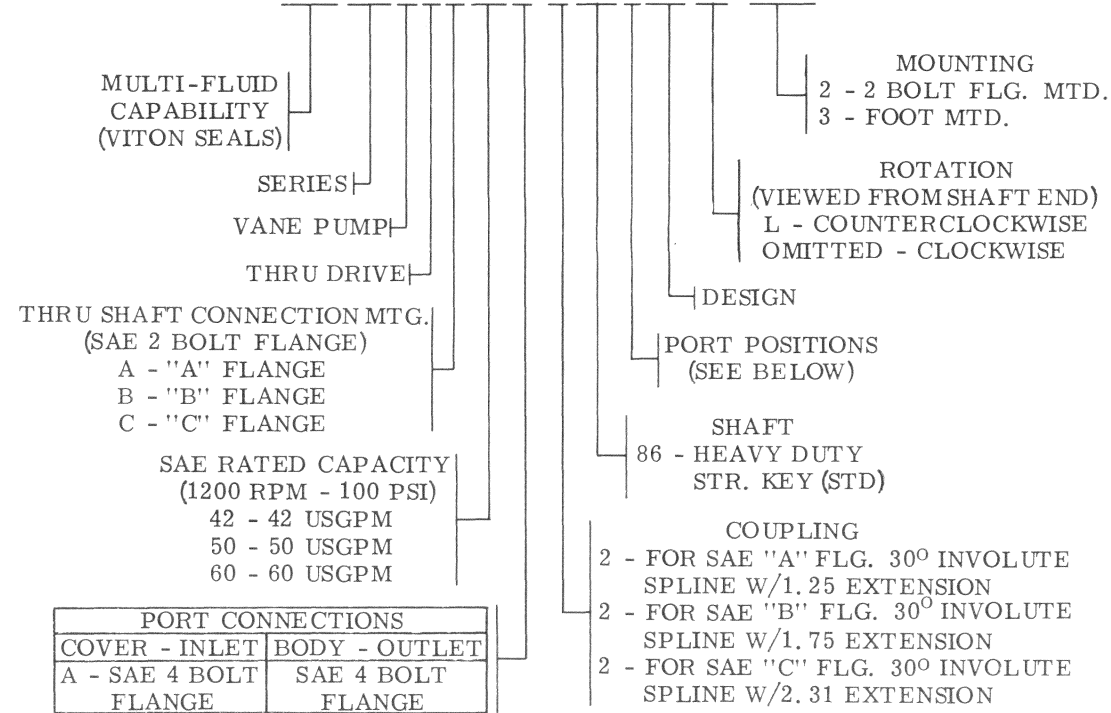

PORT CONNECTIONS	
COVER - INLET	BODY - OUTLET
A - SAE 4 BOLT FLANGE	SAE 4 BOLT FLANGE

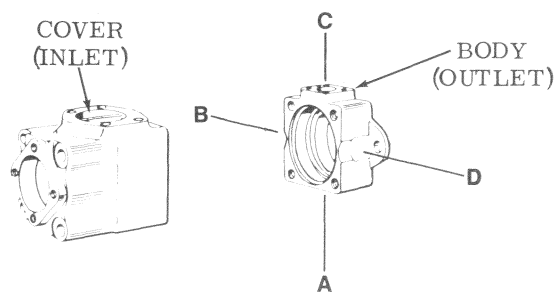

MODEL	OUTLET POSITIONS (VIEWED FROM COVER END)
45VT****-***A20(L)-28*	OPPOSITE INLET
45VT****-***B20(L)-28*	90° CCW FROM INLET
45VT****-***C20(L)-28*	INLINE WITH INLET PORT
45VT****-***D20(L)-28*	90° CW FROM INLET

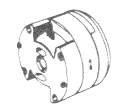

PARTS ARE THE SAME FOR RIGHT AND LEFT HAND ROTATION. WHEN ORDERING SPARE CARTRIDGE PARTS, IT IS RECOMMENDED THEY BE OBTAINED IN CART-RIDGE KITS. KITS ARE ASSEMBLED AND TESTED BY VICKERS FOR EITHER RIGHT OR LEFT HAND ROTATION. IF LEFT HAND ROTATION IS REQUIRED, IT SHOULD BE SPECIFIED ON PARTS ORDER BY ADDING SUFFIX "L" TO CARTRIDGE KIT NUMBER: FOR EXAMPLE 581663-L.



Service Parts Information

Thru Drive Vane Type Pumps

45VT****-2****20-28*

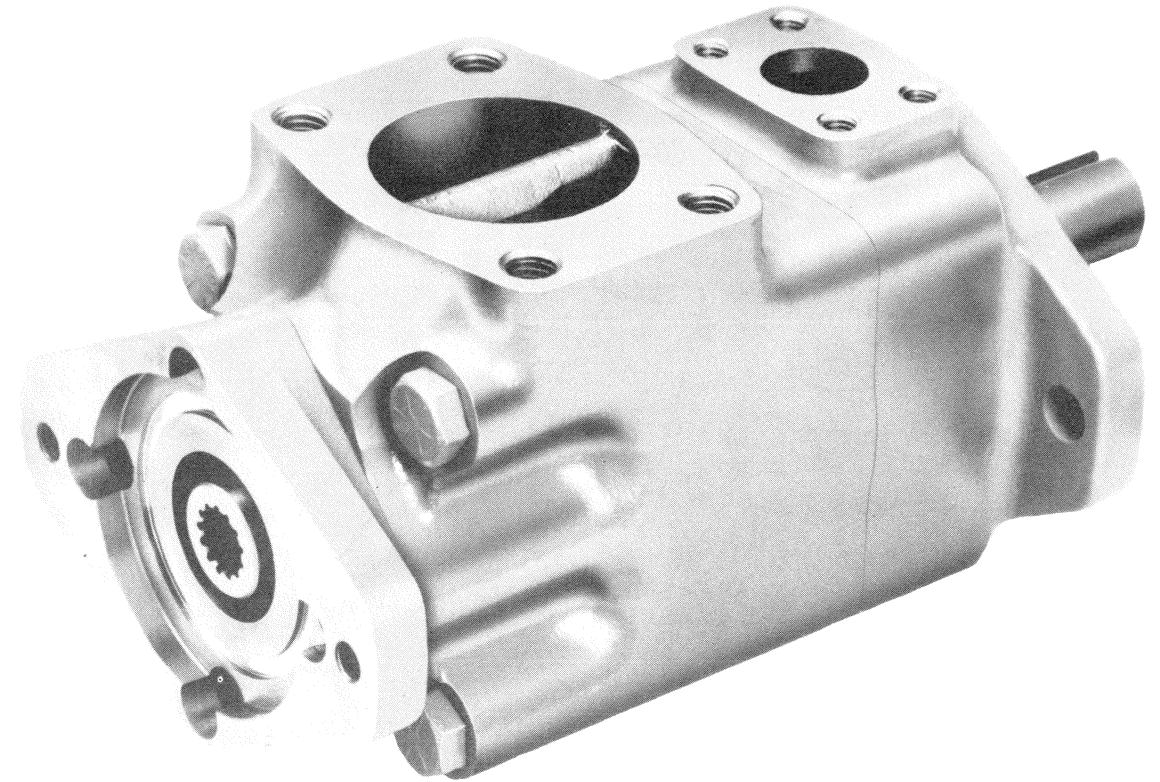

Vickers, Incorporated

1401 Crooks Road
Troy, Michigan 48084

Revised 10-1-85

I-3151-S

NOTE
Seals must be completely wetted at assembly with an SAE 10W motor oil of "SE" quality or an industrial hydraulic oil equivalent.

PIN (2 REQ'D)	SCREW (2 REQ'D)	WEAR PLATE SUB-ASSY	RING	ROTOR	VANE KIT (12 VANES & 12 INSERTS)	PRESSURE PLATE	●STD KIT	F3 KIT	MODEL
THESE PARTS ARE INCLUDED IN CARTRIDGE KIT									
220888	289476	578903 (INCLUDES BUSHING)	581679 581680 578904	578900	941049	580921	581663 581664 580919	584312 584313 584314	45VT*42A-20-28* 45VT*50A-20-28* 45VT*60A-20-28*

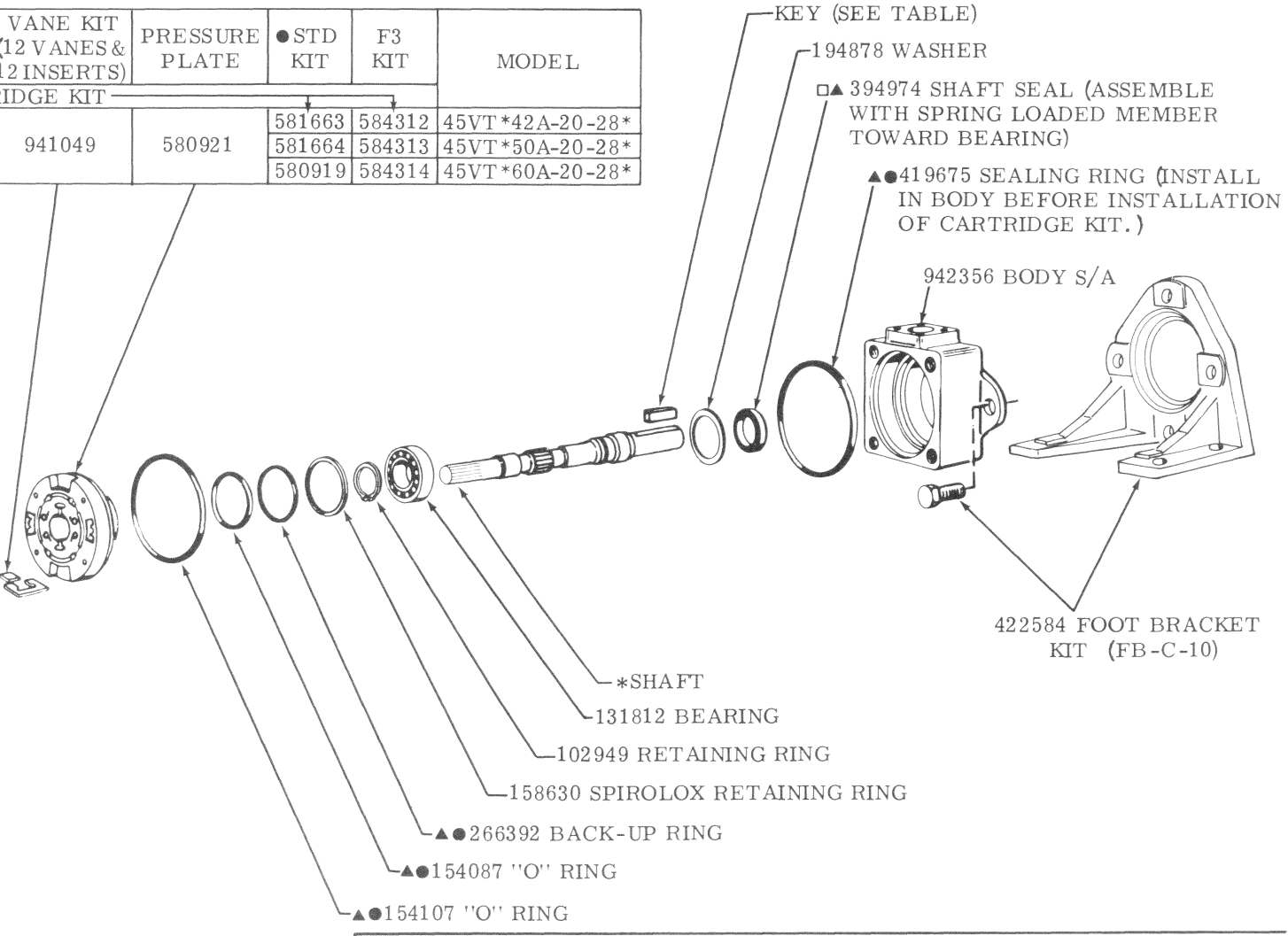
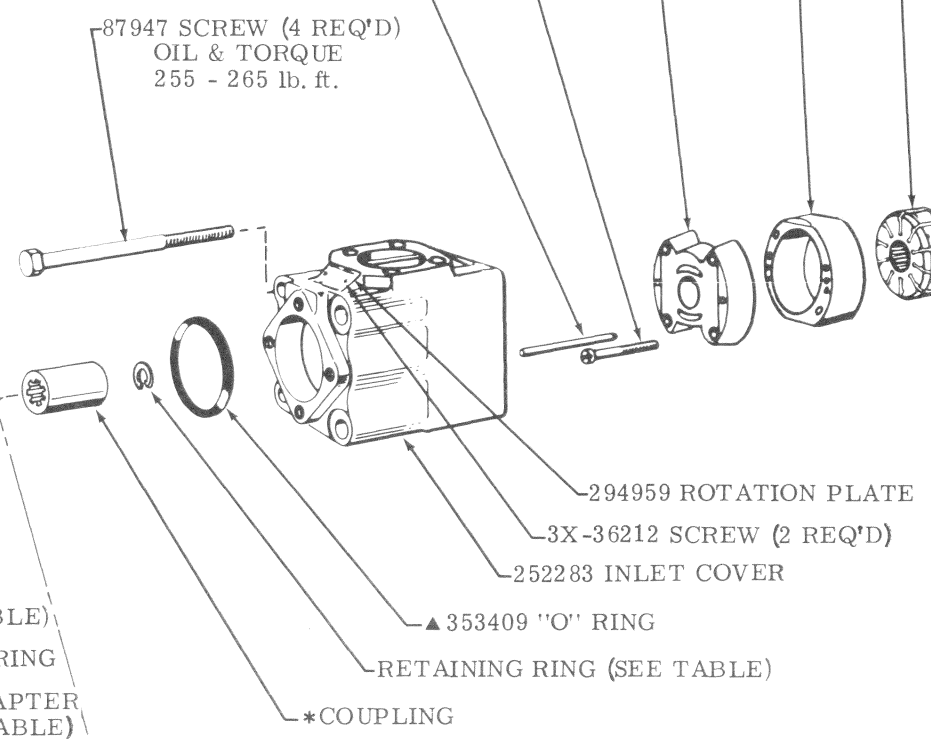
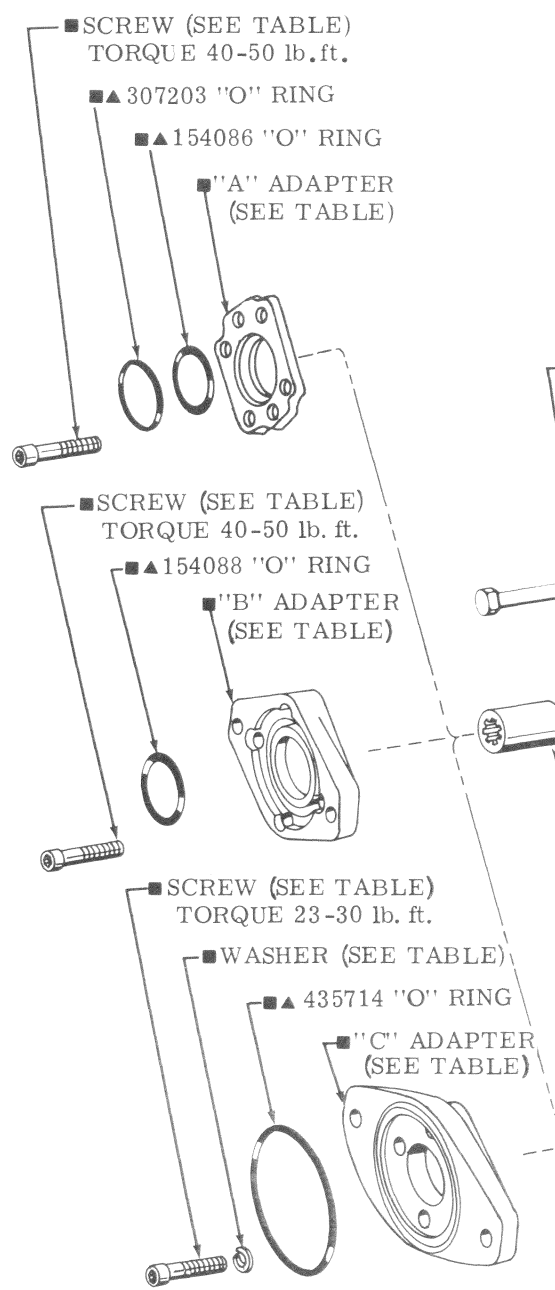

MODEL	ADAPTER	SCREW (4 REQ'D)	WASHER (4 REQ'D)	ADAPTER KIT
45VTA	584936	298147	—	941296
45VTB	584922	—	—	941297
45VTC	581833	298148	582519	941298

THE TABULATED ADAPTER KITS HAVE F3 SEALS. STANDARD KITS ARE NOT PROVIDED FOR SERVICE

● ALSO INCLUDED IN CARTRIDGE KIT

MODEL	▲ STD SEAL KIT	F3 SEAL KIT
45VTA	920201	920202
45VTB	920203	920204
45VTC	920205	920206

MODEL	*RETAINING RING	*KEY	*SHAFT & COUPLING KIT
45VTA286	223172	—	941305
45VTB286	83003	239751	941306
45VTC286	103989	—	941307

SHAFT AND COUPLING MUST BE SERVICED AS A KIT

