

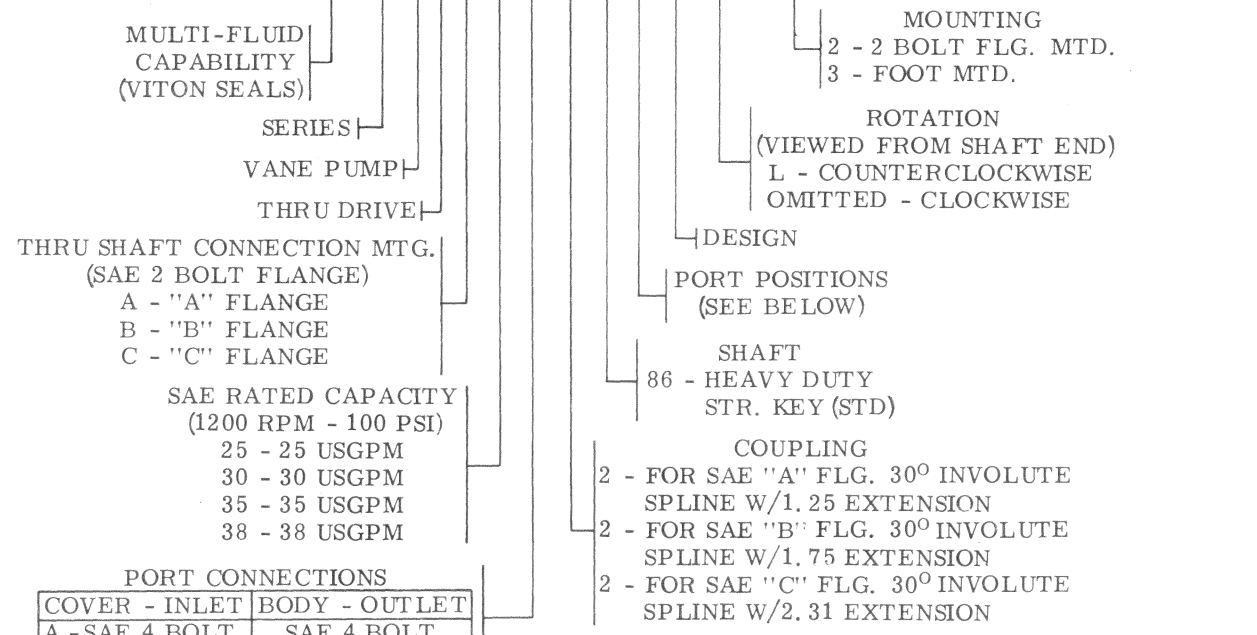

Service Parts Information

MODEL CODE BREAKDOWN

(F3)35VT****-286*20(L)-28*



Thru Drive
Vane Type Pump

35VT****-286*20-28*

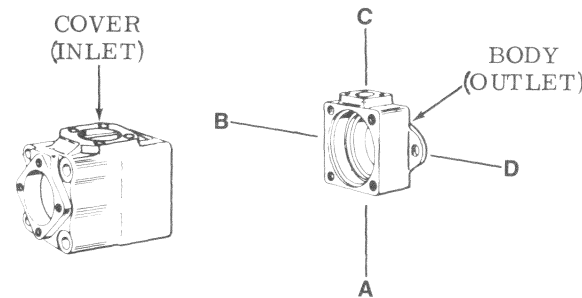
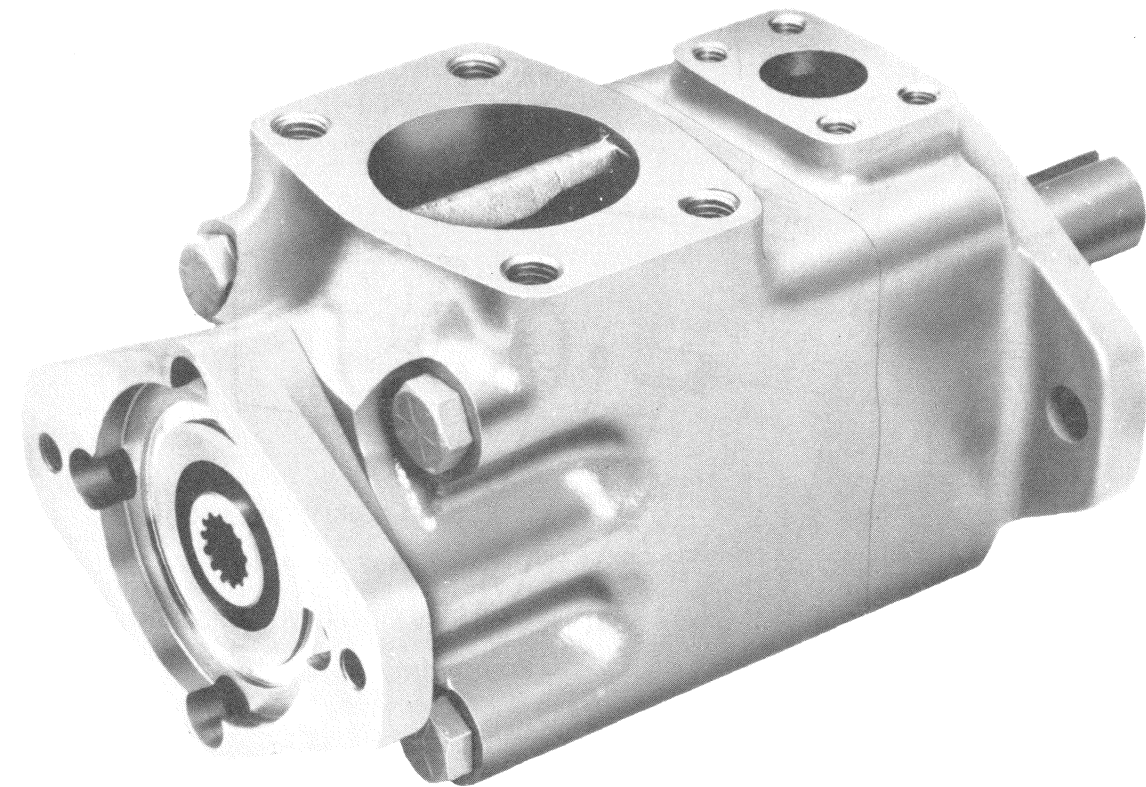

MODEL	OUTLET POSITIONS (VIEWED FROM COVER END)
35VT****-***A20(L)-28*	OPPOSITE INLET
35VT****-***B20(L)-28*	90° CCW FROM INLET
35VT****-***C20(L)-28*	INLINE WITH INLET PORT
35VT****-***D20(L)-28*	90° CW FROM INLET



PARTS ARE THE SAME FOR BOTH RIGHT AND LEFT HAND ROTATION. WHEN ORDERING SPARE CARTRIDGE PARTS, HOWEVER, IT IS RECOMMENDED THEY BE OBTAINED IN CARTRIDGE KITS. KITS ARE ASSEMBLED AND TESTED BY VICKERS FOR EITHER RIGHT OR LEFT HAND ROTATION. IF LEFT HAND ROTATION IS REQUIRED, IT SHOULD BE SPECIFIED ON PARTS ORDER BY ADDING SUFFIX "L" TO CARTRIDGE NUMBER: FOR EXAMPLE, 578311-L.

Vickers, Incorporated

1401 Crooks Road
Troy, Michigan 48084

Revised 6-1-85

I-3149-S

Litho in U. S. A.

For satisfactory service life of these components in industrial applications, use full flow filtration to provide fluid which meets ISO cleanliness code 18/15 or cleaner. Selections from Vickers OFP, OFR, and OFRS series are recommended.

MODEL	*RETAINING RING	*KEY	*SHAFT & COUPLING KIT
35VTA286	223172	393536	941302
35VTB286	83003		941303
35VTC286	237807		941304

SHAFT AND COUPLING MUST BE SERVICED AS A KIT

NOTE
Seals must be completely wetted at assembly with an SAE 10W motor oil of "SE" quality or an industrial hydraulic oil equivalent.

SCREW (2 REQ'D)	PIN (2 REQ'D)	WEAR PLATE SUB-ASSY	RING	ROTOR	VANE KIT (12 VANES & 12 INSERTS)	PRESSURE PLATE	●STD KIT	F3 KIT	MODEL
THESE PARTS ARE INCLUDED IN CARTRIDGE KIT									
289475	280031	576265 (INCLUDES BUSHING)	576210	575478	941019	575479	578311	584306	35VT*25
			576212				578312	584307	35VT*30
			576214				578313	584308	35VT*35
			575476				578314	584309	35VT*38

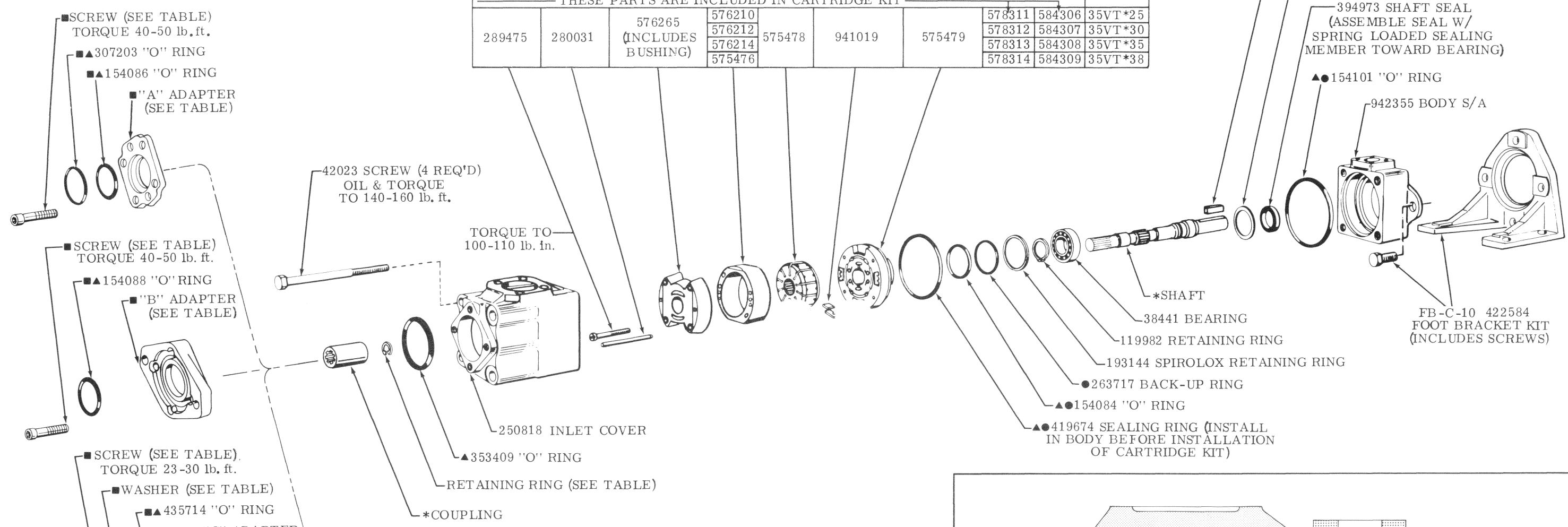

MODEL	ADAPTER	SCREW (4 REQ'D)	WASHER (4 REQ'D)	ADAPTER KIT
35VTA	584936	298147	—	941296
35VTB	584922	—	—	941297
35VTC	581833	298148	582519	941298

THE TABULATED ADAPTER KITS HAVE F3 SEALS. STANDARD KITS ARE NOT PROVIDED FOR SERVICE

MODEL	▲ STD SEAL KIT	F3 SEAL KIT
35VTA	920195	920196
35VTB	920197	920198
35VTC	920199	920200

● ALSO INCLUDED IN CARTRIDGE KIT

