

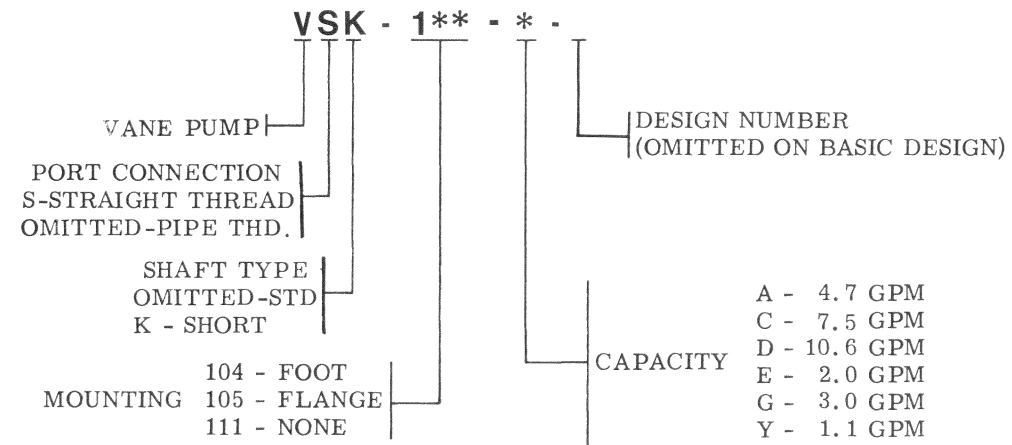

Service Parts Information

MODEL CODE BREAKDOWN



Vane
Type
Single
Pumps

Small Series
V, VK, VS and VSK-104, 105, 111-*
Basic and -10 Designs

ASSEMBLED FOR
RIGHT HAND ROTATION

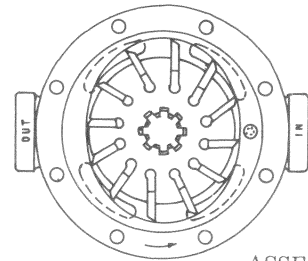

ASSEMBLED FOR
LEFT HAND ROTATION

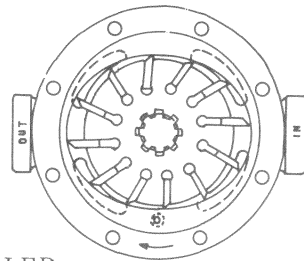

ASSEMBLED
VIEW
FACING HEAD END

Assembly of the rotor and vanes is determined by the direction of the pump shaft rotation. Vanes must be assembled so that the small beveled edges are trailing as shown. Rotation is determined by viewing pump from shaft end. Clockwise rotation of the shaft for right hand. Left hand rotation is counterclockwise.

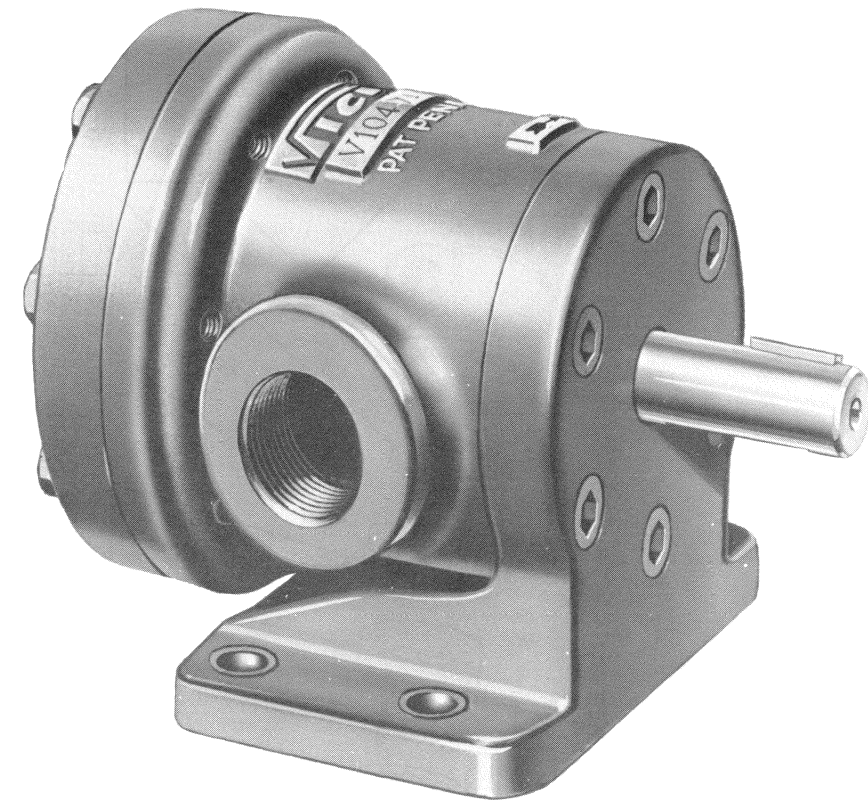

Vickers, Incorporated

1401 Crooks Road
Troy, Michigan 48084

Revised 9-1-85

I-3101-S

For satisfactory service life of these components in industrial applications, use full flow filtration to provide fluid which meets ISO cleanliness code 18/15 or cleaner. Selections from Vickers OFP, OFR, and OFRS series are recommended.

-10 DESIGN

SEE SERVICE MANUAL
I-3100-S FOR
MAINTENANCE INFORMATION.

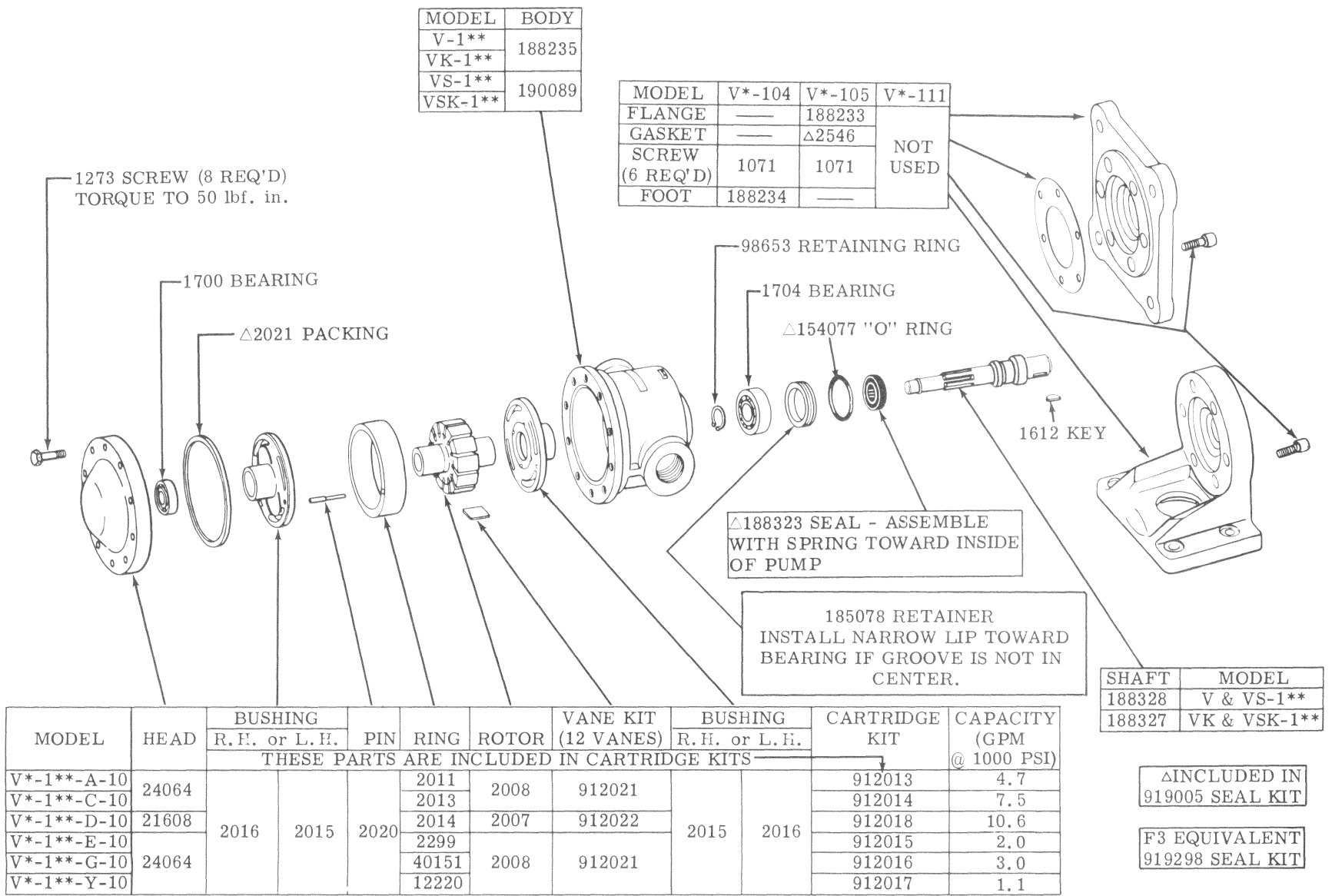

- O DESIGN

SEE SERVICE MANUAL
I-3100-S FOR
MAINTENANCE INFORMATION.

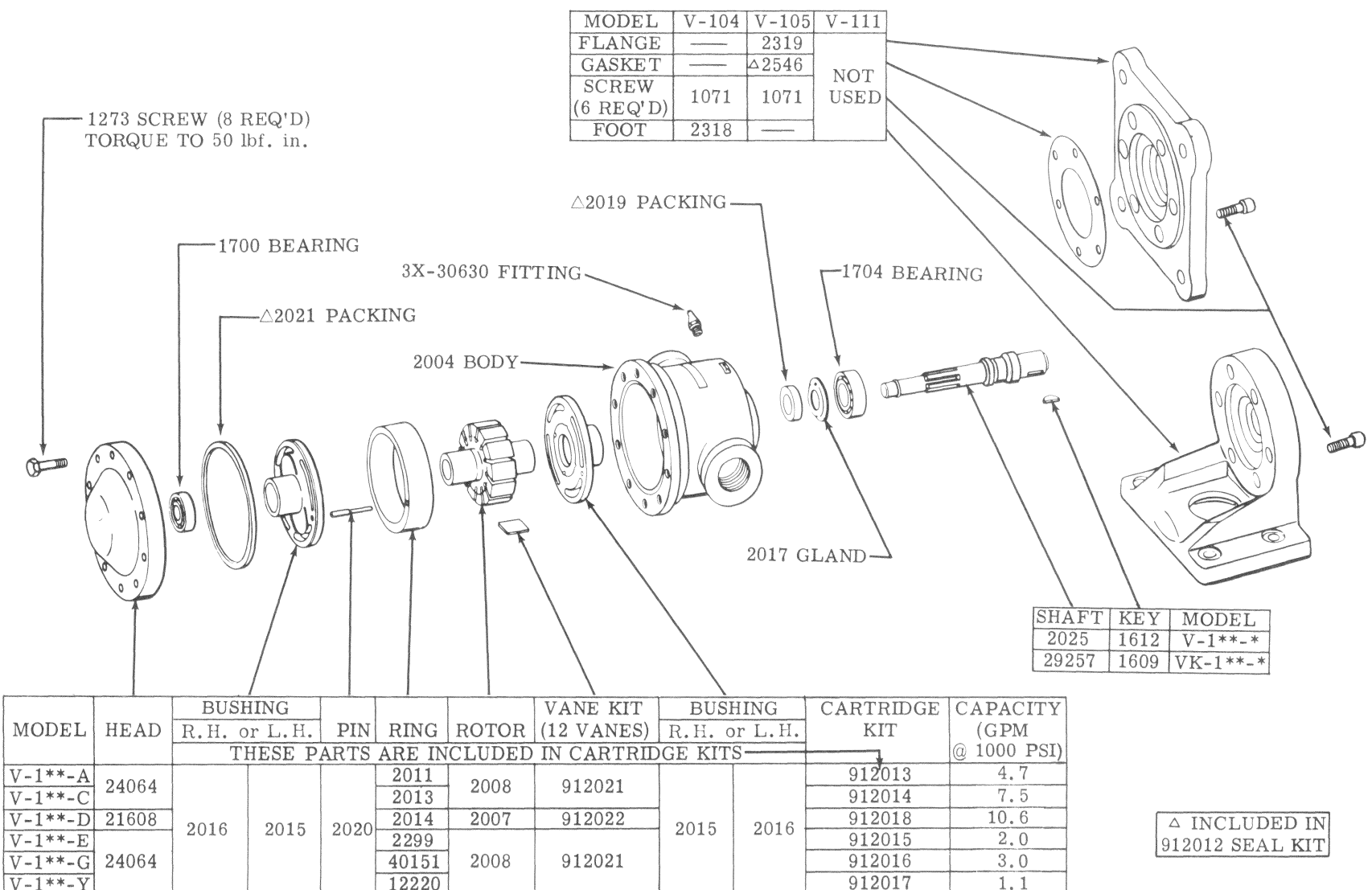

Δ INCLUDED IN
912012 SEAL KIT