

Service Parts Information

M2-400 SERIES VANE MOTORS

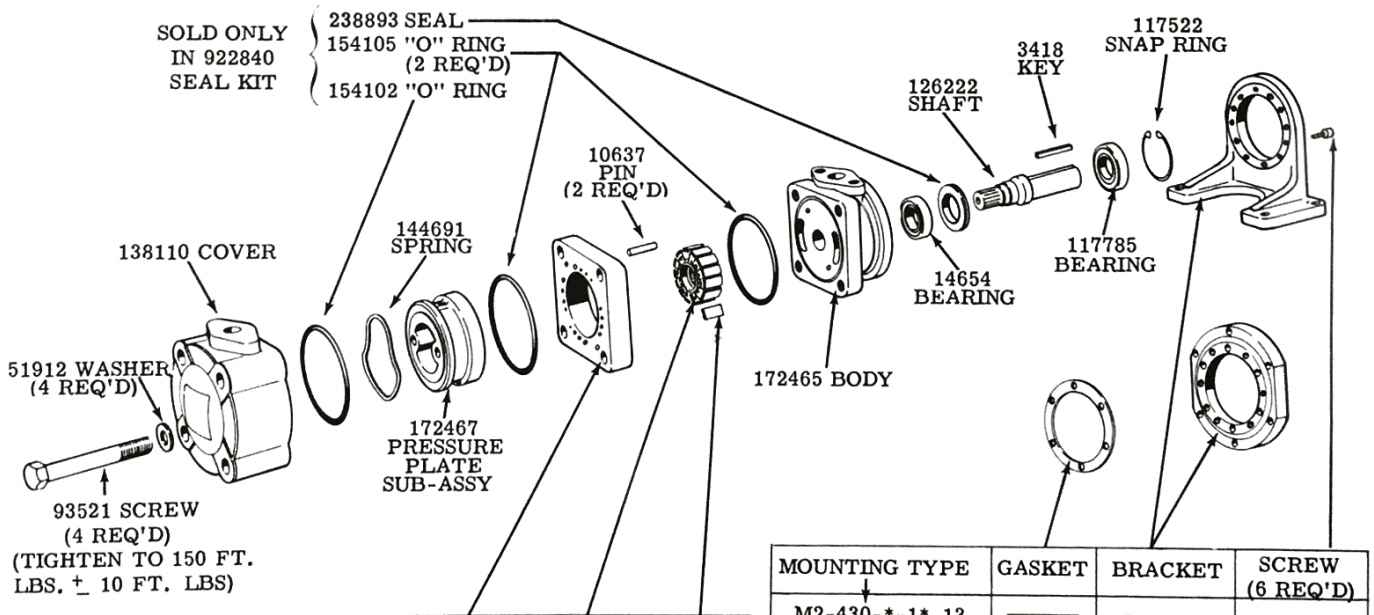
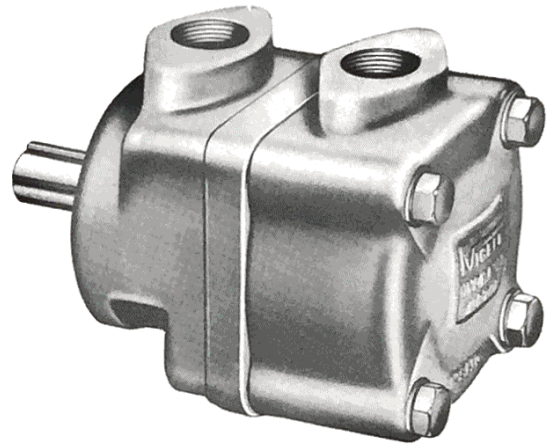
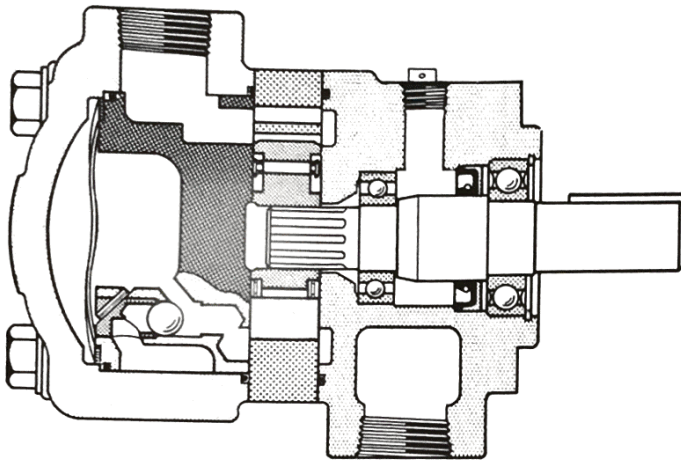

TORQUE CAPACITY	CARTRIDGE KIT	RING	ROTOR SUB-ASSY	VANE KIT
	INCLUDED IN CARTRIDGE KIT			
M2-43*-90-1*-13	922841	172469	170404	
M2-43*-115-1*-13	922842	172470	170403	912105

MOUNTING TYPE	GASKET	BRACKET	SCREW (6 REQ'D)
M2-430*-1*-13	—	—	—
M2-434*-1*-13	—	122896 (FOOT)	1072
M2-435*-1*-13	134305	128747 (FLANGE)	1274

MODEL CODE BREAKDOWN

M 2 - 4 1 * - ** - * * - 13 - S**

VANE MOTOR

REVERSIBLE

SERIES

BODY

MOUNTING

TORQUE
RATING

SHAFT

SPECIAL FEATURES

DESIGN

PORT POSITIONS

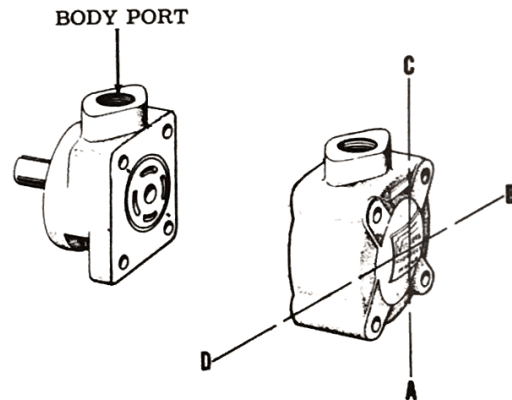

MODEL CODE	COVER PORT POSITION (VIEWED FROM COVER)
A	Opposite body port
B	90° clockwise from body port
C	In line with body port
D	90° c/clockwise from body port