

SPERRY VICKERS

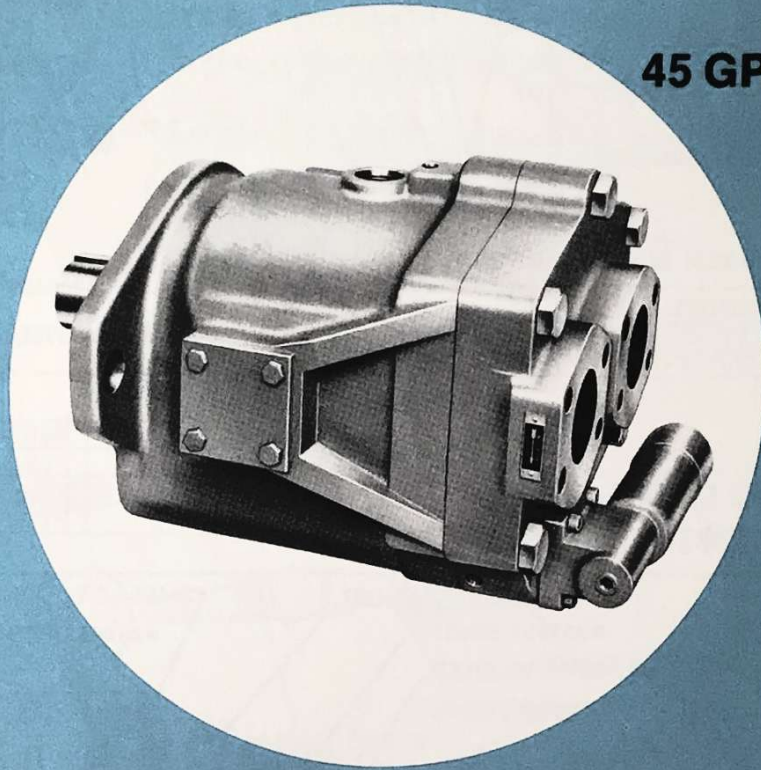

**45 GPM VARIABLE  
DELIVERY  
IN-LINE  
PISTON  
PUMPS**

**SERVICE  
PARTS  
INFORMATION**

**PVB45-(F)\*SF-11-C(M)(\*)-10**

**SPERRY VICKERS  
TROY, MI. 48064**



**COMPENSATOR CONTROL**  
**PVB45-(F)RSF-11-C(M)(\*)-10**  
**PVB45-(F)LSF-11-C(M)(\*)-10**

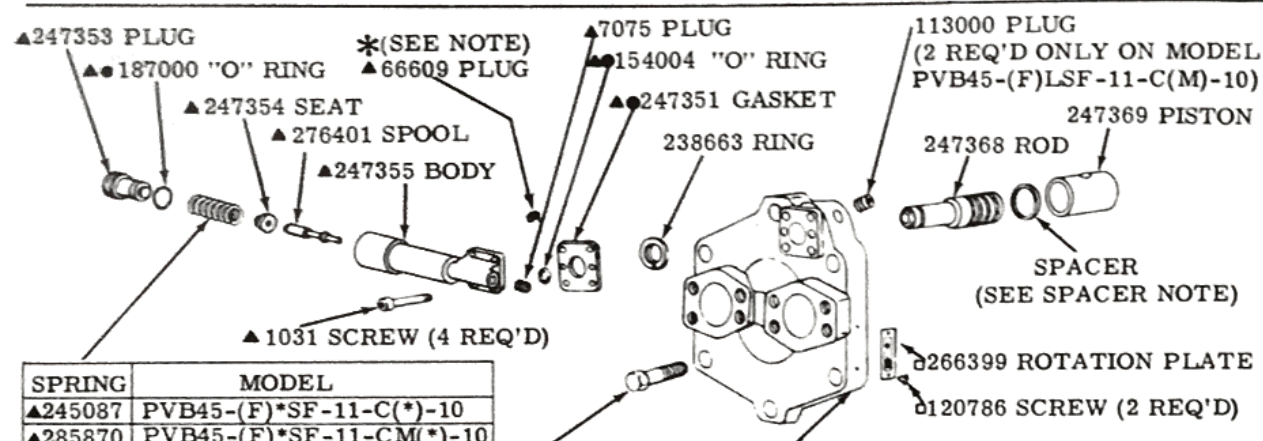

SPRING	MODEL
▲245087	PVB45-(F)*SF-11-C(*)-10
▲285870	PVB45-(F)*SF-11-C(M)(*)-10

**COMPENSATOR CONTROL**  
**MODELS: PVB45-(F)\*SF-11-C(M)(\*)-10**

1356 SCREW (6 REQ'D)  
 (TORQUE TO 90/95 LBS. FT.)

VALVE PLATE S/A	MODEL
942138	PVB45-*RSF-11-CM*-10
942139	PVB45-*LSF-11-CM*-10
941890	PVB45-*RSF-11-C*-10
941891	PVB45-*LSF-11-C*-10

SPACER NOTE	
MODEL	SPACER
PVB45-(F)*SF-11-C(M)-10	
PVB45-(F)*SF-11-C(M)9-10	307050
PVB45-(F)*SF-11-C(M)8-10	306825
PVB45-(F)*SF-11-C(M)7-10	307051
PVB45-(F)*SF-11-C(M)6-10	307052

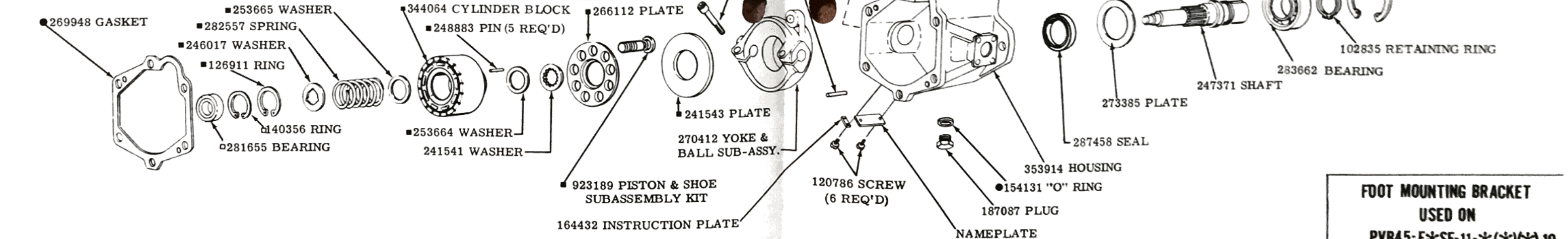
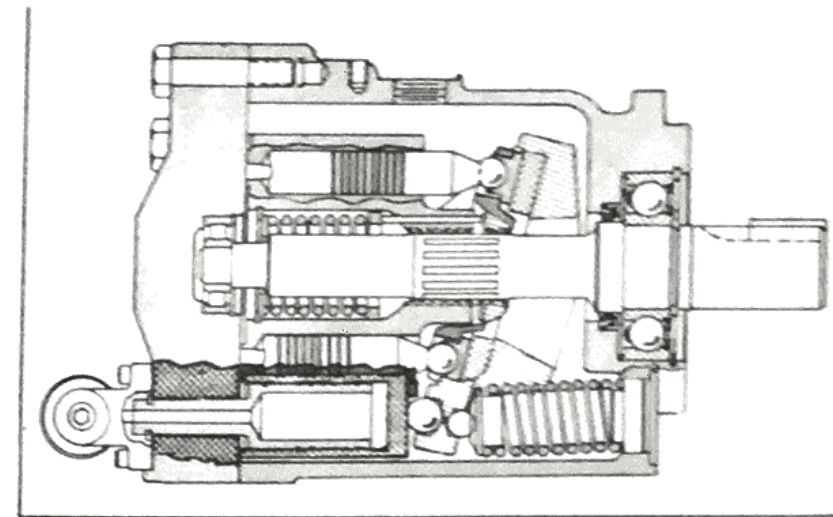

\* 66609 ORIFICE PLUG (MUST BE INSTALLED IN THE DRAIN PORT OF THE COMPENSATOR BODY, BELOW THE MOUNTING SURFACE.)

◻ INCLUDED IN VALVE PLATE SUBASSEMBLY

▲ INCLUDED IN COMPENSATOR SUBASSY: 941744-"C" MODELS 941745-"CM" MODELS

■ INCLUDED IN 938286 ROTATING GROUP

● INCLUDED IN 919401 GASKET KIT

SEE PARTS DRAWING I-3963-S FOR PORT FLANGE DATA

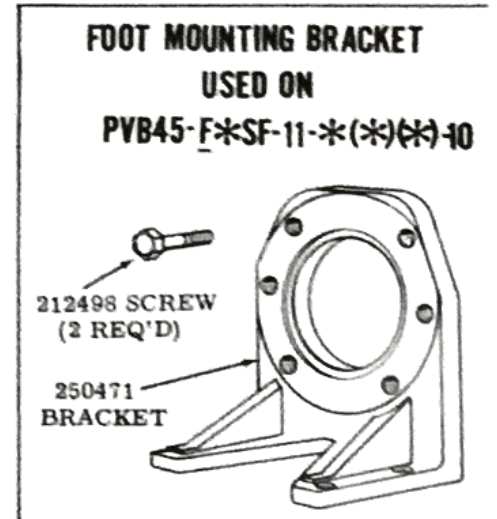

# MODEL CODE BREAKDOWN

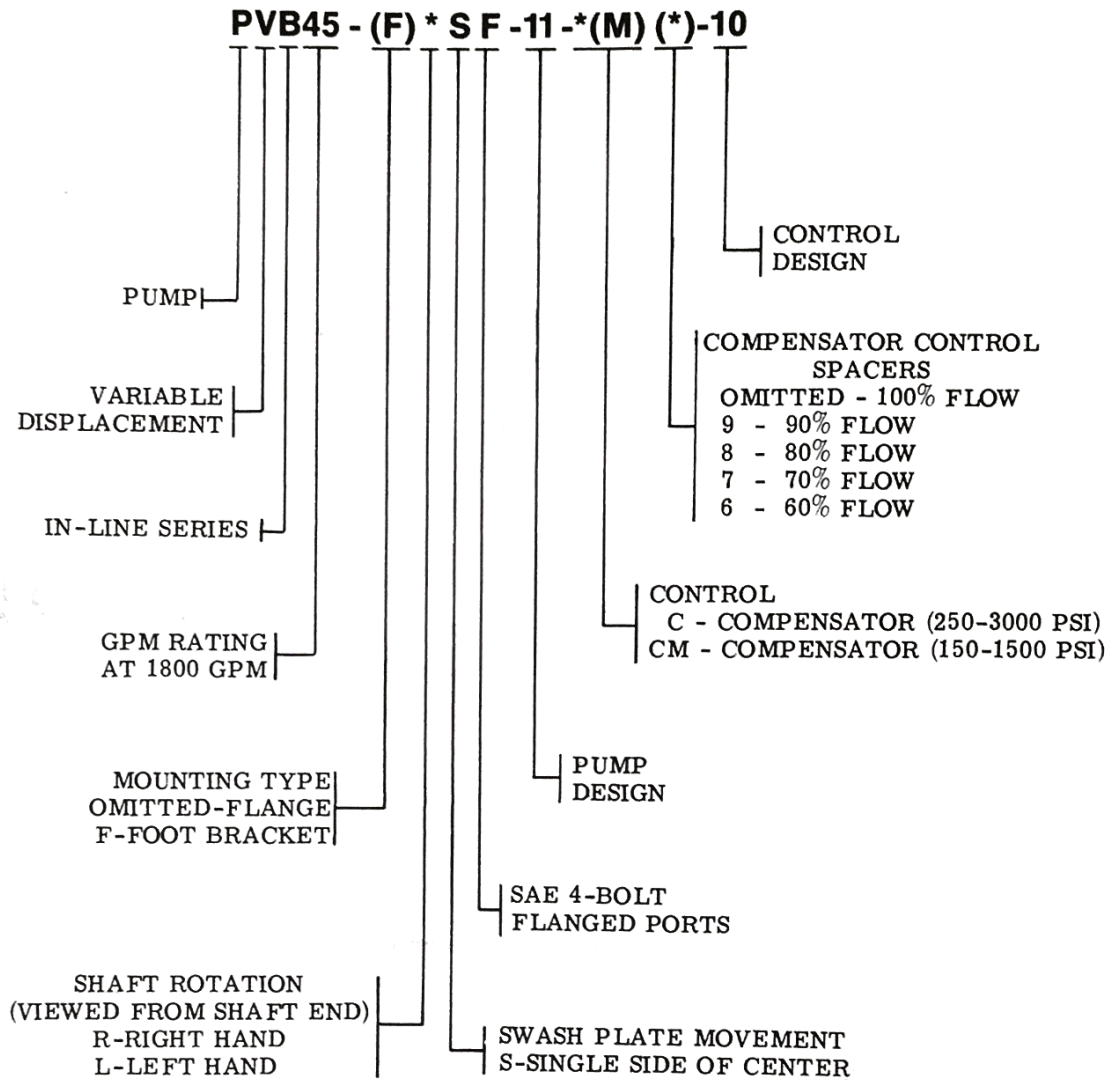

To insure sustained efficiency and maximum trouble-free life of this precision equipment, initial and continuous filtration of the fluid medium to 25 microns or less is essential. (For information pertaining to Vickers economical 10 micron filters, see installation drawing 522140.)