

**VICKERS**

**20 AND 29 GPM VARIABLE  
IN-LINE PISTON PUMPS**

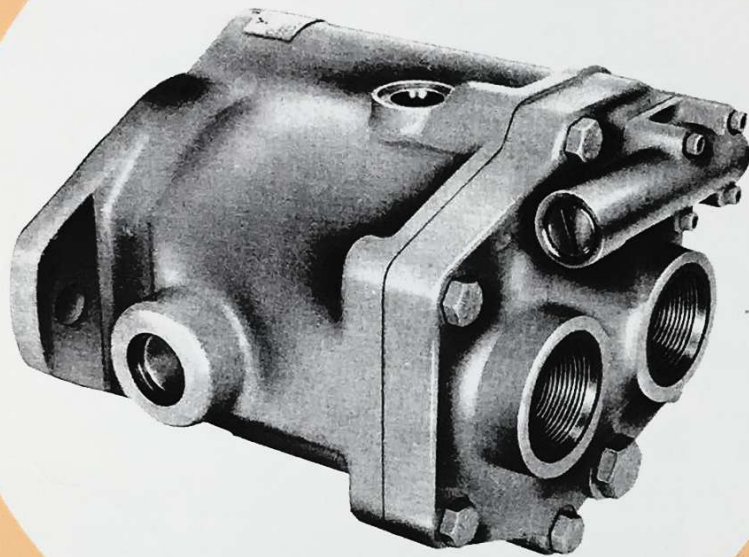

**SERVICE  
PARTS  
INFORMATION**

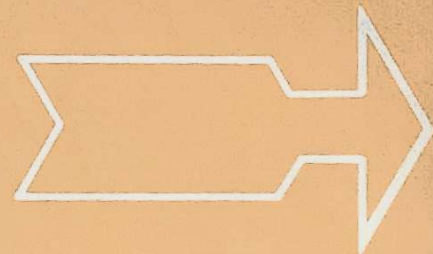

**PVB20-(F)\*S-10-C(M)(\*)-10  
PVB20-(F)\*S-10-H-10  
PVB29-(F)\*S-10-C(M)(\*)-10  
PVB29-(F)\*S-10-H-10**

**VICKERS INCORPORATED**  
DIVISION OF SPERRY RAND CORPORATION  
Machinery Hydraulics Division  
Service Department

**PVB 20-(F)\*S-10-C(M)(\*)-10**  
**PVB 29-(F)\*S-10-C(M)(\*)-10**

SPRING	MODEL
239371#	PVB20-(F)*S-10-C(*)-10
265693#	PVB20-(F)*S-10-CM(*)-10
239371#	PVB29-(F)*S-10-C(*)-10
265693#	PVB29-(F)*S-10-CM(*)-10

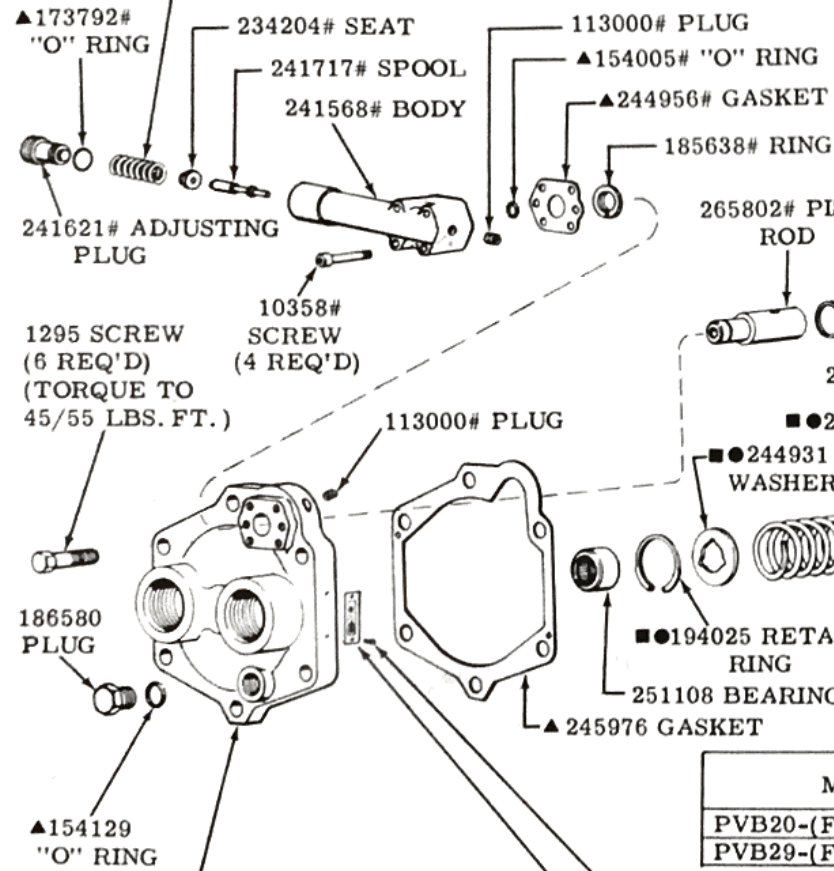

VALVE PLATE S/A INC. 251108 BEARING	MODEL
938400#	PVB20-(F)RS-10-C(M)(*)-10
938401#	PVB20-(F)LS-10-C(M)(*)-10
938404#	PVB29-(F)RS-10-C(M)(*)-10
938405#	PVB29-(F)LS-10-C(M)(*)-10

MODEL	SPRING	CYLINDER BLOCK	PISTON S/A KIT
PVB20-(F)*S-10-*(M)(*)-10	● 246386	● 250688	● 941883
PVB29-(F)*S-10-*(M)(*)-10	■ 263582	■ 259458	■ 941888

SPACER	MODEL
NONE	PVB2*-(F)*S-10-C(*)-10
289179#	PVB2*-(F)*S-10-C(*)9-10
285628#	PVB2*-(F)*S-10-C(*)8-10
289180#	PVB2*-(F)*S-10-C(*)7-10
276460#	PVB2*-(F)*S-10-C(*)6-10

120786 SCREW (2 REQ'D)  
 266399 ROTATION PLATE  
 (ARROW POINTING UP)  
 (POSITION SHOWN FOR R. H.  
 OPPOSITE SIDE FOR L. H.)  
 (BOTH PARTS INCLUDED IN  
 VALVE PLATE SUB-ASSYS.)

# PARTS USED IN COMPENSATOR MODELS ONLY

▲ INCLUDED IN 919232 GASKET KIT

■ INCLUDED IN 938290 ROTATING GROUP

● INCLUDED IN 938280 ROTATING GROUP

1076 SCREW  
 (2 REQ'D)  
 (TORQUE TO 45/55 LBS. FT.)

■ 239335 SWASH PLATE

- 248835 PIN (3 REQ'D)
- 238836 WASHER
- 283993 WASHER
- 248609 PLATE

- 238780 WASHER
- 244931 WASHER

- 194025 RETAINING RING

251108 BEARING

▲ 245976 GASKET

275675 PLUG (2 REQ'D)

▲ 175943 "O" RING (2 REQ'D)

257946 PINTLE YOKE (2 REQ'D)

11456 BEARING (2 REQ'D)

3913 PIN (2 REQ'D)

245982 HOUSING

311295 YOKE AND BALL SUB-ASSEMBLY

245982 HOUSING

212464 SCREW (2 REQ'D)  
 USED ON PVB2\*-F\*S-10-\*(M)(\*)-10

120786 SCREW (4 REQ'D)

NAME PLATE

164432 INSTRUCTION PLATE

245975 SEAT

294079 SPRING

▲ 154132 "O" RING

245973 PLUG

245979 SHAFT

194878 RETAINER

295262 SEAL (ASSEMBLE WITH SPRING TOWARD INSIDE OF UNIT)

283090 BEARING

117506 RETAINING RING

117507 RETAINING RING

204077 BRACKET USED ON PVB2\*-F\*S-10-\*(M)(\*)-10

**PVB 20-(F)\*S-10-H-10**  
**PVB 29-(F)\*S-10-H-10**

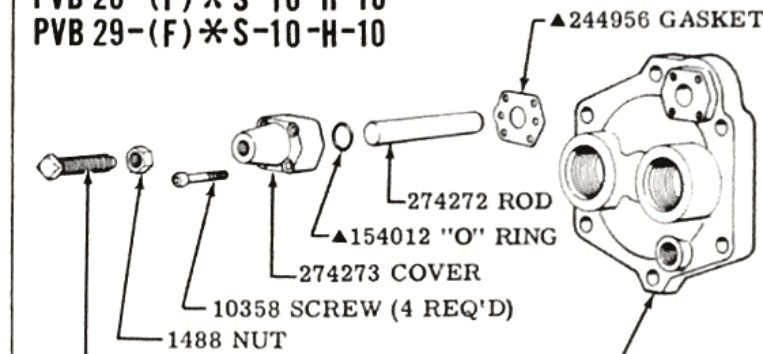

274397 SCREW

MODEL	VALVE PLATE S/A INC. 251108 BEARING
PVB20-(F)RS-10-H-10	938402
PVB20-(F)LS-10-H-10	938403
PVB29-(F)RS-10-H-10	938406
PVB29-(F)LS-10-H-10	938407

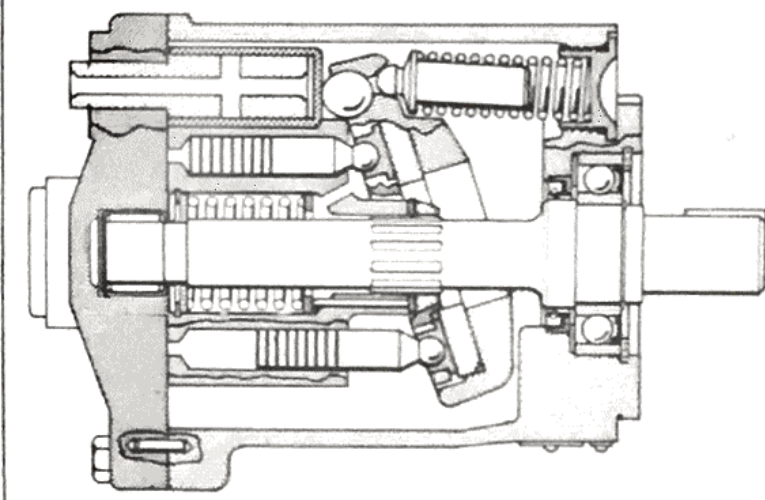

# MODEL CODE BREAKDOWN

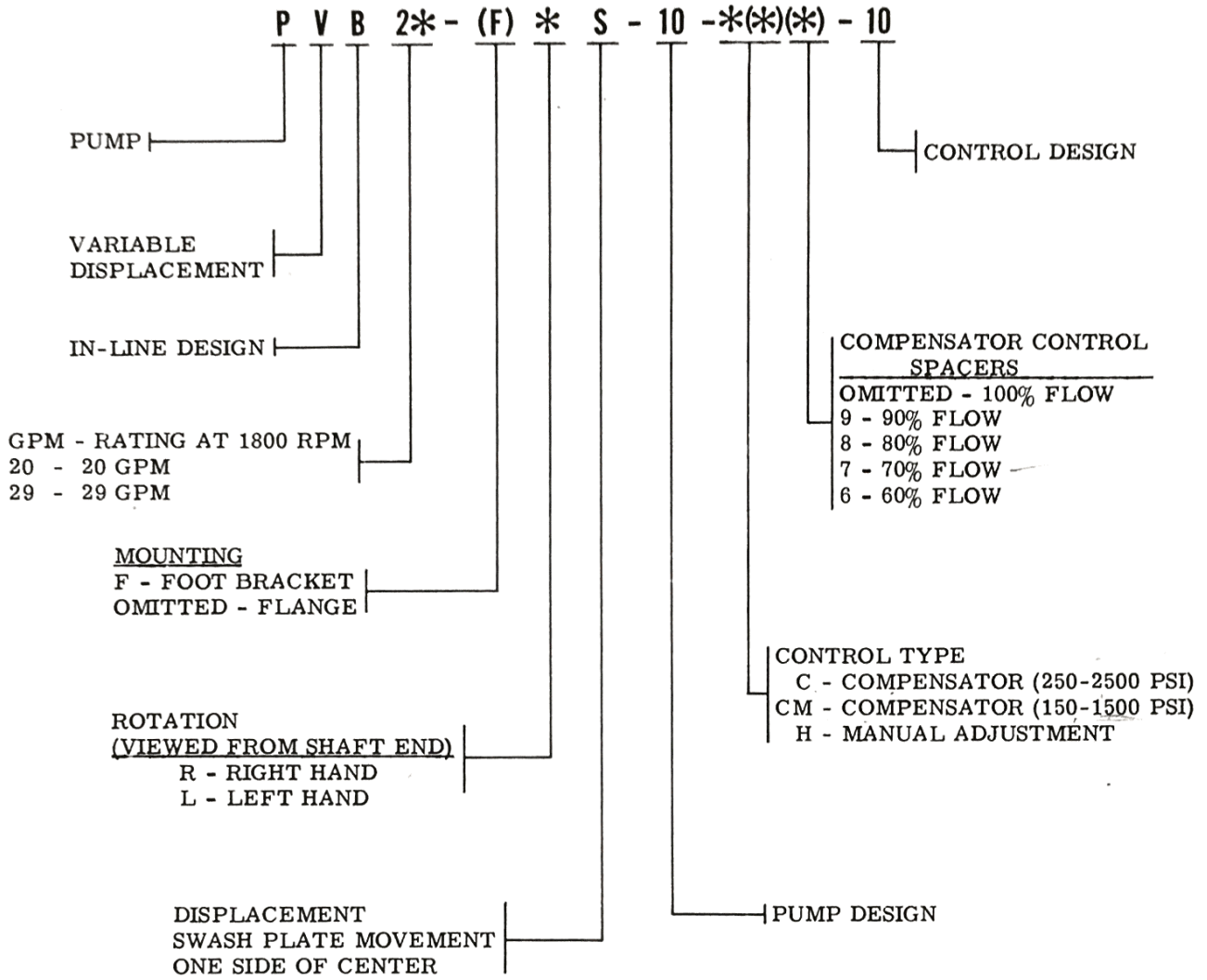

To insure sustained efficiency and maximum trouble-free life of this precision equipment, initial and continuous filtration of the fluid medium to 25 microns or less is essential. (For information pertaining to Vickers economical 10 micron filters, see installation drawing I & M 229847.)