

VICKERS

2-STAGE VANE PUMPS

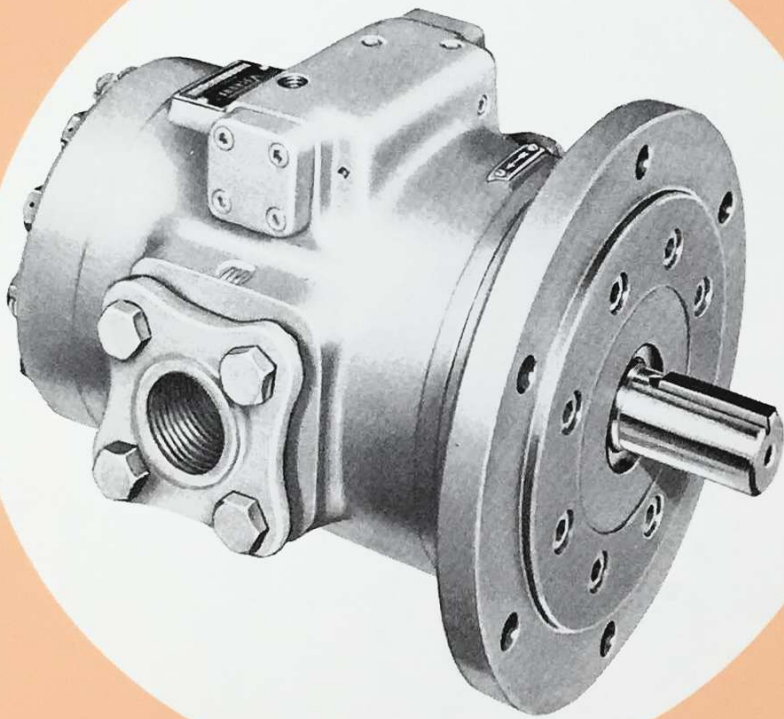

**SERVICE
PARTS
INFORMATION**

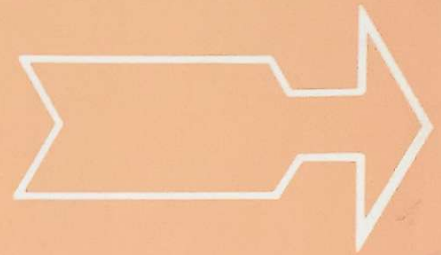

Intermediate Series

**Models: V/VK-2320-2324-2325 -2, 3 and 4 Design
V/VK-2330-2334-2335 -2, 3 and 4 Design**

VICKERS INCORPORATED

DIVISION OF SPERRY RAND CORPORATION

Machinery Hydraulics Division

Service Department

Supersedes

I-1872-S

Rel. 7-31-64

14420 Linwood Avenue

Detroit, Michigan 48238

ATLANTA • CHICAGO • DETROIT • EL SEGUNDO • HOUSTON • SEATTLE • SPRINGFIELD, N. J. • TORONTO

I-3146-S

-2 AND -3 DESIGNS

THESE PARTS ARE NOT INDIVIDUALLY PROCURABLE FOR THE -2 DESIGN PUMPS. ORDER CONVERSION KIT 919288 AND STAMP NEW MODEL NUMBER TO SHOW -3 DESIGN ON NAME PLATE SUPPLIED.

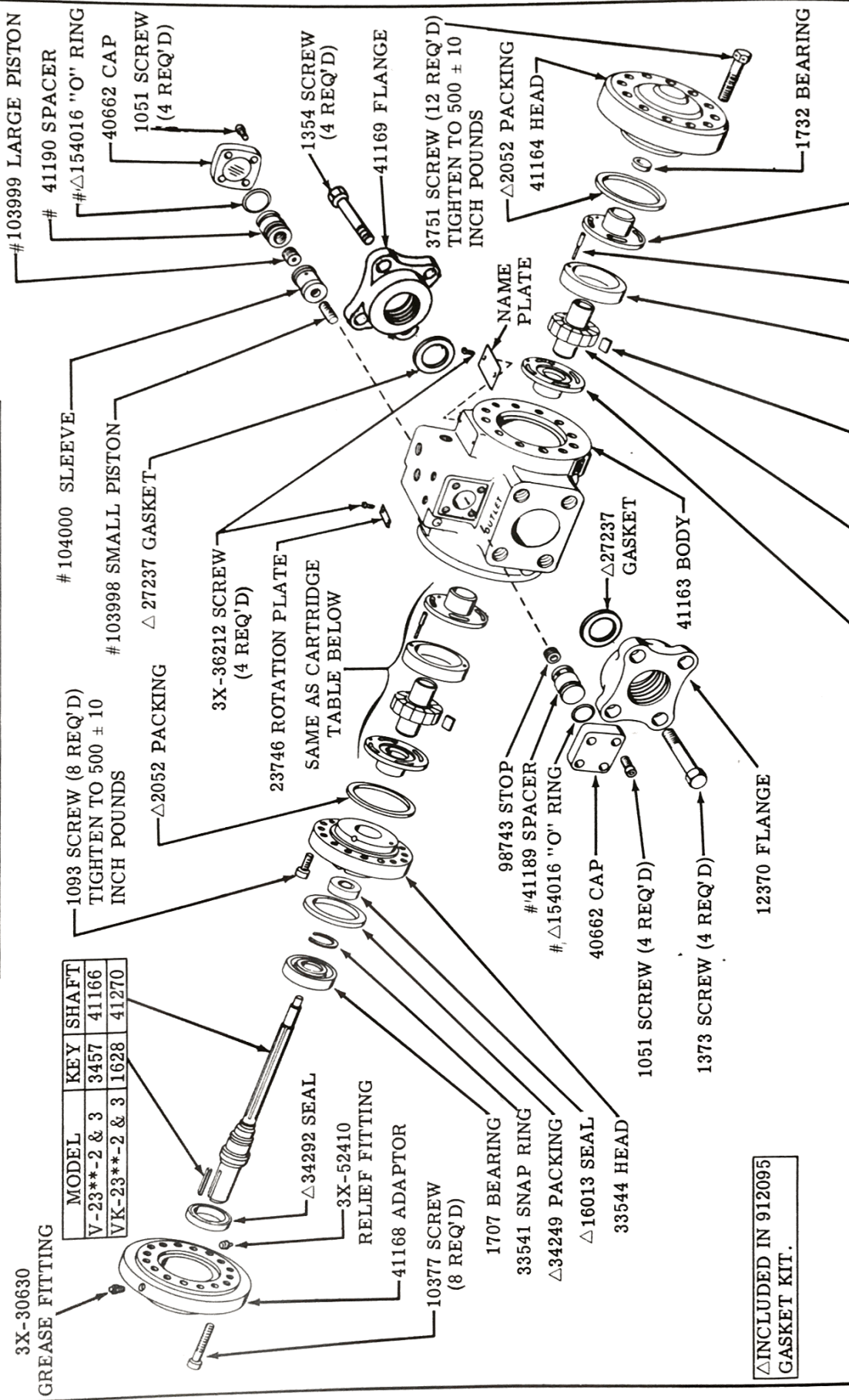

Δ INCLUDED IN 912095 GASKET KIT.

MODEL	BUSHING R.H. or L.H.		ROTOR		VANE KIT (12 VANES)		RING		PIN		BUSHING R.H. or L.H. KITS		CARTRIDGE KITS	
	2045	2046	36172	912029	2044	2046	2051	2045	2046	2045	2046	919096	919094	
V/VK-233*-2 & 3														
V/VK-232*-2 & 3														

SEE PAGE 3 FOR MOUNTING INFORMATION AND CARTRIDGE ASSEMBLY.

-4 DESIGN

MODEL	KEY	SHAFT
V-23*-4	3457	184506
VK-23*-4	1628	184504

905505?
~~181909~~ SEAL -
 Assemble with spring
 toward inside of pump.

184505 ADAPTOR
 10377 SCREW
 (8 REQ'D)

1707 BEARING
 33541 SNAP RING
 Δ34249 PACKING
 182854 HEAD

1051 SCREW (4 REQ'D)
 1373 SCREW (4 REQ'D)

ΔINCLUDED IN 919002
 GASKET KIT.

SEE PAGE 3 FOR MOUNTING
 INFORMATION AND CART-
 RIDGE ASSEMBLY.

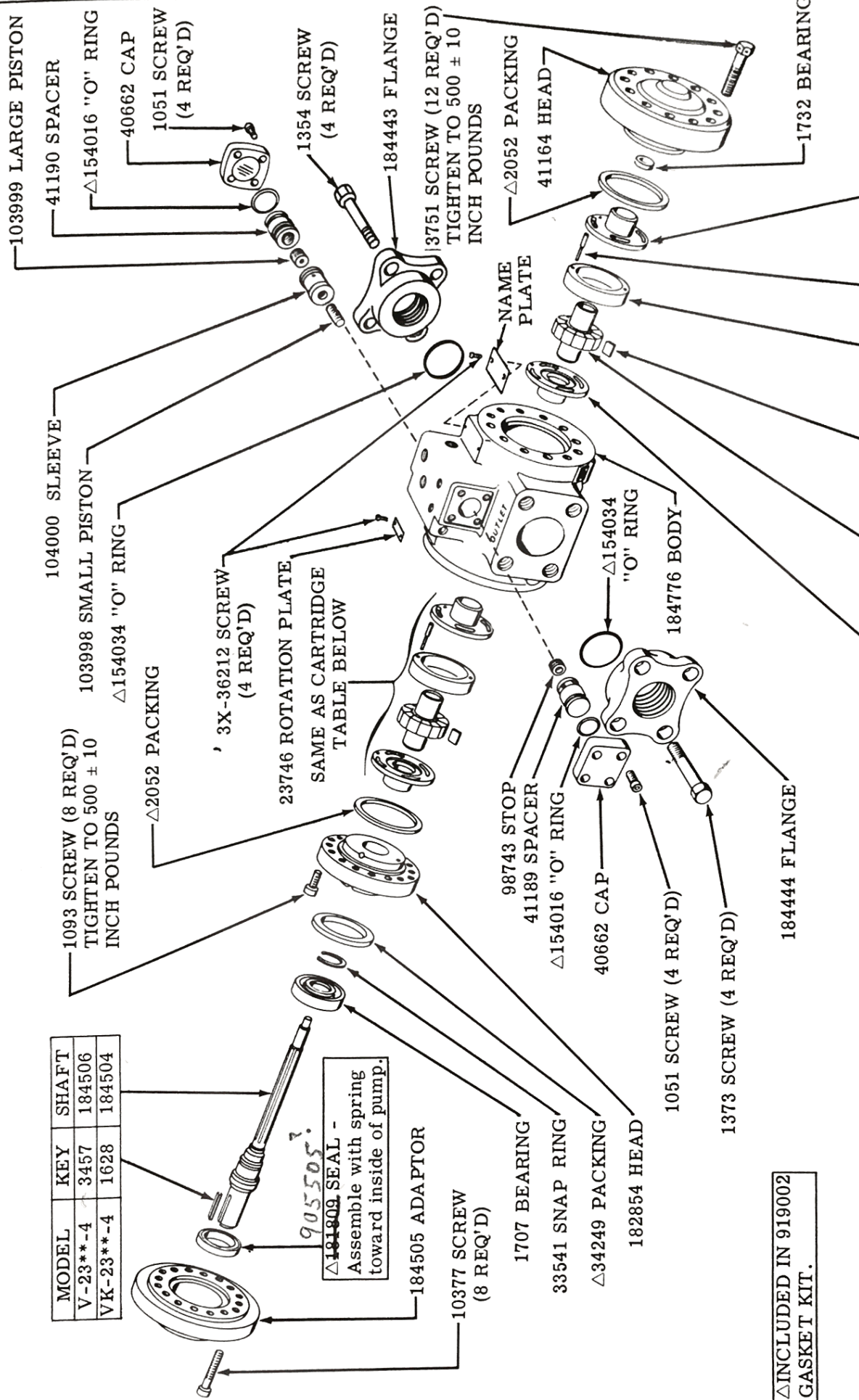

MODEL	BUSHING	ROTOR	VANE KIT	RING	PIN	BUSHING	CARTRIDGE
	R.H. or L.H.	(12 VANES)	R.H. or L.H.	2044	2051	R.H. or L.H.	KITS
V/VK-233*-4	2045	36172	912029	2044	2051	2045	919096
V/VK-232*-4	2046	36172	912029	24188	2046	2045	919094

THESE PARTS ARE INCLUDED IN CARTRIDGE KITS

MODEL CODE

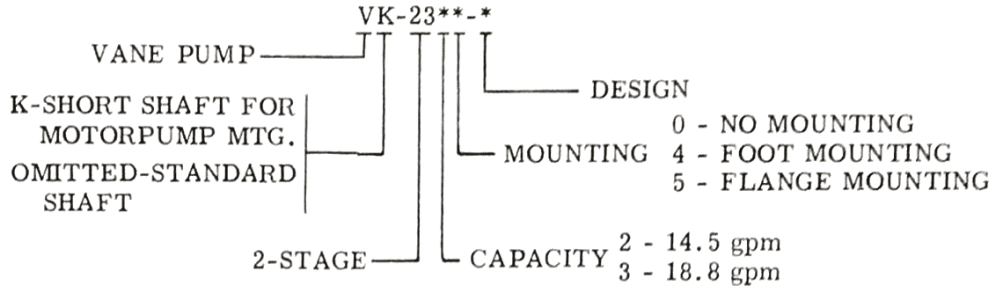

DIVIDING VALVE PARTS

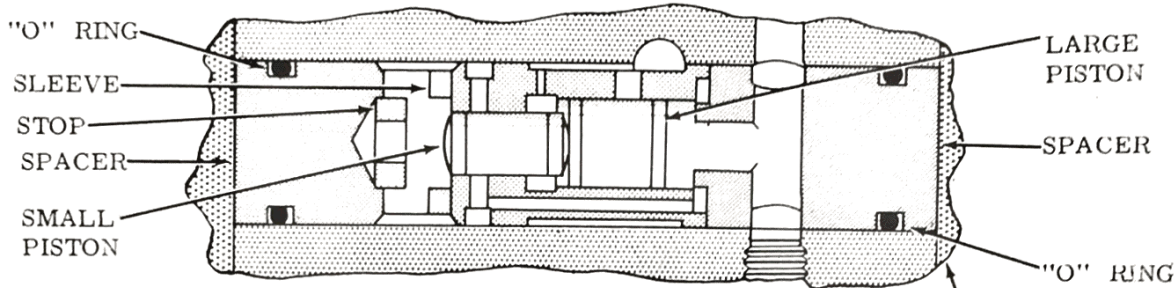

MOUNTING

MODEL	V-23*0	V-23*4	V/VK-23*5
MOUNTING TYPE	NONE	FOOT 41165	FLANGE 33546
SCREW (8 REQ'D)	—	1114	1114
LOCKWASHER (8 REQ'D)	—	—	8544
GASKET	—	—	34311

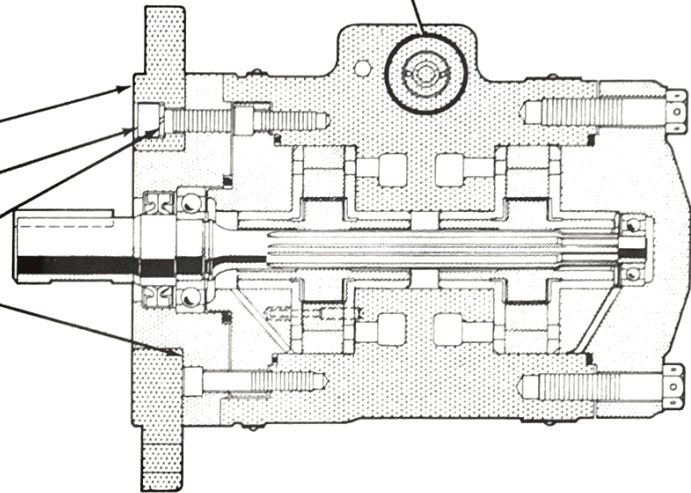

VANE AND ROTOR ASSEMBLY
HEAD-END VIEW FOR R.H. ROTATION SHOWN



Assembly of the rotor and vanes is determined by the direction of pump shaft rotation. Vanes must be assembled so that the small beveled edges are trailing as shown.

To insure sustained efficiency and maximum trouble-free life of this precision equipment, initial and continuous filtration of the fluid medium to 25 microns or less is essential. (For information pertaining to Vickers economical 10 micron filters, see installation drawing I & M 229847.)