

VICKERS

2-STAGE VANE PUMPS

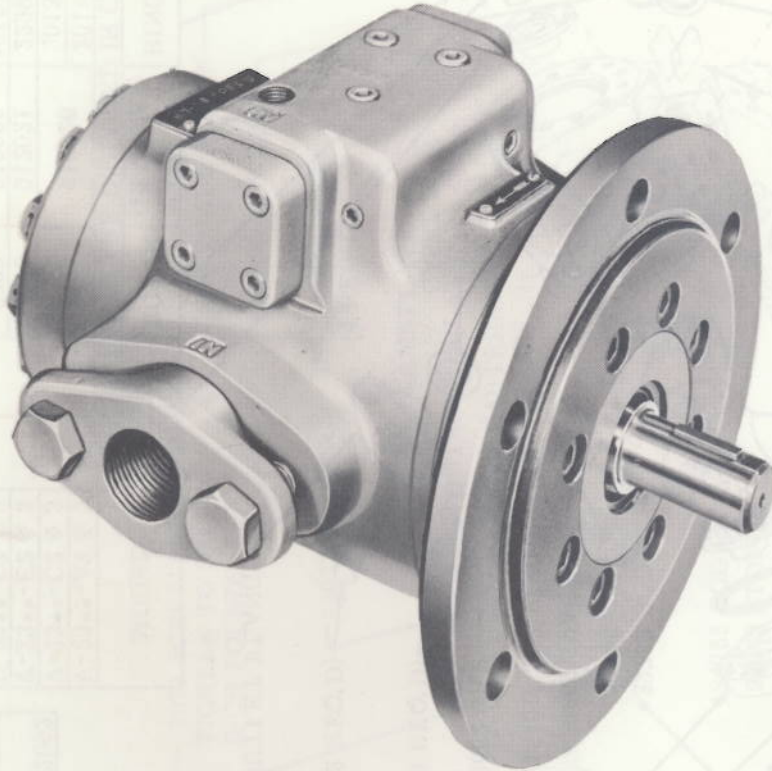

**SERVICE
PARTS
INFORMATION**

Small Series
Models: V/VK-2304-2305-2311 -2, 3 and 4 Design

-2 AND -3 DESIGNS

3X-30630 GREASE FITTING

SERIES	SHAFT
V-23**	39868
VK-23**	39978

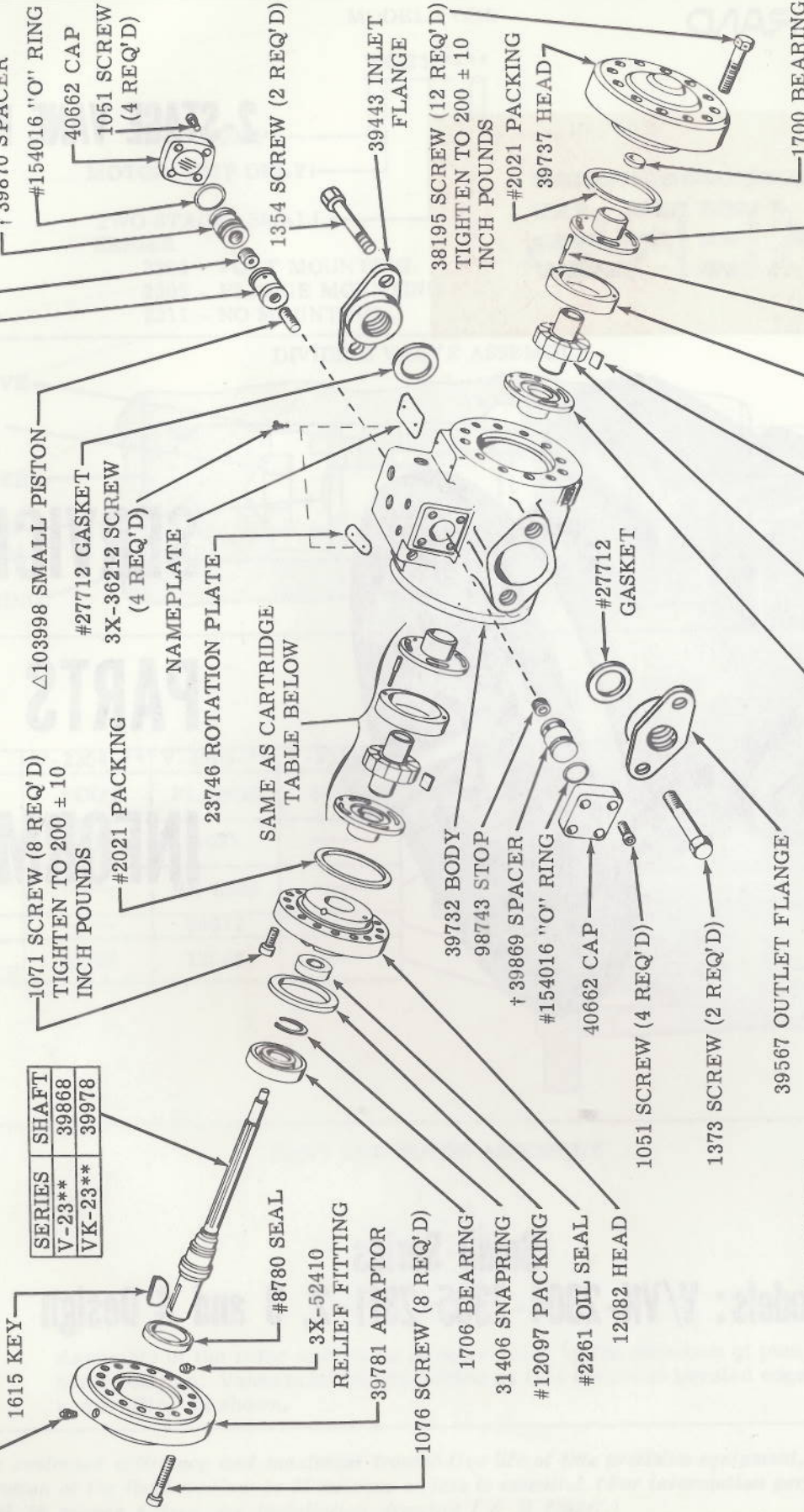

△When replacing Dividing Valve Parts for -2 design models, order 103999 and 103998 Pistons, 104000 Sleeve and 39870 Spacer. (Reference bulletins 790-S and V-2300-3.)

† When replacing 154016 "O" Ring in -2 design models, replace 39870 Spacer and 39869 Spacer.

See page 3 for flange and foot mountings and pump rotation.

MODEL	BUSHING	ROTOR	VANE KIT	RING	BUSHING	CARTRIDGE
	R.H.orL.H.	(12 VANES)	(12 VANES)	PIN	R.F.orL.H.	KITS
V-23**-A2 & 3		6779	912026	2011		912042
V-23**-C2 & 3		2008	912021	2013	2020	912043
V-23**-E2 & 3	2015	6779	912026	2299	2016	912015
V-23**-G2 & 3	2016			40151	2015	912046

THESE PARTS ARE INCLUDED IN CARTRIDGE KITS

#INCLUDED IN 912092 GASKET KIT.

-4 DESIGN

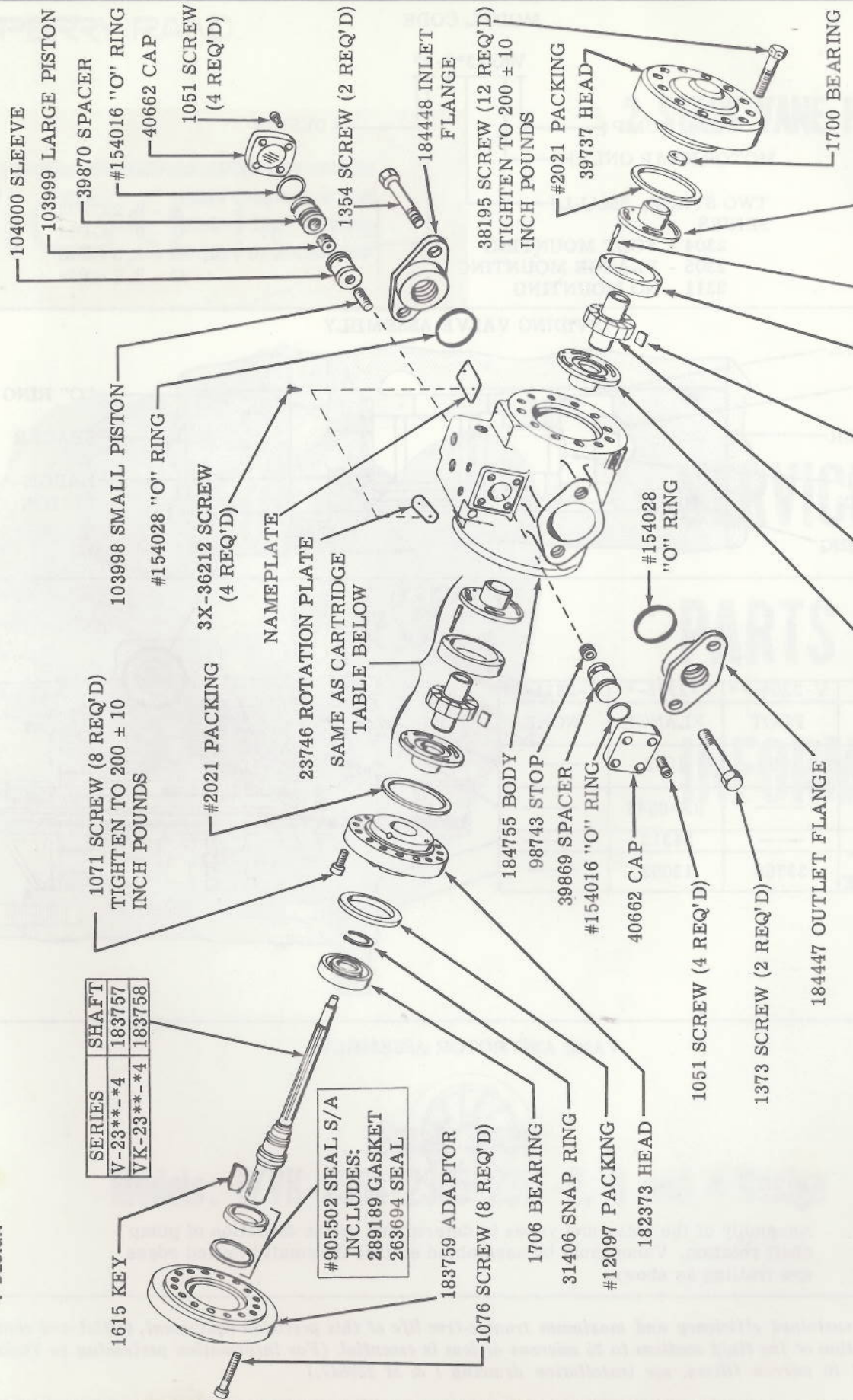

SERIES	SHAFT
V-23**-A4	183757
VK-23**-A4	183758

#905502 SEAL S/A
INCLUDES:
289189 GASKET
263694 SEAL

MODEL	BUSHING	ROTOR	VANE KIT	RING	PIN	BUSHING	CARTRIDGE
	R.H.orL.H.		(12 VANES)	IN CARTRIDGE KITS		R.H.orL.H.	KITS
V-23**-A4		6779	912026	2011			912042
V-23**-C4	2015	2008	912021	2013	2020	2016	912043
V-23**-E4		6779	912026	2299			912015
V-23**-G4				40151			912046

#INCLUDED IN 919001
GASKET KIT.

See page 3 for flange
and foot mountings
and pump rotation.

MODEL CODE

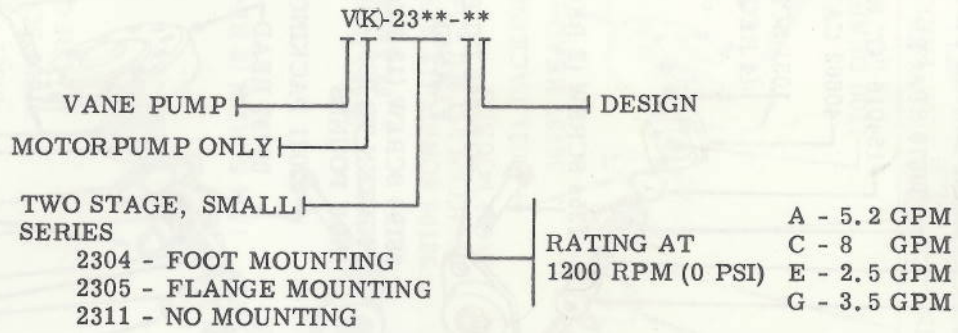

DIVIDING VALVE ASSEMBLY

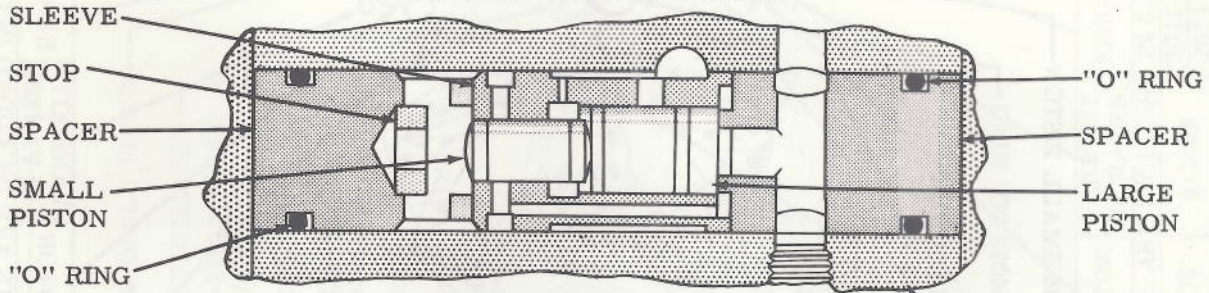

MOUNTING

MODEL	V-2304-**-**	V-2305-**-**	V-2311-**-**
MOUNTING TYPE	FOOT	FLANGE	NONE
SCREW (8 REQ'D)	1093	1093	---
LOCKWASHER (8 REQ'D)	---	9X-8543	---
GASKET	---	34312	---
FOOT	39788	12063	---
FLANGE	---	---	---

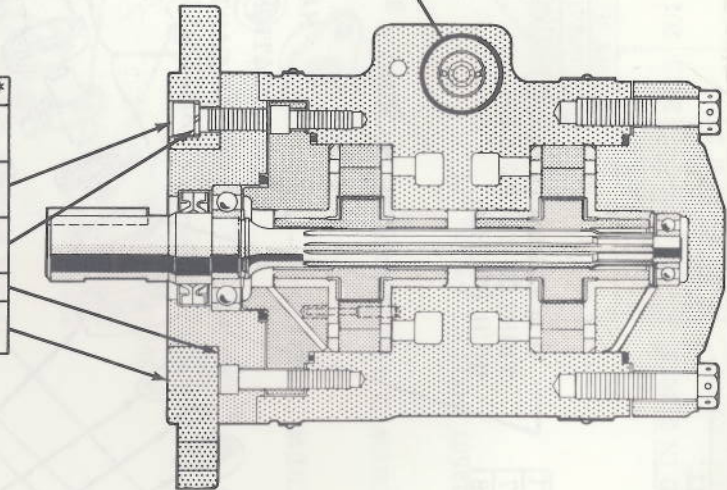

VANE AND ROTOR ASSEMBLY



Assembly of the rotor and vanes is determined by the direction of pump shaft rotation. Vanes must be assembled so that the small beveled edges are trailing as shown.

To insure sustained efficiency and maximum trouble-free life of this precision equipment, initial and continuous filtration of the fluid medium to 25 microns or less is essential. (For information pertaining to Vickers economical 10 micron filters, see installation drawing I & M 229847.)