

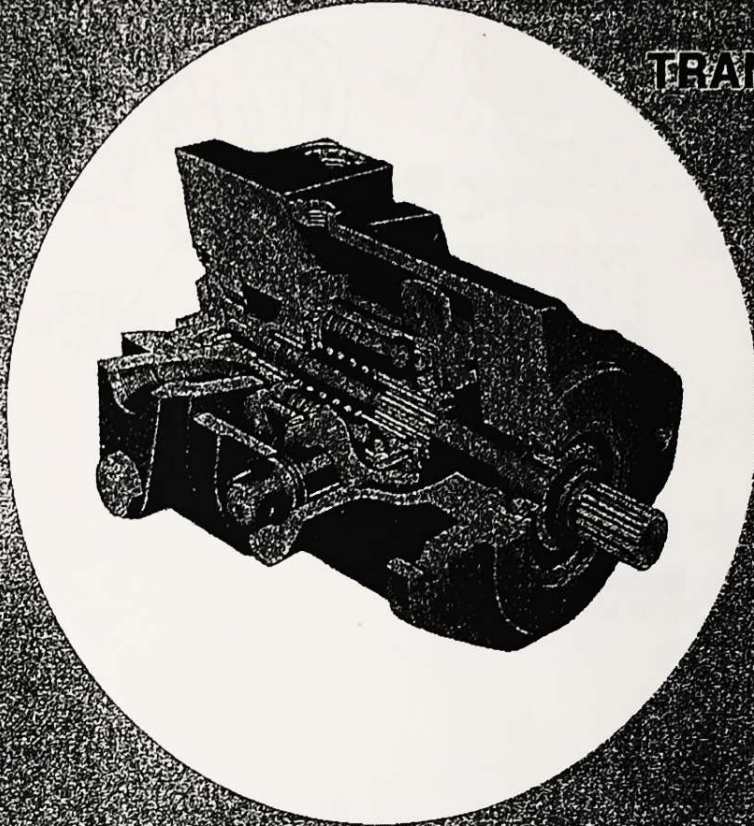

**TRANSMISSION  
PUMPS**



**SERVICE  
PARTS  
INFORMATION**

**TA15 SERIES -10/11 DESIGN**

**SPERRY - VICKERS  
TROY, MI. 48084**

VALVE PLATES/A (INC. 214118 BRG.)	SHAFT ROTATION
923212	RIGHT HAND
923213	LEFT HAND

REPLENISHING CHECK & RELIEF VALVE (2 REQ'D)	RELIEF VALVE SETTING P.S.I.
323822	2000
323820	2500
339490	3000
322534	3250
317180	4000
318399	4500

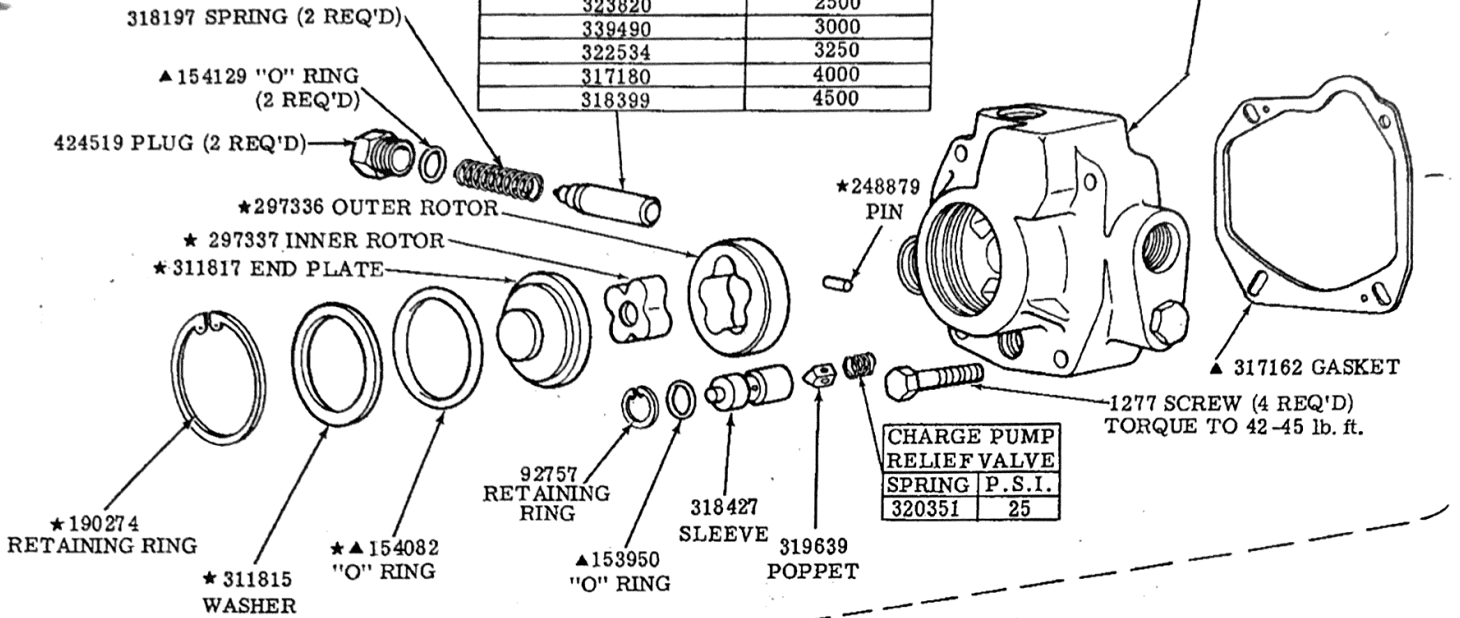

1306 SCREW (2 REQ'D)  
TORQUE TO 75-80 lb. ft.

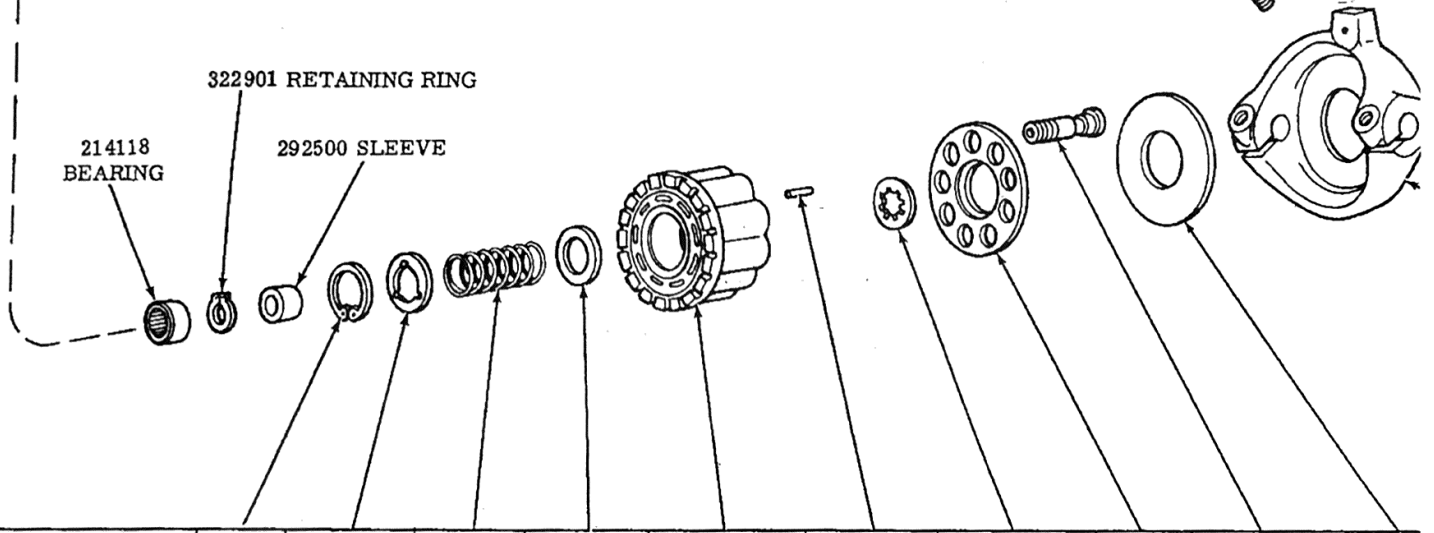

MODEL DESIGNATION	RET. RING	LIFT LIMITER	SPRING	THRUST WASHER	CYLINDER BLOCK	PINS (3 REQ'D)	SPHERICAL WASHER	SHOE PLATE	PISTON S/A (9 PISTONS)	SWA: PLA'
	SERVICED IN PUMP ROTATING GROUP KIT									
TA15-**-10/11	93509	245223	247294	241954	260860	248811	423324	275961	941887	2390'

IN	MODEL
ND	TA15-**-10/11
ND	TA15-**-10/11L

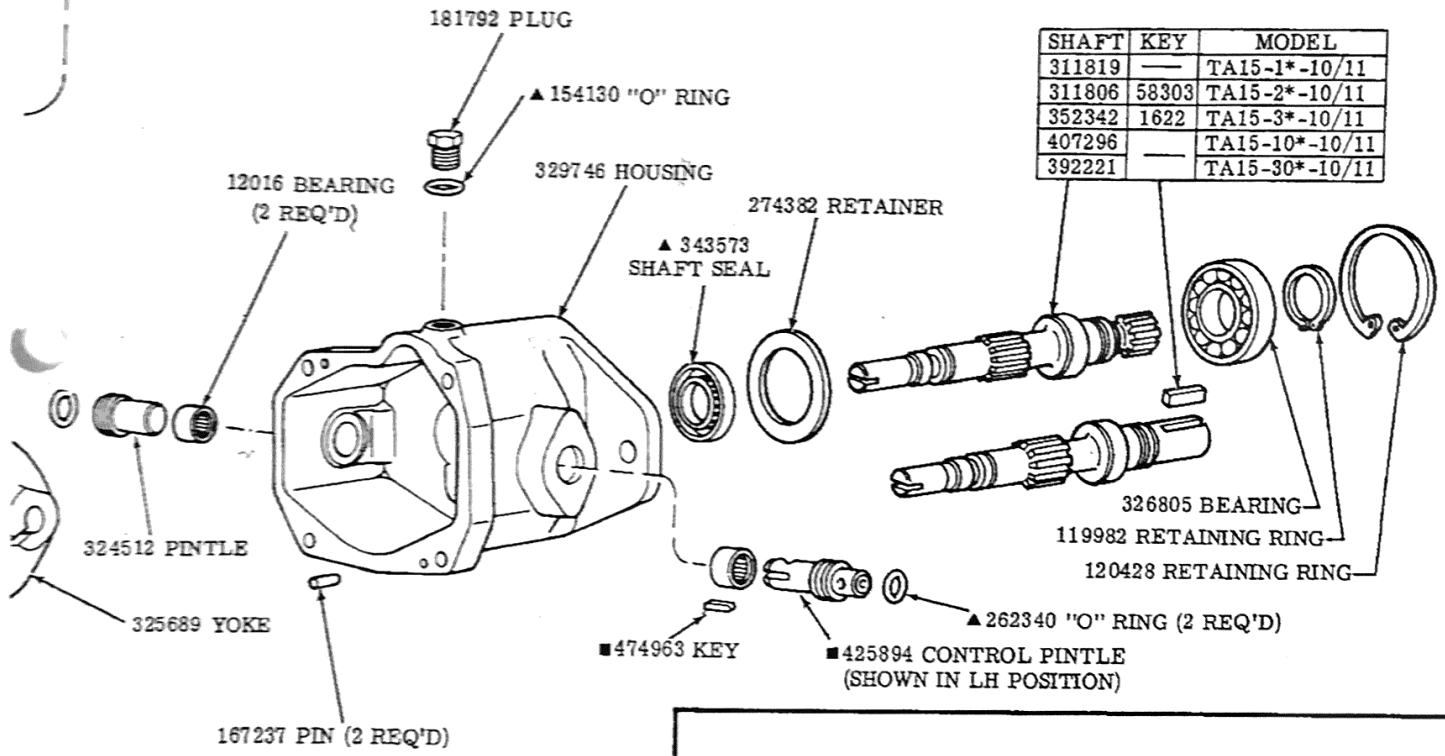
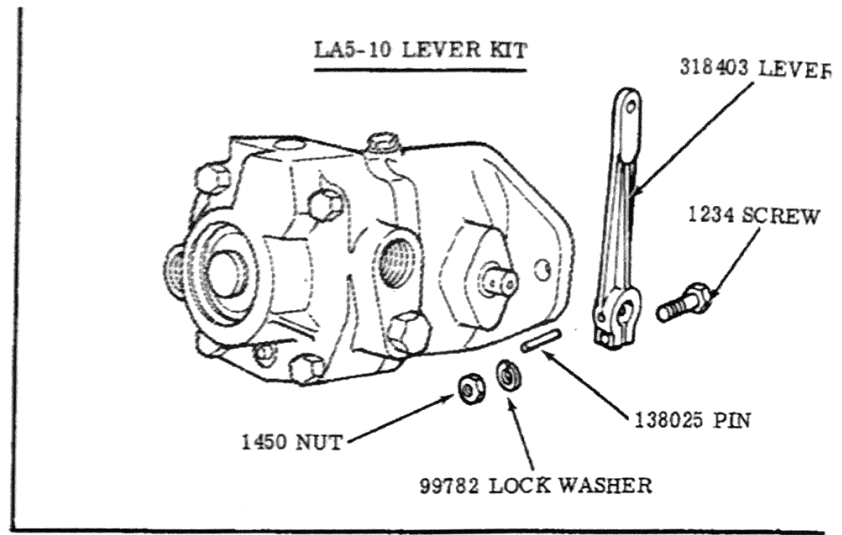

SHAFT	KEY	MODEL
311819	—	TA15-1*-10/11
311806	58303	TA15-2*-10/11
352342	1622	TA15-3*-10/11
407296	—	TA15-10*-10/11
392221	—	TA15-30*-10/11

■ -10 DESIGN MUST REPLACE KEY AND CONTROL PINTLE

WASH LATE	PUMP ROTATING GROUP KIT
39077	923062

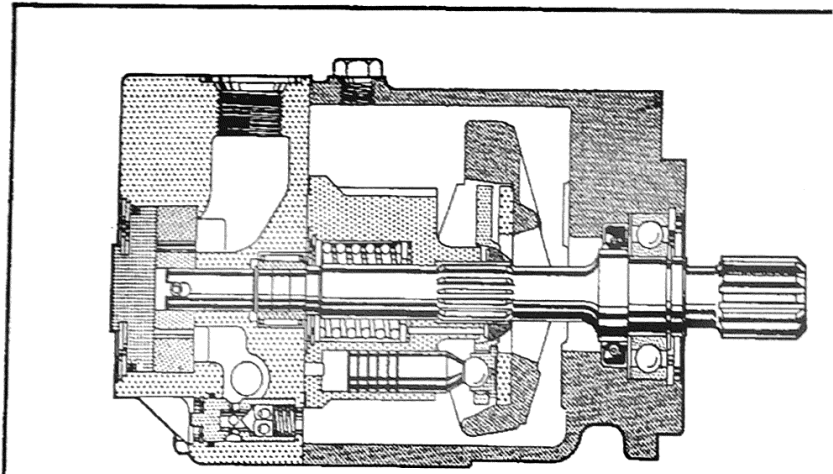

**ASSEMBLY VIEW**

- ★ THESE PARTS ARE SERVICED IN GEROTOR KIT 923379
- ▲ THESE PARTS ARE INCLUDED IN SEAL KIT 923214

# MODEL CODE BREAKDOWN

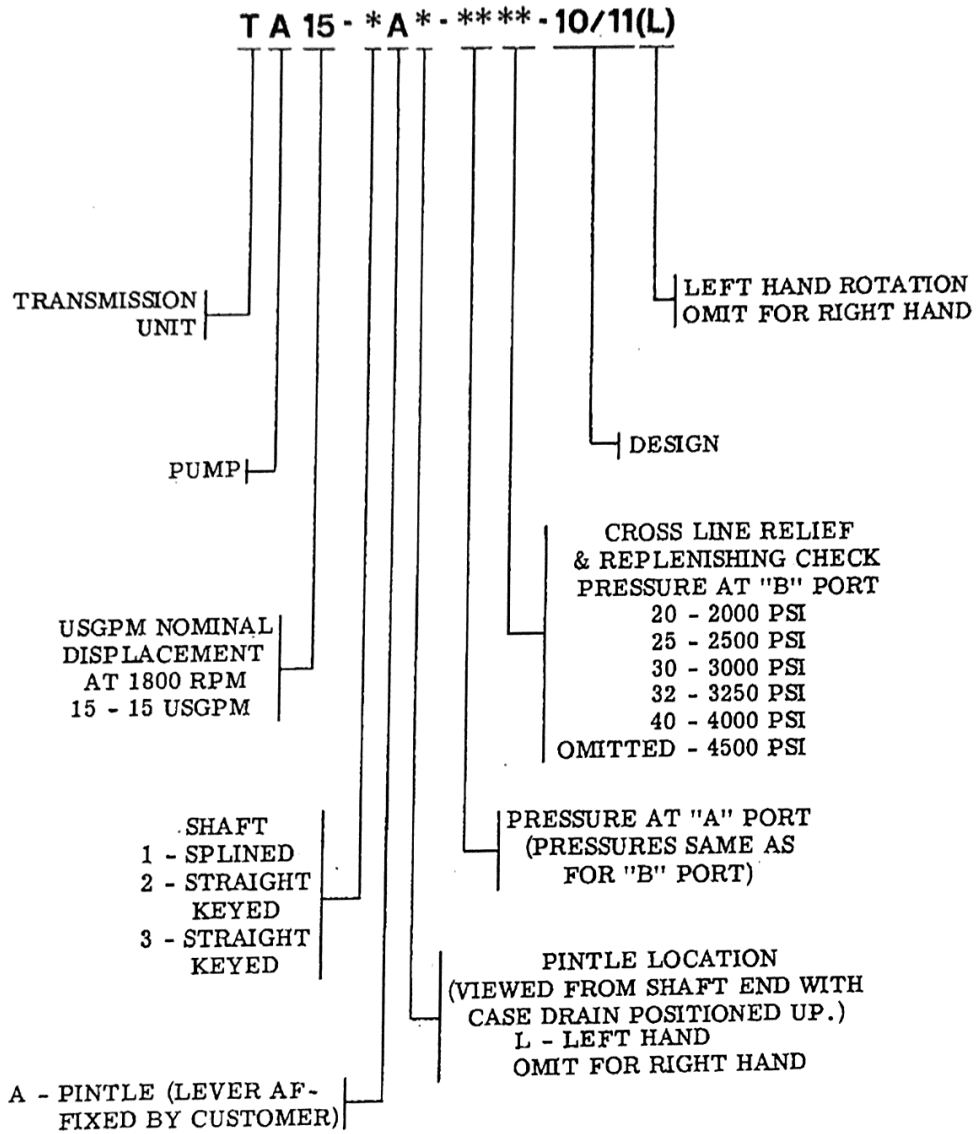

To insure sustained efficiency and maximum trouble-free life of this precision equipment, initial and continuous filtration of the fluid medium to 25 microns absolute or less is essential. (For information pertaining to Sperry Vickers economical 3 or 10 micron filters, see installation drawing 522140.)