

SPERRY VICKERS

HEAVY  
DUTY  
PISTON  
PUMPS

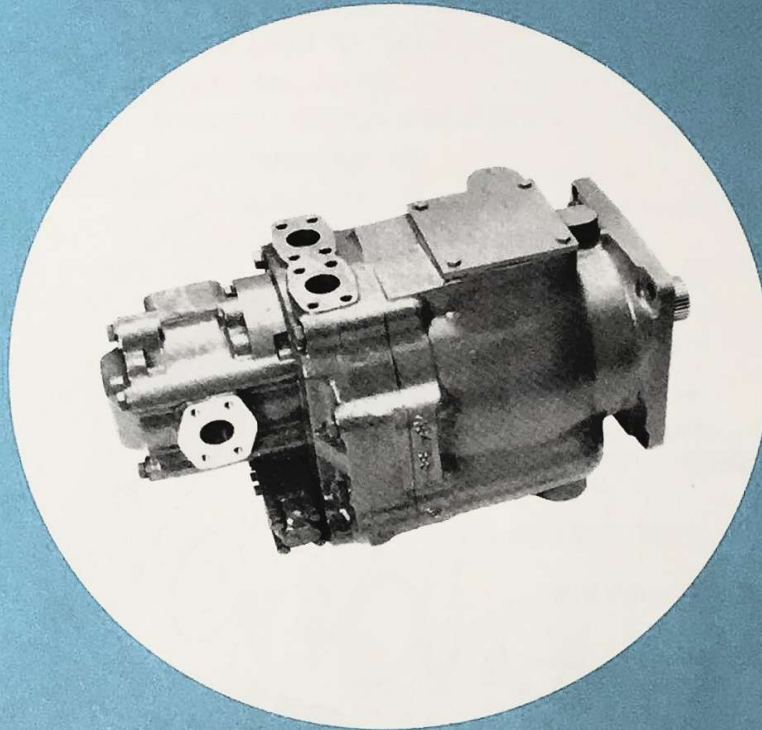

**SERVICE  
PARTS  
INFORMATION**

**PVD80C\*\*-\*\*-11-C\*\*\*\*\*-13**

SPERRY VICKERS  
TROY, MI. 48084



MODEL	VALVE BLOCK	VALVE PLATE	CHARGE PUMP	ROTATION DIRECTION	YOKE FEEDBACK FEATURE
PVD80L	581552	581550	590637	LEFT	INCLUDED
PVD80L-C	584119				OMITTED
PVD80R	581927	581118	590636	RIGHT	INCLUDED
PVD80R-C	584118				OMITTED

MODEL	SHAFT
PVD80*-1*-11	581076
PVD80*-6*-11	581553
PVD80*-9*-11	587841

▲ INCLUDED IN 920178 SEAL KIT  
 ■ INCLUDED IN 938079 ROTATING GROUP

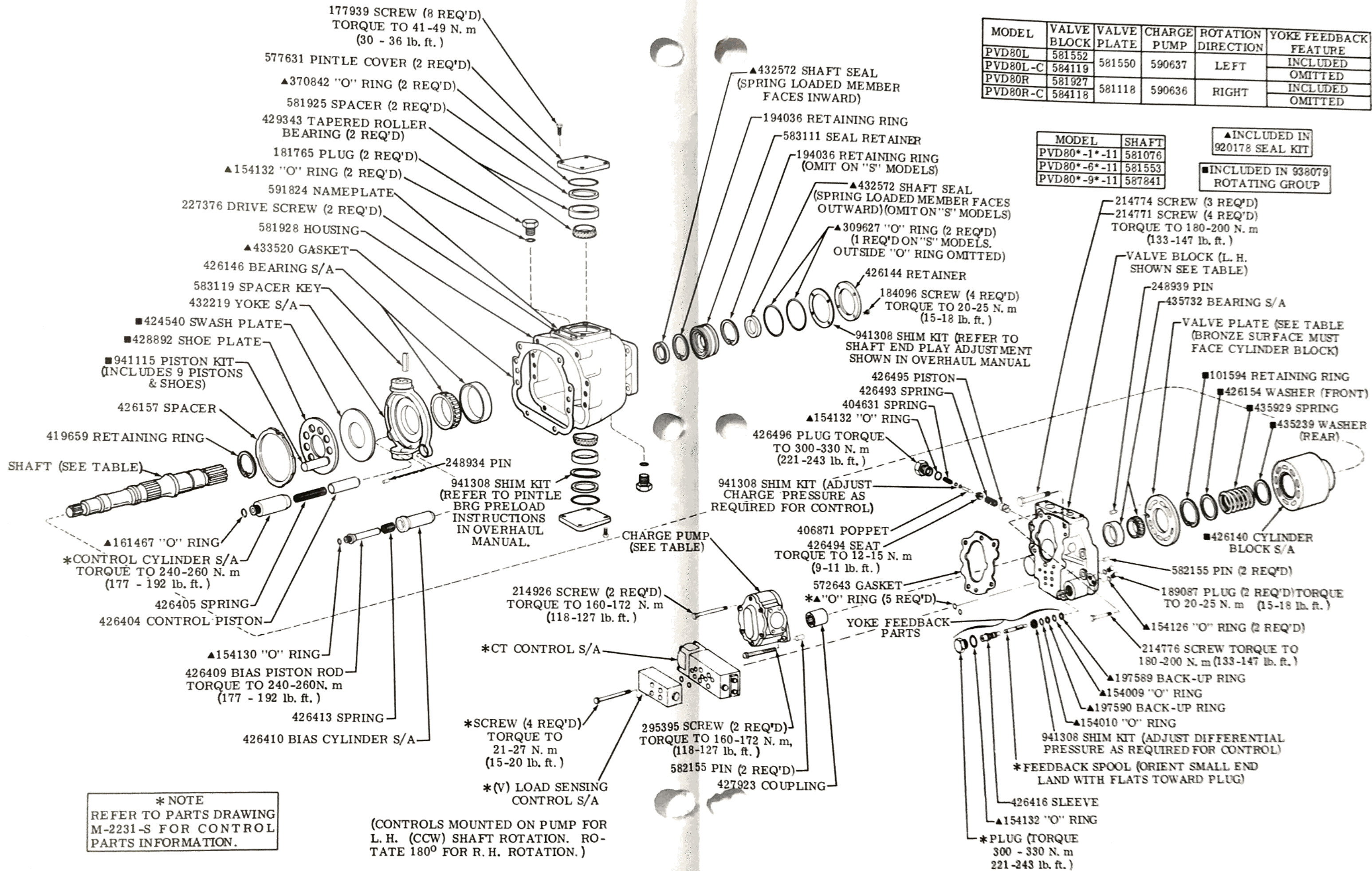

\* NOTE  
REFER TO PARTS DRAWING  
M-2231-S FOR CONTROL  
PARTS INFORMATION.

(CONTROLS MOUNTED ON PUMP FOR  
L. H. (CCW) SHAFT ROTATION. RO-  
TATE 180° FOR R. H. ROTATION.)

# MODEL CODE BREAKDOWN

**P V D 80 C \* - \* \* - 1 1 - C \* \* \* \* \* - 1 3**

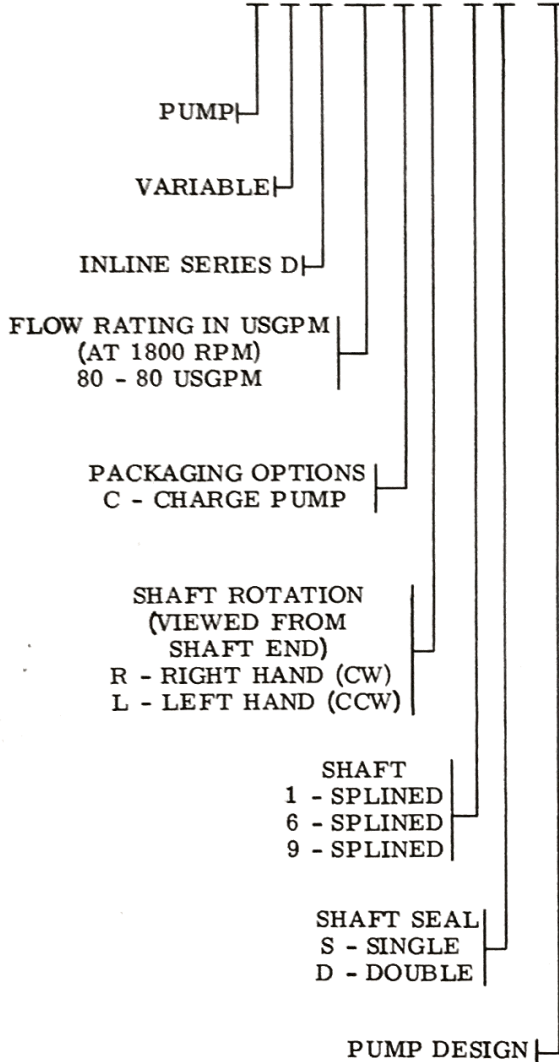

CONTROL  
DESIGN

CONTROL OPTIONS		CONTROL DEFINITIONS
C	N	C - PRESSURE LIMITER
CD	CN	D - DUAL LEVEL
CT	CNS1	N - SPEED SENSING
CTS	CNS2	S - SUMMATION
CV	CVN	S1 - SUMMATION-MASTER PUMP SPEED SENSING
CVT	CVNS1	S2 - SUMMATION-SLAVE PUMP SPEED SENSING
CVTS	CVNS2	T - TORQUE LIMITER
		V - LOAD SENSING

## NOTE

Two digits will appear following an adjustable control function. This indicates control function pressure setting in bar/10. On speed sensing units (N), the two digits indicate RPM/100.

Ex. C35T21S  
           └──┬──┘ Pressure in bar/10

C30N24S1  
           └──┬──┘ RPM/100  
               └──┬──┘ Pressure in bar/10

To insure sustained efficiency and maximum trouble-free life of this precision equipment, initial and continuous filtration of the fluid medium to 35 microns absolute or less is essential. (For information pertaining to Sperry Vickers economical filters, see bulletin 81-216.)