

SPERRY VICKERS

**VARIABLE IN-LINE
PISTON PUMPS**

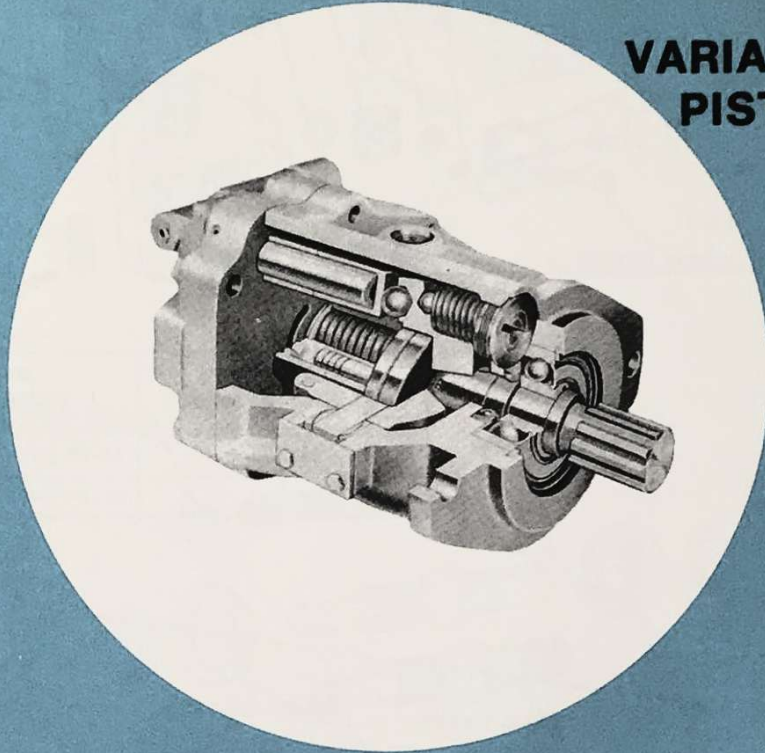

**SERVICE
PARTS
INFORMATION**

M-PVB45-10 DESIGN

SPERRY VICKERS
TROY, MI. 48084

Revised 2-1-76

M-2214-S

MODEL CODE

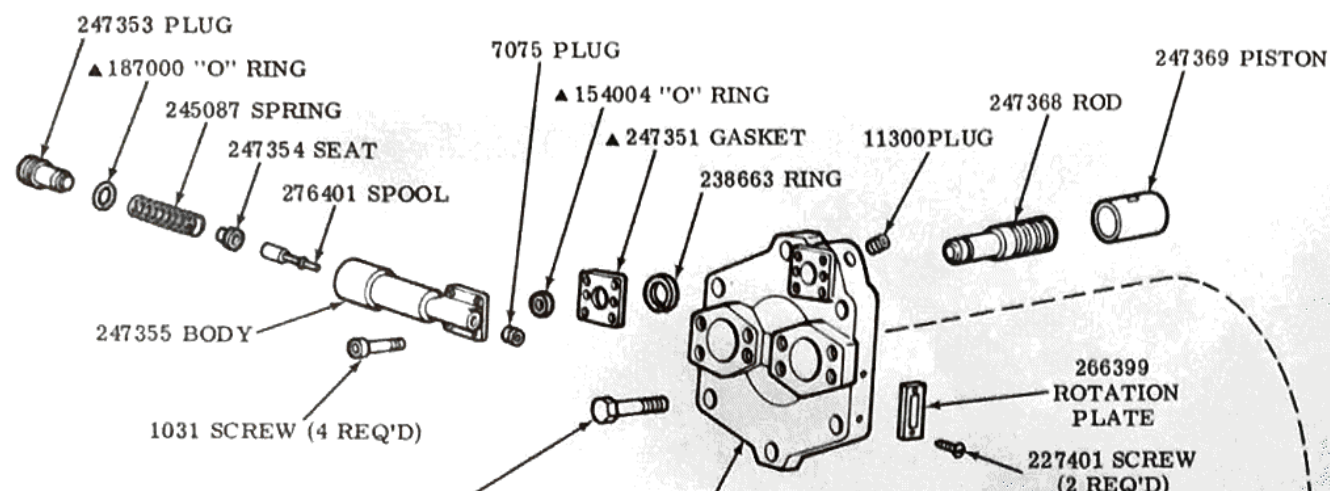
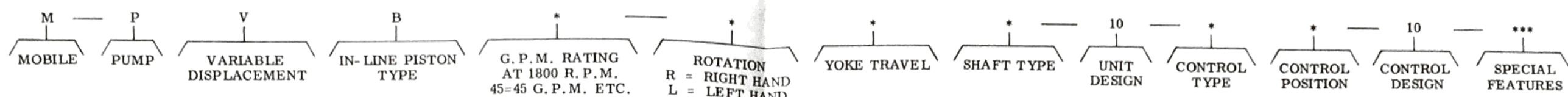

1356 SCREW (6 REQ'D)
(TORQUE TO 90-95 FT. LBS.)

VALVE PLATE (INCLUDES BEARING)	MODEL DESIGNATION
941890	M-PVB45-R**-10-C-10
941891	M-PVB45-L**-10-C-10

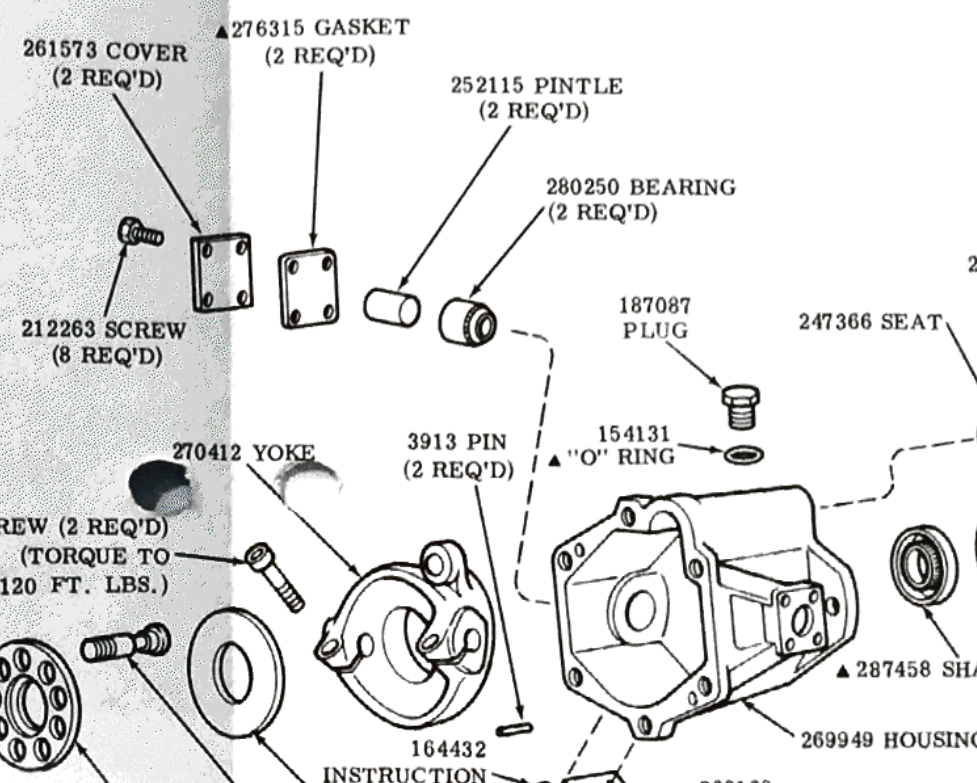

MODEL DESIGNATION	SHAFT	KEY
M-PVB*-**F-10-*10	247371	247101
M-PVB*-**E-10-*10	318548	

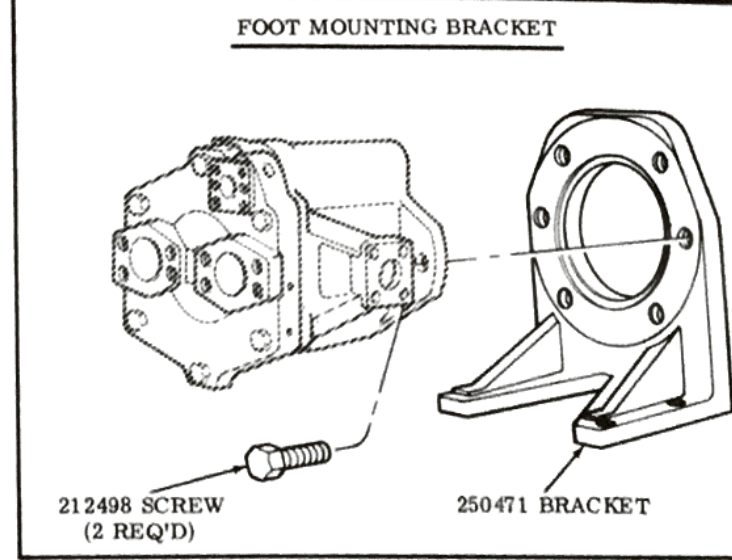

MODEL DESIGNATION	SNAP RING	LIFT LIMITER	SPRING	THRUST WASHER	CYLINDER BLOCK	PIN (5 REQ'D)	WASHER	SPHERICAL WASHER	SHOE PLATE	PISTON KIT (9 PISTONS)	SWASH PLATE	ROTATING GROUP KIT
M-PVB45***-10-*-10	126911	246017	282557	253665	344064	248883	253664	241541	266112	941889	241543	923350

THESE PARTS SERVICED IN ROTATING GROUP KIT

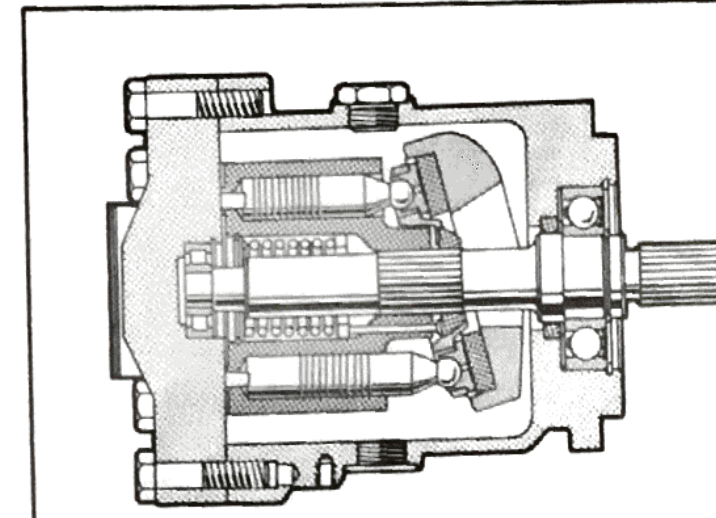

ASSEMBLY VIEW

▲ SERVICED IN 919401 SEAL KIT

SPARE PARTS STOCK RECOMMENDATIONS (FOR EACH 100 UNITS IN OPERATION)

PART NUMBER	NAME	M-PVB										QUANTITY PER UNIT	QUANTITY RECOMMENDED FOR STOCK
		G. P. M. RATING	ROTATION	YOKE TRAVEL	SHAFT TYPE	UNIT DESIGN	CONTROL TYPE	CONTROL POSITION	CONTROL DESIGN	SPECIAL FEATURES			
247353	PLUG											1	2
245087	SPRING											1	10
247354	SEAT											1	10
276401	SPOOL											1	15
247355	BODY											1	5
1031	SCREW											4	10
7075	PLUG											1	2
238663	RING											1	10
1356	SCREW											6	10
SEE PAGE 1	VALVE PLATE		R, L									1	15
227401	SCREW											6	10
266399	ROTATION PLATE											1	2
247368	ROD											1	10
247369	PISTON											1	10
281655	BEARING											1	7
140356	SNAP RING											1	10
126911	SNAP RING	45										● 1	15
246017	LIFT LIMITER	45										● 1	15
282557	SPRING	45										● 1	10
253665	THRUST WASHER	45										● 1	15
344064	CYLINDER BLOCK	45										● 1	15
248883	PIN	45										● 5	10
253664	WASHER	45										● 1	10
241541	SPHERICAL WASHER	45										● 1	10
266112	SHOE PLATE	45										● 1	15
941889	PISTON KIT (9 PISTONS)	45										● 1	15
241543	SWASH PLATE	45										● 1	15
923350	ROTATING GROUP KIT	45										1	15
1117	SCREW											2	10
270412	YOKE											1	5
3912	PIN											2	10
164432	INSTRUCTION PLATE											1	2
263129	NAME PLATE											1	2
287458	HOUSING											1	2
212263	SCREW											8	10
261573	COVER											2	10
252115	PINTLE											2	10
280250	BEARING											2	15
187087	PLUG											1	2
247366	SEAT											1	10
279492	SPRING											1	10
247365	PLUG											1	2
273385	SPACER											1	10
SEE PAGE 2	SHAFT				F, E							1	7
247101	KEY				F							1	7
283662	BEARING											1	7
102835	SNAP RING											1	10
171545	SNAP RING											1	10
919401	SEAL KIT											1	25

● MAY BE PURCHASED IN ROTATING GROUP KIT

To insure sustained efficiency and maximum trouble-free life of this precision equipment, initial and continuous filtration of the fluid medium to 25 microns or less is essential. For information pertaining to Vickers economical 10 micron filters, see installation drawing M-229847.